

MUNSON STREET

TYLER STREET

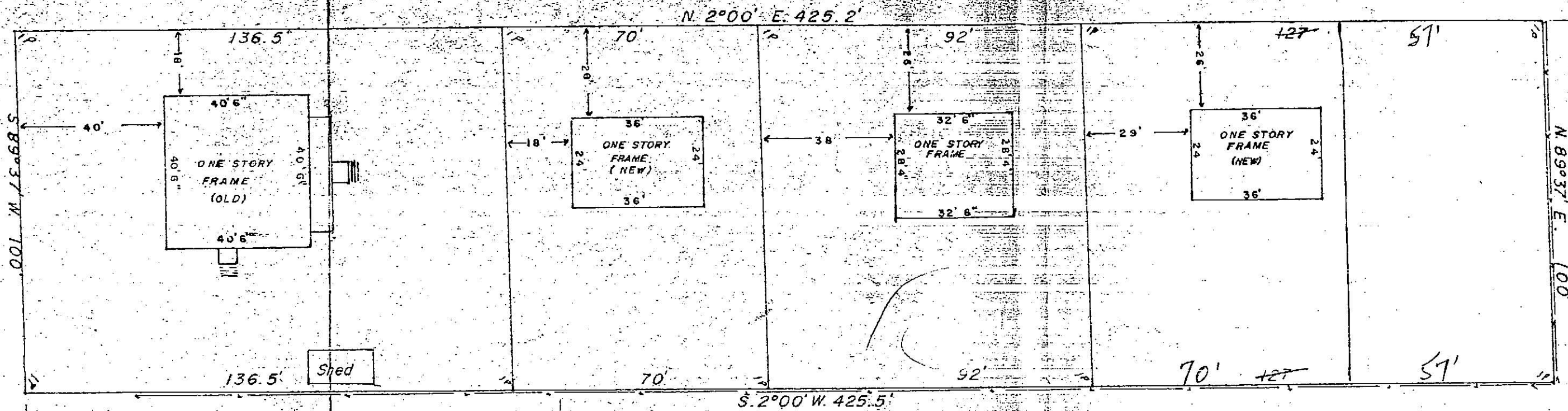

Lot No. 13 DAWSON ADDITION

CITY PARK

TO ALL PARTIES INTERESTED IN PREMISES SURVEYED:
 This is to certify that I have this date made a careful and accurate survey of property located on Munson and Tyler Streets in the City of Rockwall, Rockwall County Texas, being a .976 acre tract in size, Cassie Davis to M.J. Rodgers et al, described as follows:
 BEGINNING at an iron pin in the Northeast corner of Munson Avenue and the Southeast corner of Tyler Street;
 THENCE North 2 deg. 00' East 425.5 ft. with the East line of Tyler Street to an iron pin for a corner;
 THENCE North 89 deg. 37' East 100 ft. to an iron pin for a corner;
 THENCE South 2 deg. 00' West 425.5 ft. with old fence line to an iron pin in the Southwest corner of the Dawson Addition and the North margin of Munson Avenue;
 THENCE South 89 deg. 37' West 100 ft. to the place of beginning containing 0.976 acres subdivided into four tracts as shown by plat hereon.

The plat hereon is a true, correct and accurate representation of property shown hereon as determined by survey, the lines, distances and courses are as shown, the size, type and location of the buildings are as shown, set back the distances from property lines as shown and being within the boundaries of said property.

THERE ARE NO ENCROACHMENTS, CONFLICTS OR PROTRUSIONS.

May 15, 1964

R.E.L. Halford
 R.E.L. Halford

MONNIE RODGERS SUB-DIVISON
 LOCATED IN THE

CITY OF ROCKWALL, ROCKWALL COUNTY TEXAS

May 15, 1964

Scale 1" = 300'

R.E.L. Halford
County Surveyor.