

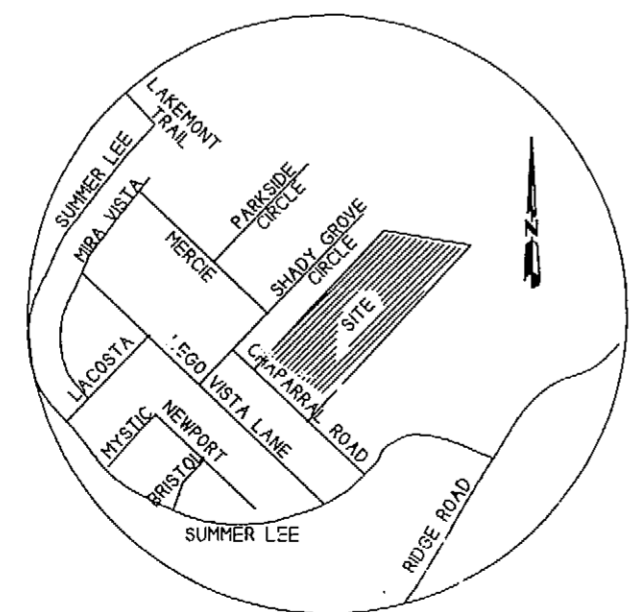

LAGO VISTA LANE



VICINITY MAP NTS

NOTES

- 1) According to F.E.M.A. Flood Insurance Rate Map, Community Panel No. 480547 0005 c dated June 16, 1992, this property lies in Zone X and Zone A. Part of this property does appear to lie within a 100-year flood plain.
- 2) BEARING SOURCE: RECORDED DEED IN VOL. 2228, PG. 64, R. P. R. R. C. T.
- 3) ALL 1/2" IRS ARE CAPPED WITH YELLOW PLASTIC CAPS "R.S.C.I. RPLS 5034."
- 4) ACCESS PROVIDED TO LOT 13B-R BY THE 24' FIRE LAND AND ACCESS EASEMENTS AS SHOWN ON THE PLAT OF WILLIS-SEALOCK ADDITION

OWNER:

FAY WILSON
 C/O STEVE WILSON
 400 CHAPARRAL LANE
 ROCKWALL, TEXAS
 (214) 651-5000

REPLAT OF
LOT 13
LAKE RIDGE ESTATES

EDWARD TEAL SURVEY, ABSTRACT NO. 207
 CITY OF ROCKWALL,
 ROCKWALL COUNTY, TEXAS

ROCKWALL SURVEYING COMPANY, INC.
 308 E. WASHINGTON, SUITE C ROCKWALL, TEXAS 75087 PHONE (972) 772-5434 FAX (972) 772-5443

SURVEY DATE June 6, 2002
 SCALE 1" = 60' FILE # 20011241-P
 CLIENT Wilson

260984
 E-219