

UNINCORPORATED ROCKWALL COUNTY  
CITY OF ROCKWALL CITY LIMITS

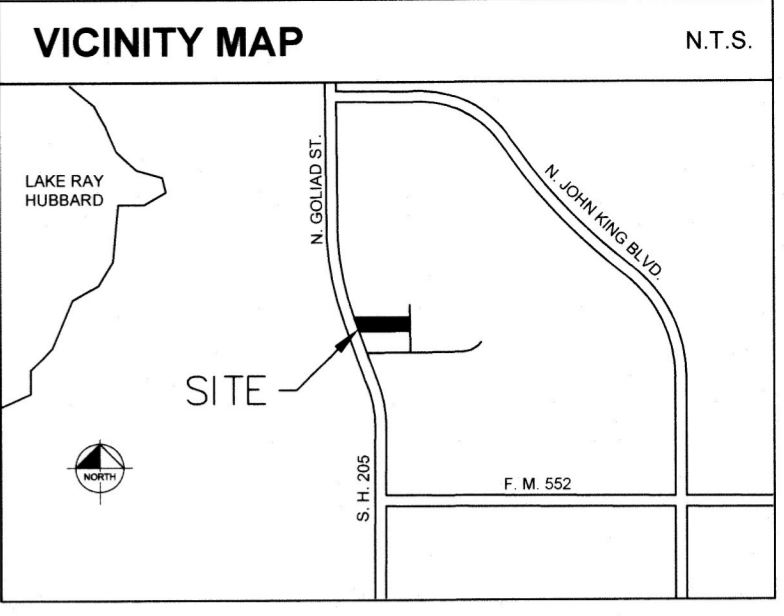

N.T.S.  
20220303021657 1/2 PLT 09/29/2022 10:27:47 AM

R.C.A.D. #86669  
LOT 1, BLOCK 1  
VALK ROCKWALL ADDITION  
INST. NO. 2014000003303  
O.P.R.R.C.T.

24' FIRELANE EASEMENT  
INST. NO. 2014000003303

15' WATER LINE EASEMENT  
INST. NO. 2014000003303

DETECTION DRAINAGE EASEMENT  
INST. NO. 2014000003303

DRAINAGE EASEMENT  
BY SEPARATE INSTRUMENT

FIRELANE EASEMENT  
BY SEPARATE INSTRUMENT

0.0345 ACRE (1,502 SQ. FT.)  
RIGHT OF WAY DEDICATION  
TO COUNTY OF ROCKWALL

1/2" IRF  
N7.043.517.64  
E2.592.955.55

N. GOLIAD STREET (STATE HIGHWAY 205)  
100' WIDE PUBLIC RIGHT OF WAY

50' B.L. (BY THIS PLAT)  
10' UTILITY EASEMENT  
BY THIS PLAT

FIRELANE EASEMENT  
BY SEPARATE INSTRUMENT

24' FIRELANE AND  
UTILITY EASEMENT  
(BY THIS PLAT)

CALLLED 2.081 ACRES  
PS LPT PROPERTIES INVESTORS  
INST. NO. 20210000031763  
O.P.R.R.C.T.  
R.C.A.D. #12322

LOT 1, BLOCK A  
2.0477 ACRES  
89,197 SQ. FT.

20' EASEMENT TO  
FARMERS ELECTRIC  
COOPERATIVE, INC.  
VOL. 2268, PG. 41

24' FIRELANE AND  
UTILITY EASEMENT  
(BY THIS PLAT)

20'X18' ELECTRIC  
EASEMENT

24' FIRELANE AND  
UTILITY EASEMENT  
(BY THIS PLAT)

DRAINAGE DETENTION  
EASEMENT  
(BY THIS PLAT)

R.C.A.D. #12996  
CALLED 2.38 ACRES  
GEORGE R. WEATHERFORD  
VOL. 4280, PG. 255  
O.P.R.R.C.T.

P.O.B.  
5/8" IRF  
N7.043.377.67  
E2.592.709.98

JOSEPH STRICKLAND SURVEY  
ABSTRACT NO. 187

R.C.A.D. #12320  
CALLED 2.672 ACRES  
DANIEL W. STRONG AND WIFE,  
ELIZABETH KAY STRONG  
VOL. 1823, PG. 224  
O.P.R.R.C.T.

CURVE TABLE					
NO.	DELTA	RADIUS	LENGTH	CHORD BEARING	CHORD
C1	90°00'00"	30.00'	47.12'	N44°04'28"E	42.43'
C2	92°00'00"	30.00'	48.17'	S44°55'32"E	43.16'
C3	90°00'00"	54.00'	84.82'	N44°04'28"E	76.37'
C4	92°00'00"	54.00'	86.71'	S44°55'32"E	77.69'

LINE TABLE		
NO.	BEARING	LENGTH
L1	N89°04'28"E	6.80'
L2	N89°04'28"E	42.00'
L3	N00°55'32"W	18.00'
L4	N89°04'28"E	15.00'
L5	S89°04'28"W	43.76'
L6	S00°55'32"E	11.29'
L7	S00°55'32"E	20.00'
L8	N89°04'28"E	18.00'
L9	N00°55'32"W	20.00'

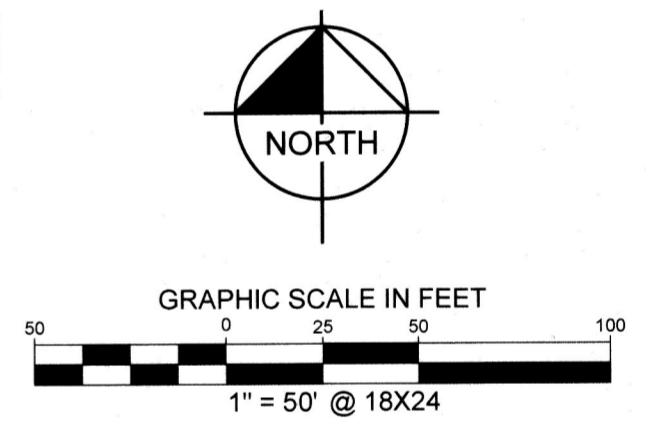

MARK, MICHAEL 8/17/2022 11:32 AM LAST SAVED 8/17/2022 9:20:27 AM

**FLOOD STATEMENT:**

According to Federal Emergency Management Agency's Flood Insurance Rate Map No. 48397C0030L, for Rockwall County, Texas and incorporated areas, dated September 26, 2008, this property is located within Zone X (unshaded) defined as "Areas determined to be outside the 0.2% annual chance floodplain"

If this site is not within an identified special flood hazard area, this flood statement does not imply that the property and/or the structures thereon will be free from flooding or flood damage. On rare occasions, greater floods can and will occur and flood heights may be increased by man-made or natural causes. This flood statement shall not create liability on the part of the surveyor.

**LEGEND:**

- R.C.A.D. = ROCKWALL COUNTY APPRAISAL DISTRICT
- P.O.B. = POINT OF BEGINNING
- IRSC = 5/8" IRON ROD W/ "KHA" CAP SET
- IRFC = IRON ROD W/CAP FOUND
- IRF = IRON ROD FOUND
- IPF = IRON PIPE FOUND
- O.P.R.R.C.T. = OFFICIAL PUBLIC RECORDS, ROCKWALL COUNTY, TEXAS

**NOTES:**

- It shall be the policy of the City of Rockwall to withhold issuing building permits until all streets, water, sewer and storm drainage systems have been accepted by the City. The approval of a plat by the City does not constitute any representation, assurance or guarantee that any building within such plat shall be approved, authorized or permit therefore issued, nor shall such approval constitute any representation, assurance or guarantee by the City of the adequacy and availability for water for personal use and fire protection within such plat, as required under Ordinance 83-54.
- All Property Corners are 5/8-inch iron rod with plastic cap stamped "KHA" found unless otherwise noted here.
- The Bearings and Coordinates shown hereon are grid values of the Texas Coordinate System of 1983, North Central Zone (4202), North American Datum of 1983 (2011).  
REFERENCE DATUM: City of Rockwall Geodetic Control Monument 4
- Property owner(s) shall be responsible for maintaining, repairing, and replacing all systems within the drainage and detention easements, if any.

OWNER:  
PS LPT Properties Investors  
701 Western Ave.  
Glendale, California 91201  
Phone: 972-546-0375  
Contact: Jarrod Yates

APPLICANT:  
Kimley-Horn and Associates, Inc.  
100 W. Oak St., Suite 203  
Denton, Texas 76201  
Phone: 940-387-3620  
Contact: Trey Braswell, P.E.

FINAL PLAT  
**PS ROCKWALL COUNTY ADDITION**  
**LOT 1, BLOCK A**  
**2.082 ACRES**  
SITUATED IN THE  
JOSEPH STRICKLAND SURVEY, ABSTRACT NO. 187  
CITY OF ROCKWALL E.T.J., ROCKWALL COUNTY, TEXAS  
CASE NO. P2022-027

## Kimley»Horn

6160 Warren Parkway, Suite 210  
Frisco, Texas 75034      FIRM # 10193822      Tel. No. (972) 335-3580  
Fax No. (972) 335-3779

Scale	Drawn by	Checked by	Date	Project No.	Sheet No.
1" = 50'	JCC	KHA	05/31/2022	069319643	1 OF 2



OWNER'S CERTIFICATE

STATE OF TEXAS §

COUNTY OF ROCKWALL §

WHEREAS PS LPT PROPERTIES INVESTORS is the owner of a tract of land situated in the Joseph Strickland Survey, Abstract No. 187, City of Rockwall E. T. J. Rockwall County, Texas and being all of a called 2.081-acre tract of land described in a Special Warranty Deed to PS LPT Properties Investors, recorded in Instrument No. 20210000031763 of the Official Public Records of Rockwall County, Texas, and being more particularly described by metes and bounds as follows:

BEGINNING at a 5/8-inch iron pipe found for the southwest corner of said 2.081-acre tract, same being the northwest corner of a called 2.672-acre tract of land described in a Warranty Deed to Daniel W. Strong and wife, Elizabeth Kay Strong, recorded in Volume 1823, Page 224 of the Official Public Records of Rockwall County, Texas, same also being on the easterly right of way line of N. Goliad Street (State Highway 205), a 100' wide right of way;

THENCE North 21°15'05" West, along the westerly line of said 2.081-acre tract and the easterly right of way line of said N. Goliad Street (State Highway 205), a distance of 150.18 feet (called 150.00 feet) to a 1/2-inch iron rod found for the northwest corner of said 2.081-acre tract, same being the southwest corner of Lot 1, Block 1 of Valk Rockwall Addition, an addition to the City of Rockwall, according to the plat, recorded in Instrument No. 2014000003303 of the Official Public Records of Rockwall County, Texas;

THENCE North 89°04'28" East, departing the easterly right of way line of said N. Goliad Street (State Highway 205), along the northerly line of said 2.081-acre tract, a distance of 670.68 feet (called 670.22 feet) to a 5/8-inch iron rod with a red plastic cap, stamped "KHA" set for the northeast corner of said 2.081-acre tract, same being on the westerly line of a called 69.22-acre tract of land described in a Warranty Deed to Shennendoah Real Estate Partners, L.P., recorded in Volume 3351, Page 114 of the Official Public Records of Rockwall County, Texas;

THENCE South 01°03'12" East, along the easterly line of said 2.081-acre tract and the westerly line of said 69.22-acre tract, a distance of 140.50 feet to a 1/2-inch iron pipe found for the southeast corner of said 2.081-acre tract, same being the northeast corner of aforesaid 2.672-acre tract;

THENCE South 89°02'39" West, along the southerly line of said 2.081-acre tract and the northerly line of said 2.672-acre tract, a distance of 618.83 feet (called 618.69 feet) to the POINT OF BEGINNING and containing 2.082 acres (90698 square feet) of land, more or less.

NOW, THEREFORE, KNOW ALL MEN BY THESE PRESENTS:

STATE OF TEXAS
COUNTY OF ROCKWALL

We, PS LPT PROPERTIES INVESTORS, the undersigned owner of the land shown on this plat, and designated herein as the PS ROCKWALL COUNTY ADDITION to the City of Rockwall, Texas, and whose name is subscribed hereto, hereby dedicate to the use of the public forever all streets, alleys, parks, watercourses, drains, easements and public places thereon shown on the purpose and consideration therein expressed, except those created by separate instrument, which are governed by the terms of such separate instruments. We further certify that all other parties who have a mortgage or lien interest in the PS ROCKWALL COUNTY ADDITION have been notified and signed this plat. We understand and do hereby reserve the easement strips shown on this plat for the purposes stated and for the mutual use and accommodation of all utilities desiring to use or using same, except those created by separate instrument, which are governed by the terms of such separate instruments. We also understand the following:

- 1. No buildings shall be constructed or placed upon, over, or across the utility easements created hereby.
2. Any public utility shall have the right to remove and keep removed all or part of any buildings, fences, trees, shrubs, or other growths or improvements which in any way endanger or interfere with construction, maintenance or efficiency of their respective system on any of the easement strips created hereby; and any public utility shall at all times have the right of ingress or egress to, from and upon the said easement strips for purpose of construction, reconstruction, inspecting, patrolling, maintaining, and either adding to or removing all or part of their respective system without the necessity of, at any time, procuring the permission of anyone.
3. The City of Rockwall will not be responsible for any claims of any nature resulting from or occasioned by the establishment of grade of streets in the subdivision.
4. The developer and subdivision engineer shall bear total responsibility for storm drain improvements.
5. The developer shall be responsible for the necessary facilities to provide drainage patterns and drainage controls such that properties within the drainage area are not adversely affected by storm drainage from the development.
6. The owners of the land dedicated by this plat reserve the right to use and enjoy the surface of all easement areas for all purposes that do not interfere with the use of said easement areas for utilities; including but not limited to the right to place surfacing materials over and across the easement areas and to use the same for parking areas, driveways, walkways, sidewalks, landscaping and/or lighting.
7. The location of easements shown hereon that are granted by separate instrument are approximate and such easements and their location are governed by the terms, provisions and conditions of the separate instrument.
8. No house dwelling unit, or other structure shall be constructed on any lot in this addition by the owner or any other person until the developer and/or owner has complied with all requirements of the Subdivision Regulations of the City of Rockwall regarding improvements with respect to the entire block on the street or streets on which property abuts, including the actual installation of streets with the required base and paving, curb and gutter, water and sewer, drainage structures, storm structures, storm sewers, and alleys, all according to the specifications of the City of Rockwall; or

Until an escrow deposit, sufficient to pay for the cost of such improvements, as determined by the city's engineer and/or city administrator, computed on a private commercial rate basis, has been made with the city secretary, accompanied by an agreement signed by the developer and/or owner, authorizing the city to make such improvements at prevailing private commercial rates, or have the same made by a contractor and pay for the same out of the escrow deposit, should the developer and/or owner fail or refuse to install the required improvements within the time stated in such written agreement, but in no case shall the City be obligated to make such improvements itself.

Such deposit may be used by the owner and/or developer as progress payments as the work progresses in making such improvements by making certified requisitions to the city secretary, supported by evidence of work done; or

We further acknowledge that the dedications and/or exaction's made herein are proportional to the impact of the Subdivision upon the public services required in order that the development will comport with the present and future growth needs of the City; We, our successors and assigns hereby waive any claim, damage, or cause of action that we may have as a result of the dedication of exactions made herein.

By: PS LPT PROPERTIES INVESTORS, a Maryland real estate investment trust

By: Jarrod Yates
Printed Name: JARROD YATES
Title: VICE PRESIDENT

STATE OF TX §
COUNTY OF Collin §

BEFORE ME, the undersigned, a Notary Public in and for the said County and State, on this day personally appeared Jarrod Yates, known to me to be the person whose name is subscribed to the foregoing instrument and acknowledged to me that he executed the same for the purpose therein expressed and under oath stated that the statements in the foregoing certificate are true.

GIVEN UNDER MY HAND AND SEAL OF OFFICE this 25th day of August 2022

Elizabeth M. Hollis
Notary Public in and for the State of TX

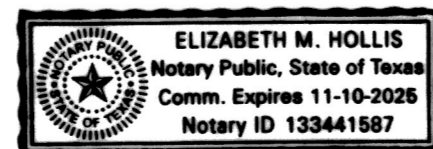

Filed and Recorded
Official Public Records
Jennifer Fogg, County Clerk
Rockwall County, Texas
09/29/2022 10:27:47 AM
\$100.00
20220000021657



Signature of Jennifer Fogg

SURVEYOR'S STATEMENT

I, Michael B. Marx, a Registered Professional Land Surveyor, licensed by the State of Texas, affirm that this plat was prepared under my direct supervision, from recorded documentation, evidence collected on the ground during field operations and other reliable documentation; and that this plat substantially complies with the Rules and Regulations of the Texas Board of Professional Engineers and Land Surveyors.

Dated this the 26th day of August, 2022.

Signature of Michael B. Marx
MICHAEL B. MARX
REGISTERED PROFESSIONAL
LAND SURVEYOR NO. 5181
6160 WARREN PKWY., SUITE 210
FRISCO, TEXAS 75034
PH. (972) 335-3580
michael.marx@kimley-horn.com



APPROVED BY THE ROCKWALL COUNTY COMMISSIONERS COURT

ON THIS THE 26 DAY OF September, 2022

Signature of County Judge
COUNTY JUDGE

RECOMMENDED FOR FINAL APPROVAL
Signature of Planning & Zoning Commission Chairman
Date: 9/27/22
APPROVED:
I hereby certify that the above and foregoing plat of an addition to the City of Rockwall, Texas, was approved by the City Council of the City of Rockwall on the 20 day of June, 2022.
This approval shall be invalid unless the approved plat for such addition is recorded in the office of the County Clerk of Rockwall, County, Texas, within one hundred eighty (180) days from said date of final approval.
WITNESS OUR HANDS, this 27th day of September, 2022.
Signatures of Mayor, City Secretary, and City Engineer.

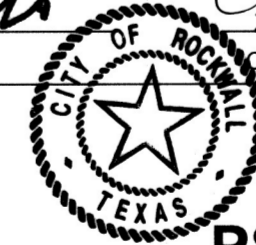

FINAL PLAT
PS ROCKWALL COUNTY ADDITION
LOT 1, BLOCK A
2.082 ACRES
SITUATED IN THE
JOSEPH STRICKLAND SURVEY, ABSTRACT NO. 187
CITY OF ROCKWALL E.T.J., ROCKWALL COUNTY, TEXAS
CASE NO. P2022-027

OWNER:
PS LPT Properties Investors
701 Western Ave.
Glendale, California 91201
Phone: 972-546-0375
Contact: Jarrod Yates

APPLICANT:
Kimley-Horn and Associates, Inc.
100 W. Oak St., Suite 203
Denton, Texas 76201
Phone: 940-387-3620
Contact: Trey Braswell, P.E.

Table with 6 columns: Scale, Drawn by, Checked by, Date, Project No., Sheet No.
Scale: N/A, Drawn by: JCC, Checked by: KHA, Date: 05/31/2022, Project No.: 069319643, Sheet No.: 2 OF 2

DWG NAME: K:\FRL\_SURVEY\069319643-4000 N SH 205 - ROCKWALL\DWG\069319643-SH 205 FP\_VER20.DWG PLOTTED BY: MARX, MICHAEL 8/17/2022 11:32 AM LAST SAVED: 8/17/2022 6:37 AM