

5011
 FINAL PLAT
HOARDSTROMS ADDITION
LOT 1, BLOCK A
 REPLAT OF
 W.D. AUSTIN ADDITION
 PART OF LOT 1
 0.47 ACRES (1 LOT)
 S.S. MCCURRY SURVEY, A-146
 AN ADDITION TO THE CITY OF ROCKWALL
 ROCKWALL COUNTY, TEXAS

- NOTES**
- 1) According to F.E.M.A. Flood Insurance Rate Map, Community Panel No. 48397C0030 L dated Sept. 26, 2008, this property lies in Zone X. This property does not appear to lie within a 100-year flood plain.
 - 2) BEARING SOURCE: RECORDED DEED IN VOL. 612, P. 209, R.P.R.R.C.T.
 - 3) ALL 1/2" IRS ARE CAPPED WITH YELLOW PLASTIC CAPS "R.S.C.I. RPLS 5034."

OWNER:
 ANDREA HOLLIMAN
 11007 E. MOFFAT
 MEAD, WA 99021

H.D. Fetty Land Surveyor, LLC
 Firm Registration no. 101509-00
 6770 FM 1565 ROYSE CITY, TX 75189 972-635-2255 PHONE tracy@hdfetty.com

SHEET 1 OF 2
 SURVEY DATE FEBRUARY 13, 2015
 SCALE 1" = 30' FILE# 921085-RP3
 CLIENT HOLLIMAN

Hoardstroms Addition
 Lot 1, Block A
 Replat

OWNER'S CERTIFICATE
(Public Dedication)

STATE OF TEXAS
COUNTY OF ROCKWALL

WHEREAS, ANDREA HOLLIMAN, BEING THE OWNER OF A TRACT
OF land in the County of Rockwall, State of Texas, said tract being described as follows:

All that certain lot, tract, parcel of land situated in the S.S. McCURRY SURVEY, ABSTRACT NO. 146, Rockwall County, Texas, and being a part of Lot 1 of W.D. AUSTIN ADDITION, an Addition to the City of Rockwall, Texas, according to the Plat thereof recorded in Volume 0, Page 536 and 537 of the Plat Records of Rockwall County, Texas, and being more particularly described as follows:

BEGINNING at a 1/2" iron rod found for corner at the Northwest corner of Lot 1 and same being the Southeast corner of Lot 2;

THENCE N. 87 deg. 30 min. 28 sec. E. along the South line of Lot 2, a distance of 220.69 feet to a 1/2" iron rod found for corner;

THENCE S 01 deg. 28 min. 03 sec. E. a distance of 139.26 feet, to an "X" set in a concrete driveway apron at the North right-of-way line of Heath Street;

THENCE S. 88 deg. 31 min. 57 sec. W. along the North right-of-way line of Heath Street, a distance of 68.30 feet to a 1/2" iron rod with yellow plastic cap stamped "R.S.C.I. RPLS 5034" found for corner;

THENCE N. 02 deg. 05 min. 05 sec. W. a distance of 66.74 feet to a 1/2" iron rod with yellow plastic cap stamped "R.S.C.I. RPLS 5034" found for corner at the base of a fence corner post;

THENCE N. 88 deg. 59 min. 35 sec. W. along a wood board fence line, a distance of 75.15 feet to a 1/2" iron rod with yellow plastic cap stamped "R.S.C.I. RPLS 5034" found for corner at the base of a fence corner post;

THENCE S. 02 deg. 29 min. 29 sec. W. along a wood board fence line, a distance of 3.90 feet to a 1/2" iron rod with yellow plastic cap stamped "R.S.C.I. RPLS 5034" found for corner at the base of a fence corner post;

THENCE S. 89 deg. 12 min. 27 sec. W. a distance of 77.40 feet to a 1/2" iron rod with yellow plastic cap stamped "R.S.C.I. RPLS 5034" found for corner in the East right-of-way line of State Highway 205 (N. Goliad);

THENCE N. 00 deg. 32 min. 36 sec. W. along the East right-of-way line of State Highway 205 (N. Goliad), a distance of 68.32 feet to the POINT OF BEGINNING and containing 19,960 square feet or 0.47 acres of land.

NOW, THEREFORE, KNOW ALL MEN BY THESE PRESENTS:

STATE OF TEXAS
COUNTY OF ROCKWALL

I the undersigned owner of the land shown on this plat, and designated herein as HOARDSTROMS ADDITION LOT 1, BLOCK A, an Addition to the City of Rockwall, Texas, and whose name is subscribed hereto, hereby dedicate to the use of the public forever all streets, alleys, parks, water courses, drains, easements and public places thereon shown on the purpose and consideration therein expressed. I further certify that all other parties who have a mortgage or lien interest in the subdivision have been notified and signed this plat.

I understand and do hereby reserve the easement strips shown on this plat for the purposes stated and for the mutual use and accommodation of all utilities desiring to use or using same.

I also understand the following:

- No buildings shall be constructed or placed upon, over, or across the utility easements as described herein.
- Any public utility shall have the right to remove and keep removed all or part of any buildings, fences, trees, shrubs, or other growths or improvements which in any way endanger or interfere with construction, maintenance or efficiency of their respective system on any of these easement strips; and any public utility shall at all times have the right of ingress or egress to, from and upon the said easement strips for purpose of construction, reconstruction, inspecting, patrolling, maintaining, and either adding to or removing all or part of their respective system without the necessity of, at any time, procuring the permission of anyone.
- The City of Rockwall will not be responsible for any claims of any nature resulting from or occasioned by the establishment of grade of streets in the subdivision.
- The developer and subdivision engineer shall bear total responsibility for storm drain improvements.
- The developer shall be responsible for the necessary facilities to provide drainage patterns and drainage controls such that properties within the drainage area are not adversely affected by storm drainage from the development.
- No house dwelling unit, or other structure shall be constructed on any lot in this addition by the owner or any other person until the developer and/or owner has complied with all requirements of the Subdivision Regulations of the City of Rockwall regarding improvements with respect to the entire block on the street or streets on which property abuts, including the actual installation of streets with the required base and paving, curb and gutter, water and sewer, drainage structures, storm structures, storm sewers, and alleys, all according to the specifications of the City of Rockwall; or

Until an escrow deposit, sufficient to pay for the cost of such improvements, as determined by the city's engineer and/or city administrator, computed on a private commercial rate basis, has been made with the city secretary, accompanied by an agreement signed by the developer and/or owner, authorizing the city to make such improvements at prevailing private commercial rates, or have the same made by a contractor and pay for the same out of the escrow deposit, should the developer and/or owner fail or refuse to install the required improvements within the time stated in such written agreement, but in no case shall the City be obligated to make such improvements itself. Such deposit may be used by the owner and/or developer as progress payments as the work progresses in making such improvements by making certified requisitions to the city secretary, supported by evidence of work done; or

Until the developer and/or owner files a corporate surety bond with the city secretary in a sum equal to the cost of such improvements for the designated area, guaranteeing the installation thereof within the time stated in the bond, which time shall be fixed by the city council of the City of Rockwall.

I further acknowledge that the dedications and/or exaction's made herein are proportional to the impact of the subdivision upon the public services required in order that the development will comport with the present and future growth needs of the City; I, my successors and assigns hereby waive any claim, damage, or cause of action that I may have as a result of the dedication of exaction's made herein.

Andrea Holliman
ANDREA HOLLIMAN

STATE OF TEXAS
COUNTY OF ROCKWALL

Before me, the undersigned authority, on this day personally appeared ANDREA HOLLIMAN known to me to be the person whose name is subscribed to the foregoing instrument, and acknowledged to me that he executed the same for the purpose and consideration therein stated.

Given upon my hand and seal of office this 25 day of August, 2016.

Matthew P. Kees
Notary Public in and for the State of Texas

Matthew P. Kees
My Commission Expires: 01/08/2017



Filed and Recorded
Official Public Records
Shelli Miller, County Clerk
Rockwall County, Texas
09/16/2016 02:10:11 PM
\$100.00
20160000016279



Shelli Miller

COPY

OWNER:
ANDREA HOLLIMAN
11007 E. MOFFAT
MEAD, WA 99021

H.D. Fetty Land Surveyor, LLC

Firm Registration no. 101509-00
6770 FM 1565 ROYSE CITY, TX 75189 972-635-2255 PHONE tracy@hdfetty.com

SHEET 2 OF 2

SURVEY DATE FEBRUARY 13, 2015
SCALE 1" = 30' FILE# 991085-RP3
CLIENT HOLLIMAN

NOTE: It shall be the policy of the City of Rockwall to withhold issuing building permits until all streets, water, sewer and storm drainage systems have been accepted by the City. The approval of a plat by the City does not constitute any representation, assurance or guarantee that any building within such plat shall be approved, authorized or permit therefore issued, nor shall such approval constitute any representation, assurance or guarantee by the City of the adequacy and availability for water for personal use and fire protection within such plat, as required under Ordinance 83-54.

SURVEYOR'S CERTIFICATE

NOW, THEREFORE KNOW ALL MEN BY THESE PRESENTS:

THAT I, Harold D. Fetty, III, R.P.L.S. No. 5034, do hereby certify that I prepared this plat from an actual and accurate survey of the land, and that the corner monuments shown thereon were properly placed under my personal supervision.

Harold D. Fetty, III
Harold D. Fetty, III
Registered Professional Land Surveyor No. 5034

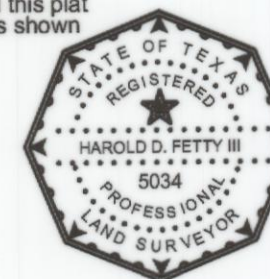

RECOMMENDED FOR FINAL APPROVAL

Christy Cole
Planning and Zoning Commission Date

APPROVED

I hereby certify that the above and foregoing plat of HOARDSTROMS ADDITION, LOT 1, BLOCK A, an addition to the City of Rockwall, Texas, was approved by the City Council of the City of Rockwall on the 1 day of March, 2016.

This approval shall be invalid unless the approved plat for such addition is recorded in the office of the County Clerk of Rockwall, County, Texas, within one hundred eighty (180) days from said date of final approval.

Said addition shall be subject to all the requirements of the Subdivision Regulations of the City of Rockwall.

WITNESS OUR HANDS, this 16th day of Sept., 2016.

Tom Pruitt
Mayor, City of Rockwall

Christy Cole
City Secretary, City of Rockwall



Tom Pruitt
City Engineer

5012
FINAL PLAT
HOARDSTROMS ADDITION
LOT 1, BLOCK A

REPLAT OF
W.D. AUSTIN ADDITION
PART OF LOT 1

0.47 ACRES (1 LOT)
S.S. MCCURRY SURVEY, A-146
AN ADDITION TO THE CITY OF ROCKWALL
ROCKWALL COUNTY, TEXAS

Hoardstroms Addition
Lot 1, Block A
Replat