

NOTES:
 1. THE FOOTCANDLE LEVELS AS SHOWN ARE BASED ON THE FOLLOWING CRITERIA. ANY SUBSTITUTIONS IN SPECIFIED FIXTURES OR CHANGES TO LAYOUT WILL AFFECT LIGHTING LEVELS SHOWN AND WILL NOT BE THE RESPONSIBILITY OF SECURITY LIGHTING.
 2. DISTANCE BETWEEN READINGS 10'

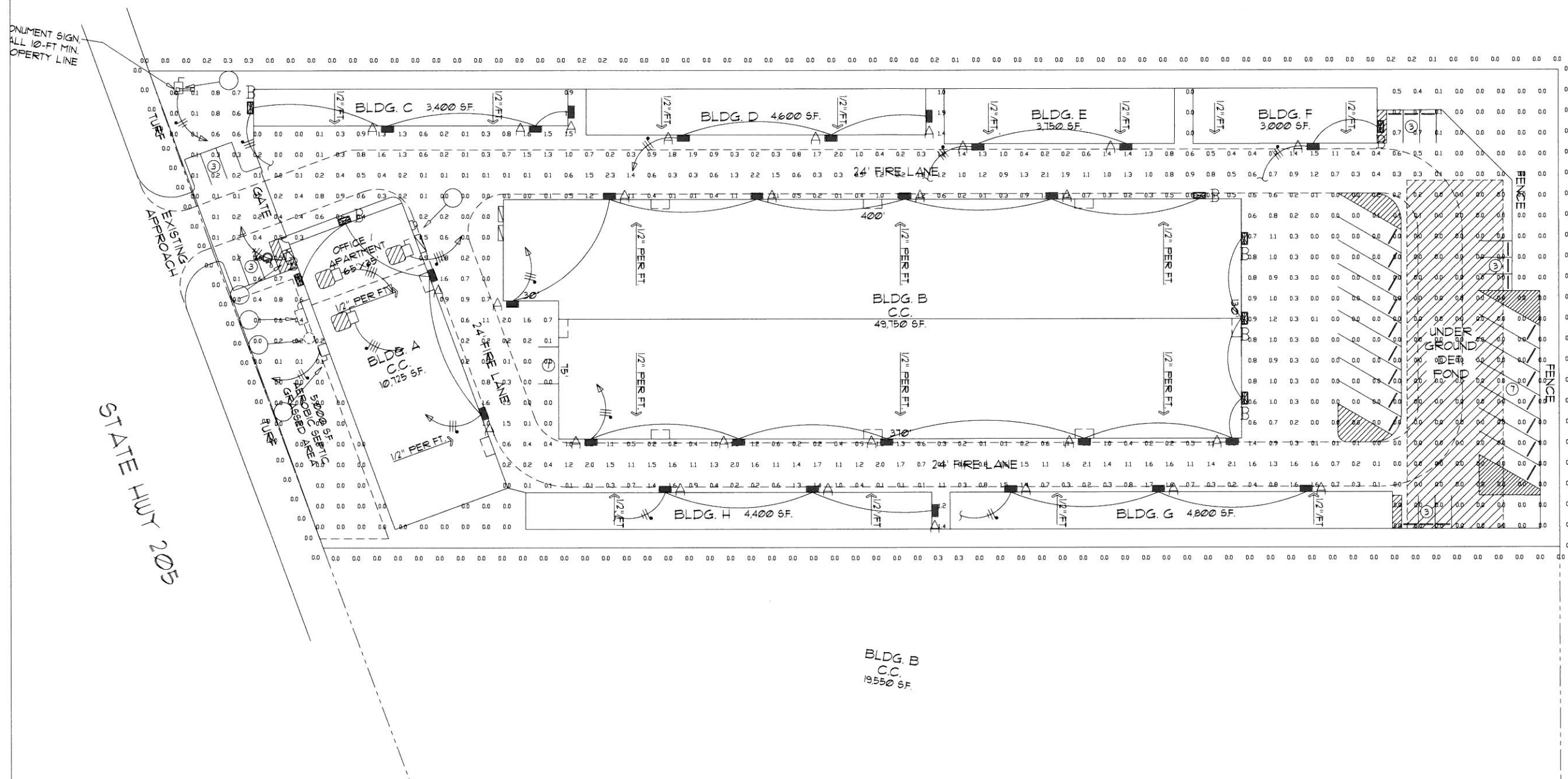

SUMMARY
 713 points at z=0, sp 10ft by 10ft
HORIZONTAL FOOTCANDLES
 Average 0.4
 Maximum 2.3
 Minimum 0.0
 AvgMin N/A
 MaxMin N/A
 Coef Var 1.25
 UnifGrad N/A

PROPERTY LINE READINGS
 179 points
HORIZONTAL FOOTCANDLES
 Average 0.0
 Maximum 0.3
 Minimum 0.0
 AvgMin N/A
 MaxMin N/A
 Coef Var 3.93

■ LNC-SLU-5K-3
 Candela File 'LNC-SLU-5K-3ies'
 1 lamp(s) per luminaire, photometry is absolute
 Light Loss Factor = 0.900, watts per luminaire = 13
 mounting height = 9 ft
 number locations = 27, number luminaires = 27
 * all locations = 03

■ LNC-SLU-5K-3
 Candela File 'LNC-SLU-5K-3ies'
 1 lamp(s) per luminaire, photometry is absolute
 Light Loss Factor = 0.900, watts per luminaire = 13
 mounting height = 14 ft
 number locations = 8, number luminaires = 8
 * all locations = 01

BLDG. B
 C.C.
 19,550 SF.

SECURITY LIGHTING
 2100 Bell Road, Suite 400, Dallas, Texas, TX 75244
 (972) 244-0888

WHITEWAY

UNLESS OTHERWISE SPECIFIED, ALL DIMENSIONS ARE IN INCHES

SCALE 1" = 25' 0"

DRAWN BY MW

POINT-BY-POINT FOOTCANDLE PLOT FOR
 PLATINUM SELF STORAGE
 4028 N HIGHWAY 205
 ROCKWALL, TX

DATE 5/17/19 DRAWING NUMBER 42432A

1. THIS LIGHTING DESIGN IS BASED ON INFORMATION SUPPLIED BY OTHERS TO SECURITY LIGHTING SYSTEMS. SITE DETAILS PROVIDED HEREON ARE REPRODUCED ONLY AS A VISUALIZATION AND FIELD DEVIATIONS MAY SIGNIFICANTLY AFFECT PREDICTED PERFORMANCE. PRIOR TO INSTALLATION, CRITICAL SITE INFORMATION (POLE LOCATIONS, ORIENTATION, MOUNTING HEIGHT, ETC.) SHOULD BE COORDINATED WITH THE CONTRACTOR AND/OR SPECIFIER RESPONSIBLE FOR THE PROJECT.

2. LUMINAIRE DATA IS TESTED TO INDUSTRY STANDARDS UNDER LABORATORY CONDITIONS. OPERATING VOLTAGE AND NORMAL MANUFACTURING TOLERANCES OF LAMP, BALLAST, AND LUMINAIRE MAY AFFECT FIELD RESULTS.

3. CONFORMANCE TO FACILITY CODE AND OTHER LOCAL REQUIREMENTS IS THE RESPONSIBILITY OF THE OWNER AND/OR THE OWNER'S REPRESENTATIVE.

4. THIS LAYOUT MAY NOT MEET TITLE 24 OR LOCAL ENERGY REQUIREMENTS. IF THE LAYOUT NEEDS TO BE COMPLIANT WITH TITLE 24 OR OTHER ENERGY REQUIREMENTS, PLEASE CONSULT FACTORY WITH SPECIFIC DETAILS REGARDING PROJECT REQUIREMENTS SO THAT REVISIONS MAY BE MADE TO THE DRAWING.

<h1>LNC SERIES</h1>	Cat.#		
	Job	Type	
			Approvals

SPECIFICATIONS

Intended Use:

The compact LED LNC is designed for entry/perimeter illumination for safety, security and identity. Typical mounting height is up to 12 feet with 40ft fixture spacing (without acrylic diffuser) and 30ft spacing with acrylic diffuser installed. Photocontrol option is available to provide dusk-to-dawn control for additional energy savings.

Construction:

Decorative die-cast aluminum housing and door. Rugged design protects internal components and provides excellent thermal management for long life – 60,000 hours minimum LED life at L96 rating per IESNA TM-21-11. Powder paint finishes provide lasting appearance in outdoor environments.

Optics/Electrical

LED:

Drivers are 120-277V, 50/60Hz Type II, III and Type IV lenses provide wide lateral spread.

0-10V dimming 120-277V only.

- LNC5L – 5 LEDs, Types II, III or IV available, see page 2 for electrical details
- LNC7L – 7 LEDs, Type II, III or IV available, see page 2 for electrical details
- LNC9L – 9 LEDs, Types II, III or IV available, see page 2 for electrical details
- 3000K - 80 CRI, 4000K - 70 CRI, and 5000K - 70 CRI, CCT nominal
- Minimum operating temperature is -40°C/-40°F
- Drivers have greater than .90 power factor and less than 20% Total Harmonic Distortion

Lenses:

Full cut-off distribution; Ambient diffuser included, use for applications near entrances or locations where reduced brightness is desired.

Installation:

Quick mount adapter provides quick installation, designed for recessed box 4" square junction box.

Listings:

Listed and labeled to UL 1598 for wet locations, 25° C ambient environments. DesignLights Consortium® (DLC) qualified. Please refer to the DLC website for specific product qualifications at:

<http://www.designlights.org/>

- IES Progress Award Winner - 2012

Warranty:

Five year limited warranty. For more information visit: <http://www.hubbelloutdoor.com/resources/warranty/>

PRODUCT IMAGE(S)



LNC-5L

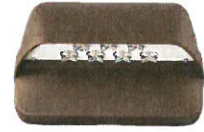

LNC-7L



LNC-9L



With diffuser



DIMENSIONS

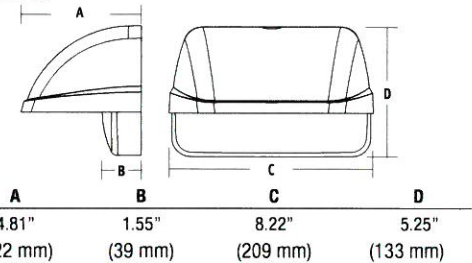

SHIPPING INFORMATION

Catalog Number	G.W(kg)/CTN	Carton Dimensions			Carton Qty. per Master Pack
		Length Inch (cm)	Width Inch (cm)	Height Inch (cm)	
LNC-5LU	9.6 (4.36)	14.5 (37)	9.6 (24.5)	6.8 (17.5)	2
LNC-7LU	9.6 (4.36)	14.5 (37)	9.6 (24.5)	6.8 (17.5)	2
LNC-9LU	9.6 (4.36)	14.5 (37)	9.6 (24.5)	6.8 (17.5)	2

CERTIFICATIONS/LISTINGS



ORDERING INFORMATION

ORDERING EXAMPLE: LNC-9LU-5K-3-1-PCU

SERIES	NUMBER OF LEDs	VOLTAGE	CCT	IES DISTRIBUTION	FINISH	OPTIONS
LNC	5L 5 LEDs 7L 7 LEDs 9L 9 LEDs	U 120V-277V 1 120V 2 208V 3 240V 4 277V	3K 3000K nominal, 70 CRI 4K 4000K nominal, 70 CRI 5K 5000K nominal	2 Type II 3 Type III 4 Type IV	1 Bronze 2 Black 3 Gray 4 White 5 Platinum	PCU Universal Button PhotoCell
<p>AM¹: Amber (590 nm) available for "Turtle Friendly"/observatory applications, 350 mA (consult factory)</p>						

¹ Amber LEDs only available on 7LU and 9LU configurations, 350 mA only

REPLACEMENT PART

CATALOG NUMBER	DESCRIPTION
93039574	Frosted comfort shield, improved uniformity with only 5% reduction

PHOTOMETRICS

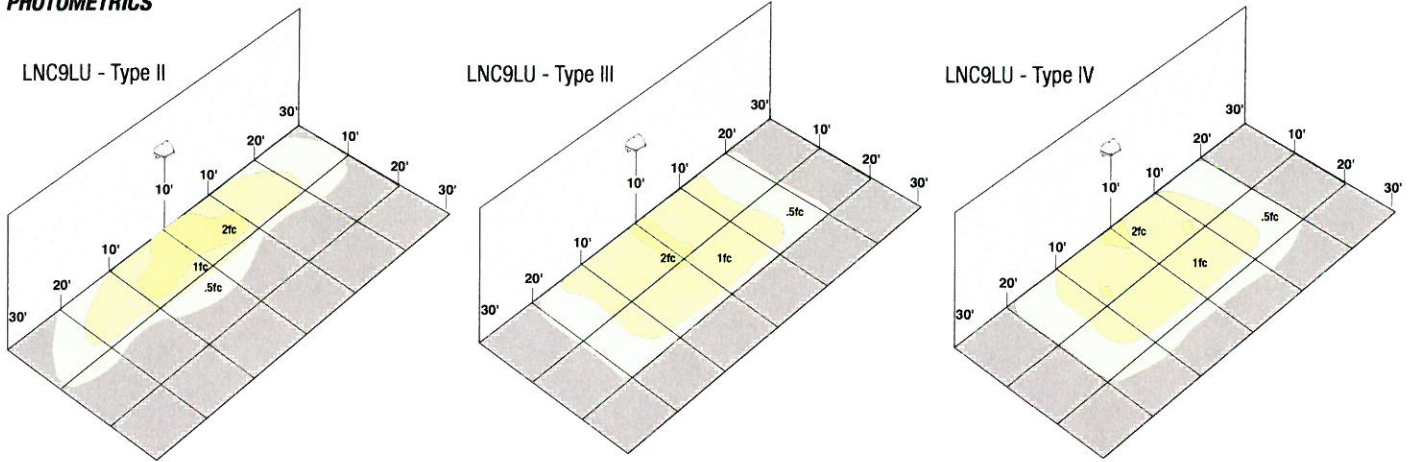

PERFORMANCE DATA

# OF LEDS	DRIVE CURRENT	SYSTEM WATTS	DIST. TYPE	5K (5000K nominal, 70 CRI)		4K (4000K nominal, 70 CRI)		3K (3000K nominal, 80 CRI)		AM (<580 nm wave-length)		
				LUMENS	LPW ¹	LUMENS	LPW ¹	LUMENS	LPW ¹	LUMENS	SYSTEM WATTS	LPW ¹
5	STD. (700mA) AM (350mA)	13W	2	1,150	88.5	1,052	81	883	68			
			3	1,132	87	1,077	83	833	64			
			4	1,146	88	1,053	81	849	65			
7		17W	2	1,515	89	1,369	80.5	1,272	75			
			3	1,500	88	1,539	90.5	1,392	82	268	6.6	59
			4	1,557	91.5	1,535	90	1,425	84			
9	22W	2	2,069	94	2,033	92	1,588	72				
		3	2,024	92	1,989	90	1,623	74				
		4	2,095	95	2,059	93.5	1,680	76	382	8.3	46	

Lumen values are from photometric tests performed in accordance with IESNA LM-79-08. Data is considered to be representative of the configurations shown. Actual performance may differ as a result of end-user environment and application. Please consult IES files for BUG ratings.

PROJECTED LUMEN MAINTENANCE

Ambient Temp.	OPERATING HOURS					
	0	25,000	50,000	TM-21-11 ¹ L96 60,000	100,000	L70 (hours)
25°C / 77°F	1.00	0.98	0.97	0.96	0.95	>791,000
40°C / 104°F	0.99	0.98	0.96	0.96	0.94	>635,000

1. Projected per IESNA TM-21-11 * (Nichia 219B, 700mA, 85°C Ts, 10,000hrs)
Data references the extrapolated performance projections for the LNC-12LU-5K base model in a 40°C ambient, based on 10,000 hours of LED testing per IESNA LM-80-08.

LUMINAIRE AMBIENT TEMPERATURE FACTOR (LATF)

AMBIENT TEMPERATURE		LUMEN MULTIPLIER
0° C	32° F	1.02
10° C	50° F	1.01
20° C	68° F	1.00
25° C	77° F	1.00
30° C	86° F	1.00
40° C	104° F	0.99
50° C	122° F	0.98

Use these factors to determine relative lumen output for average ambient temperatures from 0-50°C (32-122°F).

ELECTRICAL DATA

# OF LEDS	DRIVE CURRENT (mA)	DRIVE CURRENT (mA)	INPUT VOLTAGE (V)	CURRENT (Amps)	SYSTEM POWER (w)
5	1	STD. (700mA)	120	0.11	13
			277	0.05	13
7	1	STD. (700mA)	120	0.14	17
			277	0.07	17
9	1	STD. (700mA)	120	0.17	22
			277	0.09	22



Hubbell Outdoor Lighting • 701 Millennium Boulevard • Greenville, SC 29607 • Phone: 864-678-1000

Due to our continued efforts to improve our products, product specifications are subject to change without notice.

© 2016 HUBBELL OUTDOOR LIGHTING, All Rights Reserved • For more information visit our website: www.hubbelloutdoor.com • Printed in USA

LAREDOLNC-SPEC

AUGUST 30, 2017 4:47 PM