

DESCRIPTION
 BEING Lot 5, Block B of ROCKWALL 205 BUSINESS PARK ADDITION, an Addition to the City of Rockwall, Rockwall County, Texas, according to the Plat thereof recorded in Cabinet C, Slide 8, of the Plat Records of Rockwall County, Texas.

- NOTES**
- 1) According to F.E.M.A. Flood Insurance Rate Map, Community Panel No. 48397C0030 L dated Sept. 26, 2008, this property lies in Zone X. This property does not appear to lie within a 100-year flood plain.
 - 2) BEARING SOURCE: RECORDED PLAT.
 - 3) ALL 1/2" IRS ARE CAPPED WITH YELLOW PLASTIC CAPS "RPLS 5034."

SURVEYOR'S CERTIFICATE
 I, Harold D. Fetty, III, Registered Professional Land Surveyor No. 5034, do hereby certify that the above plat of the property surveyed for James Meade at 496 National Drive, Rockwall, Rockwall County, Texas, is the result of a careful collection of the best evidence available to me and my opinion is based on the facts as found at the time of survey. This survey meets the requirements of the Minimum Standards of Practice as approved and published by the Texas Board of Professional Land Surveying, effective September 1, 1992 and subsequent revisions, and the same was surveyed under my supervision on the ground this the 7th day of July, 2016.

Harold D. Fetty III, R.P.L.S. No. 5034

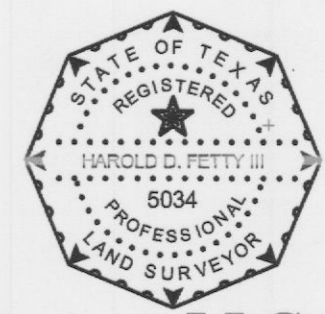

TV	GAS	TEL	PH	PP
CABLE TIE	WATER	POLE	HYDRANT	POWER POLE
ELEC	ELEC	WATER	LIGHT	1/2" IRF
WATER	WATER	WATER	WATER	1/4" IRF
JUNCTION BOX	WATER	WATER	WATER	(CORNER)
	EXHIBIT LANE			

SURVEY ACCEPTED BY:
 _____ DATE _____
 _____ DATE _____

PROPOSED SITE PLAN & SURVEY

H.D. Fetty Land Surveyor, LLC
 Firm Registration no. 101509-00
 6770 FM 1565 ROYSE CITY, TX 75189 972-635-2255 PHONE tracy@hdfetty.com