

**LEGEND**

- PROPOSED CURB AND GUTTER
- CART CORRAL
- WALMART PROPERTY LINE
- PROPOSED FIRE LINE
- PROPOSED UNDERGROUND ELECTRIC
- PROPOSED FIBER LINE
- PROPOSED WATER LINE
- PROPOSED SANITARY SEWER LINE
- PROPOSED GAS LINE
- EXISTING OVERHEAD ELECTRIC
- PROPOSED STORM SEWER
- PROPOSED LIGHT POLE
- STANDARD DUTY CONCRETE: SEE 'CONCRETE PAVEMENT PLAN' FOR MATERIALS
- HEAVY DUTY CONCRETE: SEE 'CONCRETE PAVEMENT PLAN' FOR MATERIALS
- ARCHITECTURAL CONCRETE APRON (SEE ARCH. PLANS)
- STANDARD DUTY CONCRETE FOR SIDEWALKS AND ISLAND BUFFER

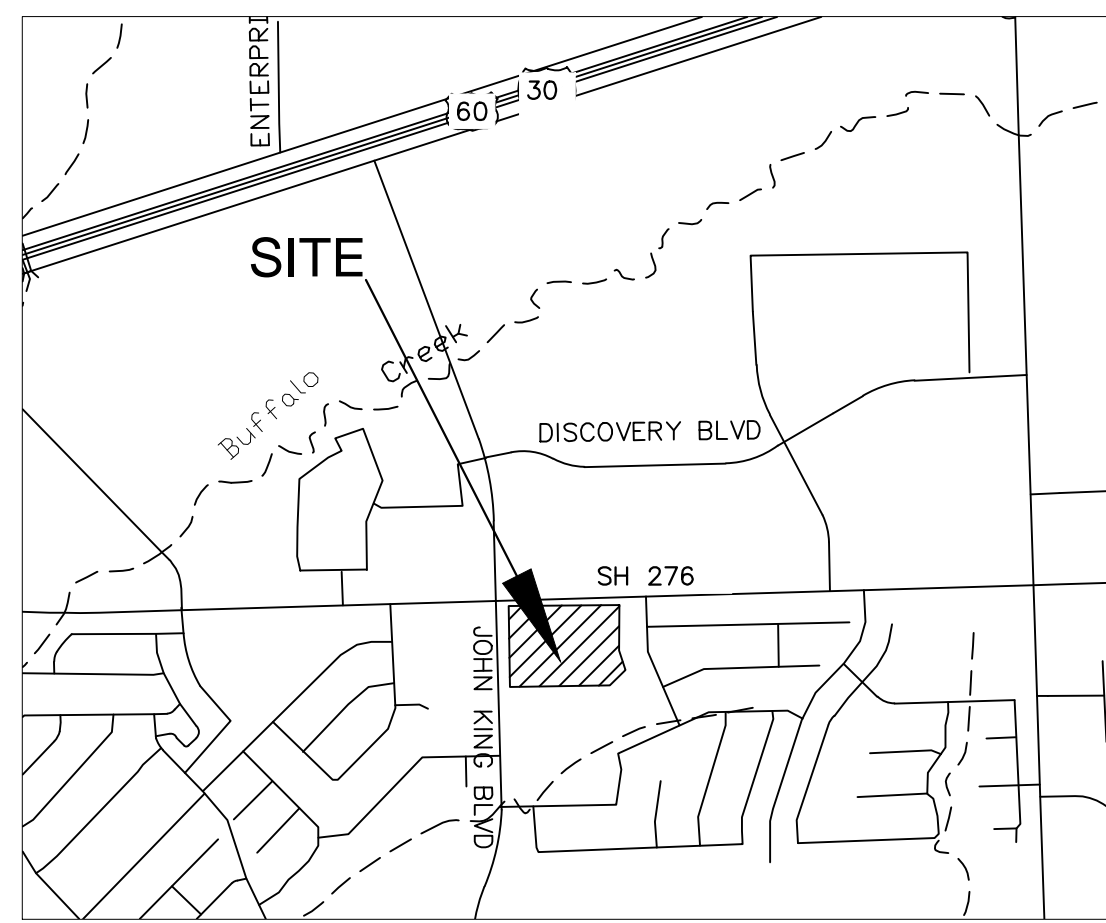

SITE LOCATION MAP  
N.T.S.

SITE PLAN  
OF  
**WALMART STORE #4604-00**  
LOT 1, BLOCK 1, LOFLAND FARMS RETAIL ADDITION  
IN THE CITY OF ROCKWALL  
ROCKWALL COUNTY, TEXAS  
6.26 ACRES  
ZONED: PD

**OWNER**  
LOFLAND FARMS, LTD  
DON HOLLOWAY  
P.O. BOX 360399  
DALLAS, TEXAS 75336  
PHONE: (972) 557-3494

**ENGINEER/SURVEYOR**  
KIMLEY-HORN AND ASSOCIATES, INC.  
12012 WICKCHESTER LANE, SUITE 500  
HOUSTON, TEXAS 77079  
PHONE: (281) 920-6314

**DEVELOPER**  
WALMART REAL ESTATE BUSINESS TRUST  
2001 S.E. 10TH STREET, SWDC  
BENTONVILLE, AR 72716-0550  
PHONE: (479) 273-4000

SITE LEGEND	
(M)	ACCESSIBLE PARKING SPACE TYPICAL. SEE DETAIL SHEET FOR ACCESSIBLE PARKING SPACE SIZE, SIGN AND SYMBOL ("VAN" INDICATES VAN ACCESSIBLE SPACE).
(P)	CART CORRAL TYPICAL. SEE DETAIL SHEET FOR CART CORRAL DETAIL. (SAM'S CART CORRAL LOCATIONS ARE FIXED AND MUST BE CONFIRMED WITH SAM'S MANAGEMENT).
(X)	ORGANIC BIN AREA, BALE AND PALLET AREA WITH GATE

PARKING DATA TABLE - LOT 1	
WALMART NEIGHBORHOOD MARKET	41,921 S.F.
PARKING (ASSOCIATES AND CUSTOMER)	162 SPACES
ACCESSIBLE	6 SPACES
TOTAL PARKING	168 SPACES
REQUIRED PARKING	168 SPACES
RATIO	4,001,000 S.F. (1 SPACE/250 S.F.)
*CART CORRAL	6 CORRALS / 6 SPACES

\*PARKING SPACES OBSTRUCTED BY CART CORRALS ARE NOT INCLUDED IN OVERALL PARKING RATIO.

SITE DATA TABLE - LOT 1	
PROPOSED PLAT:	LOT 1, 5.52 AC. WALMART NEIGHBORHOOD MARKET
LOFLAND FARMS RETAIL ADDITION BLOCK 1	LOT 2, 0.74 AC. WALMART FUEL STATION
	LOT 3, 1.16 AC. OUTPARCEL FOR FUTURE DEVELOPMENT
	LOT 4, 4.45 AC. OUTPARCEL FOR FUTURE DEVELOPMENT
TOTAL SITE AREA	6.26 AC. (272,686 S.F.)
ZONING	PLANNED DEVELOPMENT (PD-45) SH 205 BY-OV SH276 OVERLAY DISTRICT
PROPOSED USE	GROCERY
MAX. LIGHT POLE HEIGHT	20'-0"
EXISTING PROTECTED TREES	NO TREES

CASE NUMBER:

**Kimley»Horn**  
12012 WICKCHESTER LANE, HOUSTON, TX 77079  
© 2014 KIMLEY-HORN AND ASSOCIATES, INC.  
PHONE: 281-597-9300 FAX: 281-597-8032  
CERTIFICATION OF AUTHORIZATION F-928  
WWW.KIMLEY-HORN.COM

SCALE: AS NOTED  
DESIGNED BY: CPB  
DRAWN BY: KJA  
CHECKED BY: SCF

**LOT 1 SITE PLAN**

**Walmart** STORE #4604-00  
ROCKWALL, TEXAS  
WAL-MART REAL ESTATE BUSINESS TRUST  
ROCKWALL, TEXAS

DATE: OCTOBER 2014  
PROJECT NO.: 063362537  
SHEET NUMBER:

**6105**



<b>Building Calculations:</b>	
P124 = Meadowlark	
P101 = Dromedary Camel	
<b>FRONT:</b>	
Stone Veneer - 1134.23 SF = 20% Stone	
P124 Split Face - 724.9 SF	
P101 Split Face - 2314.5 SF	
EIFS E83 - 733.6 SF	
Awning - 16 LF	
<b>REAR:</b>	
Stone Veneer - 229.0 SF	
P124 Split Face - 3156.7 SF	
P101 Split Face - 2480.8 SF	
<b>RIGHT:</b>	
Stone Veneer - 362.7 SF	
P124 Split Face - 2094.2 SF	
P101 Split Face - 1300.4 SF	
<b>LEFT:</b>	
Stone Veneer - 947.9 SF = 22% Stone	
P124 Split Face - 2285.5 SF	
P101 Split Face - 1558.2 SF	
Awning - 49 LF	



Rockwall (E), TX #4604

Elevations

	October 10, 2014	4
--	------------------	---

DESIGN REPRESENTATION ONLY - NOT FOR CONSTRUCTION The building images shown are a representation of the current design intent only. The building images may not reflect variations in color, tone, hue, tint, shading, ambient light intensity, materials, texture, contrast, font style, construction variations required by building codes or inspectors, materials or final design detailing.

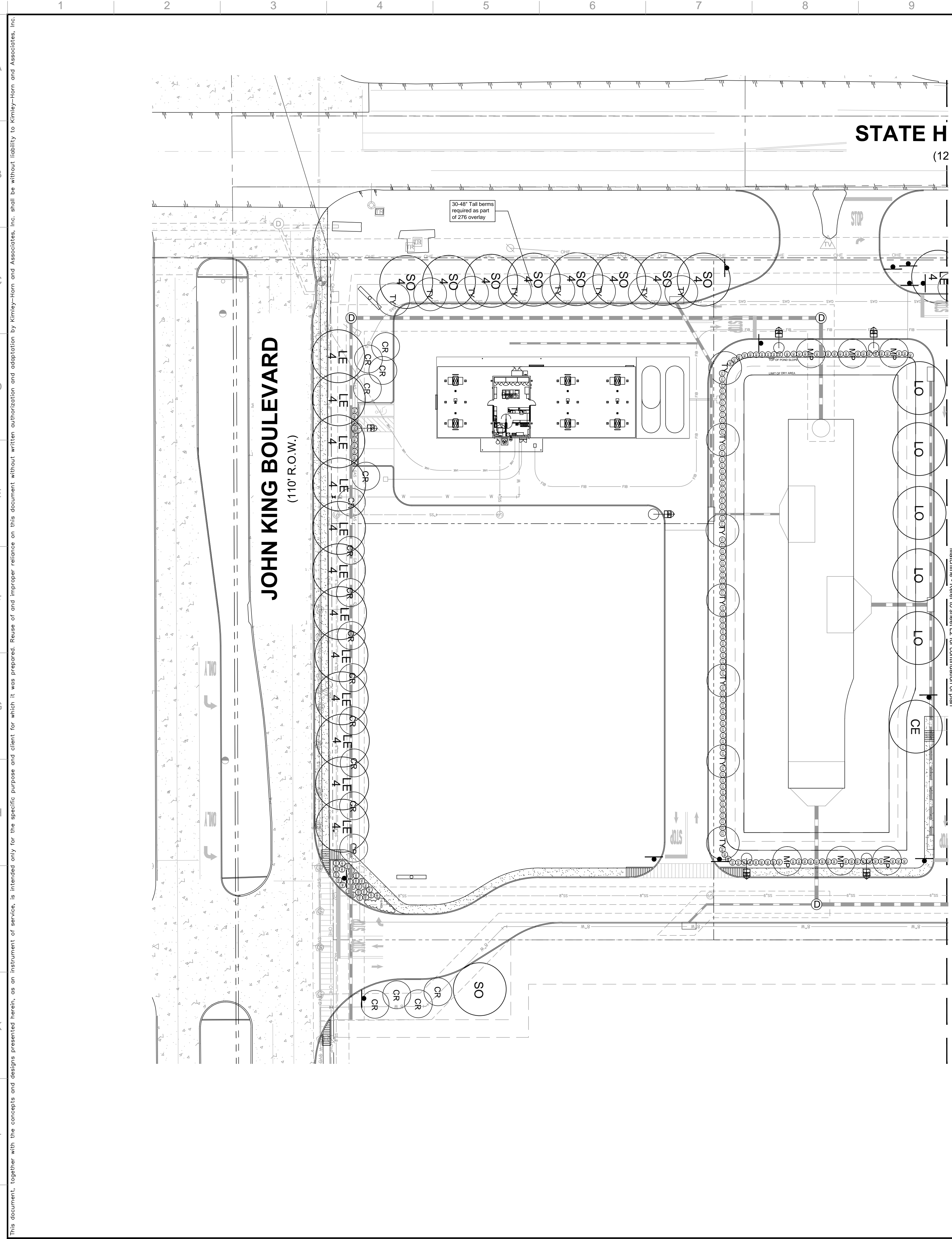

**TREE LEGEND**

- Canopy Trees**
- LO Live Oak
  - CE Cedar Elm
  - BO Bur Oak
  - CR Crapemyrtle
  - TY Tree Yaupon
  - WM Wax Myrtle
  - CO Chinquapin Oak
  - SO Shumard Oak
  - LE Lacebark Elm
  - RB Redbud
  - MP Mexican Plum
  - SM Shantung Maple
  - ERC Eastern Red Cedar

**SHRUB LEGEND**

- DB Dwarf Burford Holly
- CZ Zenizo
- DIH Dwarf Indian Hawthorn
- NGL New Gold Lantana

**LANDSCAPE NOTES**

1. Solid sod Bermuda Grass in all areas disturbed by construction.
  2. The project will have an underground automatic irrigation system to water all new plantings.
  3. Install 4" layer of shredded hardwood mulch to all planting beds.
  4. Install 4" recycled plastic edging between all shrub beds and grass areas. Benda Board or equal.
- Note: Refer to sheet L3 for Plant List, Planting Details, Calculations, and Notes.

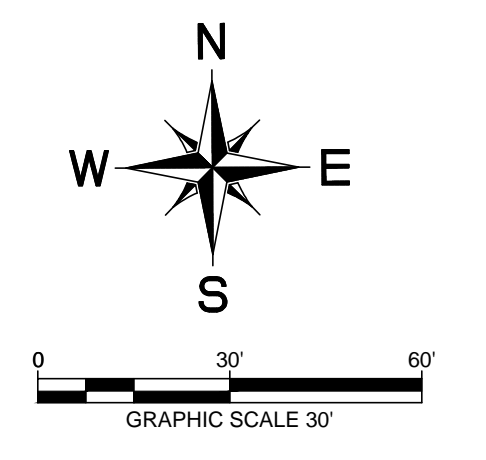

**site integration studio**  
 Landscape Architecture - Sustainable Site Planning - Natural Resource Design

**John F. Murphy, ASLA**

1324 S. Beckham Ave.  
 Suite 244  
 Tyler, TX 75701  
 936.533.8899 tel / fax  
 john@siteint.com

2709 S. Lamar Blvd.  
 Suite 110  
 Austin, TX 78704  
 512.443.3512 tel  
 512.443.3589 fax  
 www.siteint.com

No.	REVISIONS	DATE

**Kimley»Horn**

12012 WICKHAMER LANE HOUSTON, TX 77079  
 © 2014 KIMLEY-HORN AND ASSOCIATES, INC.  
 PHONE: 281-597-9300 FAX: 281-597-8032  
 CERTIFICATION OF AUTHORIZATION F-928  
 WWW.KIMLEY-HORN.COM

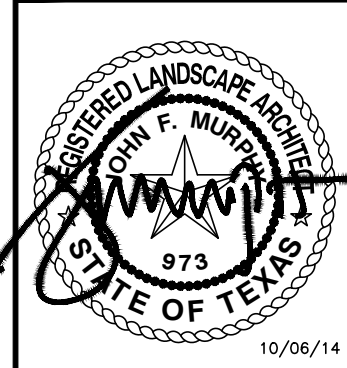

SCALE AS NOTED
DESIGNED BY
DRAWN BY
CHECKED BY

**LANDSCAPE PLAN**

**Walmart** STORE #4604-00  
 ROCKWALL, TEXAS  
 WAL-MART REAL ESTATE BUSINESS TRUST  
 ROCKWALL, TEXAS

DATE	OCTOBER 2014
PROJECT NO.	063362537
SHEET NUMBER	6320



**ALERT TO CONTRACTOR:**

1. THE PRESENCE OF GROUNDWATER SHOULD BE ANTICIPATED ON THIS PROJECT. CONTRACTOR'S BID SHALL INCLUDE CONSIDERATION FOR THIS ISSUE. WHEN PERFORMING GRADING OPERATIONS DURING PERIODS OF WET WEATHER, PROVIDE ADEQUATE DEWATERING, DRAINAGE AND GROUND WATER MANAGEMENT TO CONTROL MOISTURE OF SOILS. REFER TO MASTER SITE SPECIFICATIONS.
2. ALL WM GENERAL CONTRACTOR WORK TO BE COMPLETED (EARTHWORK, FINAL UTILITIES, AND FINAL GRADING) BY THE MILESTONE DATE IN PROJECT DOCUMENTS. OUTLOT AREA TO BE KEPT FREE OF JOB TRAILERS AND STORAGE AFTER THE CONTRACT MILESTONE DATE FOR THE OUTLOT. WM GENERAL CONTRACTOR TO PROVIDE CLEAR ACCESS FOR OUTLOT CONTRACTOR TO THE SPECIFIC PARCEL AT ALL TIMES AFTER MILESTONE DATE. PURCHASER OF OUTLOT TO PROVIDE PERMIT DOCUMENTS AND SWPPP REQUIRED BY STATE/LOCAL REQUIREMENTS FOR SPECIFIC OUTLOT.

This document, together with the concepts and designs presented herein, is intended only for the specific purpose and client for which it was prepared. Reuse of and improper reliance on this document without written authorization and adaptation by Kimley-Horn and Associates, Inc. shall be without liability to Kimley-Horn and Associates, Inc.  
 Sheet set: Walmart-004 Layout: L1 October, 06, 2014 02:03:25pm E:\AutoCAD\Auto\Walmart-Rockwall\Walmart\Rockwall\_L1.dwg  
 Plotted by: Scott Unwin

This document, together with the concepts and designs presented herein, is intended only for the specific purpose and client for which it was prepared. Reuse of and improper reliance on this document without written authorization and adaptation by Kimley-Horn and Associates, Inc. shall be without liability to Kimley-Horn and Associates, Inc.



**site integration studio**  
 Landscape Architecture - Sustainable Site Planning - Natural Resource Design

**John F. Murphy, ASLA**

1324 S. Beckham Ave.  
 Suite 244  
 Tyler, TX 75701  
 936.533.8899 tel / fax  
 john@siteint.com

2709 S. Lamar Blvd.  
 Suite 110  
 Austin, TX 78704  
 512.443.3512 tel  
 512.443.3589 fax  
 www.siteint.com

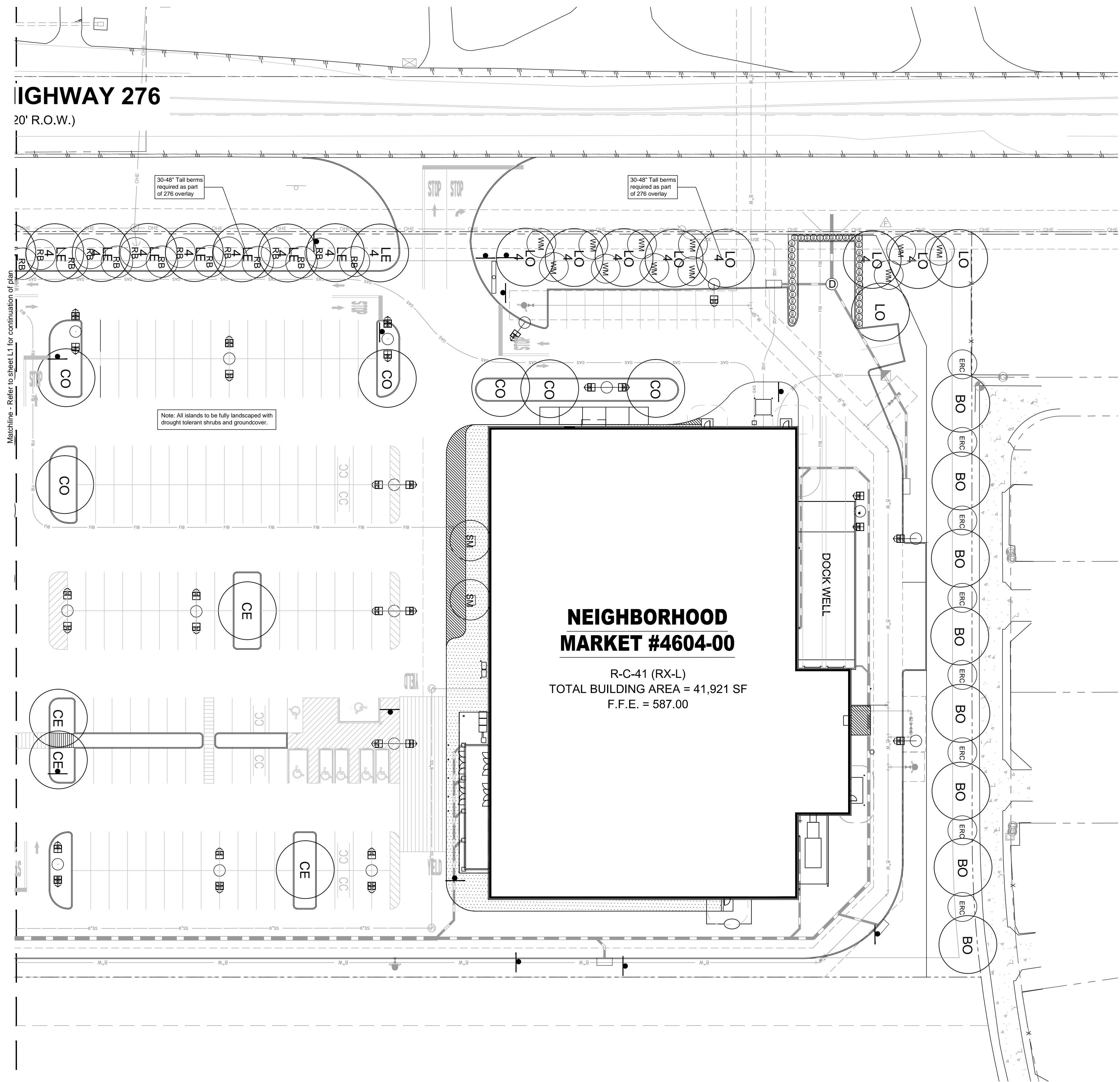

**TREE LEGEND**

- Canopy Trees**
- LO Live Oak
  - CE Cedar Elm
  - BO Bur Oak
  - CR Crapemyrtle
  - TY Tree Yaupon
  - WM Wax Myrtle
  - CO Chinquapin Oak
  - SO Shumard Oak
  - LE Lacebark Elm
  - RB Redbud
  - MP Mexican Plum
  - SM Shantung Maple
  - ERC Eastern Red Cedar

**SHRUB LEGEND**

- DB Dwarf Burford Holly
- CZ Cenizo
- DIH Dwarf Indian Hawthorn
- NGL New Gold Lantana

**LANDSCAPE NOTES**

1. Solid sod Bermuda Grass in all areas disturbed by construction.
  2. The project will have an underground automatic irrigation system to water all new plantings.
  3. Install 4" layer of shredded hardwood mulch to all planting beds.
  4. Install 4" recycled plastic edging between all shrub beds and grass areas. Benda Board or equal.
- Note: Refer to sheet L3 for Plant List, Planting Details, Calculations, and Notes.

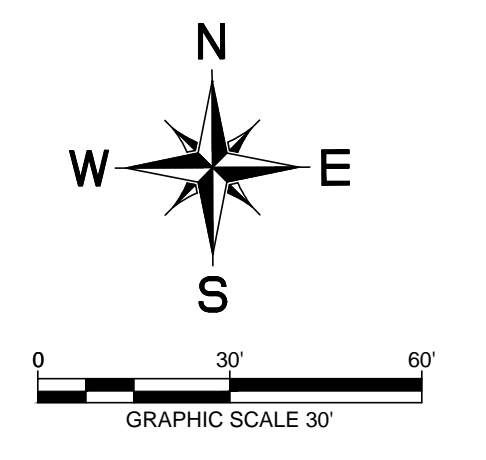

**ALERT TO CONTRACTOR:**

1. THE PRESENCE OF GROUNDWATER SHOULD BE ANTICIPATED ON THIS PROJECT. CONTRACTOR'S BID SHALL INCLUDE CONSIDERATION FOR THIS ISSUE. WHEN PERFORMING GRADING OPERATIONS DURING PERIODS OF WET WEATHER, PROVIDE ADEQUATE DEWATERING, DRAINAGE AND GROUND WATER MANAGEMENT TO CONTROL MOISTURE OF SOILS. REFER TO MASTER SITE SPECIFICATIONS.
2. ALL WM GENERAL CONTRACTOR WORK TO BE COMPLETED (EARTHWORK, FINAL UTILITIES, AND FINAL GRADING) BY THE MILESTONE DATE IN PROJECT DOCUMENTS. OUTLOT AREA TO BE KEPT FREE OF JOB TRAILERS AND STORAGE AFTER THE CONTRACT MILESTONE DATE FOR THE OUTLOT. WM GENERAL CONTRACTOR TO PROVIDE CLEAR ACCESS FOR OUTLOT CONTRACTOR TO THE SPECIFIC PARCEL AT ALL TIMES AFTER MILESTONE DATE. PURCHASER OF OUTLOT TO PROVIDE PERMIT DOCUMENTS AND SWPPP REQUIRED BY STATE/LOCAL REQUIREMENTS FOR SPECIFIC OUTLOT.

No.	REVISIONS	DATE

**Kimley»Horn**

12012 WICKHAMER LANE HOUSTON, TX 77079  
 © 2014 KIMLEY-HORN AND ASSOCIATES, INC.  
 PHONE: 281-597-3300 FAX: 281-597-8032  
 CERTIFICATION OF AUTHORIZATION F-928  
 WWW.KIMLEY-HORN.COM

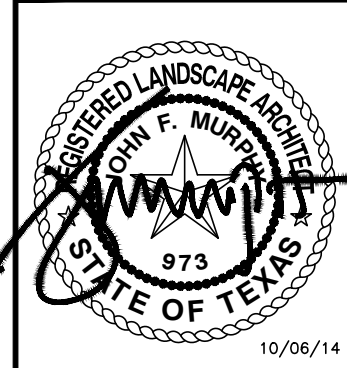

SCALE AS NOTED
DESIGNED BY
DRAWN BY
CHECKED BY

**LANDSCAPE PLAN**

**Walmart** STORE #4604-00  
 ROCKWALL, TEXAS  
 WAL-MART REAL ESTATE BUSINESS TRUST  
 ROCKWALL, TEXAS

DATE	OCTOBER 2014
PROJECT NO.	063362537
SHEET NUMBER	6321

This document, together with the concepts and designs presented herein, is intended only for the specific purpose and client for which it was prepared. Reuse of and improper reliance on this document without written authorization and adaptation by Kimley-Horn and Associates, Inc. shall be without liability to Kimley-Horn and Associates, Inc.

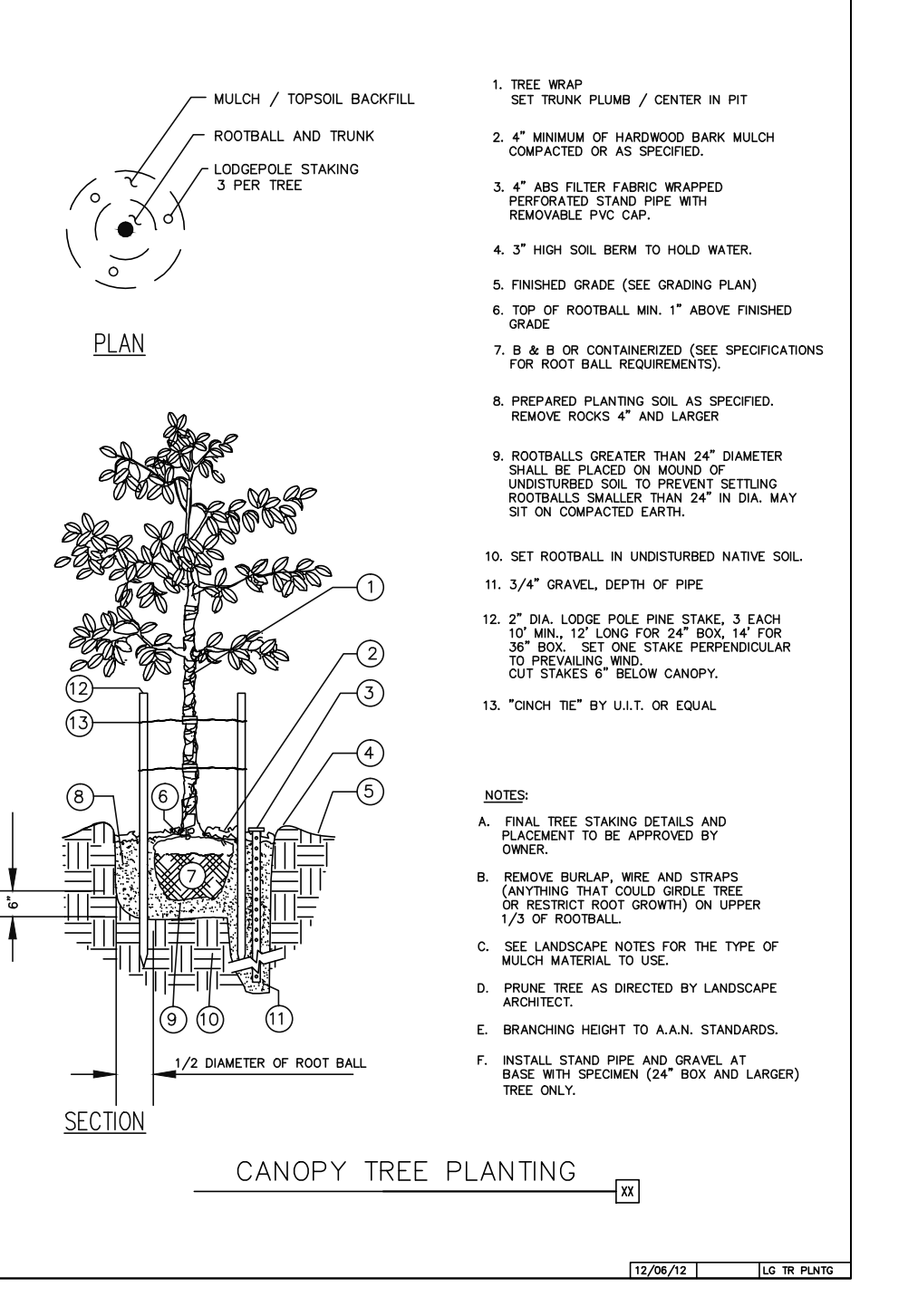
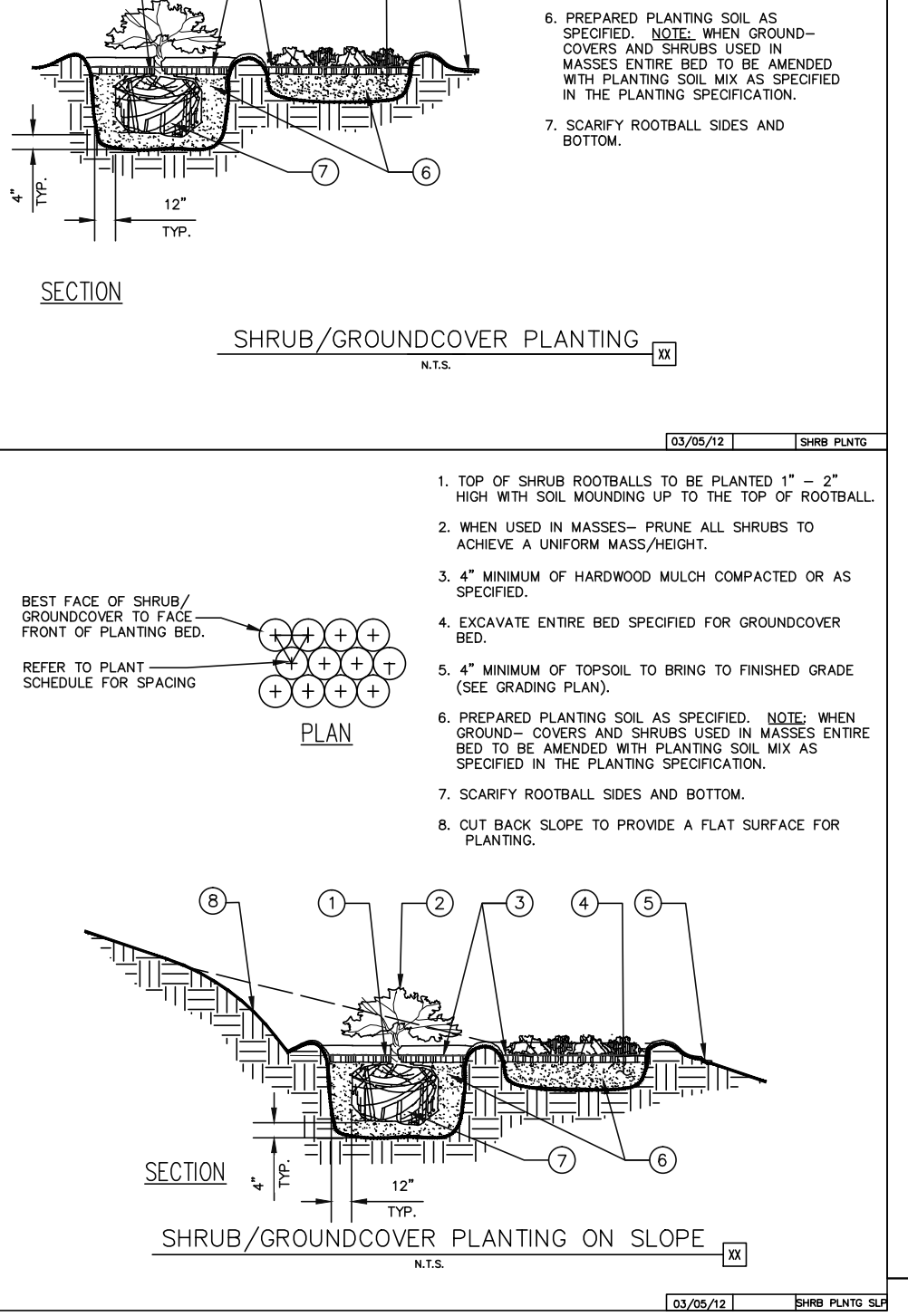
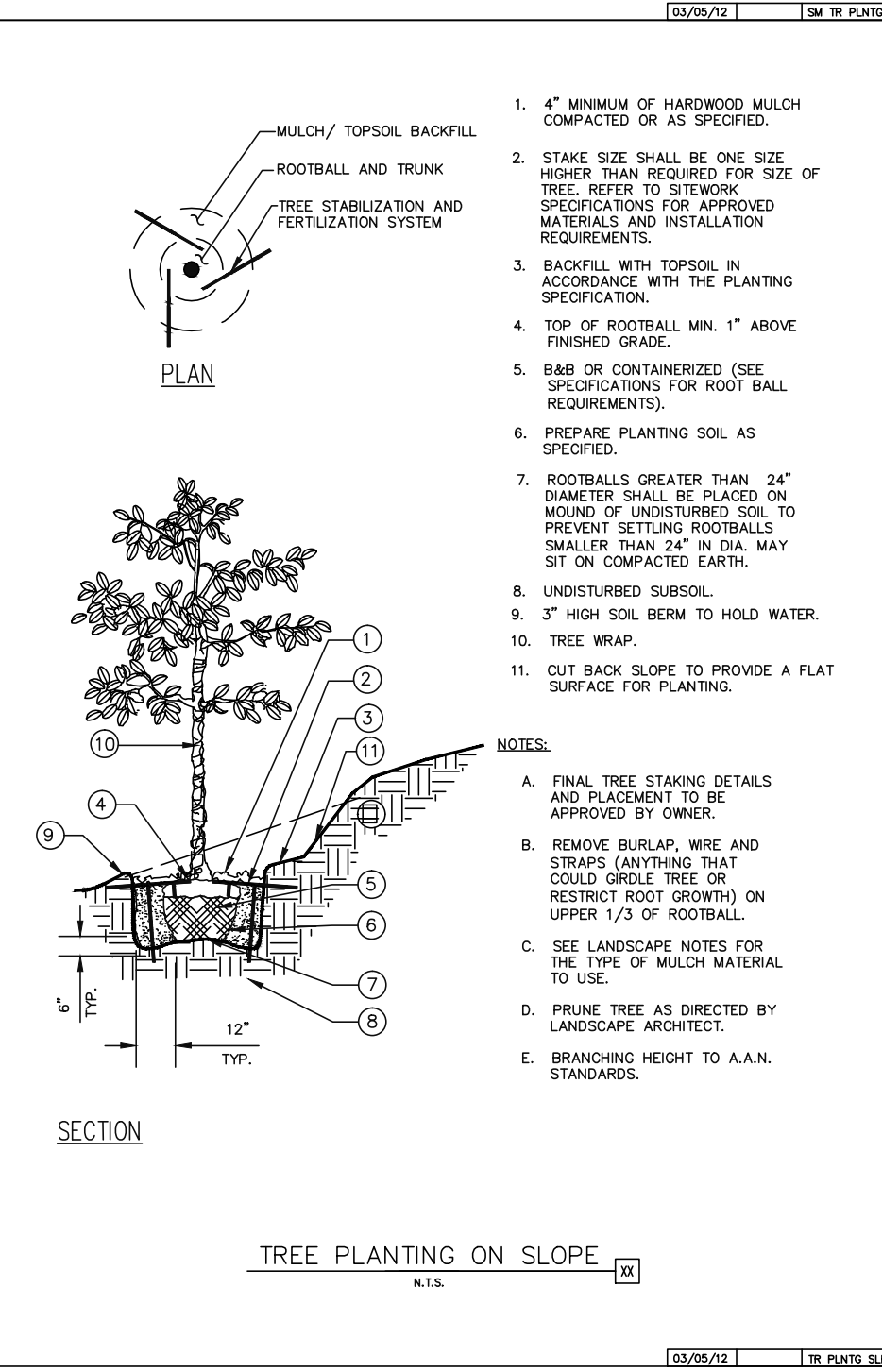
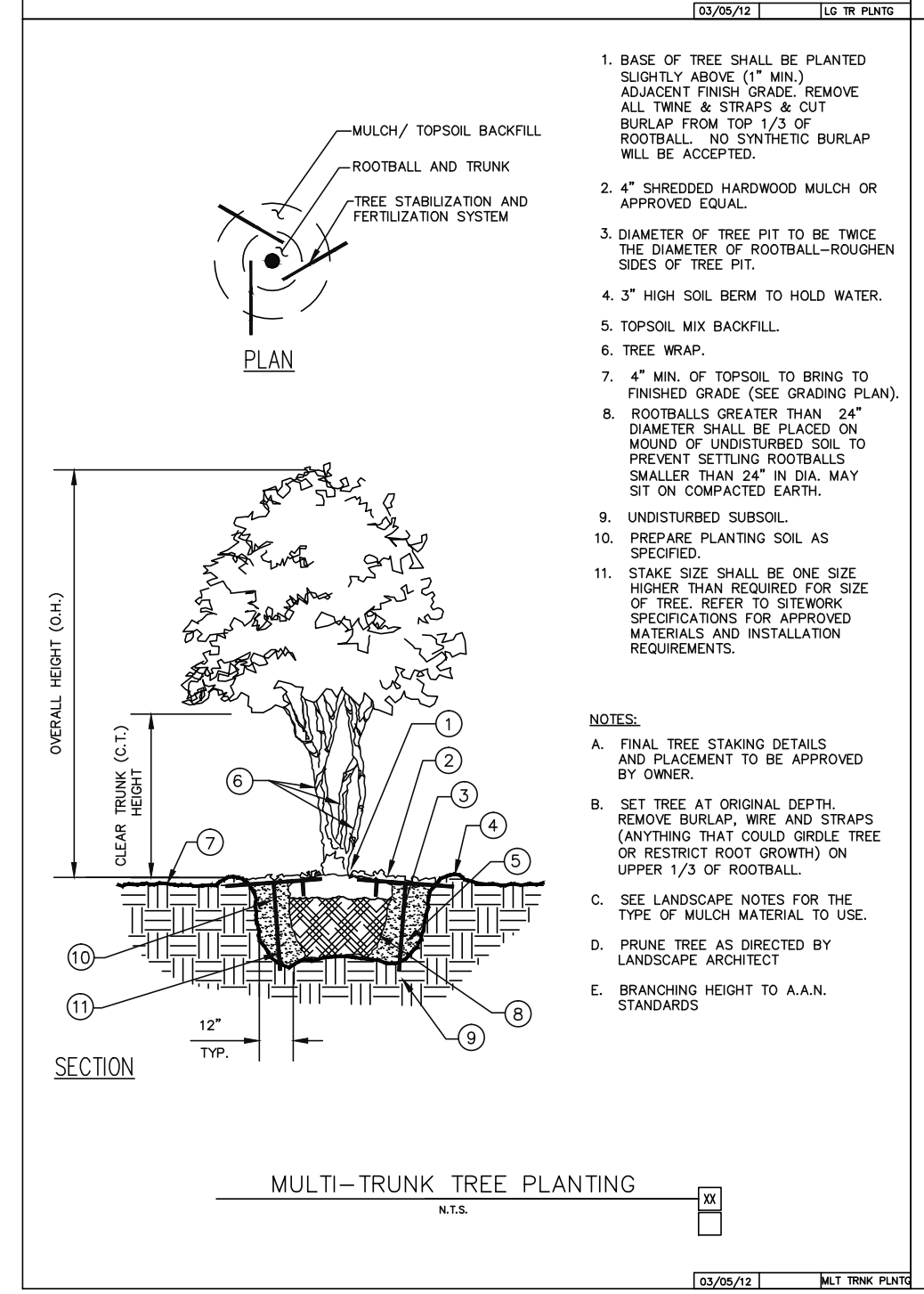
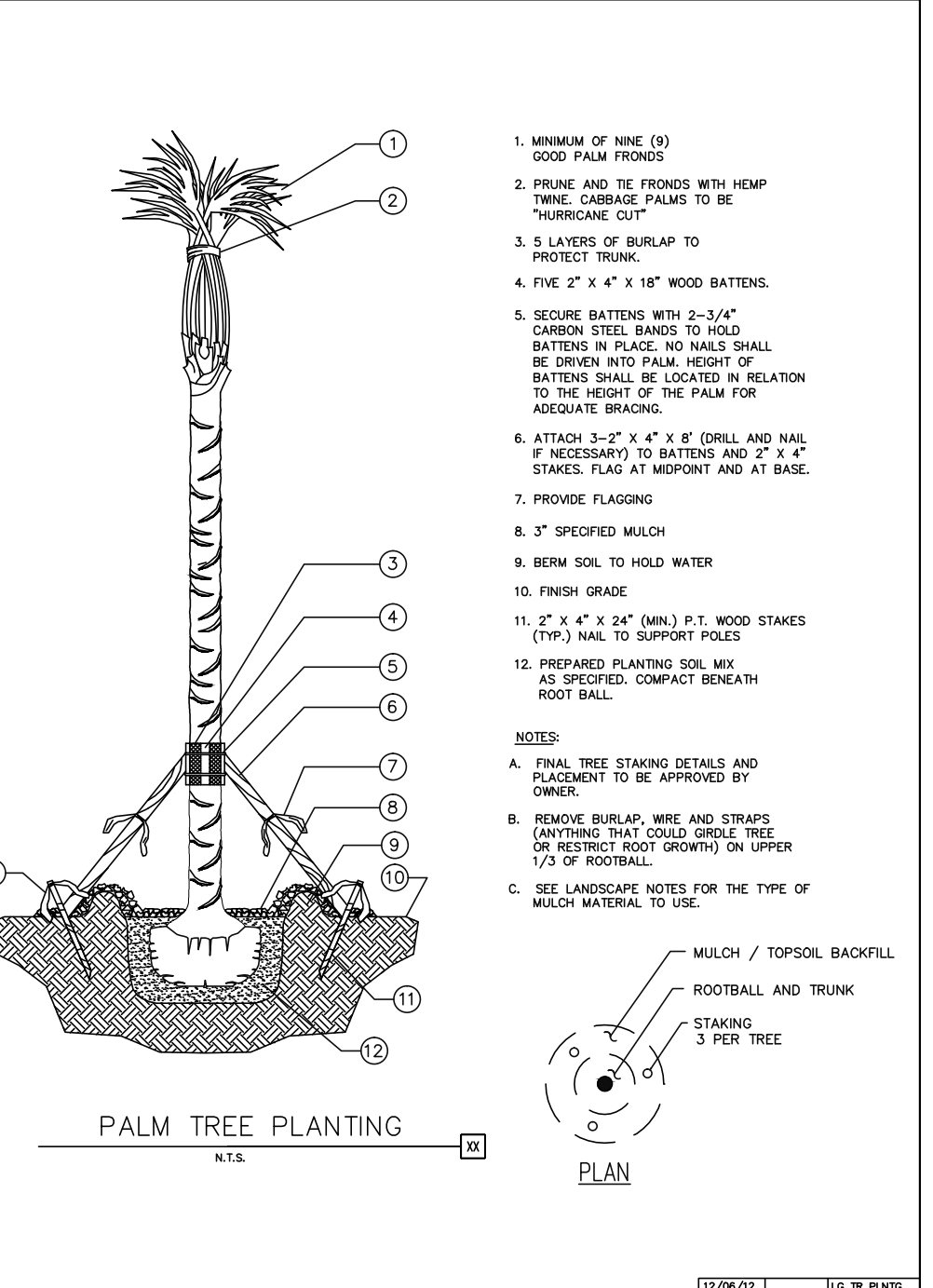
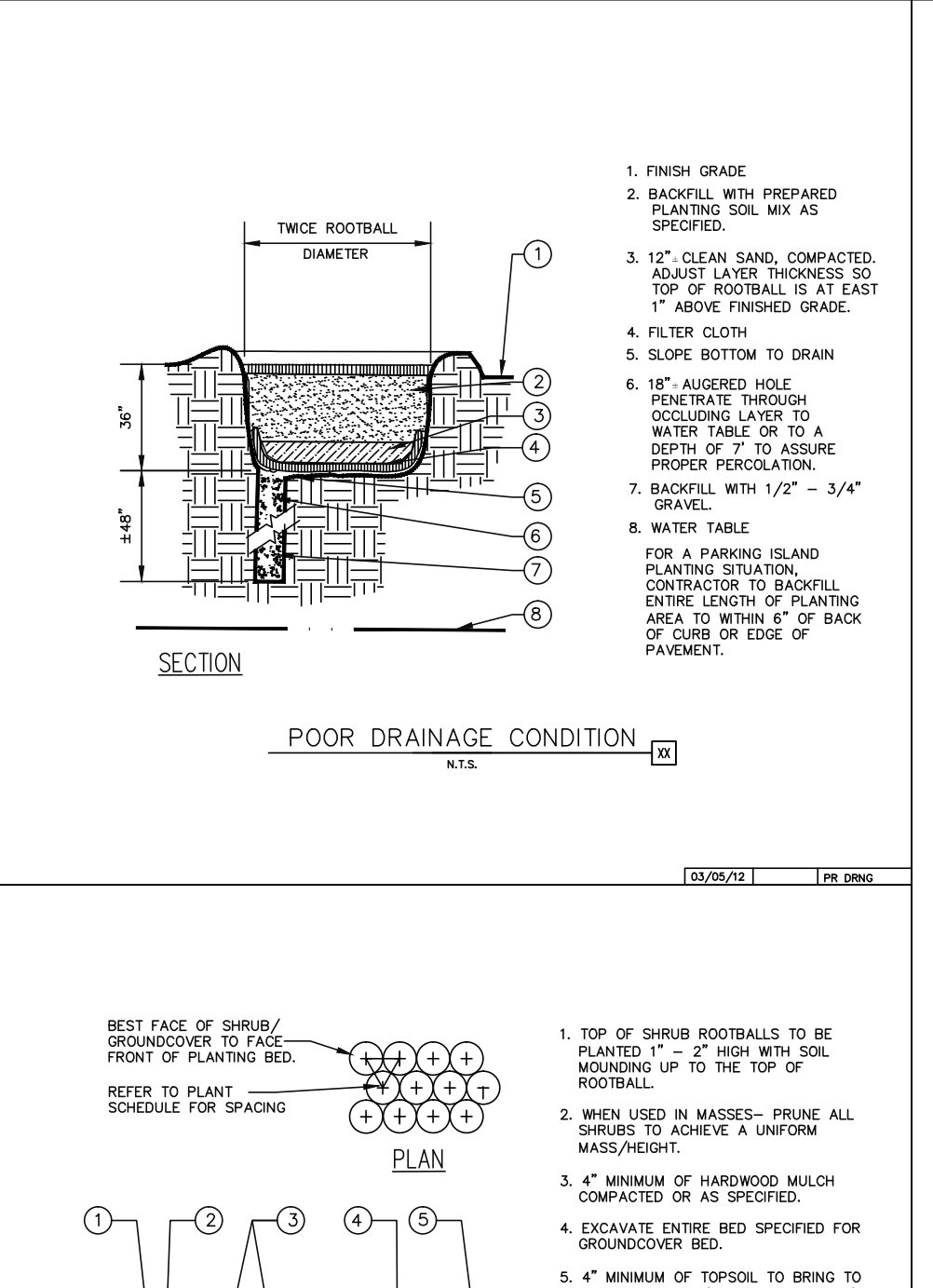
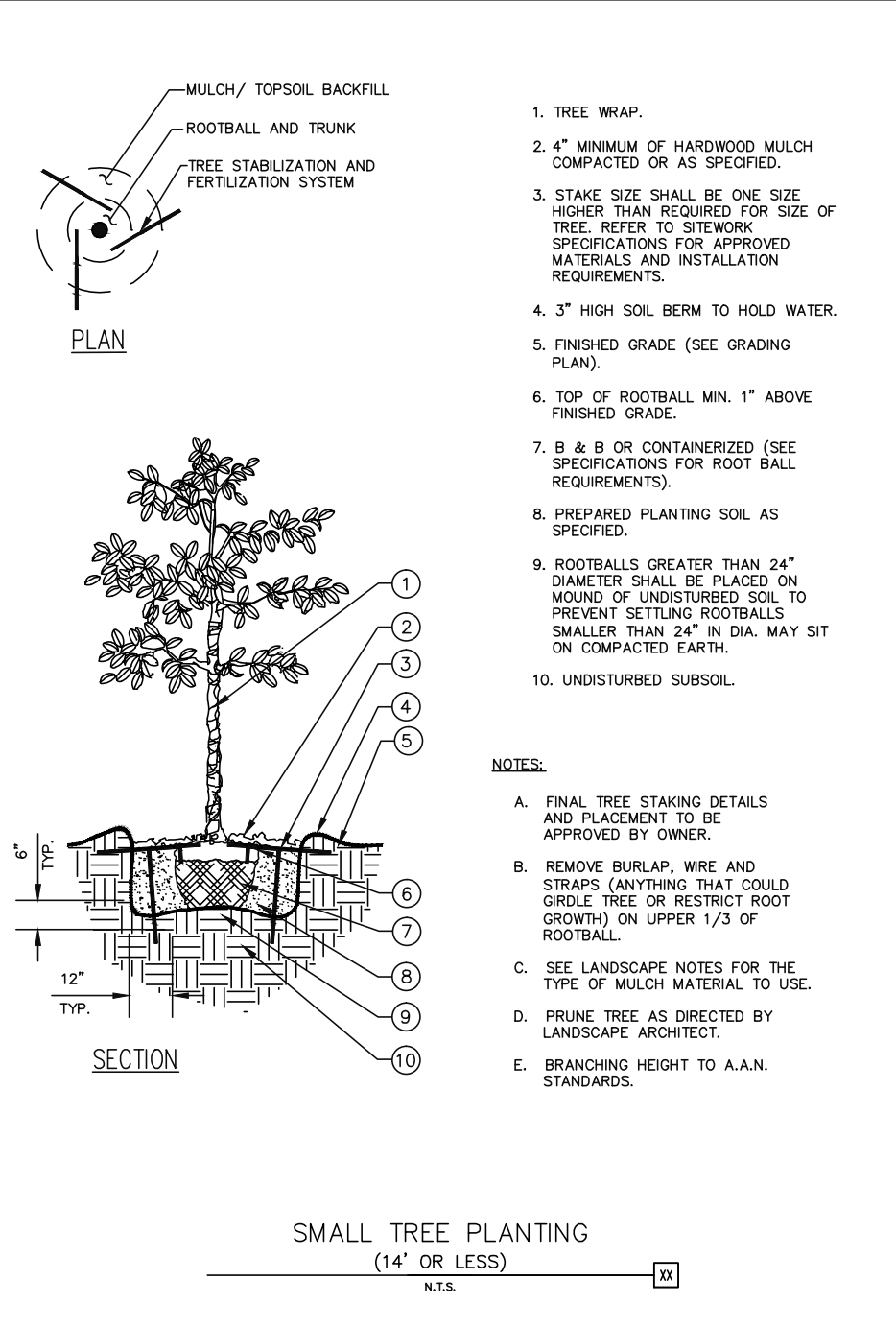
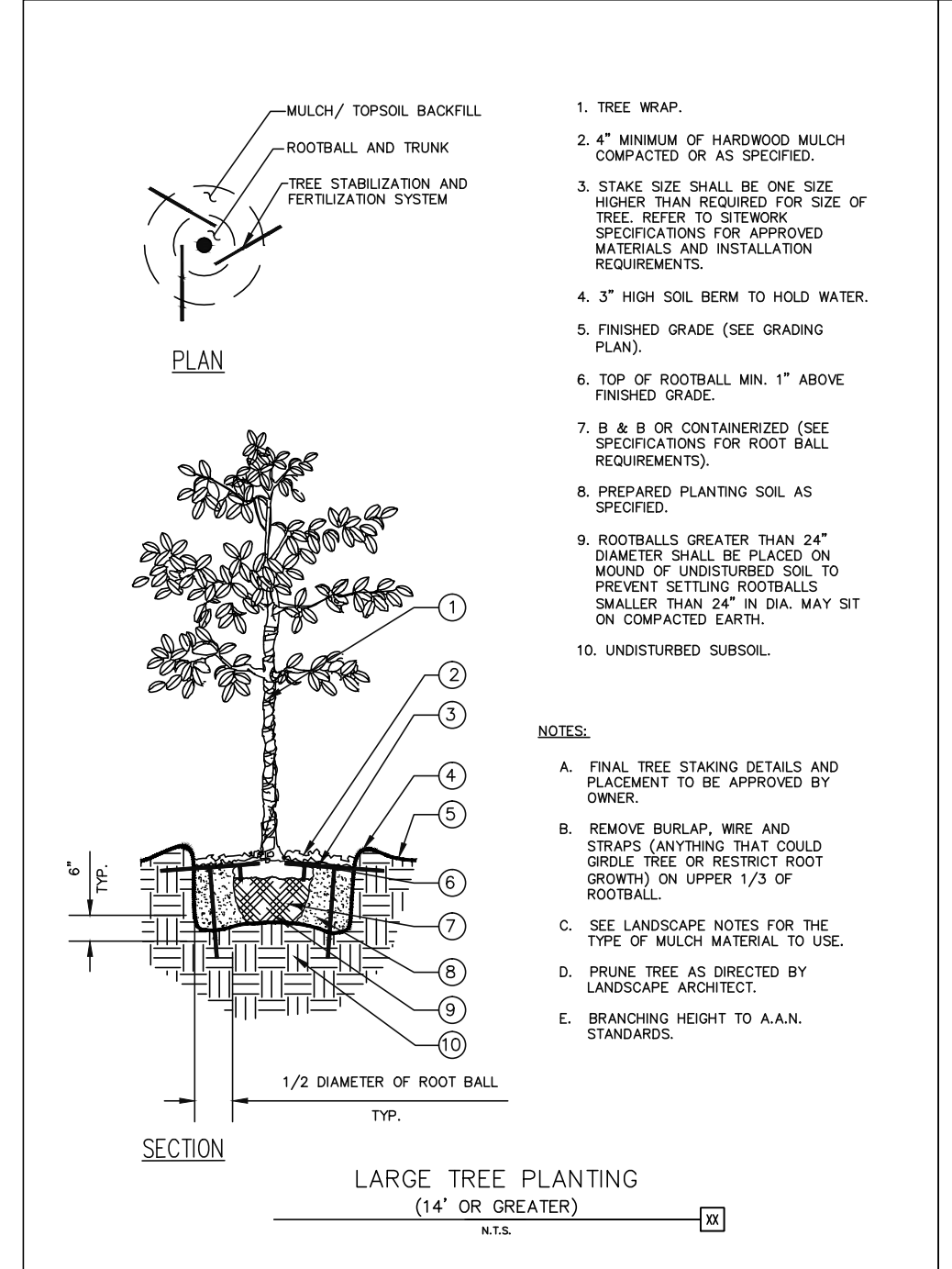

**site integration studio**  
Landscape Architecture - Sustainable Site Planning - Natural Resource Design

**John F. Murphy, ASLA**

1324 S. Beckham Ave.  
Suite 244  
Tyler, TX 75701  
936.533.8899 tel / fax  
john@siteint.com

2709 S. Lamar Blvd.  
Suite 210  
Austin, TX 78704  
512.443.3512 tel  
512.443.3589 fax  
www.siteint.com

**Kimley-Horn**

12012 WICKHAM LANE, HOUSTON, TX 77079  
© 2014 KIMLEY-HORN AND ASSOCIATES, INC.  
PHONE: 281-597-9300 FAX: 281-597-8032  
CERTIFICATION OF AUTHORIZATION F-928  
WWW.KIMLEY-HORN.COM

10/06/14

**LANDSCAPE NOTES:**

- ALL LANDSCAPED AREAS ARE TO RECEIVE A MINIMUM OF 4" OF TOPSOIL. SEE 02900 SPECIFICATION.
- ALL PLANT MATERIAL SHALL BE HEALTHY, VIGOROUS, AND FREE OF PESTS AND DISEASE.
- ALL PLANT MATERIAL SHALL BE CONTAINER GROWN OR BALLED AND BUR LAPPED AS INDICATED IN THE PLANT LIST.
- ALL TREES SHALL HAVE A STRAIGHT TRUNK AND FULL HEAD AND MEET ALL REQUIREMENTS SPECIFIED.
- ALL MATERIALS ARE SUBJECT TO THE APPROVAL OF THE LANDSCAPE ARCHITECT BEFORE, DURING, AND AFTER INSTALLATION.
- ALL TREES MUST BE GUYED OR STAKED AS SHOWN IN THE DETAILS.
- ALL PLANTING AREAS SHALL BE COMPLETELY MULCHED AS SPECIFIED.
- PRIOR TO CONSTRUCTION, THE CONTRACTOR SHALL BE RESPONSIBLE FOR LOCATING ALL UNDERGROUND UTILITIES AND SHALL AVOID DAMAGE TO ALL UTILITIES DURING THE COURSE OF THE WORK. LOCATIONS OF EXISTING BURIED UTILITY LINES SHOWN ON THE PLANS ARE BASED UPON BEST AVAILABLE INFORMATION AND ARE TO BE CONSIDERED APPROXIMATE. IT SHALL BE THE RESPONSIBILITY OF THE CONTRACTOR TO VERIFY THE LOCATIONS OF UTILITY LINES AND ADJACENT TO THE WORK AREA TO PROTECT OF ALL UTILITY LINES DURING THE CONSTRUCTION PERIOD TO REPAIR ANY AND ALL DAMAGE TO UTILITIES, STRUCTURES, SITE APPURTENANCES, ETC. WHICH OCCURS AS A RESULT OF THE CONSTRUCTION.
- THE CONTRACTOR SHALL BE RESPONSIBLE FOR VERIFYING ALL QUANTITIES SHOWN ON THESE PLANS BEFORE PRICING THE WORK.
- THE CONTRACTOR SHALL BE RESPONSIBLE FOR FULLY MAINTAINING (INCLUDING BUT NOT LIMITED TO: WATERING, SPRAYING, MULCHING, FERTILIZING, ETC.) ALL OF THE PLANT MATERIALS AND LAWN FOR THE PERIOD OF TIME SHOWN IN THE 29000 SPEC.
- ANY PLANT MATERIAL WHICH IS DISEASED, DISTRESSED, DEAD, OR REJECTED (PRIOR TO SUBSTANTIAL COMPLETION) SHALL BE PROMPTLY REMOVED FROM THE SITE AND REPLACED WITH MATERIAL OF THE SAME SPECIES, QUANTITY, AND SIZE AND MEETING ALL PLANT LIST SPECIFICATIONS.
- THE CONTRACTOR SHALL COMPLETELY GUARANTEE ALL PLANT MATERIAL FOR A PERIOD DEFINED IN THE 02900 SPEC. THE CONTRACTOR SHALL PROMPTLY MAKE ALL REPLACEMENTS DURING THE NORMAL PLANTING SEASON.
- AFTER BEING DUG AT THE NURSERY SOURCE, ALL TREES IN LEAF SHALL BE ACCLIMATED FOR TWO (2) WEEKS UNDER A MIST SYSTEM PRIOR TO INSTALLATION.
- STANDARDS SET FORTH IN "AMERICAN STANDARD FOR NURSERY STOCK" REPRESENT GUIDELINE SPECIFICATIONS ONLY AND SHALL CONSTITUTE MINIMUM QUALITY REQUIREMENTS FOR PLANT MATERIAL.
- WHERE SHOWN ON THE PLANS AND DETAILS, PLANTING BEDS ARE TO BE COMPLETELY COVERED WITH A HARDWOOD MULCH FROM A LOCAL SOURCE HARVESTED IN A SUSTAINABLE MANNER TO A MINIMUM DEPTH OF FOUR INCHES.
- REFER TO SPECIFICATIONS FOR INFORMATION NEEDED FOR IMPLEMENTATION OF PLANTING PLANS.
- WEED MAT IS REQUIRED IN ALL LANDSCAPED ISLANDS AS SPECIFIED.
- ALL PLANT MATERIAL QUANTITIES SHOWN ARE APPROXIMATE. CONTRACTOR SHALL BE RESPONSIBLE FOR COMPLETE COVERAGE OF ALL PLANTING BEDS AT SPACING SHOWN.
- THIS PLAN IS TO BE IMPLEMENTED COOPERATIVELY WITH SWPPP PLAN, AS NEEDED, TO MAXIMIZE THE EFFECTIVENESS OF THE SWPPP PLAN FOR THIS SITE.
- THE CONTRACTOR IS ENCOURAGED TO COMPLETE TEMPORARY OR PERMANENT SEEDING OR SODDING IN STAGES FOR SOIL STABILIZATION AS AREAS ARE COMPLETED AFTER GRADING.
- THIS PLAN DOES NOT PRESENT ANY TEMPORARY STABILIZATION REQUIRED AS PART OF SWPPP PLAN.

**PLANT LIST**

CANOPY TREES			
8	BO	Bur Oak	Quercus macrocarpa
8	LO4	Live Oak	Quercus virginiana
8	SO4	Shumard Oak	Quercus shumardii
6	LO	Live Oak	Quercus virginiana
1	SO	Shumard Oak	Quercus shumardii
6	CO	Chinquapin Oak	Quercus muhlenbergii
20	LE4	Lacebark Elm	Ulmus parvifolia
5	CE	Cedar Elm	Ulmus crassifolia
ORNAMENTAL TREES			
15	TY	Tree Yaupon	Ilex vomitoria
18	CR	Crapemyrtle	Lagerstroemia indica
15	RB	Redbud	Cercis canadensis
6	MP	Mexican Plum	Prunus mexicana
2	SM	Shantung Maple	Acer truncatum
8	ER	Eastern Red Cedar	Juniperus virginiana
11	WM	Wax Myrtle	Myrica cerifera
SHRUBS & GROUNDCOVERS			
106	DB	Dwarf Burford Holly	Ilex cornuta 'Burfordii' nana
71	CZ	Cenizo	Leucophyllum frutescens
26	DIH	Dwarf Indian Hawthorn	Rhaphiolepis indica 'Pinkie'
10	NGL	New Gold Lantana	Lantana camara 'New Gold'

**City of Rockwall, Texas  
LANDSCAPE CALCULATIONS**

Area	Required	Provided
Total Site Area	272,657 SF	
15% Required Landscape Area	40,899 SF	86,544 SF (32%)
SH 276 OVERLAY BUFFER		
15 ft. width buffer	841 LF	
Canopy Trees	3 per 100 ft. and 4 orn. trees per 100	25 large + 34 orn. trees
John King Blvd. BUFFER		
10 ft. width buffer	385 LF	
Canopy Trees	3 per 100 ft. and 4 orn. trees per 100	12 large + 16 orn. trees
12 large trees 16 orn. trees Entry shrub planting		
Parking Lot Landscape		
168 Spaces	Required	Provided
Parking Area 83,306 sf. 5% Req. Landscape Area	4,166 sf.	4,188 sf. (5%)
No space greater than 80 ft. from a tree 1 tree per 10 spaces	17 trees	17 trees
Detention Pond Landscape		
1 tree per 750 sf of dry area dry area 7,193 sf	Required	Provided
	10 trees	13 trees



**ALERT TO CONTRACTOR:**

- THE PRESENCE OF GROUNDWATER SHOULD BE ANTICIPATED ON THIS PROJECT. CONTRACTOR'S BID SHALL INCLUDE CONSIDERATION FOR THIS ISSUE. WHEN PERFORMING GRADING OPERATIONS DURING PERIODS OF WET WEATHER, PROVIDE ADEQUATE DRAINAGE, DRAINAGE AND GROUND WATER MANAGEMENT TO CONTROL MOISTURE OF SOILS. REFER TO MASTER SITE SPECIFICATIONS.
- ALL WM GENERAL CONTRACTOR WORK TO BE COMPLETED (EARTHWORK, FINAL UTILITIES, AND FINAL GRADING) BY THE MILESTONE DATE IN PROJECT DOCUMENTS. OUTLET AREA TO BE KEPT FREE OF JOB TRAILERS AND STORAGE AFTER THE CONTRACT MILESTONE DATE FOR THE OUTLET. WM GENERAL CONTRACTOR TO PROVIDE CLEAR ACCESS FOR OUTLET CONTRACTOR TO THE SPECIFIC PARCEL AT ALL TIMES AFTER MILESTONE DATE. PURCHASER OF OUTLET TO PROVIDE PERMIT DOCUMENTS AND SWPPP REQUIRED BY STATE/LOCAL REQUIREMENTS FOR SPECIFIC OUTLET.

**Walmart** STORE #4604-00  
ROCKWALL, TEXAS  
WAL-MART REAL ESTATE BUSINESS TRUST  
ROCKWALL, TEXAS

DATE	OCTOBER 2014
PROJECT NO.	063362537
SHEET NUMBER	6322



# WAL-MART STEEL ROUND TAPERED POLES

## DIMENSIONS

### ONE-PIECE RTPN

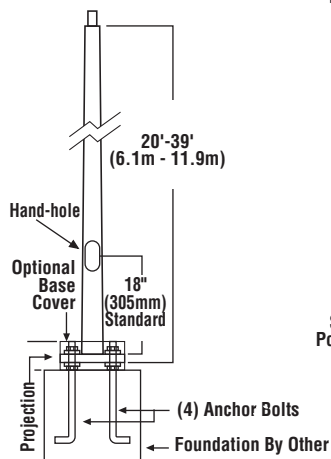

RTPBO – Bolt-On Mount, 2-Bolt Pattern

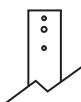

RTPP – Round Pole Top



SF – Single Flood Pole Preparation



**POLE SHAFT** - Pole shaft is electro-welded ASTM-A595 Grade A steel tubing with a minimum yield strength of 55,000 psi. On Tenon Mount steel poles, tenon is 2-3/8" O.D. high-strength pipe. Tenon is 4-3/4" in length.

**HAND-HOLE** - Standard hand-hole location is 18" above pole base. Hand-hole size is 4" x 6" and reinforced.

**BASE** - Pole base is ASTM-A36 hot-rolled steel plate with a minimum yield strength of 36,000 psi. Two-piece square base cover is optional.

**ANCHOR BOLTS** - Poles are furnished with anchor bolts featuring zinc-plated double nuts and washers. Galvanized anchor bolts are optional. Anchor bolts conform to ASTM-F-1554, Grade 55 with a minimum yield strength of 55,000 psi.

**GROUND LUG** - Ground lug is standard.

**DUPLEX RECEPTACLE** - Weatherproof duplex receptacle is optional.

**GROUND FAULT CIRCUIT INTERRUPTER** - Ground fault circuit interrupter is optional.

**FINISHES** - Each steel pole is finished with LSI's DuraGrip<sup>®</sup> baked-on polyester-powder finishing process to give the pole an exceptionally attractive appearance. The process electrostatically applies and thermally fuses a polyester powder to the pole. This unique protection process provides an extremely smooth and uniform finish to withstand extreme weather changes without cracking or peeling. DuraGrip finish features a two-year limited warranty. Standard finish colors available for poles are bronze, black, platinum plus, buff, white, satin verde green, metallic silver, and graphite. Optional DuraGrip<sup>®</sup> Plus features added protection with a 3.0 to 5.0 mil thickness of polyester-powder finish plus an inner coating. This specially developed inner coating is a thermal plastic hydrocarbon resin applied to the inside of the pole to seal and protect against atmospheric and corrosive matter. DuraGrip Plus finish features a five-year limited warranty.

ONE-PIECE SHAFT		
Height	Pole Bottom	Pole Top
20' (6.1m)	5.80" (147mm)O.D.	3.0" (76mm)O.D.
25' (7.1m)	6.60" (168mm)O.D.	3.10" (79mm)O.D.
30' (9.1m)	7.50" (191mm)O.D.	3.30" (84mm)O.D.
35' (10.7m)	8.50" (216mm)O.D.	3.60" (91mm)O.D.
39' (11.9m)	9.00" (229mm)O.D.	3.54" (90mm)O.D.

## DRILLING LOCATIONS

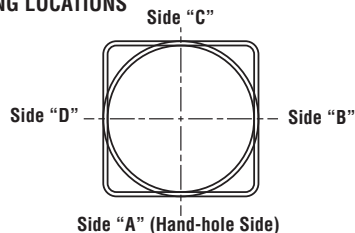

Sides	A	B	C	D
Hand-hole	X			
Single	X			
D180°		X		X
D90°	X			X
T90°	X	X		X
TN120°*	X			
Q90°	X	X	X	X
Single FBO	X			
Double FBO		X		X

\*Other two locations will be 120° to the left and right of Side A.

**Note:** Standard SF and DF pole preparations are located 3/4 of the height of the pole from the base, except on 20' poles. Maximum height for SF and DF pole preparations on 20' poles is 13' from the base.

## SHIPPING WEIGHTS - Round Steel Tapered Poles

20' (6.1m) S11 Ga. is approximately	153 lbs. (69kg)
25' (7.6m) S11 Ga. is approximately	196 lbs. (89kg)
30' (9.1m) S11 Ga. is approximately	247 lbs. (112kg)
35' (10.7m) S11 Ga. is approximately	319 lbs. (145kg)
39' (11.9m) S11 Ga. is approximately	358 lbs. (162kg)
39' (11.9m) S07 Ga. is approximately	529 lbs. (240kg)

### Anchor Bolts

1-1/4" x 42" (32mm x 1069mm)	63 lbs. (29kg)
------------------------------	----------------



LSI INDUSTRIES INC.  
10000 Alliance Road ♦ Cincinnati, Ohio 45242 ♦ (800)436-7800 FAX (513)793-0147 ♦ Ext. 3211 - National Accounts  
www.lsi-industries.com ♦ Photometric Requests: lsi-wmt.apps@lsi-industries.com

# WAL-MART STEEL ROUND TAPERED POLES

## POLE ORDERING INFORMATION

TYPICAL ORDER EXAMPLE: **W/M RTPBO S11G 39 S BLK DGP 18HH 12BC 1 1/4AB**

Pole Series	Material	Height <sup>1</sup>	Mounting Configuration	Pole Finish	Options
Round Tapered Pole for Bolt-On Mount 2-Bolt Pattern RTPBO	S11G – 11 Ga. Steel S07G – 07 Ga. Steel	20' 25' 30' 35' 39'	S – Single/Parallel D180 – Double D90° – Double DN90° – Double T90° – Triple TN120° – Triple Q90° – Quad	BLK – Black	GA – Galvanized Anchor Bolts SF – Single Flood <sup>2</sup> DF – Double Flood <sup>2</sup> DGP – DuraGrip® Plus LAB – Less Anchor Bolts
<b>Standard SF and DF pole preparations are located 3/4 of the height of the pole from the base, except on 20' poles. Maximum height for SF and DF pole preparations on 20' poles is 13' from the base.</b>					

### FOOTNOTES:

1 - Pole heights will have +/- 1/2" tolerance.

2- See Flood Lighting Brackets Section.

ACCESSORY ORDERING INFORMATION (Accessories are field installed)			
Description	Order Number	Description	Order Number
15' - 20' SRTBC Square Base Cover	400103	ER2 – Weatherproof RTP Duplex Receptacle	122568CLR
21' - 30' SRTBC Square Base Cover	345555BLK	GFI – Ground Fault RTP Circuit Interrupter	122569CLR
31' - 39' SRTBC Square Base Cover	155887BLK	MHD - Mounting Hole Weatherproof Decal	Consult Factory

### BOLT CIRCLE

12-1/2" (318mm) sq.

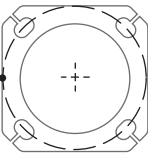

12-1/2" (318mm) Dia. Bolt Circle

Bolt Circle	Slotted 12" -13"
Anchor Bolt Size	1-1/4" x 42"
Anchor Bolt Projection	5"
Base Plate Dimensions	12-1/2" sq. x 1-1/4" thk.

Note: Base plate illustrations may change without notice. Do not use for setting anchorbolts. Consult factory for the base plate templates.