





Rockwall



HONDA

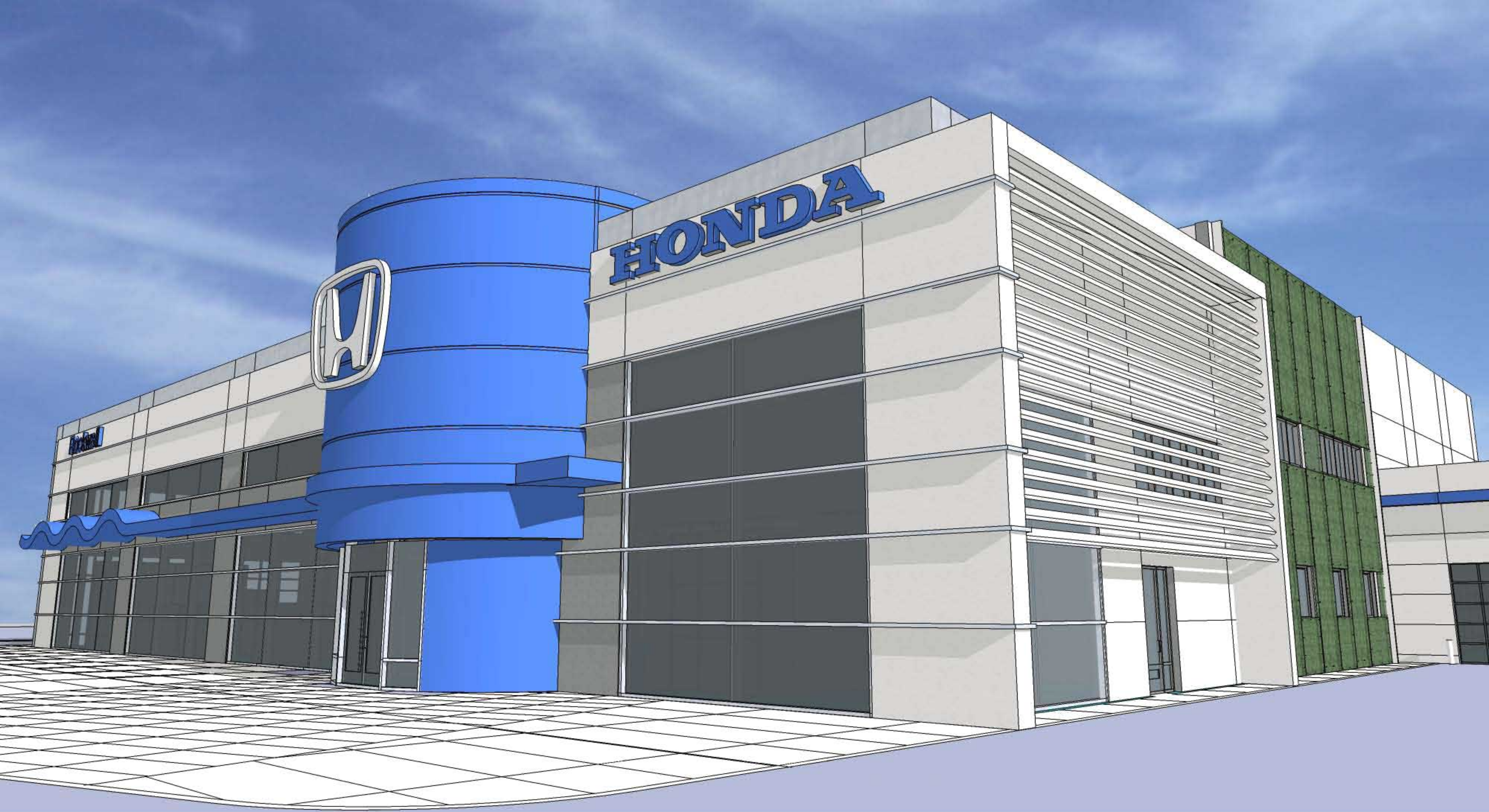

HONDA



HONDA



**CITY REQUIREMENTS  
IH-30 OVERLAY DISTRICT**

<b>TOTAL LANDSCAPE AREA</b>
10% TOTAL LANDSCAPE REQUIRED
TOTAL SITE 378,354 SF x 10% = 37,835 SF REQUIRED 108,350 SF PROVIDED (28.64%)
<b>STREET FRONTAGE</b>
20' LANDSCAPE BUFFER-STRIP REQUIRED
20' LANDSCAPE BUFFER-STRIP PROVIDED
<b>BUFFER-STRIP PLANTINGS</b>
3 CANOPY TREES PER 100 LF IH-30 R.O.W.
$\frac{420'}{100} = 4.2 \times 3 = 12.6 = 13$ TREES REQUIRED 13 TREES PROVIDED
4 ACCENT TREES PER 100 LF IH-30 R.O.W.
$\frac{420'}{100} = 4.2 \times 4 = 16.8 = 17$ TREES REQUIRED 17 TREES PROVIDED
<b>PARKING LOT LANDSCAPING</b>
1 TREE PER 10 SPACES
$\frac{505 \text{ PARKING}}{10} = 50.5 = 51$ TREES REQUIRED 51 TREES PROVIDED
5% INTERIOR LANDSCAPE REQUIRED
224,741 SF x 5% = 11,237 SF REQUIRED 16,035 SF PROVIDED (7.13%)
<b>DRY LAND DETENTION BASIN</b>
1 TREE PER 750 SQ. FT.
$\frac{31,604 \text{ SF}}{750} = 42.14 = 42$ TREES REQUIRED 43 TREES PROVIDED

**UTILITY NOTE:**  
NO TREES SHALL BE PLANTED WITHIN 5' OF ANY UTILITIES

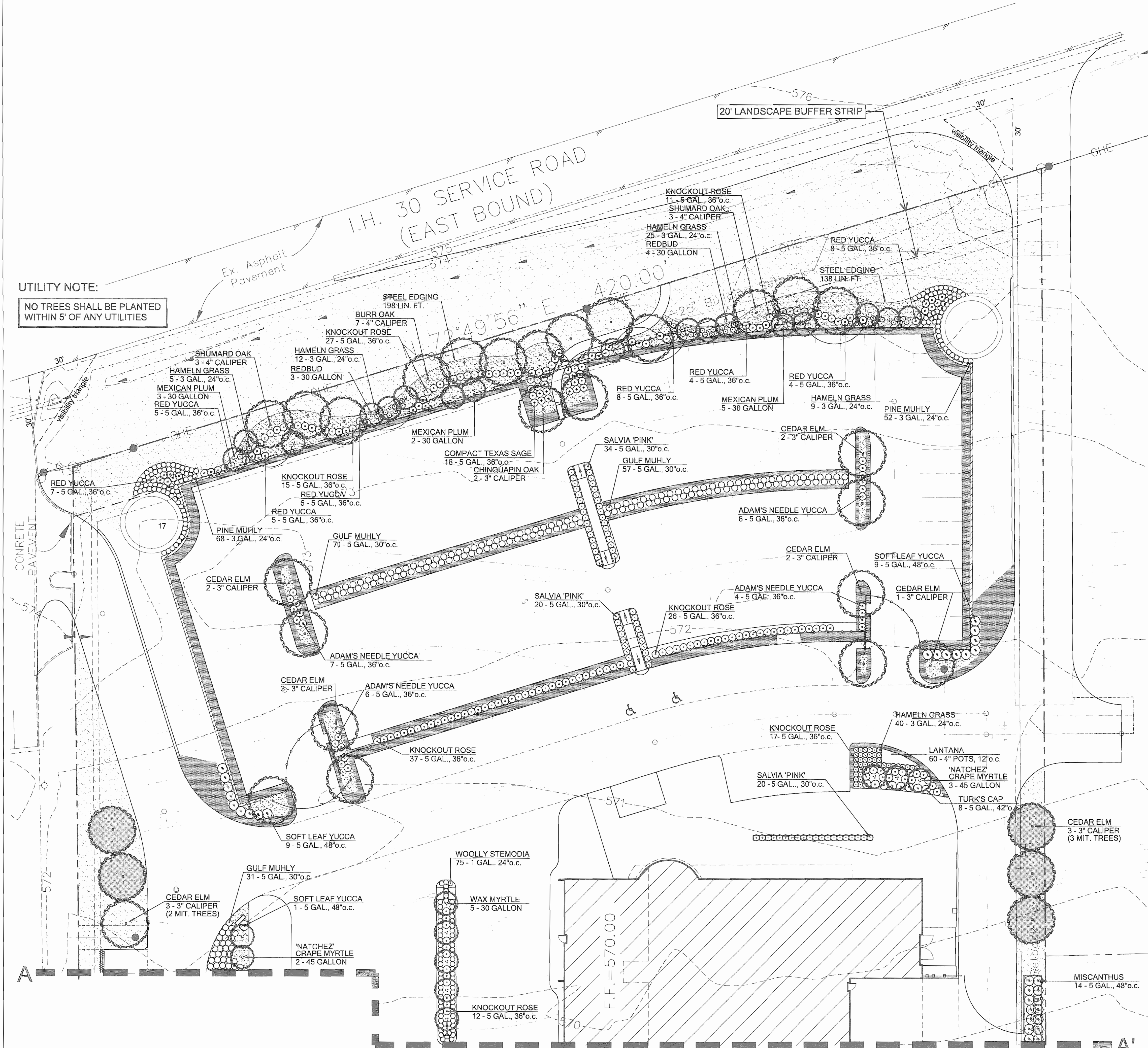

**HATCH SCHEDULE**

[Hatched Pattern]	DECORATIVE AGGREGATE REF. DETAIL SHEET L.03
[Hatched Pattern]	GRAVEL GROUNDCOVER REF. DETAIL SHEET L.03
[Hatched Pattern]	MULCH GROUNDCOVER REF. DETAIL SHEET L.03
[Hatched Pattern]	BUFFALO GRASS SOD (BUCHLOE DACTYLOIDES) IRRIGATED
[Hatched Pattern]	BUFFALO GRASS SEED (BUCHLOE DACTYLOIDES) TEMPORARY IRRIGATION

**MITIGATION REQUIREMENTS**

[Tree Symbol]	MITIGATION TREE 3" CALIPER REF. SHEET L.01
REQUIRED	13 CALIPER INCHES
PROPOSED	15 CALIPER INCHES (5 - 3" CAL. CEDAR ELM)

**PROJECT ADDRESS:**  
1550 EAST I-30  
ROCKWALL, TEXAS 75087

**OWNER INFORMATION:**  
JOHN EAGLE DEALERSHIPS  
1925 CEDAR SPRING  
SUITE 204  
DALLAS, TEXAS 75201

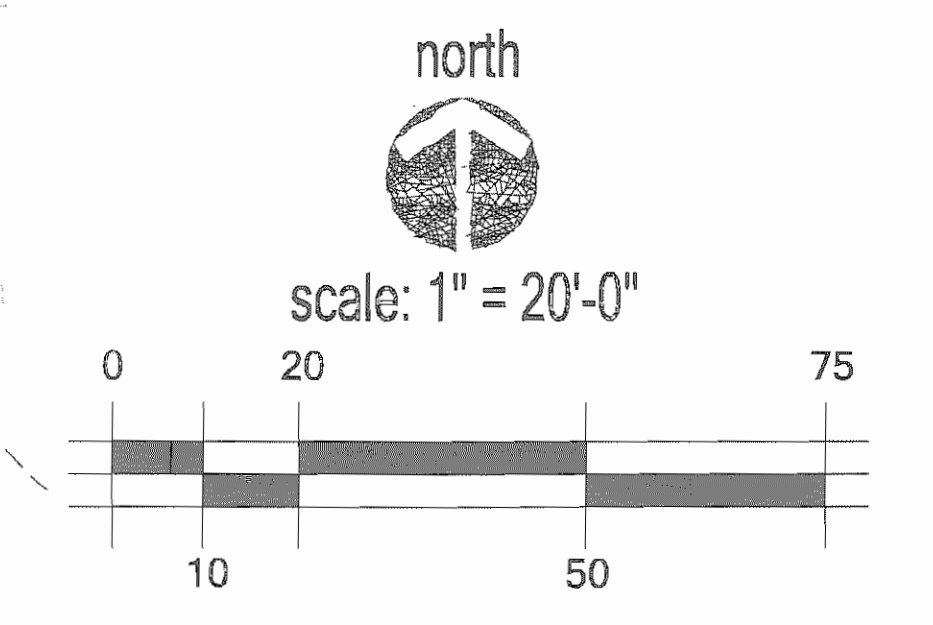

**Good Fulton & Farrell Architects**  
214-303.1800 / Tel  
214-303.1812 / Fax  
www.gff.com

2808 Fairmount Street  
Suite 300  
Dallas, Texas 75201

© Good Fulton & Farrell 2006

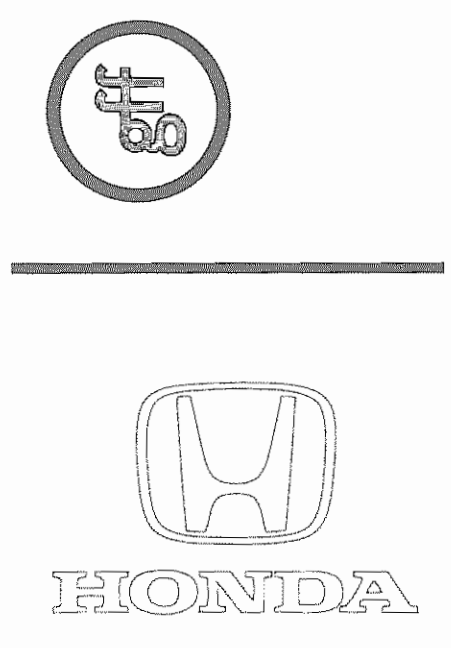

**HONDA OF ROCKWALL**  
I-30 @ THE 205 BYPASS  
ROCKWALL, TEXAS  
CITY SUBMISSION SET

No.	Date	Item	REVISIONS

SP 2011 015

NOV 21 2011

**RECEIVED**

**FILE COPY**

**Leeming Design Group**  
Landscape Architecture

4913 Rufe Snow Drive, Suite 101-B North Richland Hills, Texas 76180  
(817) 577-0889 Fax (817) 577-0896 leemingdesigngroup@gmail.com

LANDSCAPE\_PLAN

Project No. 08055.00  
Date NOVEMBER 18, 2011  
Last Revision

**L.02**

**MATCHLINE**  
REF. SHEET L.03

# MATCHLINE

REF. SHEET L.03

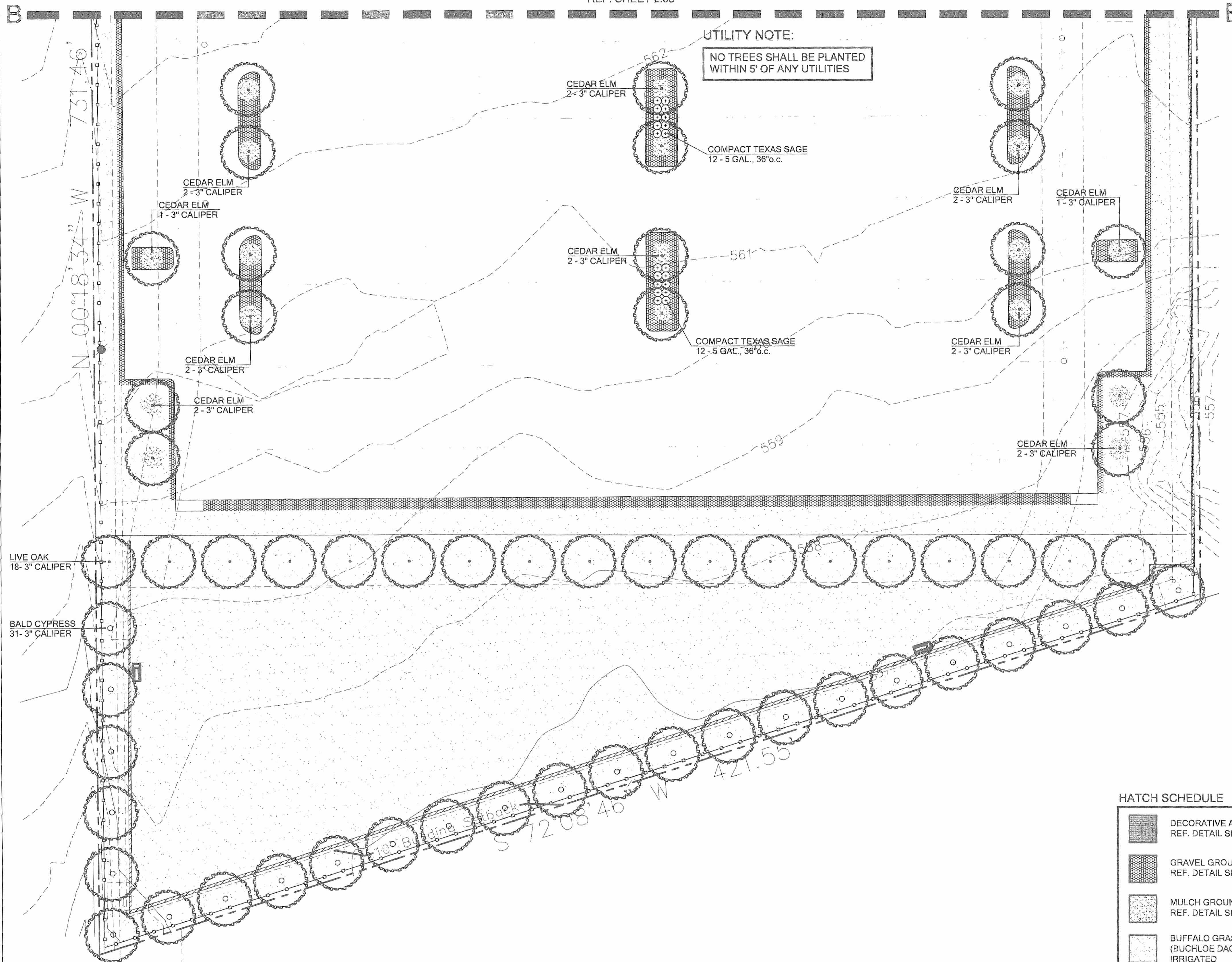

**UTILITY NOTE:**  
NO TREES SHALL BE PLANTED WITHIN 5' OF ANY UTILITIES

DRENCH WITH COMPOST TEA OR GARRETT JUICE AT TIME OF INSTALLATION

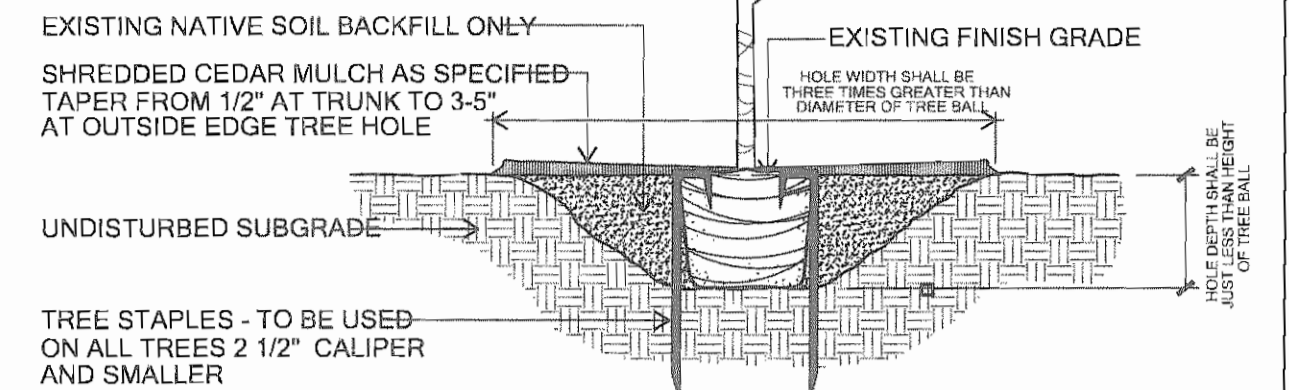

**TREE PLANTING**  
TYPICAL SHADE TREE  
not to scale

DRENCH WITH COMPOST TEA OR GARRETT JUICE AT TIME OF INSTALLATION

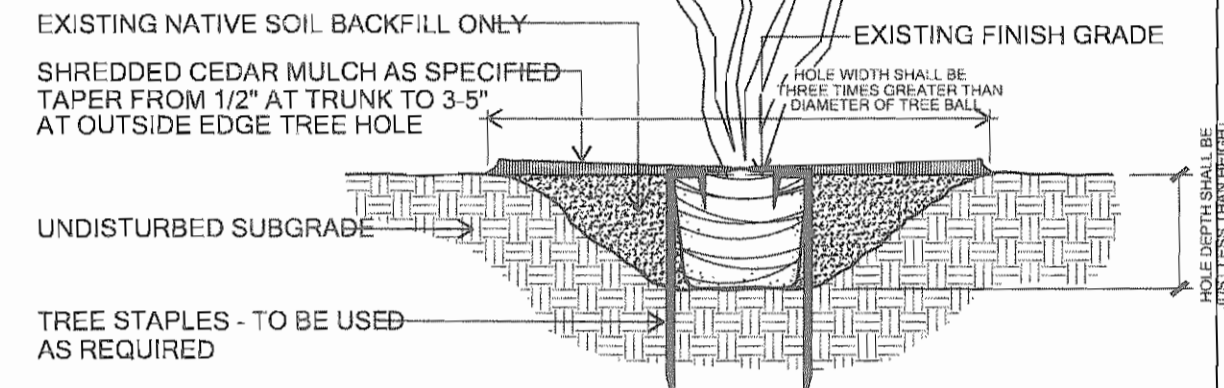

**TREE PLANTING**  
TYPICAL MULTI-TRUNK TREE  
not to scale

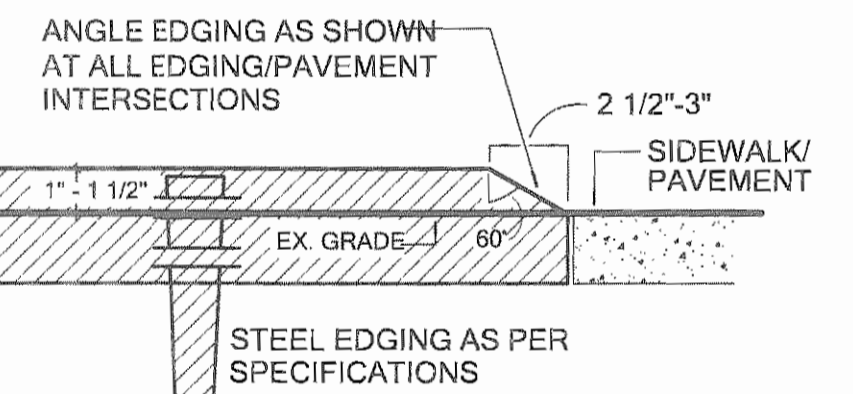

**STEEL EDGING**  
NOT TO SCALE

**HATCH SCHEDULE**

- DECORATIVE AGGREGATE  
REF. DETAIL SHEET L.03
- GRAVEL GROUNDCOVER  
REF. DETAIL SHEET L.03
- MULCH GROUNDCOVER  
REF. DETAIL SHEET L.03
- BUFFALO GRASS SOD (BUCHLOE DACTYLOIDES) IRRIGATED
- BUFFALO GRASS SEED (BUCHLOE DACTYLOIDES) TEMPORARY IRRIGATION

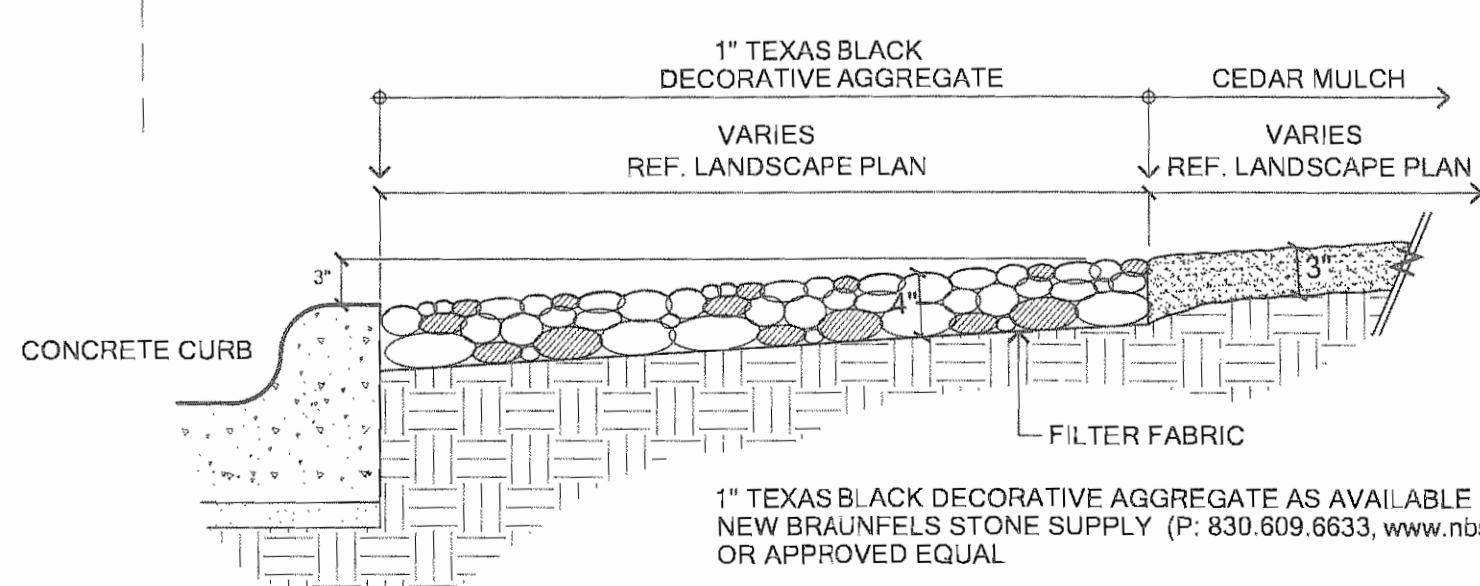

**TYPICAL DECORATIVE AGGREGATE EDGE**

SCALE: 1" = 1'-0"

1" TEXAS BLACK DECORATIVE AGGREGATE AS AVAILABLE FROM NEW BRAUNFELS STONE SUPPLY (P: 830.609.6633, www.nostone.com) OR APPROVED EQUAL

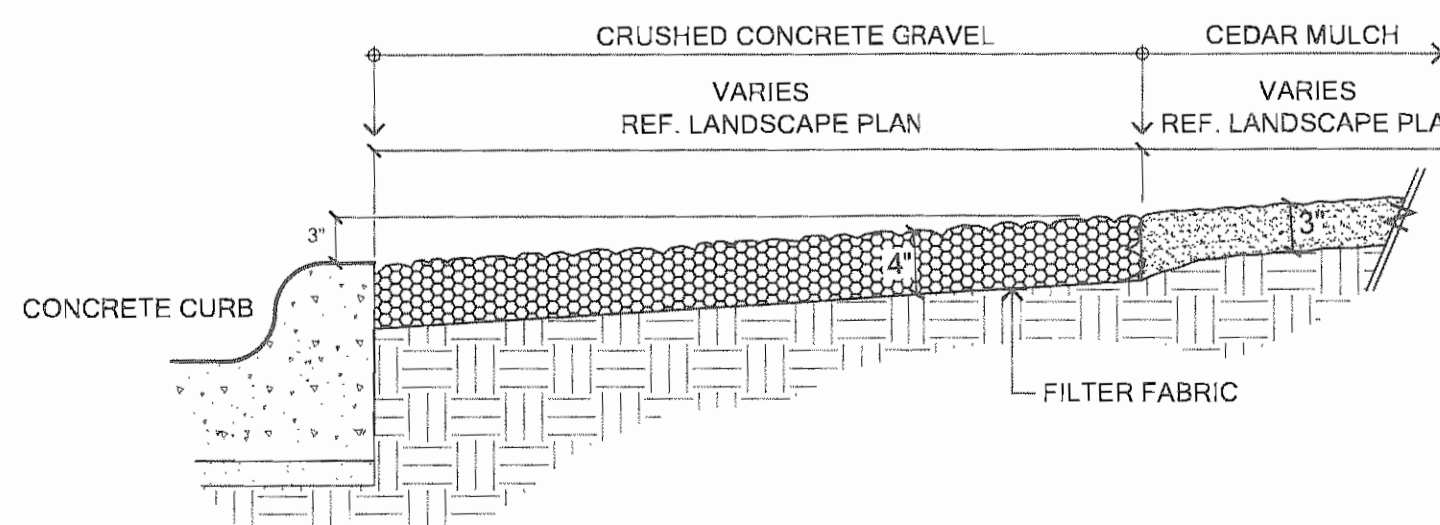

**TYPICAL GRAVEL EDGE**

SCALE: 1" = 1'-0"

**PROJECT ADDRESS:**  
1550 EAST I-30  
ROCKWALL, TEXAS 75087

**OWNER INFORMATION:**  
JOHN EAGLE DEALERSHIPS  
1925 CEDAR SPRING  
SUITE 204  
DALLAS, TEXAS 75201

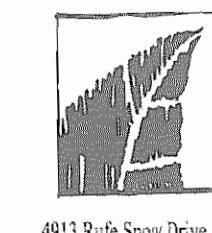

**Leeming Design Group**  
Landscape Architecture

4913 Rufe Snow Drive, Suite 101-B North Richland Hills, Texas 75180  
(817) 577-0889 Fax (817) 577-0896 leemingdesigngroup@icloud.com

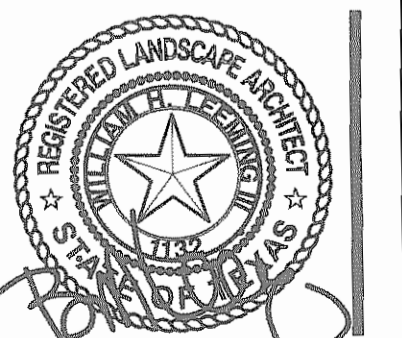

**Good Fulton & Farrell Architects**  
214.303.1500/761  
214.303.1512/Fax  
www.gff.com

2908 Fairmount Street  
Suite 300  
Dallas, Texas 75201

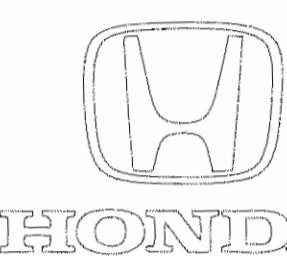
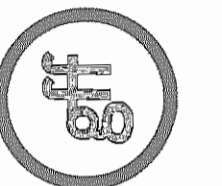

**HONDA OF ROCKWALL**  
I-30 @ THE 205 BYPASS  
ROCKWALL, TEXAS

2011

No.	Date	Item

Drawn \_\_\_\_\_  
Checked \_\_\_\_\_  
Approved \_\_\_\_\_

LANDSCAPE PLAN

Project No. 080  
Date NOVEMBER 18,  
Last Revision

PLANTLIST

MATERIAL	QNTY	SIZE	HT	SP	NOTES
BURR OAK	7	4" CAL.	12-14'	6-7'	NURSERY GROWN
QUERCUS MACROCARPA	6	4" CAL.	12-14'	6-7'	NURSERY GROWN
SHUMARD OAK	18	3" CAL.	10-12'	5-6'	NURSERY GROWN
QUERCUS SHUMARDI	8	3" CAL.	10-12'	5-6'	NURSERY GROWN
LIVE OAK	51	3" CAL.	10-12'	4-5'	NURSERY GROWN
QUERCUS VIRGINIANA	25	3" CAL.	10-12'	4-5'	NURSERY GROWN
CHINQUAPIN OAK	5	30 GAL.	8-10'	5-6'	CONTAINER GROWN
QUERCUS MUHLENBERGII	5	30 GAL.	8-10'	5-6'	CONTAINER GROWN
CEDAR ELM	7	30 GAL.	8-10'	5-6'	CONTAINER GROWN
ULMUS CRASSIFOLIA	10	30 GAL.	7-9'	4-5'	CONTAINER GROWN
BALD CYPRESS	22	4-5' HT.	4-5'	30-36"	NURSERY GROWN
TAXODIUM DISTICHUM	57	5 GAL.	42"	15"	FULL
CRAPE MYRTLE	204	5 GAL.	30"	24"	FULL
LAGERSTROEMIA INDICA 'NATCHEZ'	65	5 GAL.	24"	20"	FULL
WAX MYRTLE	5	5 GAL.	15"	15"	FULL
LAGERSTROEMIA INDICA 'NATCHEZ'	7	30 GAL.	8-10'	5-6'	CONTAINER GROWN
REDBUD	158	5 GAL.	18"	15"	FULL
CERCIS CANADENSIS	3	5 GAL.	24"	15"	FULL
MEXICAN PLUM	5	5 GAL.	15"	15"	FULL
PRUNUS MEXICANA	49	5 GAL.	15"	18"	FULL
EASTERN RED CEDAR	120	3 GAL.	15"	15"	FULL
JUNIPERUS VIRGINIANA	120	3 GAL.	15"	15"	FULL
SKYROCKET JUNIPER	75	1 GAL.	10"	10"	FULL
JUNIPERUS VIRGINIANA 'SKYROCKET'	60	4" POTS	6"	6"	FULL
MISCANTHUS	338	LIN. FT.			REF. DETAIL
MISCANTHUS SINENSIS 'MORNING LIGHT'					
COMPACT TEXAS SAGE					
LEUCOPHYLLUM FRUTESCENS 'COMPACTUM'					
SOFT LEAF YUCCA					
YUCCA RECURVIFOLIA					
RED YUCCA					
HESPERALOE PARVIFOLIA					
KNOCKOUT ROSE					
ROSA 'RADRAZZ'					
ADAM'S NEDDLE YUCCA					
YUCCA FILAMENTOSA					
GULF MUHLY					
MUHLENBERGIA CAPILLARIS					
TURK'S CAP					
MALVAVISCUS DRUMMONDII					
SALVIA 'PINK'					
SALVIA GREGGII					
BOSTON IVY					
PARTHENOCISSUS TRICUSPADATA 'LOWII'					
HAMELN GRASS					
PENNISETUM ALOPECUROIDES 'HAMELN'					
PINE MUHLY					
MUHLENBERGIA DUBIA					
WOOLLY STEMODIA					
STEMODIA TOMENTOSA					
LANTANA					
LANTANA SPP 'GOLD'					
STEEL EDGING					

LANDSCAPE NOTES

- PLANT LIST FOR SHEETS L.02 THRU L.04.
- PLANT LIST TO BE USED AS AIDE TO BIDDER ONLY. LANDSCAPE CONTRACTOR TO VERIFY ALL QUANTITIES.
- ALL BED AREAS SHALL BE SEPARATED FROM TURF AREAS WITH STEEL EDGING.
- ALL LANTANA BEDS AND SERVICE BAY ISLAND SHALL BE TILLED TO A DEPTH OF 4-6", RAKING OUT ALL DEAD VEGETATION.
- APPLY A 2-3" DEPTH OF ORGANIC MATERIAL OVER ENTIRE BED AND TILL INTO EXISTING SOIL. ORGANIC MATERIAL SHALL BE ONE OF FOLLOWING:  
 VITAL EARTH COMPOST  
 BACK-TO-EARTH SOIL CONDITIONER  
 LIVING EARTH COMPOST  
 SOIL BUILDING SYSTEMS COMPOST  
 SILVER CREEK MATERIALS COMPOST
- ALL SHRUBS PLANTED GREATER THAN 36" O.C. SHALL BE PIT-PLANTED AND BACK-FILLED WITH 1/3 ORGANIC MATERIAL (REF. NOTE 5) AND 2/3 EXISTING SOIL.
- TOPDRESS ENTIRE BED AREAS AS SHOWN AND PLANTINGS WITH MINIMUM 3" DEPTH SHREDDED NATIVE CEDAR MULCH.
- ALL SHADE AND ORNAMENTAL TREES SHALL BE PLANTED AS PER DETAILS ON SHEET L.04.

HATCH SCHEDULE

	DECORATIVE AGGREGATE REF. DETAIL SHEET L.03
	GRAVEL GROUNDCOVER REF. DETAIL SHEET L.03
	MULCH GROUNDCOVER REF. DETAIL SHEET L.03
	BUFFALO GRASS SOD (BUCHLOE DACTYLOIDES) IRRIGATED
	BUFFALO GRASS SEED (BUCHLOE DACTYLOIDES) TEMPORARY IRRIGATION

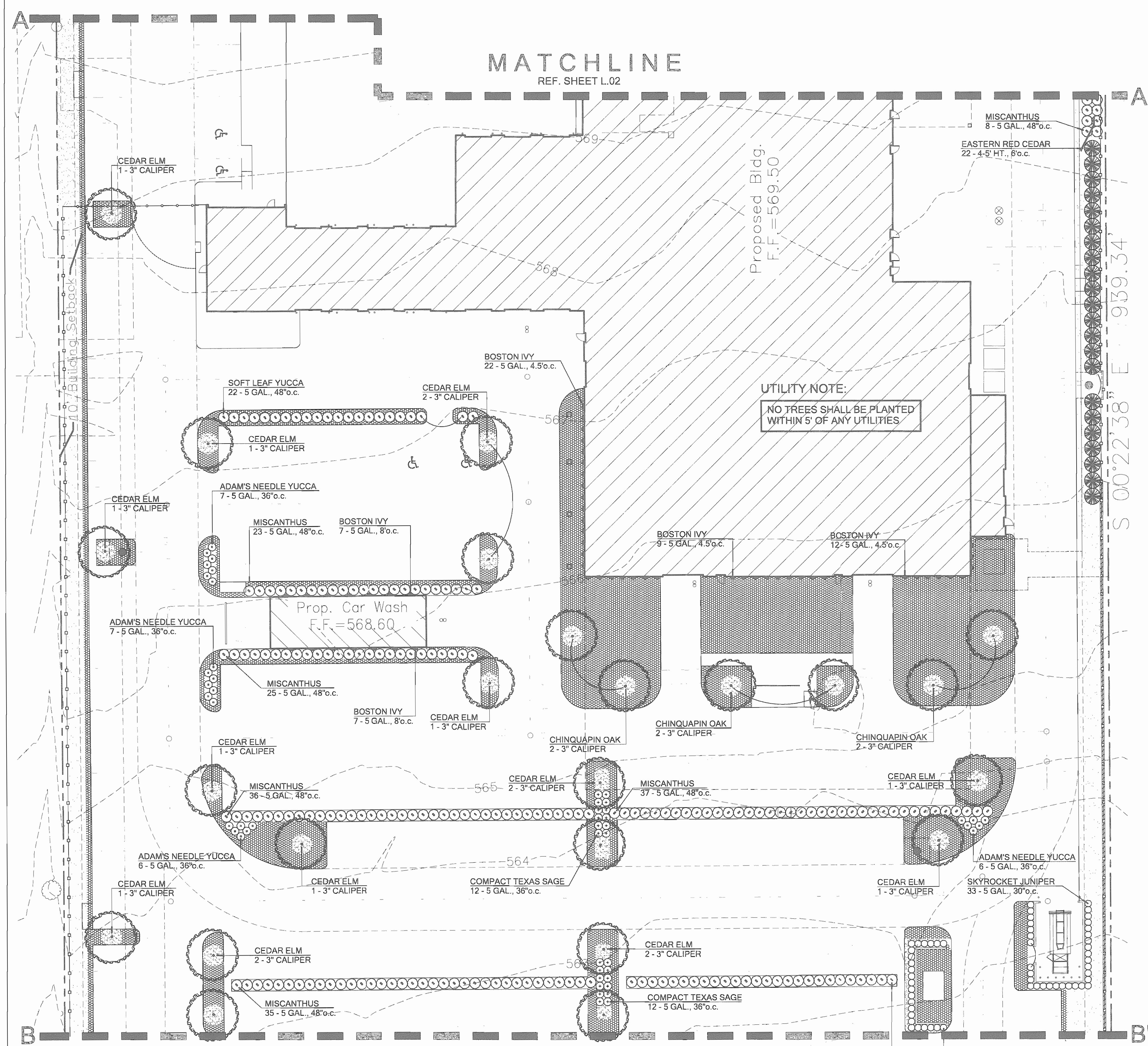
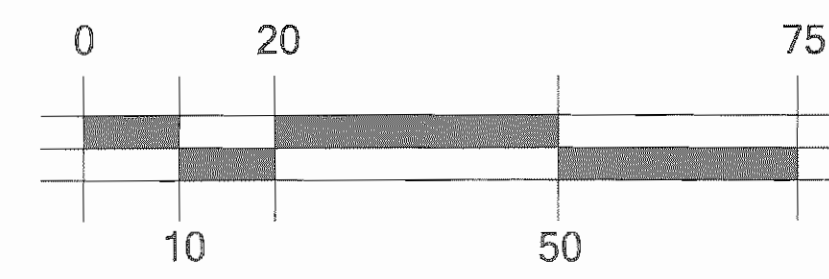
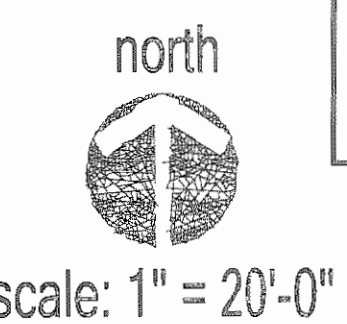

Proposed Bldg.  
F.F. = 569.150

UTILITY NOTE:  
NO TREES SHALL BE PLANTED  
WITHIN 5' OF ANY UTILITIES

Prop. Car Wash  
F.F. = 568.60

PROJECT ADDRESS:  
1550 EAST I-30  
ROCKWALL, TEXAS 75087  
  
OWNER INFORMATION:  
JOHN EAGLE DEALERSHIPS  
1925 CEDAR SPRING  
SUITE 204  
DALLAS, TEXAS 75201

MATCHLINE  
REF. SHEET L.04

Leeming Design Group  
Landscape Architecture  
4913 Rufe Snow Drive, Suite 101-B North Richland Hills, Texas 76180  
(817) 577-9889 Fax (817) 577-9886 leemingdesigngroup@leemingdesign.com



Good Fulton & Farrell Architects  
2008 Fairmount Street  
Suite 300  
Dallas, Texas 75201  
www.gff.com

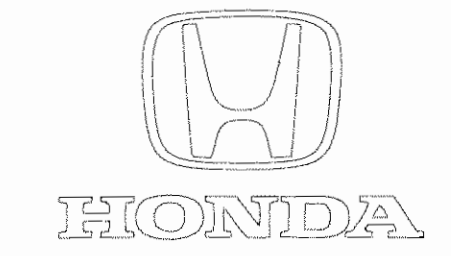
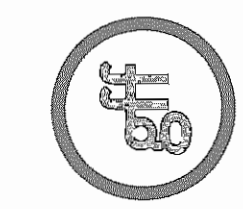

HONDA OF ROCKWALL  
I-30 @ THE 205 BYPASS  
ROCKWALL, TEXAS  
CITY SUBMISSION SET

No.	Date	Item
1	2011	015

RECEIVED  
NOV 21 2011  
FILED

LANDSCAPE\_PLAN  
  
Project No. 08055.00  
Date NOVEMBER 18, 2011  
Last Revision L.03