



City of Rockwall

Planning & Zoning Department
 385 S. Goliad Street
 Rockwall, Texas 75032
 (P): (972) 771-7745
 (W): www.rockwall.com

The City of Rockwall GIS maps are continually under development and therefore subject to change without notice. While we endeavor to provide timely and accurate information, we make no guarantees. The City of Rockwall makes no warranty, express or implied, including warranties of merchantability and fitness for a particular purpose. Use of the information is the sole responsibility of the user.





City of Rockwall

Planning & Zoning Department
385 S. Goliad Street
Rockwall, Texas 75087
(P): (972) 771-7745
(W): www.rockwall.com

The City of Rockwall GIS maps are continually under development and therefore subject to change without notice. While we endeavor to provide timely and accurate information, we make no guarantees. The City of Rockwall makes no warranty, express or implied, including warranties of merchantability and fitness for a particular purpose. Use of the information is the sole responsibility of the user.

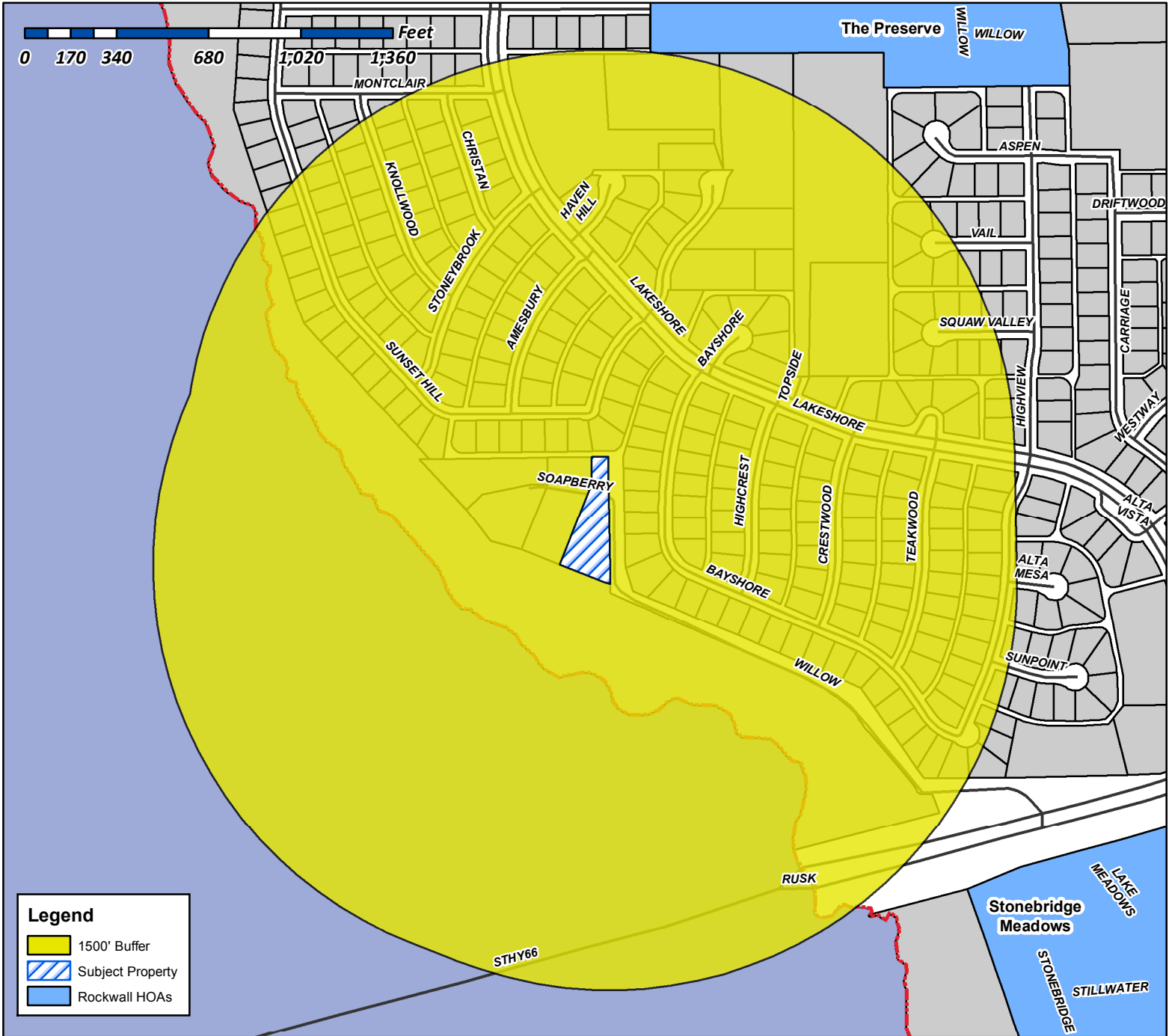

Case Number: Z2017-064
Case Name: 4 Soapberry Ln
Case Type: Zoning
Zoning: SUP
Case Address: 4 Soapberry Ln

Date Created: 11/21/2017
For Questions on this Case Call (972) 771-7745

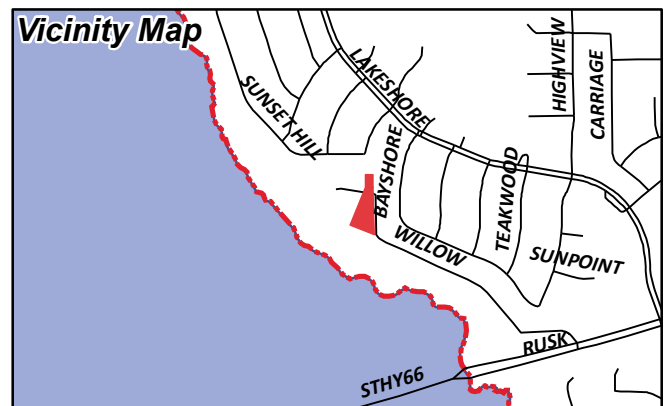





City of Rockwall

Planning & Zoning Department
385 S. Goliad Street
Rockwall, Texas 75087
(P): (972) 771-7745
(W): www.rockwall.com

The City of Rockwall GIS maps are continually under development and therefore subject to change without notice. While we endeavor to provide timely and accurate information, we make no guarantees. The City of Rockwall makes no warranty, express or implied, including warranties of merchantability and fitness for a particular purpose. Use of the information is the sole responsibility of the user.



Legend

-  Subject Property
-  500' Buffer
-  Notified Properties

Case Number: Z2017-064
Case Name: 4 Soapberry Ln
Case Type: Zoning
Zoning: SUP
Case Address: 4 Soapberry Ln

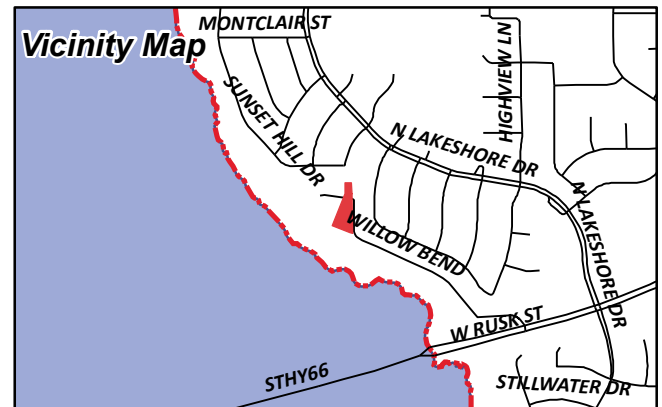

Date Created: 11/21/2017
For Questions on this Case Call (972) 771-7745

CURRENT RESIDENT
1 SOAPBERRY LN
ROCKWALL, TX 75032

PARKER KIM L
101 HIGHCREST LN
ROCKWALL, TX 75087

CURRENT RESIDENT
103 HIGHCREST LN
ROCKWALL, TX 75032

PATTERSON PAT A & JUDYE
105 HIGHCREST LN
ROCKWALL, TX 75087

CONFIDENTIAL
107 HIGHCREST LN
ROCKWALL, TX 75087

HOLCOMB GARY CHRIS
109 HIGHCREST LN
ROCKWALL, TX 75087

CURRENT RESIDENT
111 HIGHCREST LN
ROCKWALL, TX 75032

CURRENT RESIDENT
1117 BAYSHORE DR
ROCKWALL, TX 75032

BAZARGANI AZRA
1119 BAYSHORE DRIVE
ROCKWALL, TX 75087

VIERLING DENNIS A AND LISA F
1121 BAYSHORE DR
ROCKWALL, TX 75087

MEIER CONNIE M
1123 BAYSHORE DR
ROCKWALL, TX 75087

VOLPERT JOHN
1125 BAYSHORE DR
ROCKWALL, TX 75087

MADDOX GAYLA
1126 BAYSHORE DR
ROCKWALL, TX 75087

ELDRIDGE CHARLES E II & SHELBY M
1127 BAYSHORE DR
ROCKWALL, TX 75087

BUTTS JORDAN M AND ELIZABETH
1128 BAYSHORE DR
ROCKWALL, TX 75087

WISE RICHARD ALLEN AND DONALD W RASBURY
REVOCABLE LIVING TRUSTE
RICHARD ALLEN WISE AND DONALD W RASBURY
TRUSTEES
1129 BAYSHORE DR
ROCKWALL, TX 75087

HELMS CHYL
113 HIGHCREST LN
ROCKWALL, TX 75087

EATMAN JAMES BERNARD AND GWENDOLYN
ESTHER
1130 BAYSHORE DR
ROCKWALL, TX 75087

SAUNDERS BRIAN AND LAUREN
1131 BAYSHORE DR
ROCKWALL, TX 75087

PAYNE ALLAN CLARK ETUX
1132 BAYSHORE DR
ROCKWALL, TX 75087

HENRY CHRIS S AND ANGELA D
1133 BAYSHORE DR
ROCKWALL, TX 75087

SMITH JENNIFER E
1134 BAYSHORE DR
ROCKWALL, TX 75087

MARTIN JESSIE L
1135 BAYSHORE DR
ROCKWALL, TX 75087

KELLEY CLYDE EUGENE INDIVIDUAL LIVING
TRUST
1136 BAYSHORE DR
ROCKWALL, TX 75087

HAWKINS RONALD T & JENIREE R
1137 BAYSHORE DR
ROCKWALL, TX 75087

DOYLE LINDA M & MALCOLM P
1138 BAYSHORE DR
ROCKWALL, TX 75087

WRIGHT MICHAEL G & EDITH M
1139 BAYSHORE DR
ROCKWALL, TX 75087

CURRENT RESIDENT
1140 BAYSHORE DR
ROCKWALL, TX 75032

GRAY JOE E ETUX
1141 BAYSHORE DR
ROCKWALL, TX 75087

CURRENT RESIDENT
1143 BAYSHORE DR
ROCKWALL, TX 75032

BERG KRISTINA
115 HIGHCREST LANE
ROCKWALL, TX 75087

MCCALLUM DARRELL A AND SHARON F
1535 E I-30
ROCKWALL, TX 75087

HESTER ROGER F II
1601 SUNSET HILL DR
ROCKWALL, TX 75087

HANNA ANNA CHRISTINE
1602 SUNSET HILL DR
ROCKWALL, TX 75087

CURRENT RESIDENT
1603 SUNSET HILL DR
ROCKWALL, TX 75032

CURRENT RESIDENT
1604 SUNSET HILL DR
ROCKWALL, TX 75032

KLUTTS BEN ALLEN JR
1604 NORTH HILLS DR
ROCKWALL, TX 75087

CURRENT RESIDENT
1605 SUNSET HILL DR
ROCKWALL, TX 75032

MULDER LINDA FAYE
1606 SUNSET HILL DR
ROCKWALL, TX 75087

JOHNSTON ALTON W & PEGGY F
1607 AMESBURY LN
ROCKWALL, TX 75087

MITCHELL DENNIS E ETUX
1607 SUNSET HILL DR
ROCKWALL, TX 75087

LEAL JR FEDERICO MARTINEZ AND VERONICA
1608 SUNSET HILL DR
ROCKWALL, TX 75087

CURRENT RESIDENT
1609 SUNSET HILL DR
ROCKWALL, TX 75032

BARTENSTEIN WILLIAM
1609 AMESBURY LN
ROCKWALL, TX 75087

TUCKER EARL W & MELINDA K
1610 AMESBURY LN
ROCKWALL, TX 75087

SCAMPERINO CHARLES
1611 AMESBURY LN
ROCKWALL, TX 75087

BURKS GLENN H & PAULETTE
1612 AMESBURY LN
ROCKWALL, TX 75087

ROGERS JOHN R & SHIRLEY J
1613 AMESBURY LN
ROCKWALL, TX 75087

LYNCH PATRICIA A
1614 AMESBURY LN
ROCKWALL, TX 75087

BREWER THOMAS D AND KASIE
1615 AMESBURY LN
ROCKWALL, TX 75087

OFFUTT DENNIS O & GLENDA K
1616 AMESBURY LN
ROCKWALL, TX 75087

RIDDELL RONALD SCOTT II AND SHANNON
MCCORD VRZAK
2 SOAPBERRY LN
ROCKWALL, TX 75032

RASH ROBERT D
3 SOAPBERRY LN
ROCKWALL, TX 75087

RASH RANDALL L & KAREN
4 SOAPBERRY LN
ROCKWALL, TX 75087

FERRENTINO WAYNE J
501 SUNSET HILL DR
ROCKWALL, TX 75087

SNYDER TIMOTHY S
503 SUNSET HILL DR
ROCKWALL, TX 75087

DEAN GREG
505 SUNSET HILL DR
ROCKWALL, TX 75087

JACKSON CRAIG A & JULIEANN J
507 SUNSET HILL DR
ROCKWALL, TX 75087

PETERSON BRYCE M & SANDRA
509 SUNSET HILL DR
ROCKWALL, TX 75087

KING MARILYN
511 SUNSET HILL DR
ROCKWALL, TX 75087

STIEGELMAR RICHARD AND
STIEGELMAR JACK
542 YACHT CLUB DR
ROCKWALL, TX 75032

CLOVERDALE RANCH LLC
ONE BRIGHT MEADOW ROAD
ROCKWALL, TX 75032

KJT FLYING PROPERTIES LLC
PO BOX 1476
ROCKWALL, TX 75087

WIENEKE ELAINE
PO BOX 1623
ROCKWALL, TX 75087

COOK DEBORAH SUE
PO BOX 261543
PLANO, TX 75026

November 10, 2010

The purpose of this request is to have permission to enclose an existing shed approved and built in 2003.

It was originally permitted as an "RV Shed". We are requesting permission now to enclose the structure for security purposes for the storage of trailers, tractors, and other yard equipment.

Attached are pictures of the existing structure, and our plans are to enclose it between the existing brick columns with R9 metal panels, with doors on the front of the structure. Plans are to use non-glossy green panels.

Please contact Robert (Bob) Rash with any questions, or other needed information.

Robert (Bob) Rash

3 Soapberry Lane

Rockwall, TX 78087

214-557-0537

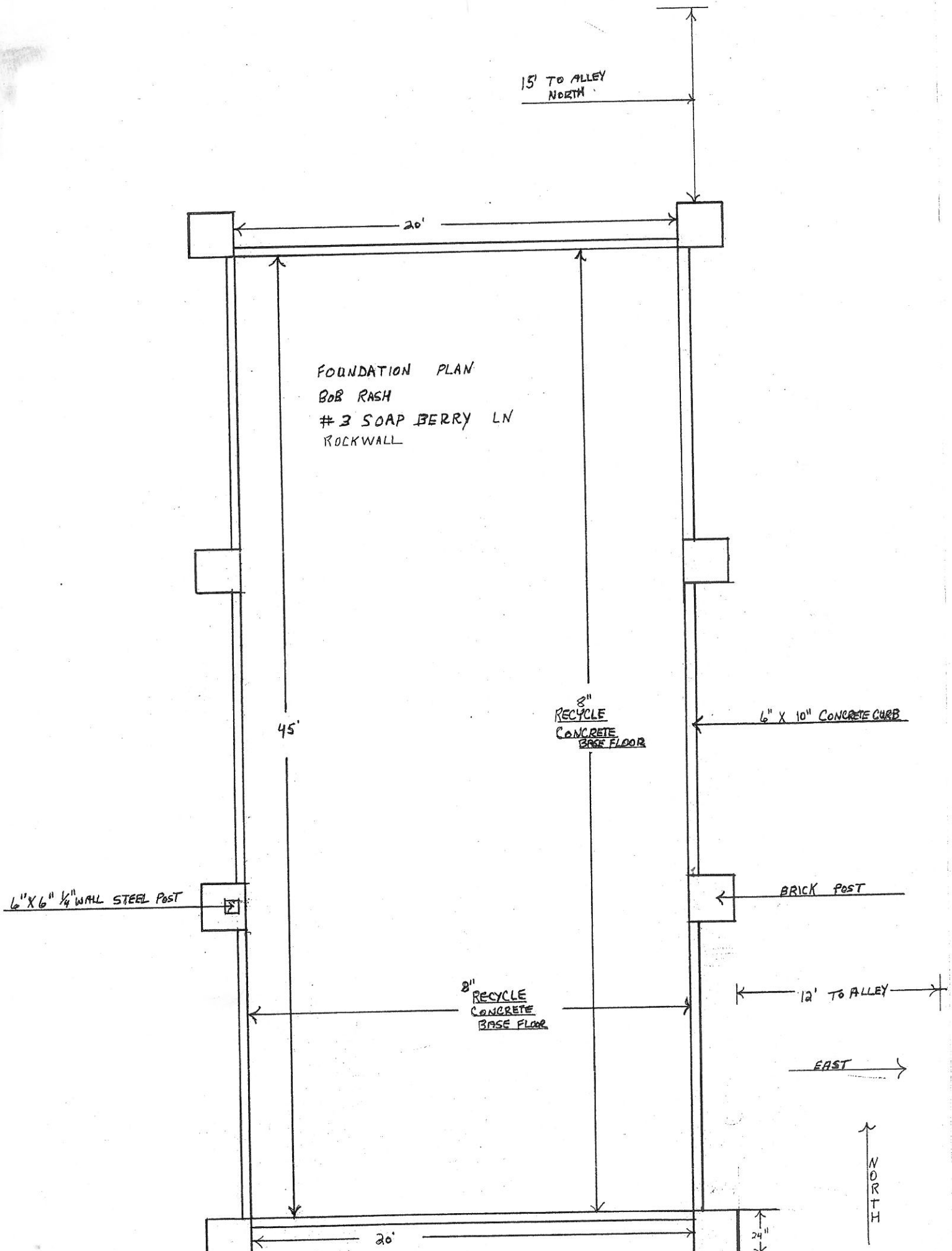



Soapberry Ln

Willow Bend

4 Soapberry

