

0 50 100 200 300 400 Feet

Z2016-022- SUP FOR SPR PACKAGING  
SUP - LOCATION MAP = 

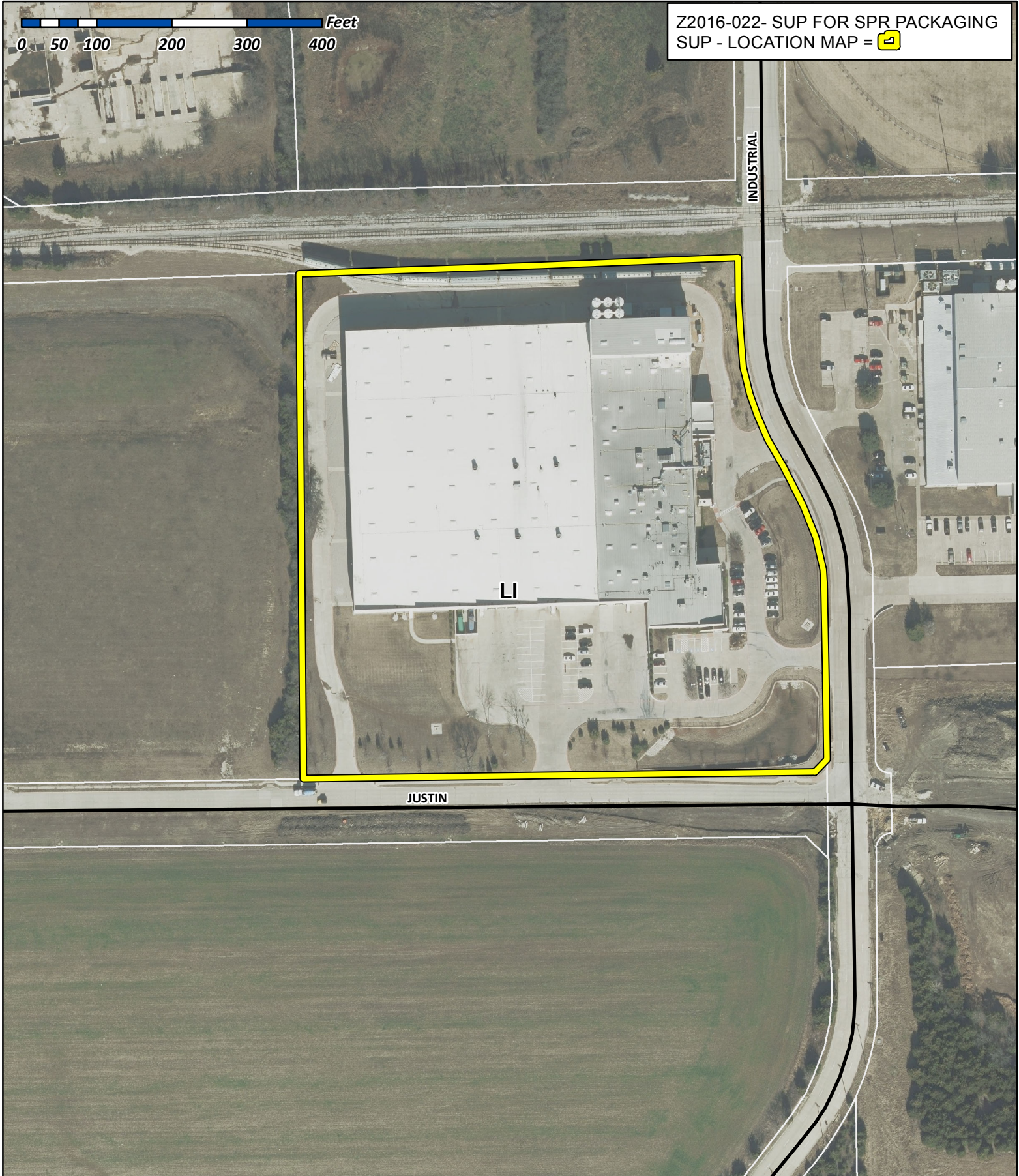

# City of Rockwall

Planning & Zoning Department  
385 S. Goliad Street  
Rockwall, Texas 75032  
(P): (972) 771-7745  
(W): [www.rockwall.com](http://www.rockwall.com)

The City of Rockwall GIS maps are continually under development and therefore subject to change without notice. While we endeavor to provide timely and accurate information, we make no guarantees. The City of Rockwall makes no warranty, express or implied, including warranties of merchantability and fitness for a particular purpose. Use of the information is the sole responsibility of the user.

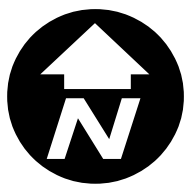







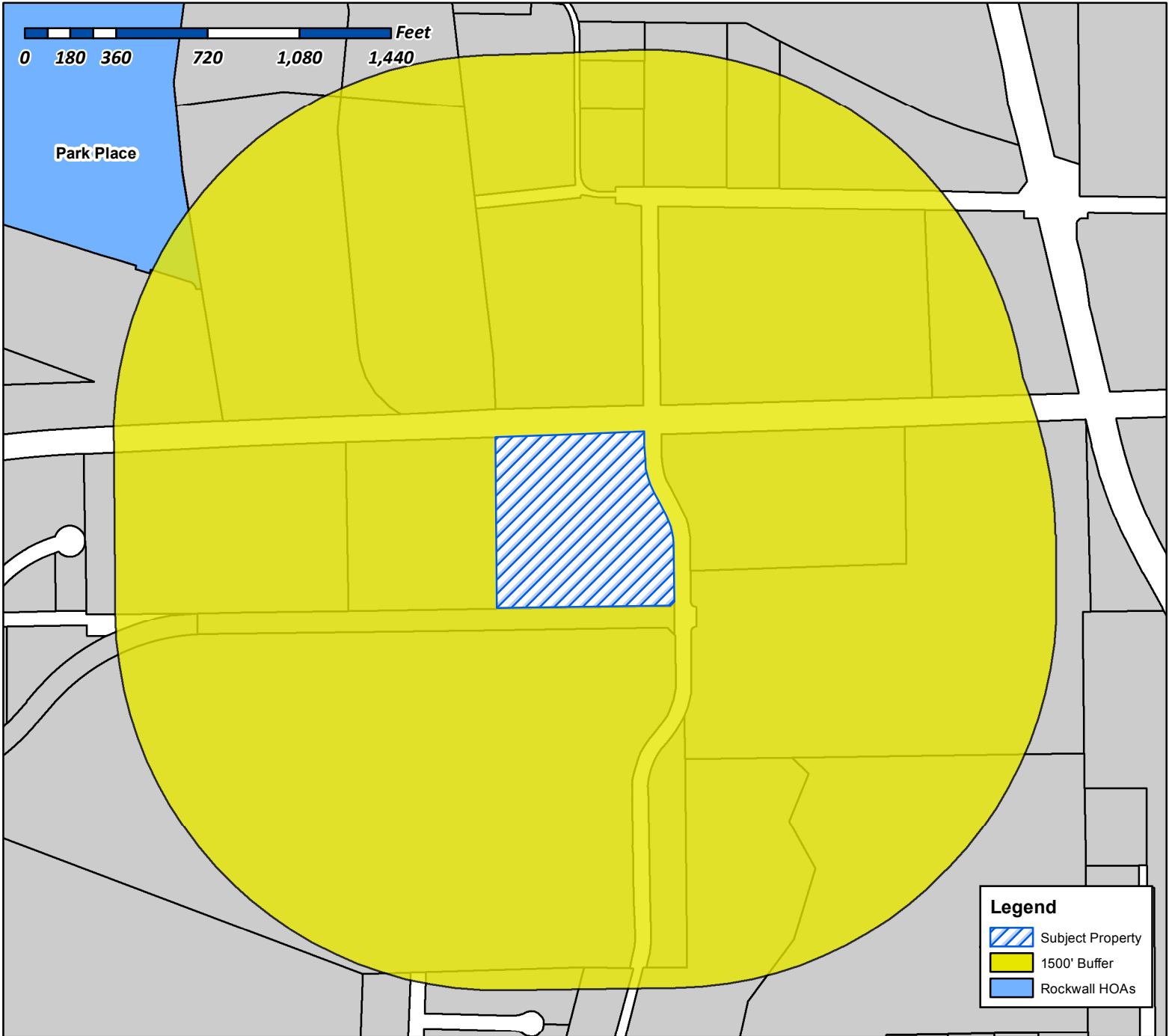
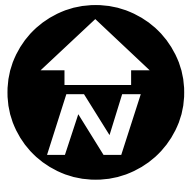

# City of Rockwall

Planning & Zoning Department  
385 S. Goliad Street  
Rockwall, Texas 75087  
(P): (972) 771-7745  
(W): www.rockwall.com

The City of Rockwall GIS maps are continually under development and therefore subject to change without notice. While we endeavor to provide timely and accurate information, we make no guarantees. The City of Rockwall makes no warranty, express or implied, including warranties of merchantability and fitness for a particular purpose. Use of the information is the sole responsibility of the user.



**Legend**

-  Subject Property
-  1500' Buffer
-  Rockwall HOAs

**Case Number:** Z2016-022  
**Case Name:** SUP for SPR Packaging  
**Case Type:** Specific Use Permit  
**Zoning:** Light Industrial (LI) District  
**Case Address:** 1480 Justin Road

**Date Created:** 07/14/2016  
 For Questions on this Case Call (972) 771-7745

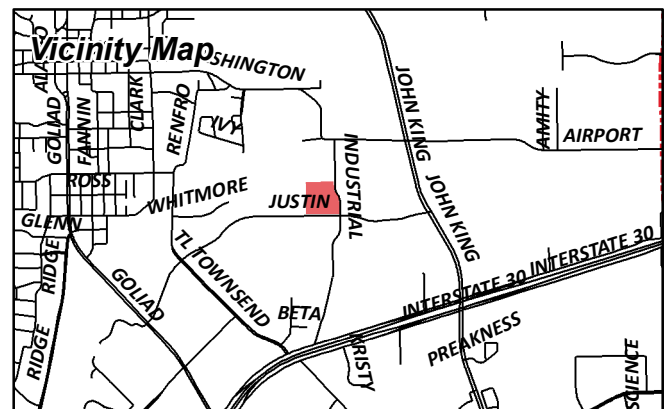



# City of Rockwall

Planning & Zoning Department  
385 S. Goliad Street  
Rockwall, Texas 75087  
(P): (972) 771-7745  
(W): www.rockwall.com

The City of Rockwall GIS maps are continually under development and therefore subject to change without notice. While we endeavor to provide timely and accurate information, we make no guarantees. The City of Rockwall makes no warranty, express or implied, including warranties of merchantability and fitness for a particular purpose. Use of the information is the sole responsibility of the user.

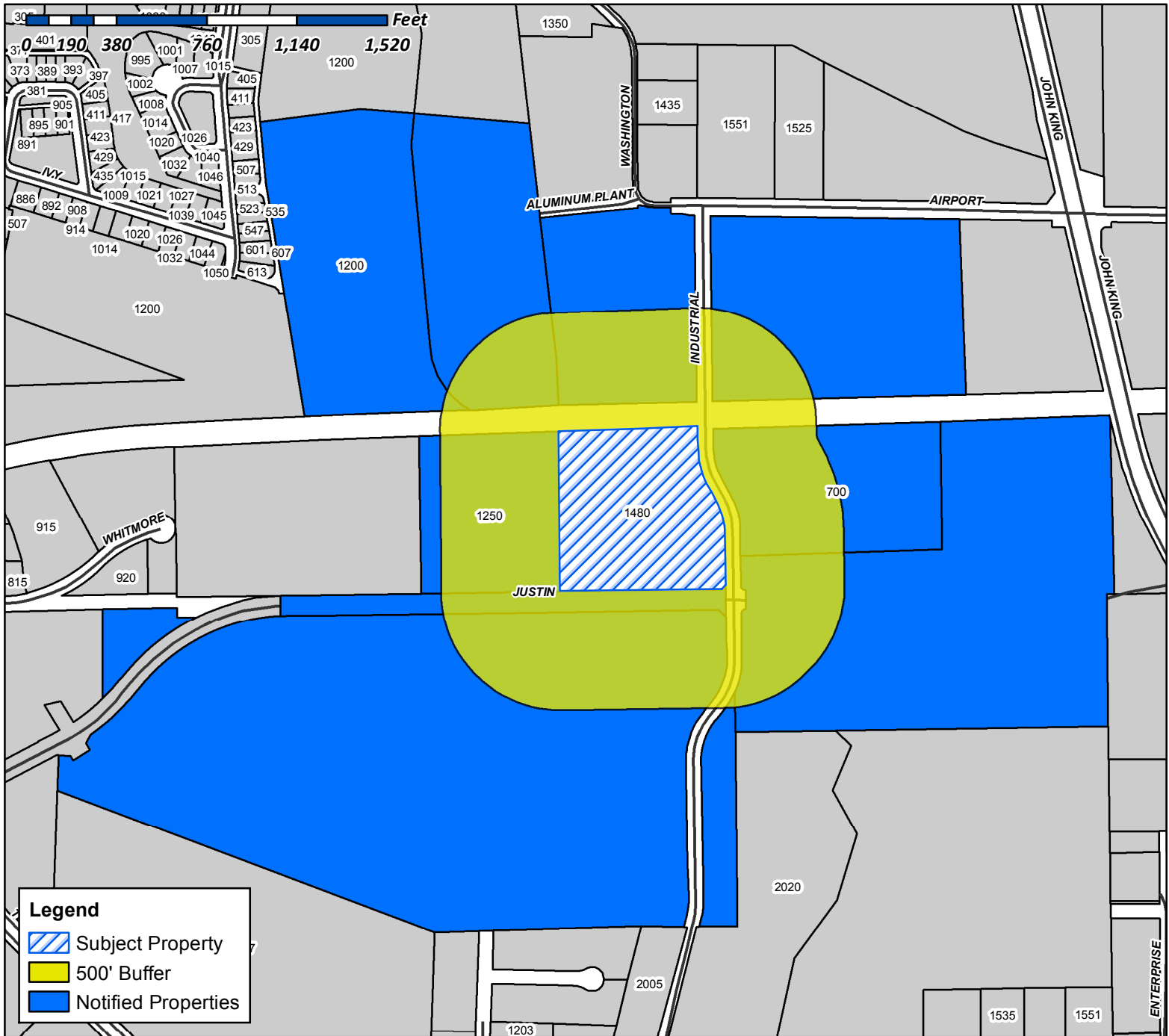

**Case Number:** Z2016-022  
**Case Name:** SUP for SPR Packaging  
**Case Type:** Specific Use Permit  
**Zoning:** Light Industrial (LI) District  
**Case Address:** 1480 Justin Road

**Date Created:** 07/14/2016  
 For Questions on this Case Call (972) 771-7745

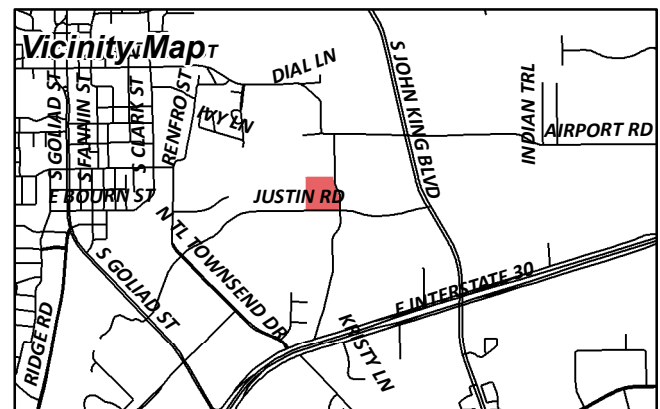

SMARTT LOFLAND & J BOND PTNRS  
1 CARMARTHEN CT  
DALLAS, TX 75225

CURRENT RESIDENT  
1200 E WASHINGTON  
ROCKWALL, TX 75087

CURRENT RESIDENT  
1250 JUSTIN RD  
ROCKWALL, TX 75087

FLEXLAND LP  
1480 JUSTIN RD  
ROCKWALL, TX 75087

ALVAPLAST US INC  
1480 JUSTIN RD  
ROCKWALL, TX 75087

CONTINENTAL PET TECHNOLOGY  
GRAHAM PACKAGING PET TECH INC  
2401 PLEASANT VALLEY RD  
YORK, PA 17402

COLUMBIA EXTRUSION CORP  
ATTN: BILL BRICKER  
305 PARK PLACE BLVD  
ROCKWALL, TX 75087

ROCKWALL COMMERCIAL PROPERTY  
MANAGEMENT LLC  
305 PARK PLACE BLVD  
ROCKWALL, TX 75087

CURRENT RESIDENT  
700 INDUSTRIAL  
ROCKWALL, TX 75087

WHITMORE MANUFACTURING CO  
930 WHITMORE DRIVE  
ROCKWALL, TX 75087

ROCKWALL ECONOMIC DEVELOPMENT  
PO BOX 968  
ROCKWALL, TX 75087



5:17:33 PM 7/12/2016 s:\draw\1620\_SFR\_High-Bay\_Extuder\_Room\_Expansion\CDs\1620A1-0.sht  
© 2015, THIS DOCUMENT AND THE DESIGNS CONTAINED THEREIN REMAINS THE PROPERTY OF PROSS DESIGN GROUP, INC. AS AN INSTRUMENT OF PROFESSIONAL SERVICE. IT IS NOT TO BE USED IN WHOLE OR IN PART FOR ANY OTHER PURPOSE WITHOUT THE WRITTEN PERMISSION OF PROSS DESIGN GROUP.

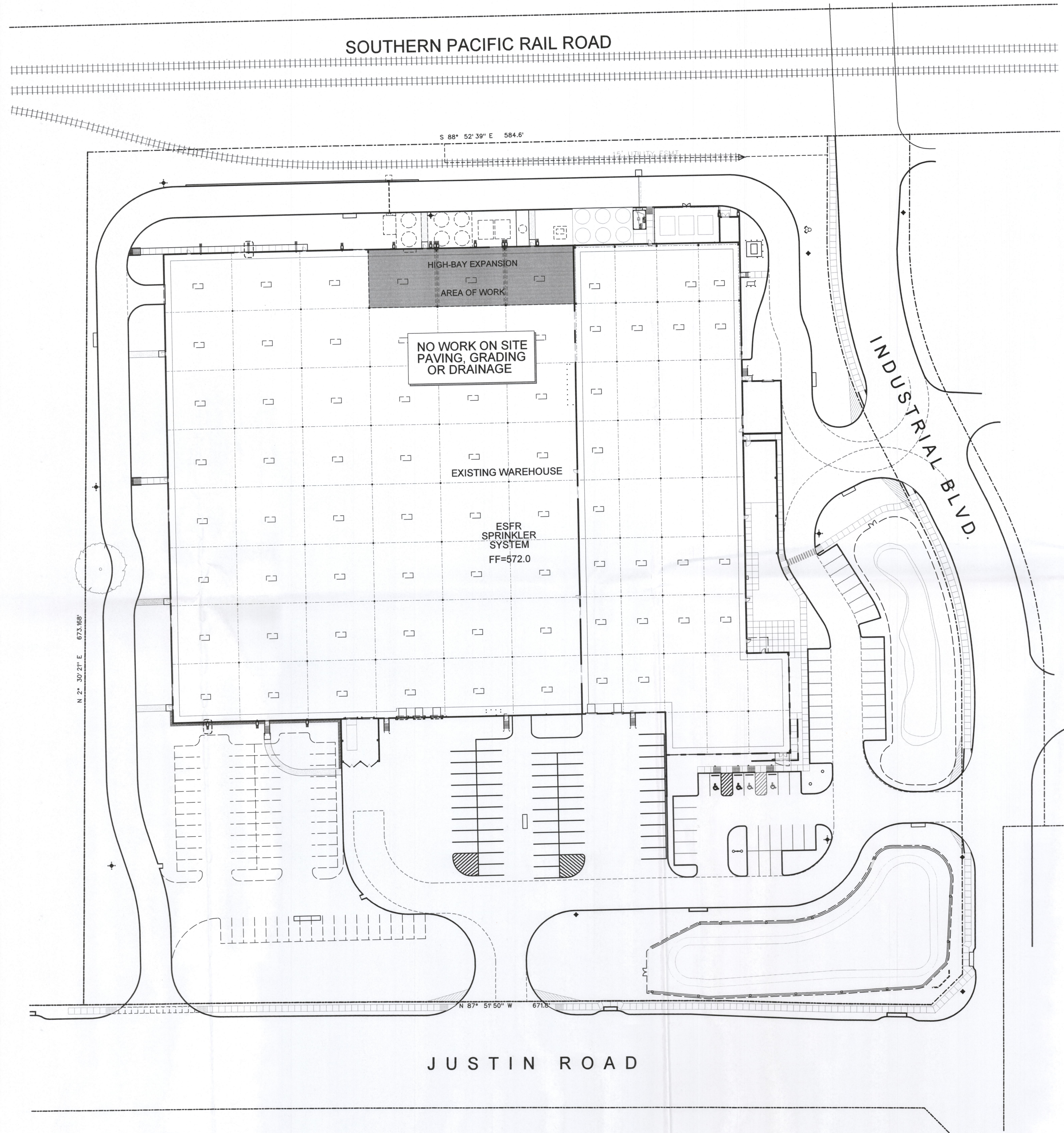

NORTH  
  
**1 SITE PLAN**  
SCALE: 1"=40'-0"

drawn: BD  
checked: MARK W. PROSS  
date: 07/12/2016

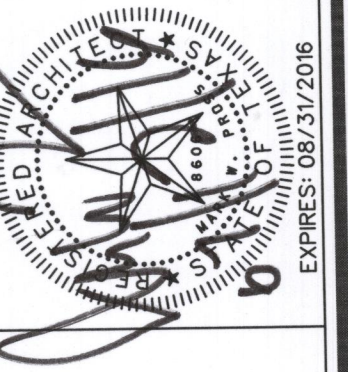

**SPR EXTRUDER TOWER  
HIGH BAY EXPANSION**  
ROCKWALL, TEXAS

job no  
1620  
sheet  
**A1.0**



