

Z2016-013- ROCHELLE ESTATES
 ZONING - LOCATION MAP = 1



City of Rockwall

Planning & Zoning Department
 385 S. Goliad Street
 Rockwall, Texas 75032
 (P): (972) 771-7745
 (W): www.rockwall.com

The City of Rockwall GIS maps are continually under development and therefore subject to change without notice. While we endeavor to provide timely and accurate information, we make no guarantees. The City of Rockwall makes no warranty, express or implied, including warranties of merchantability and fitness for a particular purpose. Use of the information is the sole responsibility of the user.

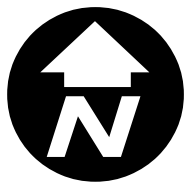



City of Rockwall

Planning & Zoning Department
385 S. Goliad Street
Rockwall, Texas 75087
(P): (972) 771-7745
(W): www.rockwall.com

The City of Rockwall GIS maps are continually under development and therefore subject to change without notice. While we endeavor to provide timely and accurate information, we make no guarantees. The City of Rockwall makes no warranty, express or implied, including warranties of merchantability and fitness for a particular purpose. Use of the information is the sole responsibility of the user.

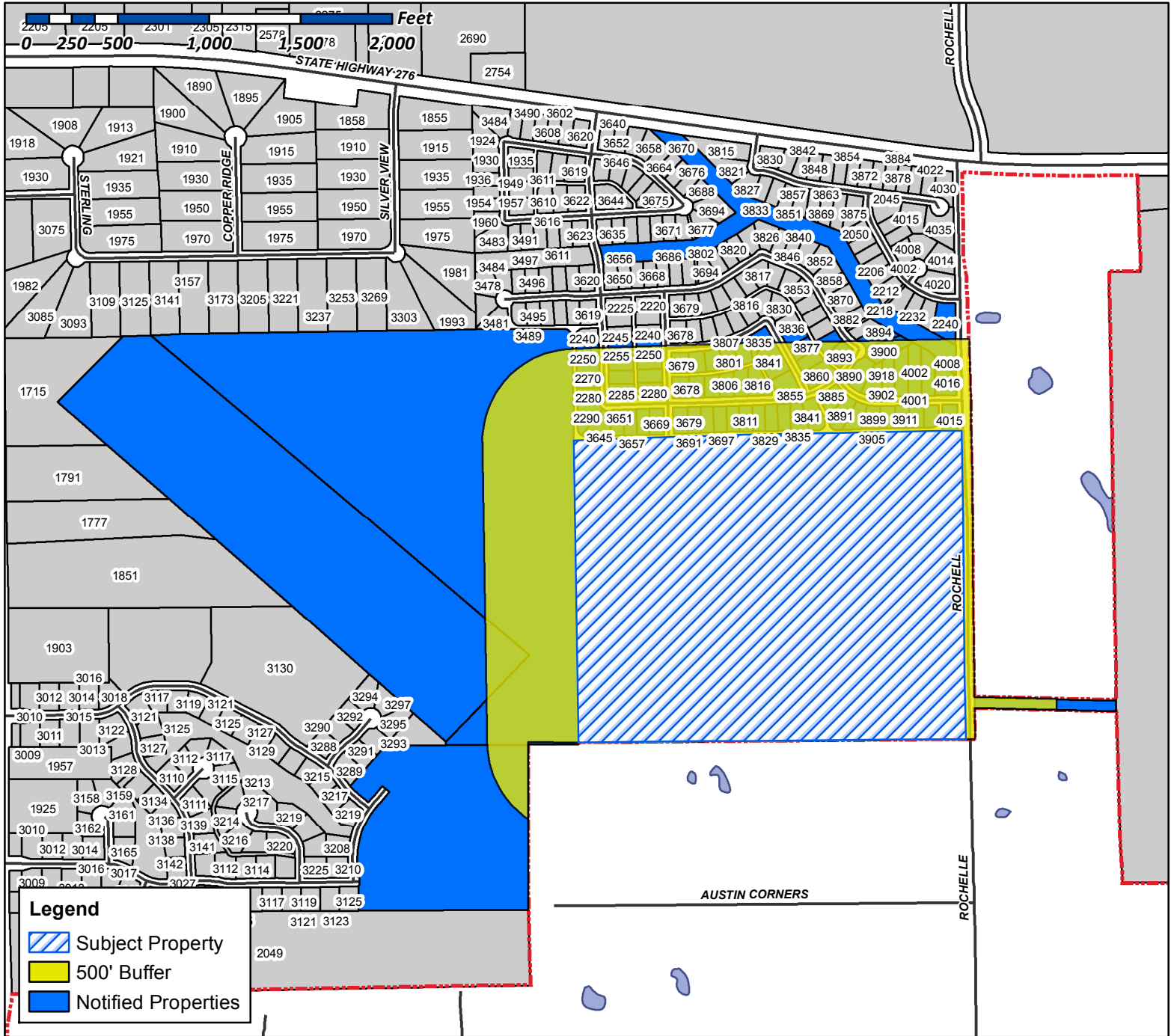

Case Number: Z2016-013
Case Name: Rochelle Estates
Case Type: Zoning
Zoning: Planned Development (PD) District
Case Address: South of Intersection of Rochelle Road and SH-276

Date Created: 04/18/2016
For Questions on this Case Call (972) 771-7745

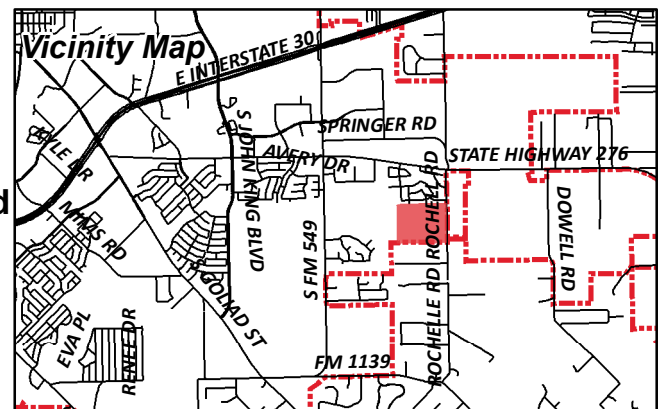

CURRENT RESIDENT
FM549
ROCKWALL, TX 75032

GUAN HAIHUI & YUFENG TANG
1024 BUBB RD
CUPERTINO, CA 95014

PAPPAS NICHOLAS
11595 MINES RD
LIVERMORE, CA 94550

PAPPAS NICHOLAS
11595 MINES RD
LIVERMORE, CA 94550

ROBERTSON JAMES E
1202 BAYSHORE DR
ROCKWALL, TX 75032

CLIFTON STEPHEN E
1273 HIGHLAND DR
ROCKWALL, TX 75087

AMERICAN DREAM RENTALS LLC
A TEXAS LIMITED LIABILITY COMPANY
1285 NW PINE LAKE DR
STUART, FL 34994

MCLENDON COMPANY THE
13101 PRESTON RD STE 501
DALLAS, TX 75240

ANUAR PETER
1419 WEST WICKHAM CIRCLE
DELRAY BEACH, FL 33445

SUTKER ITAI
17353 HATTERAS ST
ENCINO, CA 91316

PETERSON JUSTIN H & LAURA C REVOCABLE
LIVING TRUST
1960 MURIFIELD AVENUE
ROCKWALL, TX 75087

AKITA TRUST
213 WILD LILAC
IRVINE, CA 92620

HIGGINBOTHAM JANET R &
MELANIE A EDWARDS
2240 RIVERBIRCH LN
ROCKWALL, TX 75032

CURRENT RESIDENT
2250 ACACIA DR
ROCKWALL, TX 75032

GIDDENS ANTHONY & JERELYNN
2250 TIMBER CREEK DR
ROCKWALL, TX 75032

HOWLE MICHELE
2255 TIMBER CREEK DR
ROCKWALL, TX 75032

CURRENT RESIDENT
2260 TIMBER CREEK DR
ROCKWALL, TX 75032

MCCUEN STEVE
2260 ACACIA
ROCKWALL, TX 75032

LUTTRELL OSCAR & JEAN
2265 TIMBER CREEK DR
ROCKWALL, TX 75032

CURRENT RESIDENT
2270 ACACIA DR
ROCKWALL, TX 75032

CURRENT RESIDENT
2270 TIMBER CREEK DR
ROCKWALL, TX 75032

CURRENT RESIDENT
2275 TIMBER CREEK DR
ROCKWALL, TX 75032

CURRENT RESIDENT
2280 ACACIA DR
ROCKWALL, TX 75032

CURRENT RESIDENT
2280 TIMBER CREEK DR
ROCKWALL, TX 75032

CURRENT RESIDENT
2285 TIMBER CREEK DR
ROCKWALL, TX 75032

CURRENT RESIDENT
2290 TIMBER CREEK DR
ROCKWALL, TX 75032

WEST UNION INVESTMENT CO
23545 CRENSHAW BLVD STE 201
TORRANCE, CA 90505

HOCKINSON KIRK & KAREN
25 PRAIRIE FALCON DR
NOVATO, CA 94949

EMERY DIANE MEYER
2706 SUZANNE DR
ROWLETT, TX 75088

AMH 2015-1 BORROWER LLC
30601 AGOURA RD SUITE 200
AGOURA HILLS, CA 91301

SYBRANDY HENRY M AND CANDY I 1989
REVOCABLE TRUST
HENRY M AND CANDY I SYBRANDY TRUSTEES
3216 ERIE ST
SAN DIEGO, CA 92117

BURNHAM PAMELA
3510 DOVER DR
SANTA CRUZ, CA 95065

CURRENT RESIDENT
3645 LAUREL CROSSING DR
ROCKWALL, TX 75032

CLARK JUSTIN L
3651 LAUREL CROSSING DRIVE
ROCKWALL, TX 75032

COURTNEY SHANNON AND SHAMBRICA
3657 LAUREL CROSSING DR
ROCKWALL, TX 75032

KYLE LAURA
3663 LAUREL CROSSING DRIVE
ROCKWALL, TX 75032

CURRENT RESIDENT
3669 LAUREL CROSSING DR
ROCKWALL, TX 75032

CROSSAN GEORGE N & JUDY A
3678 LAUREL CROSSING DR
ROCKWALL, TX 75032

CURRENT RESIDENT
3679 CHESTNUT TR
ROCKWALL, TX 75032

KILLINGSWORTH WILLIAM R AND
MARY ANN PETTON
3679 LAUREL CROSSING
ROCKWALL, TX 75032

CURRENT RESIDENT
3684 LAUREL CROSSING DR
ROCKWALL, TX 75032

CURRENT RESIDENT
3685 CHESTNUT TR
ROCKWALL, TX 75032

CURRENT RESIDENT
3685 LAUREL CROSSING DR
ROCKWALL, TX 75032

CURRENT RESIDENT
3690 LAUREL CROSSING DR
ROCKWALL, TX 75032

CURRENT RESIDENT
3691 CHESTNUT TR
ROCKWALL, TX 75032

CURRENT RESIDENT
3691 LAUREL CROSSING DR
ROCKWALL, TX 75032

CURRENT RESIDENT
3697 LAUREL CROSSING DR
ROCKWALL, TX 75032

BARNES JENNIFER L
3801 CHESTNUT TRL
ROCKWALL, TX 75032

ANUAR MOSHE & KAREN
3801 NW 97TH AVE
HOLLYWOOD, FL 33024

MATTHEWS ROSS D III &
KRISTI L WALDEN
3802 LAUREL CROSSING DR
ROCKWALL, TX 75032

FIELDS GREGORY & TESSARA
3805 LAUREL CROSSING DR
ROCKWALL, TX 75032

MCCAIG LINDA S
3806 LAUREL CROSSING DRIVE
ROCKWALL, TX 75032

CURRENT RESIDENT
3807 CHESTNUT TR
ROCKWALL, TX 75032

CURRENT RESIDENT
3811 LAUREL CROSSING DR
ROCKWALL, TX 75032

CURRENT RESIDENT
3816 LAUREL CROSSING DR
ROCKWALL, TX 75032

COPPOCK MICHAEL & LANESEA
3817 LAUREL CROSSING
ROCKWALL, TX 75032

BEAN RUSSELL S & JESSICA D
3823 LAUREL CROSSING DRIVE
ROCKWALL, TX 75032

VENTURA CELYN A
3829 LAUREL CROSSING DR
ROCKWALL, TX 75032

SHARPE CHARLES & MYRA JO
3835 CHESTNUT TRL
ROCKWALL, TX 75032

THOMAS ANTHONY
3835 LAUREL CROSSING DR
ROCKWALL, TX 75032

MCCARTER CHARLES & MARIA C
3841 CHESTNUT TRAIL
ROCKWALL, TX 75032

GOMEZ OSCAR SR
3841 LAUREL CROSSING DR
ROCKWALL, TX 75032

HARRISON CLINTON
3842 CHESTNUT TRL
ROCKWALL, TX 75032

CURRENT RESIDENT
3847 CHESTNUT TR
ROCKWALL, TX 75032

MELLEN JUSTIN C & CRYSTAL R
3848 CHESTNUT TRL
ROCKWALL, TX 75032

CURRENT RESIDENT
3854 CHESTNUT TR
ROCKWALL, TX 75032

NOTT PHILLIP
3855 CHESTNUT TRAIL
ROCKWALL, TX 75032

ROWELL ARNOLD B & JACQUELYN
3860 CHESTNUT TRL
ROCKWALL, TX 75032

GERSON AND LESSER REVOCABLE TRUST
RANDI T GERSON AND SARA R LESSER TRUSTEES
387 43RD ST
OAKLAND, CA 94609

SMITH OLIVER HUGHIE & NATASHA COLETTE
3885 JUNIPER HILLS DR
ROCKWALL, TX 75032

KNEAREM BEAU J
3885 POPLAR POINT DR
ROCKWALL, TX 75032

CURRENT RESIDENT
3890 POPLAR POINT DR
ROCKWALL, TX 75032

THOMAS JOHN SCOTT & TAMMY L
3890 POPLAR POINT DR
ROCKWALL, TX 75032

WILLIAMS MICHAEL AND MICHELLE
3891 POPLAR POINT DR
ROCKWALL, TX 75032

BENNETT CLAY
3893 JUNIPER HILLS DR
ROCKWALL, TX 75032

NEFF NATHANIEL J
3894 JUNIPER HILLS DR
ROCKWALL, TX 75032

BAHAM AMBER
3899 POPLAR POINT DR
ROCKWALL, TX 75032

FORTNER MICHAEL AND JENNIFER
3900 JUNIPER HILLS DR
ROCKWALL, TX 75032

CURRENT RESIDENT
3902 POPLAR POINT DR
ROCKWALL, TX 75032

NARRAMORE RYAN & WENDI
3905 POPLAR POINT DR
ROCKWALL, TX 75032

CURRENT RESIDENT
3910 POPLAR POINT DR
ROCKWALL, TX 75032

CURRENT RESIDENT
3911 POPLAR POINT DR
ROCKWALL, TX 75032

COLLINSWORTH TERRY RAY & SHIRLEY ANN
3918 POPLAR POINT DRIVE
ROCKWALL, TX 75032

FERGUSON MONDE & JONATHAN
3919 POPLAR POINT DR
ROCKWALL, TX 75032

BATES DOUGLAS & ANITA
4001 POPLAR POINT DR
ROCKWALL, TX 75032

WILLIAMS DAVID R & LEAANN
4002 POPLAR POINT DR
ROCKWALL, TX 75032

CURRENT RESIDENT
4007 POPLAR POINT DR
ROCKWALL, TX 75032

CURRENT RESIDENT
4008 POPLAR POINT DR
ROCKWALL, TX 75032

HARRISON CHRISTINA LYNN
4015 POPLAR POINT DR
ROCKWALL, TX 75032

MCPHERSON LUKE KENNETH & SHAYLYN
4016 POPLAR POINT DR
ROCKWALL, TX 75032

CARR JIMMIE T
506 GILTIN DR
ARLINGTON, TX 76006

HIGHLANDS OF ROCKWALL LTD
C/O JAMES M BROWN
6750 HILLCREST PLAZA DR STE 213
DALLAS, TX 75230

AMERICAN RESIDENTIAL LEASING COMPANY LLC
7047 E GREENWAY PARKWAY SUITE 350
SCOTTSDALE, AZ 85254

ZHIXING REN & ZHIPU SHU
7572 BOLLINGER RD
CUPERTINO, CA 95014

FREO TEXAS LLC
7702 E DOUBLETREE RANCH RD #100
SCOTTSDALE, AZ 85258

ROMERO OSCAR & SELMA C
925 SKYLINE DR
VALLEJO, CA 94591

IHEARTMEDIA TOWER CO I (AM) LLC
VERTICAL BRIDGE CC PARENT LLC
951 BROKEN SOUND PKWY SUITE 320
BOCA RATON, FL 33487

MALTEZ RAOUL A
PO BOX 1314
FAIR OAKS, CA 95628

FONTANNA RANCH LTD
PO BOX 191185
DALLAS, TX 75219

BRADEN MICHAEL
PO BOX 3016
SAN ANSELMO, CA 94979

BRADEN MICHAEL
PO BOX 3016
SAN ANSELMO, CA 94979

MCCUEN STEVEN
PO BOX 953
ROCKWALL, TX 75087



City of Rockwall

Planning & Zoning Department
385 S. Goliad Street
Rockwall, Texas 75087
(P): (972) 771-7745
(W): www.rockwall.com

The City of Rockwall GIS maps are continually under development and therefore subject to change without notice. While we endeavor to provide timely and accurate information, we make no guarantees. The City of Rockwall makes no warranty, express or implied, including warranties of merchantability and fitness for a particular purpose. Use of the information is the sole responsibility of the user.

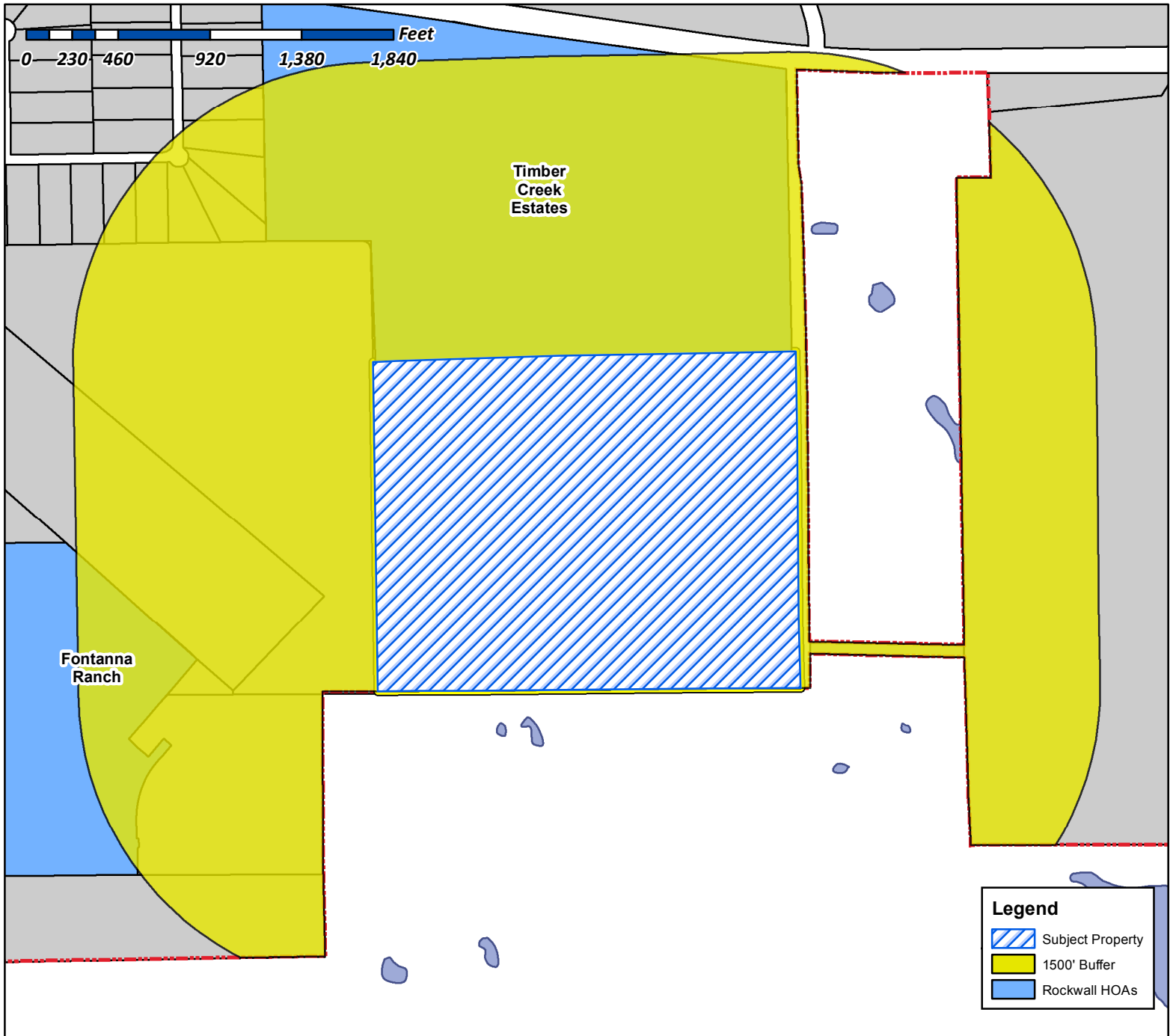

Case Number: Z2016-013
Case Name: Rochelle Estates
Case Type: Zoning
Zoning: Planned Development (PD) District
Case Address: South of intersection of Rochelle Road and SH-276

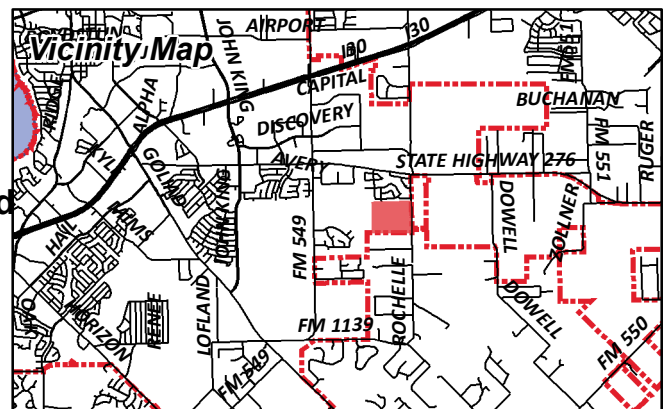

Date Created: 04/18/2016

For Questions on this Case Call (972) 771-7745

ROCHELLE ESTATES

A Concept Plan - 204 Total Lots



N 89°03'13" E 837.5000'

N 88°55'06" E 1307.4600'

N 01°01'41" W 1645.0600'

S 00°43'00" E 1668.8500'

S 89°13'00" W 2136.1000'



0' 50' 100' 200'

SCALE: 1"=100'
DATE: 4.15.2016

THIS PLAN WAS PREPARED USING REASONABLY RELIABLE SOURCES AND IS SUBJECT TO CHANGE PENDING A DETAILED BOUNDARY SURVEY. THIS PLAN HAS NOT BEEN REVIEWED BY ANY GOVERNMENTAL AGENCY. ADDITIONAL STREETS AND/OR DRAINAGE PROVISIONS MAY BE REQUIRED. THIS PLAN IS AN ARTIST'S CONCEPTION AND IS PROVIDED FOR GENERAL INFORMATION PURPOSES ONLY. ALL PLANS FOR FACILITIES OR LAND USES ARE SUBJECT TO CHANGE WITHOUT NOTICE.

Rochelle Estates

Park Concept Plan ± 9.0 AC

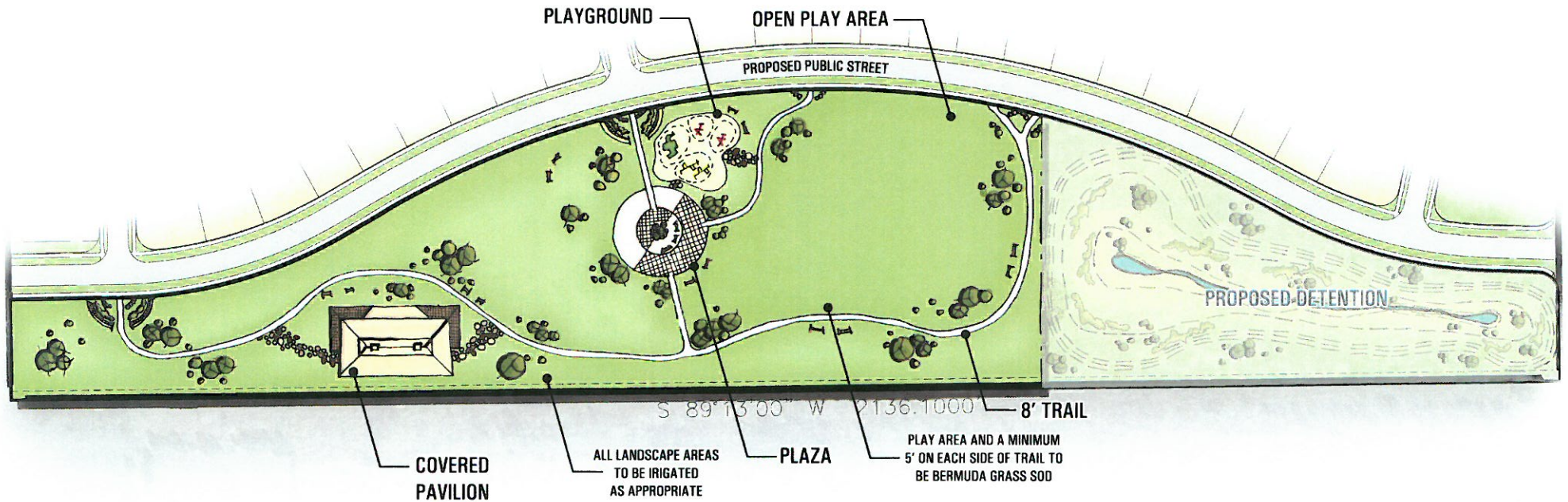

0' 30' 60' 120'

SCALE: 1"=60'

DATE: 4.14.2016

THIS PLAN WAS PREPARED USING REASONABLY RELIABLE SOURCES AND IS SUBJECT TO CHANGE PENDING A DETAILED BOUNDARY SURVEY. THIS PLAN HAS NOT BEEN REVIEWED BY ANY GOVERNMENTAL AGENCY. ADDITIONAL STREETS AND/OR DRAINAGE PROVISIONS MAY BE REQUIRED. THIS PLAN IS AN ARTIST'S CONCEPTION AND IS PROVIDED FOR GENERAL INFORMATION PURPOSES ONLY. ALL PLANS FOR FACILITIES OR LAND USES ARE SUBJECT TO CHANGE WITHOUT NOTICE.



JONES | CARTER

Amenity Package
Proposed Split District Park Concept Plan

Features:

- 9 Acres of Open Space
- 8ft concrete Hike & Bike trail
- Playground
- Plaza
- Full irrigation of park area
- Bermuda Sod of park area
- Covered Pavilion
- Picnic area
- Benches
- Landscape features including trees and other vegetation approved by City of Rockwall