

Z2015-033- 513 Windsor Way
 SUP - LOCATION MAP = [icon]



City of Rockwall

Planning & Zoning Department
 385 S. Goliad Street
 Rockwall, Texas 75032
 (P): (972) 771-7745
 (W): www.rockwall.com

The City of Rockwall GIS maps are continually under development and therefore subject to change without notice. While we endeavor to provide timely and accurate information, we make no guarantees. The City of Rockwall makes no warranty, express or implied, including warranties of merchantability and fitness for a particular purpose. Use of the information is the sole responsibility of the user.

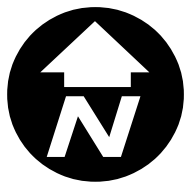



City of Rockwall

Planning & Zoning Department
385 S. Goliad Street
Rockwall, Texas 75087
(P): (972) 771-7745
(W): www.rockwall.com

The City of Rockwall GIS maps are continually under development and therefore subject to change without notice. While we endeavor to provide timely and accurate information, we make no guarantees. The City of Rockwall makes no warranty, express or implied, including warranties of merchantability and fitness for a particular purpose. Use of the information is the sole responsibility of the user.

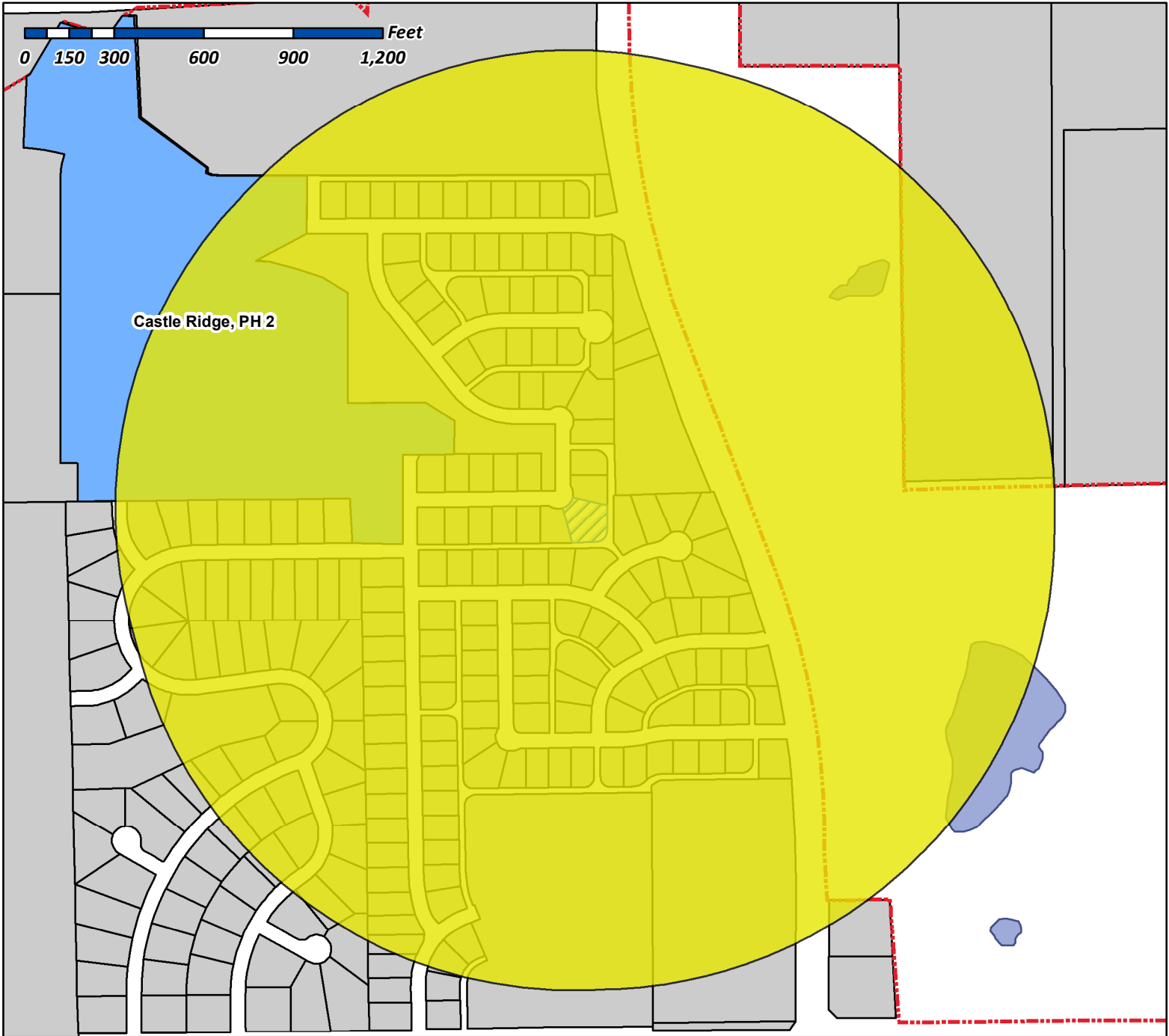
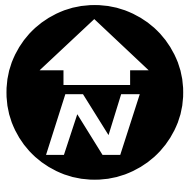

Case Number: Z2015-033
Case Name: 153 Windsor Way
Case Type: Specific Use Permit
Zoning: Residential
Case Address: 153 Windsor Way

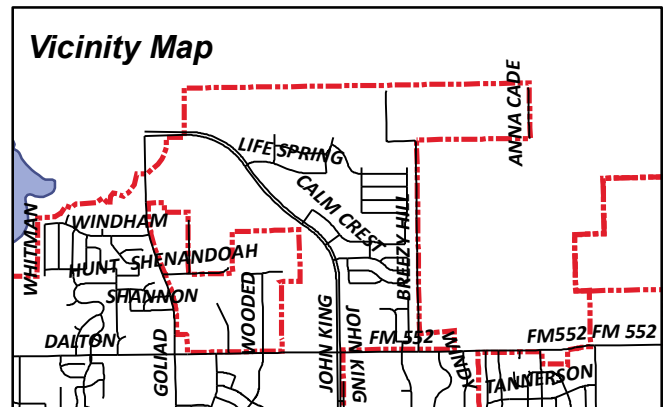

Date Created: 11/16/2016
 For Questions on this Case Call (972) 771-7745



City of Rockwall

Planning & Zoning Department
385 S. Goliad Street
Rockwall, Texas 75087
(P): (972) 771-7745
(W): www.rockwall.com

The City of Rockwall GIS maps are continually under development and therefore subject to change without notice. While we endeavor to provide timely and accurate information, we make no guarantees. The City of Rockwall makes no warranty, express or implied, including warranties of merchantability and fitness for a particular purpose. Use of the information is the sole responsibility of the user.



Case Number: Z2015-033
Case Name: 153 Windsor Way
Case Type: Specific Use Permit
Zoning: Residential
Case Address: 153 Windsor Way

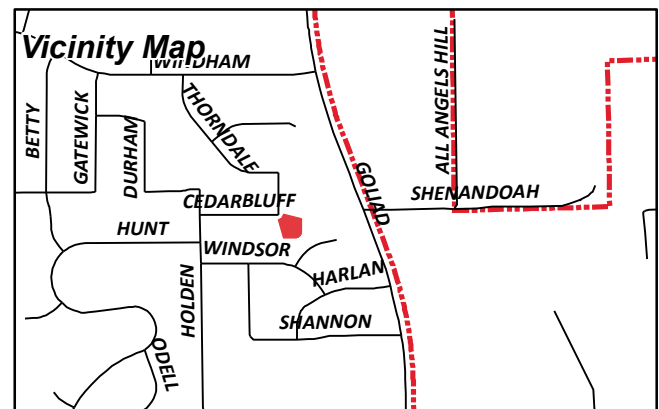

Date Created: 11/16/2015
For Questions on this Case Call (972) 771-7745

DESCRIPTION

Lot 14, Block "F" REPLAT OF HARLAN PARK, an Addition in Rockwall County, Texas, according to the Plat thereof recorded in Slide B, Page 226 of the Plat Records of Rockwall County, Texas.

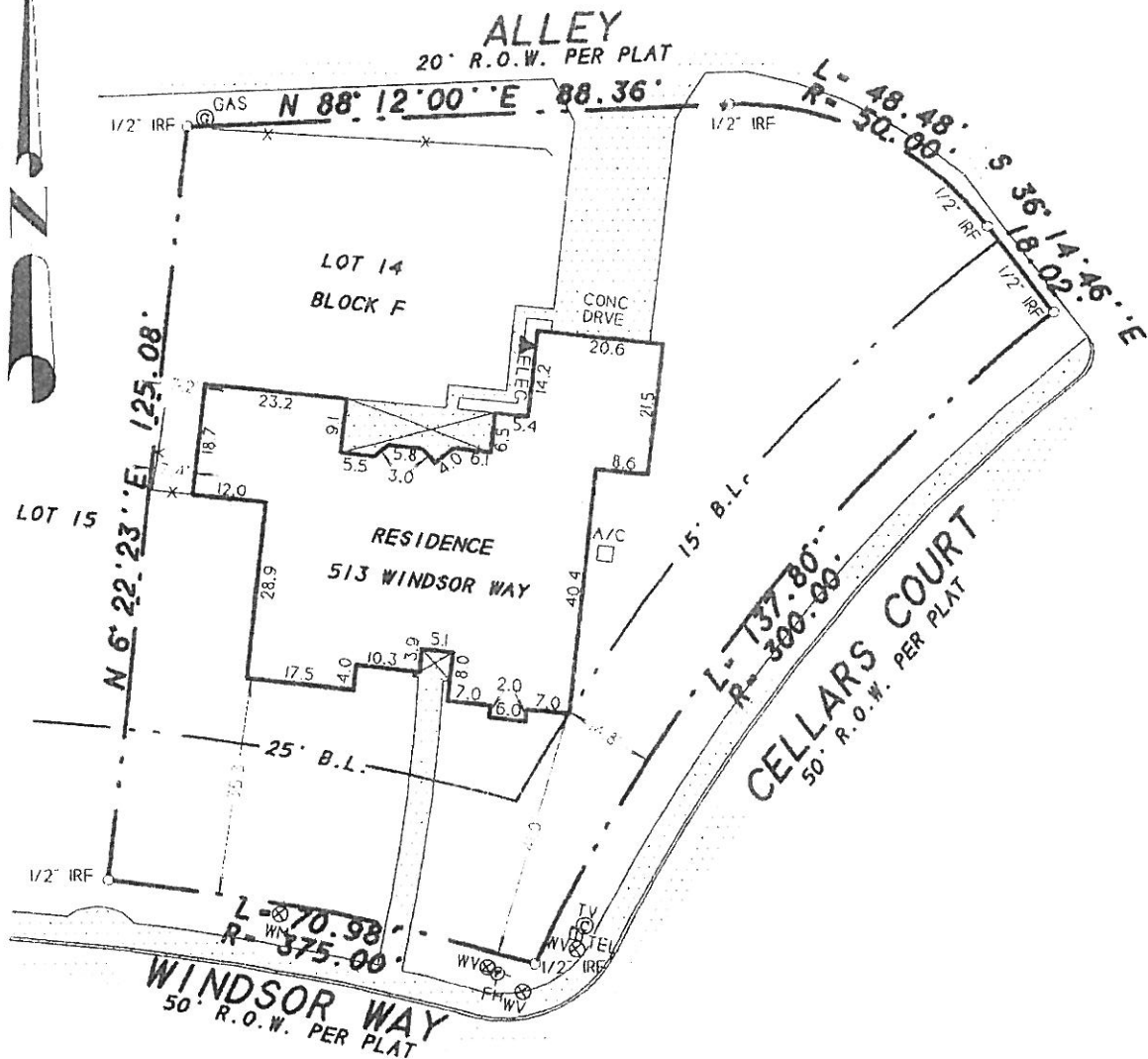

NOTES

- 1) According to F.E.M.A. Flood Insurance Rate Map. Community Panel No. 480547 0005 C dated June 16, 1992, this property lies in Zone X. This property does not appear to lie within a 100-year flood plain.
- 2) BEARING SOURCE: RECORDED PLAT.
- 3) The following easements do not lit on this lot: (i) V. 82, P. 376, (ii) V. 91, P. 159, (iii) V. 383, P. 253, (iv) V. 392, P. 325.

SURVEYOR'S CERTIFICATE

I, Harold D. Fetty, III, Registered Professional Land Surveyor No. 5034, do hereby certify that the above plat of the property surveyed for RANGER TITLE COMPANY and GEORGE K, & MARILYN A. HALL, at 513 Windsor Way, Rockwall, Rockwall County, Texas, is the result of a careful collection of the best evidence available to me and my opinion is based on the facts as found at the time of survey. This survey meets the requirements of the Minimum Standards of Practice as approved and published by the Texas Board of Professional Land Surveying, effective September 1, 1992 and subsequent revisions, and the same was surveyed under my supervision on the ground this the 5th day of Nov., 1999.

Harold D. Fetty III
 Harold D. Fetty III, R.P.L.S. No. 5034



SURVEY DATE NOV. 5, 1999
 SCALE 1" = 30' FILE # 992278
 CLIENT HALL GF # 321747