

PROJECT NO. TL2004-103
LOT 3, BLOCK H
1212 LAKESHORE DRIVE
ROCKWALL, TEXAS

I, the undersigned, hereby certify that the survey map heron, and accompanying description, depicts and describes the results of a survey, made on the ground between January 2004 and December 2004. And to the best of my knowledge and belief, is a depiction and description of the property surveyed. The Surveyor has not abstracted the record title and / or easements of the subject property and prepared this survey without the benefit of a title commitment and assumes no liability for easements, reservations, and restrictions that may be of record. This property is subject to change due to natural and / or man made changes.

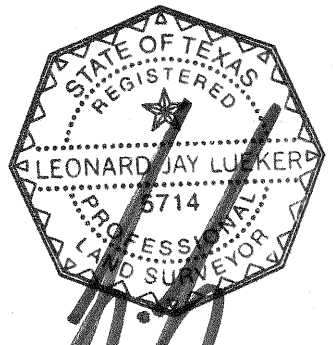

Leonard J. Lueker
Registered Professional Land Surveyor
Texas Registration No. 5714
Winkelmann & Associates, Inc.
6750 Hillcrest Plaza Drive # 100
Dallas, Texas 75230
(972) 490-7090

Winkelmann & Associates, Inc.
CONSULTING CIVIL ENGINEERS ■ SURVEYORS

6750 HILLCREST PLAZA DRIVE, SUITE 100 (972) 490-7090
DALLAS, TEXAS 75230 (972) 490-7099 FAX
COPYRIGHT 2001, WINKELMANN & ASSOCIATES, INC.

DATE : May 05

EXHIBIT "B"

SUB LEASE DESCRIPTION
PROJECT NO. TL2004-103

STATE OF TEXAS
COUNTY OF ROCKWALL

BEING a tract of land situated in the City of Dallas Takeline Area and being a portion of a tract of land leased to the City of Rockwall and being more particularly described as follows:

BEGINNING at a point from which a 1/2 inch iron rod found bears North 86 deg 57 min 39 sec West a distance of 3.12 feet, said point being the most northwesterly corner of LOT 3, BLOCK H of RIDGE ROAD VILLAGE 2ND INSTALLMENT, an addition to the City of Rockwall as recorded in Cabinet A, Page 107 of the Plat Records of Rockwall County, Texas (PRRCT);

THENCE along the westerly line of said LOT 3, BLOCK H South 29 deg 10 min 32 sec East a distance of 85.00 feet to a point from which a 1/2 inch iron rod found bears North 88 deg 48 min 03 sec West a distance of 2.93 feet for corner at the most southwesterly corner of said LOT 3, BLOCK H;

THENCE departing the westerly line of said LOT 3, BLOCK H South 60 deg 49 min 28 sec West passing a 3 1/2 inch Aluminum Monument stamped "CITY OF ROCKWALL LAKE RAY HUBBARD SUB LEASE MARKER 2004" at a distance of 173.27 feet, continuing in all a distance of 183.35 feet to a point for corner in the 435.5 contour line as defined at the time of the survey;

THENCE along the meanders of said 435.5 contour line in a northwesterly direction a distance of 98.1 feet to a point for corner;

THENCE departing said 435.5 contour line North 60 deg 49 min 28 sec East passing a 3 1/2 inch Aluminum Monument stamped "CITY OF ROCKWALL LAKE RAY HUBBARD SUB LEASE MARKER 2004" at a distance of 14.24 feet, continuing in all a distance of 218.88 feet to the POINT OF BEGINNING;

CONTAINING within these metes and bounds 0.385 acres or 16,757 square feet of land, more or less. This Sub Lease description was prepared from an actual on the ground survey performed in the field from January 2004 to December 2004 and is subject to change due to natural and / or man made changes after the survey.

PROJECT NO. TL2004-103
LOT 3, BLOCK H
1212 LAKESHORE DRIVE
ROCKWALL, TEXAS