

THE SEAL APPEARING ON THIS DOCUMENT WAS AUTHORIZED BY CHRISTOPHER R. CUNY, P.E. 65642

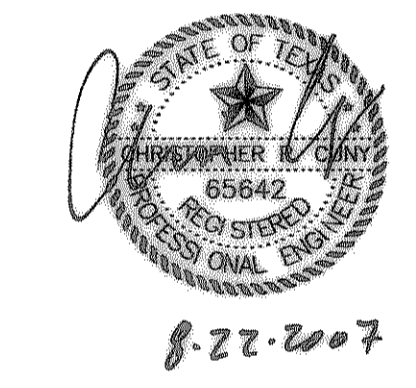

**LINE "D"**

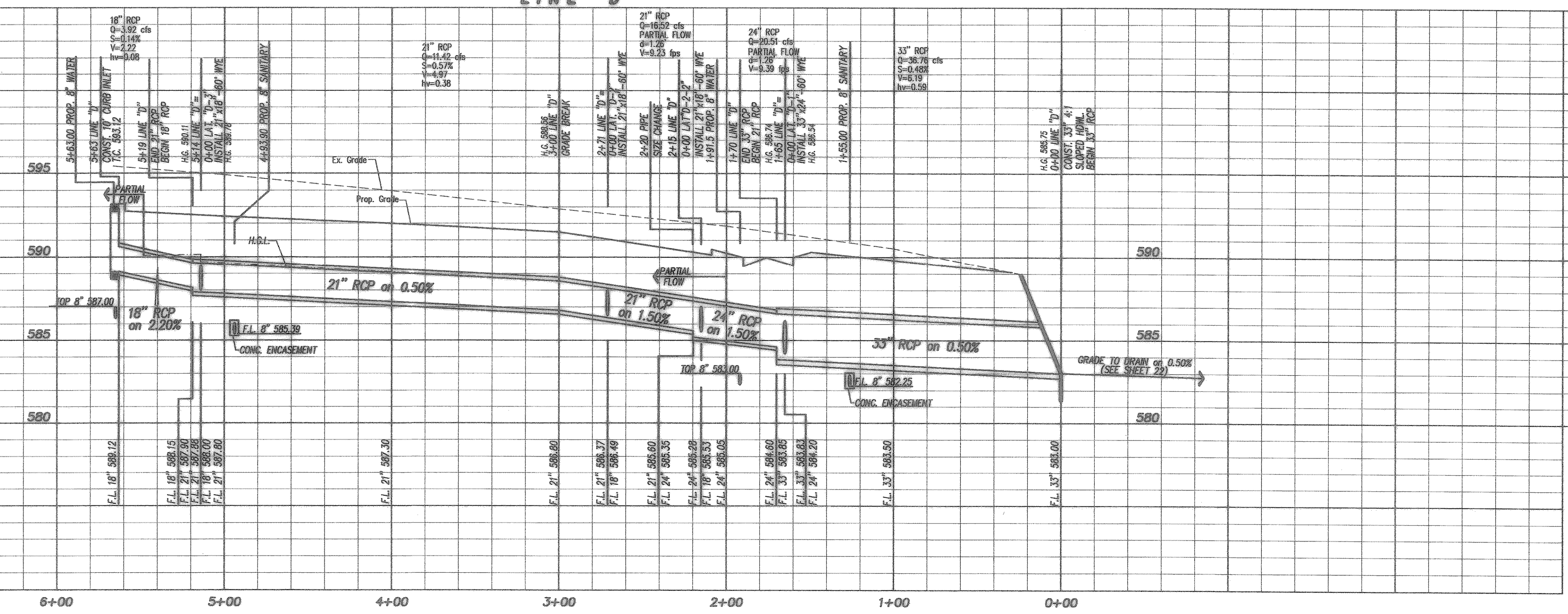

**Construction Record Drawing**  
8-22-2007

**Storm Sewer Plan & Profile - Line "D"**  
Fontanna Ranch  
City of Rockwall, Rockwall County, Texas  
Spring Haven Investments, Inc.  
6750 Hillcrest Plaza Dr. • Suite 305 • Dallas, Texas 75230 • 972.386.3333

**F.C. CUNY CORPORATION**  
#2 Horizon Court • Heath, Texas 75032 • 469-402-7700

Drawn By:	Checked By:	Date:	Scale:	Project No.:	Sheet No.:
MSC	DJM	10/18/06	H: 1"=40' V: 1"=4'	05-013	26 of 45

Z:\Projects\6-Res\Ident\Fontanna\Record Drawings\Font-SmLn 0.dwg Thu Aug 23 10:22:12 2007