

LEGEND

- PROP. PAVEMENT
- - - SETBACK (BLDG) LINE
- EXTERIOR BOUNDARY LINE
- LOT LINE
- RIGHT OF WAY
- DRAINAGE DIRECTION

Note: Construct Barrier Free Ramp (B.F.R.) per City of Rockwall Stds.

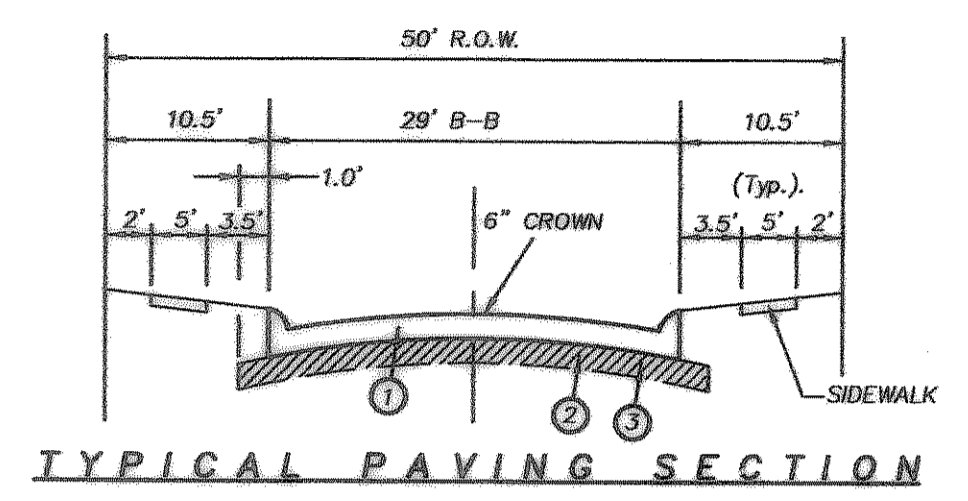

- ① 6"-3600 PSI Class "C" concrete pavement with No. 3 bars 24" on centers both ways.
Min. 6 Sack For Machine Placed
Min. 6 1/2 Sack For Hand Placed
 - ② Where the Plasticity Index of the natural soil is equal to or exceeds 15, lime stabilization shall be required. A minimum of 6% by weight of lime to a depth of 6" shall be required.
 - ③ Subgrade shall be 6" thick and compacted to a density not less than 95% of optimum moisture content.
- Note: 1. All construction joints & rebar to be in conformance with the City of Rockwall Specifications and Standards.

THE SEAL APPEARING ON THIS DOCUMENT WAS AUTHORIZED BY CHRISTOPHER R. CUNY, P.E. 65642

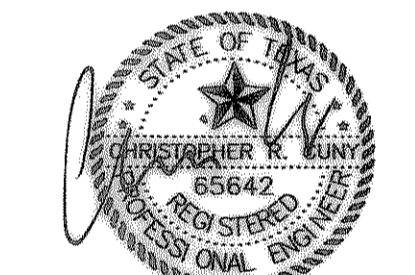

8-22-2007

C.L. CURVE TABLE

CURVE	RADIUS	DELTA	TANGENT	LENGTH	CHORD	BEARING	
C-1	200.00'	40°41'37"	74.17'	142.04'	138.06'	S 88°56'27"	W
C-2	200.00'	40°58'20"	74.72'	143.02'	139.99'	N 70°04'48"	E
C-3	275.00'	25°06'25"	61.15'	120.34'	118.36'	S 76°53'49"	E
C-4	275.00'	15°38'39"	37.89'	74.92'	74.69'	S 53°47'41"	W
C-5	425.00'	08°42'42"	32.37'	64.61'	64.55'	N 53°55'22"	E
C-6	391.77'	10°04'08"	34.51'	68.85'	68.76'	N 53°41'47"	E
C-7	375.00'	10°37'43"	34.88'	68.56'	68.46'	S 52°51'51"	E
C-8	375.00'	10°37'43"	34.88'	68.56'	68.46'	S 42°20'09"	E
C-9	425.00'	14°31'03"	54.13'	107.88'	107.40'	N 44°16'49"	E
C-10	450.00'	20°00'39"	112.24'	219.59'	217.81'	N 20°20'40"	E
C-11	100.00'	78°28'49"	81.67'	136.87'	126.51'	N 81°35'25"	W
C-12	200.00'	30°14'49"	54.05'	105.58'	104.36'	N 74°17'35"	W
C-13	80.00'	90°00'00"	80.00'	125.66'	113.14'	S 44°25'00"	E
C-14	655.00'	03°48'16"	21.85'	43.69'	43.68'	N 88°36'21"	E
C-15	645.00'	11°28'28"	64.80'	129.17'	128.96'	N 87°34'04"	W
C-16	890.00'	11°28'47"	80.41'	160.28'	160.02'	S 87°34'13"	E
C-17	500.00'	13°50'17"	60.67'	120.76'	120.47'	N 07°25'12"	E
C-18	600.00'	03°51'41"	20.23'	40.44'	40.43'	N 87°33'09"	E
C-19	600.00'	07°36'34"	39.90'	79.69'	79.63'	S 89°25'36"	E
C-20	600.00'	03°44'33"	19.63'	39.25'	39.24'	S 88°38'33"	W
C-21	375.00'	12°43'02"	41.79'	83.23'	83.06'	N 83°07'29"	E
C-22	425.00'	27°24'43"	103.65'	203.33'	201.40'	N 89°31'41"	E
C-23	175.00'	14°41'41"	22.57'	44.88'	44.76'	S 83°10'09"	W
C-24	200.00'	31°02'11"	55.53'	108.34'	107.02'	N 73°57'35"	E
C-25	200.00'	30°31'35"	54.58'	106.56'	105.30'	S 73°42'37"	E
C-26	200.00'	23°00'43"	40.71'	80.33'	79.79'	N 11°30'21"	E
C-27	220.00'	40°08'20"	80.38'	154.12'	150.99'	S 22°34'44"	E
C-28	200.00'	43°13'54"	79.25'	150.90'	147.33'	N 21°01'57"	E
C-29	300.00'	40°59'22"	112.13'	214.62'	210.07'	S 19°54'41"	E
C-30	175.00'	18°11'42"	28.02'	55.57'	55.34'	N 51°26'51"	W
C-31	225.00'	18°11'42"	36.03'	71.45'	71.15'	S 51°26'51"	W
C-32	180.00'	53°32'57"	50.46'	93.46'	90.10'	N 62°42'32"	W
C-33	140.00'	90°00'00"	140.00'	210.91'	197.99'	S 44°29'00"	E

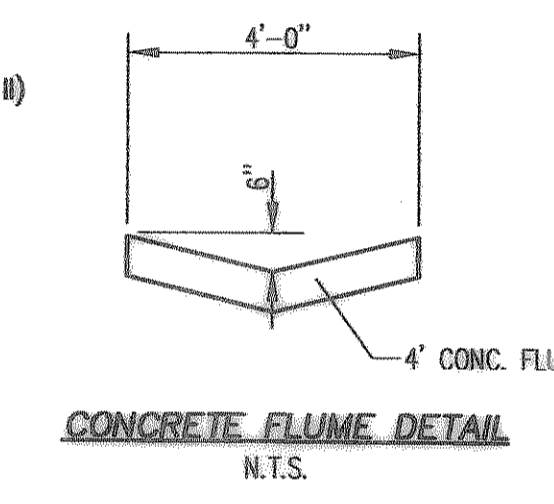
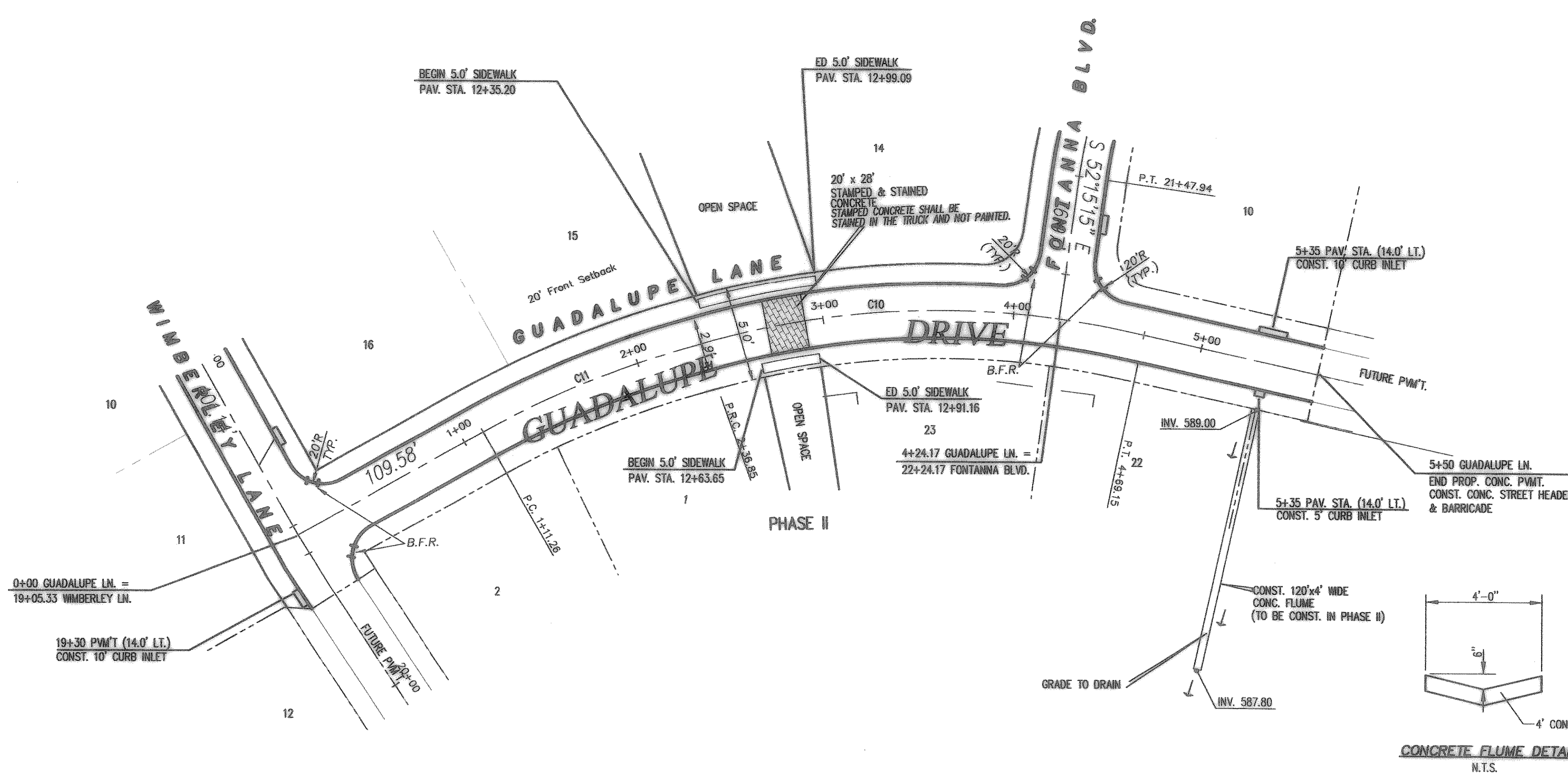

GUADALUPE LANE

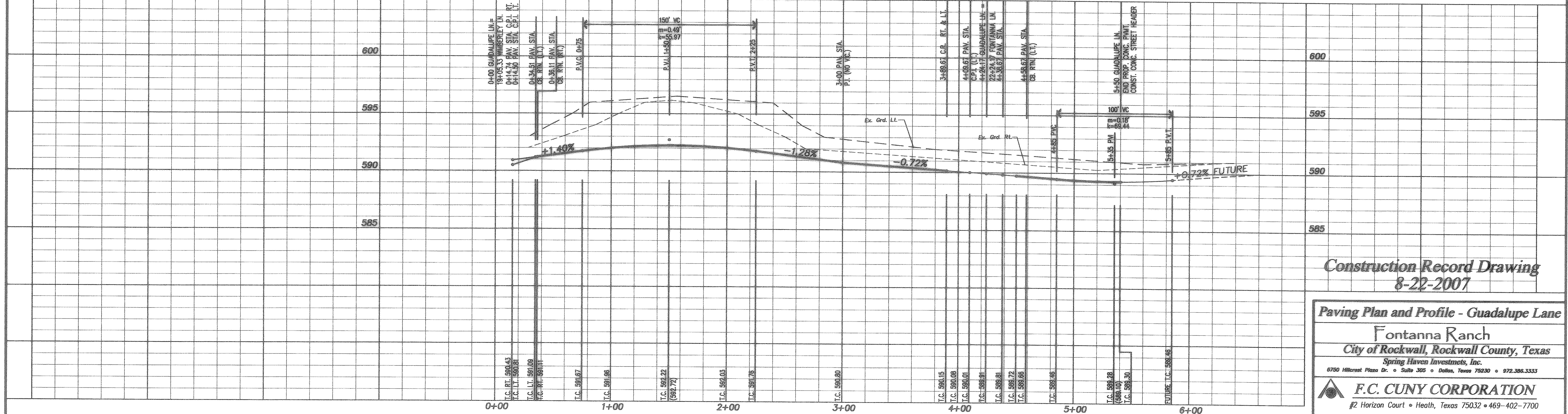

**Construction Record Drawing
8-22-2007**

Paving Plan and Profile - Guadalupe Lane
Fontanna Ranch
 City of Rockwall, Rockwall County, Texas
 Spring Haven Investments, Inc.
 6750 Hillcrest Plaza Dr. • Suite 305 • Dallas, Texas 75230 • 972.386.3333

F.C. CUNY CORPORATION
 #2 Horizon Court • Heath, Texas 75032 • 469-402-7700

Drawn By: MSC	Checked By: DJW	Date: 10/18/06	Scale: 1/2"=40' 1/4"=4'	Project No.: 05-013	Sheet No.: 11 of 45
---------------	-----------------	----------------	----------------------------	---------------------	---------------------

Z:\Projects\5-Residential\Fontanna\Record Drawings\Font-pav5.dwg Mon Aug 20 15:05:18 2007