

**B. J. T. LEWIS SURVEY  
ABSTRACT NO. 255**

PISTATION = 68+75.87  
X = 2,596,972.2990  
Y = 7,022,455.1870  
DELTA = 12°31'28.53" (LT)  
LENGTH = 626.23'  
RADIUS = 2,864.79'  
PC STATION = 65+61.50  
PT STATION = 71+87.73

**J. CADLE SURVEY  
ABSTRACT NO. 65**

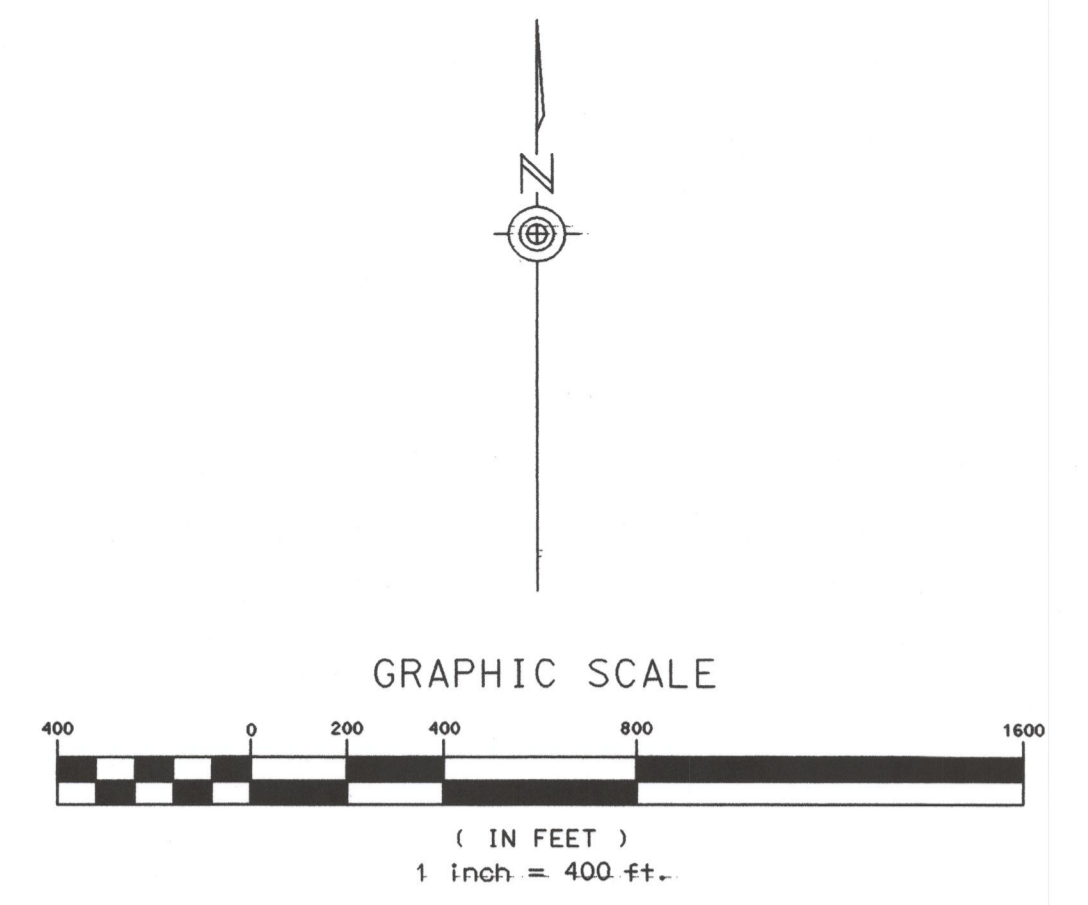

POINT	NORTH	EAST	ELEV.	DESCRIPTION
NTB 1	7016559.608	2600564.737	532.09	1/2" IRON ROD SET
NTB 2	7017144.453	2600114.749	552.38	1/2" IRON ROD SET
NTB 3	7017767.161	2599875.424	540.66	1/2" IRON ROD SET
NTB 4	7018635.919	2599239.342	521.35	1/2" IRON ROD SET
NTB 5	7019755.285	2598647.605	542.47	1/2" IRON ROD SET
NTB 6	7020390.503	2598141.821	562.09	1/2" IRON ROD SET
NTB 7	7021139.998	2597830.669	557.74	1/2" IRON ROD SET
NTB 8	7021550.435	2597455.369	564.69	1/2" IRON ROD SET
NTB 9	7022196.270	2597155.004	579.40	1/2" IRON ROD SET
NTB 10	7022621.389	2596754.232	577.60	1/2" IRON ROD SET
NTB 11	7023941.641	2595584.728	563.38	1/2" IRON ROD SET
NTB 12	7024476.605	2595010.402	565.81	1/2" IRON ROD SET
NTB 13	7025182.868	2594661.067	580.79	1/2" IRON ROD SET
NTB 14	7025893.663	2594688.692	584.47	1/2" IRON ROD SET
NTB 15	7026787.458	2594612.390	591.49	1/2" IRON ROD SET
NTB 16	7027829.726	2594663.305	551.88	1/2" IRON ROD SET
NTB 17	7028472.209	2594647.183	594.83	X-CUT IN CONCRETE
NTB 18	7029451.592	2594584.160	578.60	1/2" IRON ROD SET
NTB 19	7029920.053	2594636.759	575.48	PK NAIL SET
R1991134	7020841.440	2597854.282	577.44	TxDOT GPS CONTROL

BEGIN PROJECT  
BEGIN CONTROL 0451-01-043  
BEGIN ACCOUNT 8018-02-049

STA = 7+00.00  
X = 2,600,159.2572  
Y = 7,017,165.1357

POT STATION = 0+00.00  
X = 2,600,520.4810  
Y = 7,016,565.5380

NOTE:  
All bearings are based upon the Texas State Plane Coordinate System, NAD 83, North Central Zone. Scale factor: 1.000146135

FED. DIST. NO.	STATE	FEDERAL AID PROJECT NO.	HIGHWAY NO.		
6	TEXAS		SH 205		
STATE DISTRICT NO.	COUNTY	CONTRACT NO.	SECTION NO.	JOB NO.	SHEET NO.
18	ROCKWALL	0451	01	043	16