

ANY FUTURE INSTALLATION FOR ILLUMINATION SYSTEMS WILL BE DONE TO THE NATIONAL ELECTRICAL CODE AND TxDOT RESERVES THE RIGHT TO REVIEW AND INSPECT THESE INSTALLATIONS.

STREET LIGHTING PLANS

IRRIGATION DESIGNER
 JOHN WINGFIELD
 801 MORNINGSIDE TRAIL
 RICHARDSON, TEXAS 75081
 (972) 238-1488 PHONE
 (972) 238-1499 FAX

CIVIL ENGINEER
 CHUCK TODD
 ENGINEERING DEPARTMENT
 385 S. GOLIAD
 CITY OF ROCKWALL, TEXAS 75081
 (972) 771-7746 PHONE
 (972) 771-7748 FAX

STATE D O T
 MR. PATRICK HAIGE
 LANDSCAPE ARCHITECT
 STATE DEPT. OF TRANSPORTATION
 1 P.O. BOX 3067
 DALLAS, TEXAS 75221
 (214) 320-6205 PHONE
 (214) 320-6615 FAX

CITY OF ROCKWALL
 MR. BRAD GRIGGS
 DIRECTOR OF PARKS AND RECREATION
 CITY OF ROCKWALL
 108 E. WASHINGTON STREET
 ROCKWALL, TEXAS 75087
 (972) 771-7761 PHONE
 (972) 771-7728 FAX

LANDSCAPE ARCHITECT
 T.H. PRITCHETT ASSOCIATES
 LANDSCAPE ARCHITECTURAL DESIGN
 3017 WESTMINSTER DRIVE
 FARMERS BRANCH, TEXAS 75234
 (972) 484-1230 FAX
 (972) 484-7373 PHONE

FED. RD. DIV. NO.	PROJECT NO.		SHEET NO.	
6	(See Title Sheet)		836	
STATE	STATE DIST. NO.	COUNTY		
TEXAS	18	ROCKWALL		
CONTROL	SECTION	JOB	HIGHWAY NO.	
0451	01	032	SH 205	

STREET LIGHT LEGEND

- STREET LIGHT BASE, SEE DETAIL SLP-A
- HISTORICAL STREET LIGHT BASE, SEE DETAIL SLP-A
- ☐ GROUND BOX TYPE "A"
- STREET LIGHT SCH 40 CONDUIT MIN. 2" 4" FROM POWER SUPPLY TO MEDIAN PER NATIONAL ELEC CODE.

LOCATION OF CONDUIT IS DIAGRAMATIC FOR CLARITY, LOCATE IN MEDIAN AND INSTALL GROUND BOX TYPE "A" AT ENDS OF MEDIANS AND CONNECTIONS TO PARKWAY POWER SUPPLY.

ANY FUTURE INSTALLATION FOR ILLUMINATION SYSTEMS WILL BE DONE TO THE NATIONAL ELECTRICAL CODE AND TxDOT RESERVES THE RIGHT TO REVIEW AND INSPECT THESE INSTALLATIONS.



AREA A



AREA B



X- Did Not Install



STREET LIGHTING PLANS

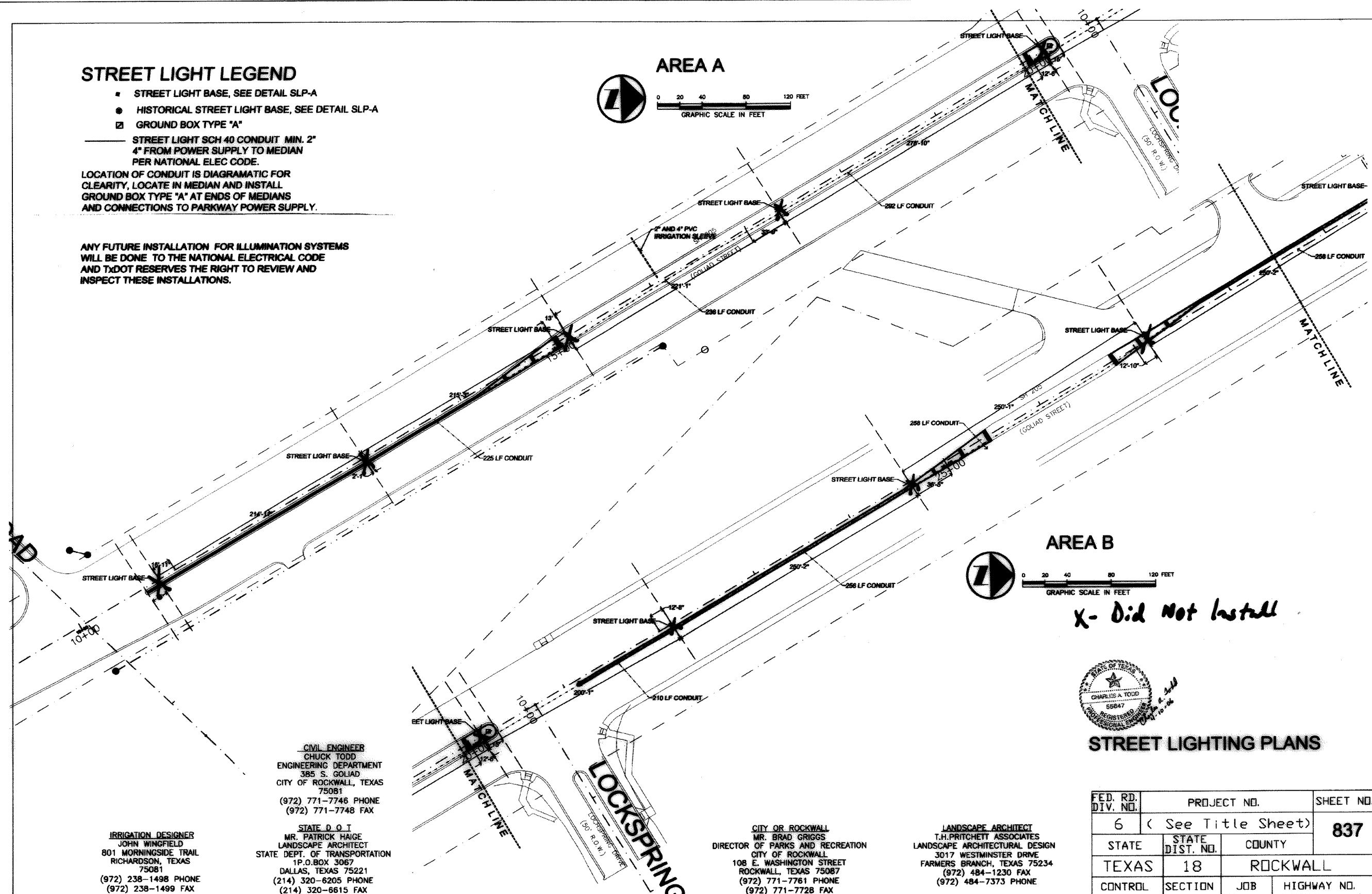

CIVIL ENGINEER
 CHUCK TODD
 ENGINEERING DEPARTMENT
 385 S. GOLIAD
 CITY OF ROCKWALL, TEXAS
 75081
 (972) 771-7746 PHONE
 (972) 771-7748 FAX

IRRIGATION DESIGNER
 JOHN WINGFIELD
 801 MORNINGSIDE TRAIL
 RICHARDSON, TEXAS
 75081
 (972) 238-1498 PHONE
 (972) 238-1499 FAX

STATE D.O.T.
 MR. PATRICK HAIGE
 LANDSCAPE ARCHITECT
 STATE DEPT. OF TRANSPORTATION
 P.O. BOX 3067
 DALLAS, TEXAS 75221
 (214) 320-6205 PHONE
 (214) 320-6615 FAX

CITY OF ROCKWALL
 MR. BRAD GRIGGS
 DIRECTOR OF PARKS AND RECREATION
 CITY OF ROCKWALL
 108 E. WASHINGTON STREET
 ROCKWALL, TEXAS 75087
 (972) 771-7761 PHONE
 (972) 771-7728 FAX

LANDSCAPE ARCHITECT
 T.H. PRITCHETT ASSOCIATES
 LANDSCAPE ARCHITECTURAL DESIGN
 3017 WESTMINSTER DRIVE
 FARMERS BRANCH, TEXAS 75234
 (972) 484-1230 FAX
 (972) 484-7373 PHONE

FED. RD. DIV. NO.	PROJECT NO.	SHEET NO.	
6	(See Title Sheet)	837	
STATE	STATE DIST. NO.	COUNTY	
TEXAS	18	ROCKWALL	
CONTROL	SECTION	JOB	HIGHWAY NO.
0451	01	032	SH 205

STREET LIGHT LEGEND

- STREET LIGHT BASE, SEE DETAIL SLP-A
- HISTORICAL STREET LIGHT BASE, SEE DETAIL SLP-A
- ☐ GROUND BOX TYPE 'A'
- STREET LIGHT SCH 40 CONDUIT MIN. 2" 4" FROM POWER SUPPLY TO MEDIAN PER NATIONAL ELEC CODE.

LOCATION OF CONDUIT IS DIAGRAMATIC FOR CLARITY, LOCATE IN MEDIAN AND INSTALL GROUND BOX TYPE 'A' AT ENDS OF MEDIANS AND CONNECTIONS TO PARKWAY POWER SUPPLY.

ANY FUTURE INSTALLATION FOR ILLUMINATION SYSTEMS WILL BE DONE TO THE NATIONAL ELECTRICAL CODE AND TxDOT RESERVES THE RIGHT TO REVIEW AND INSPECT THESE INSTALLATIONS.

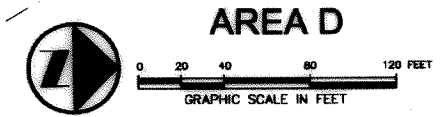
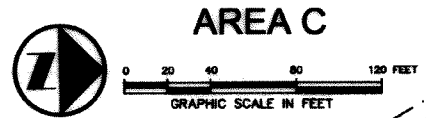
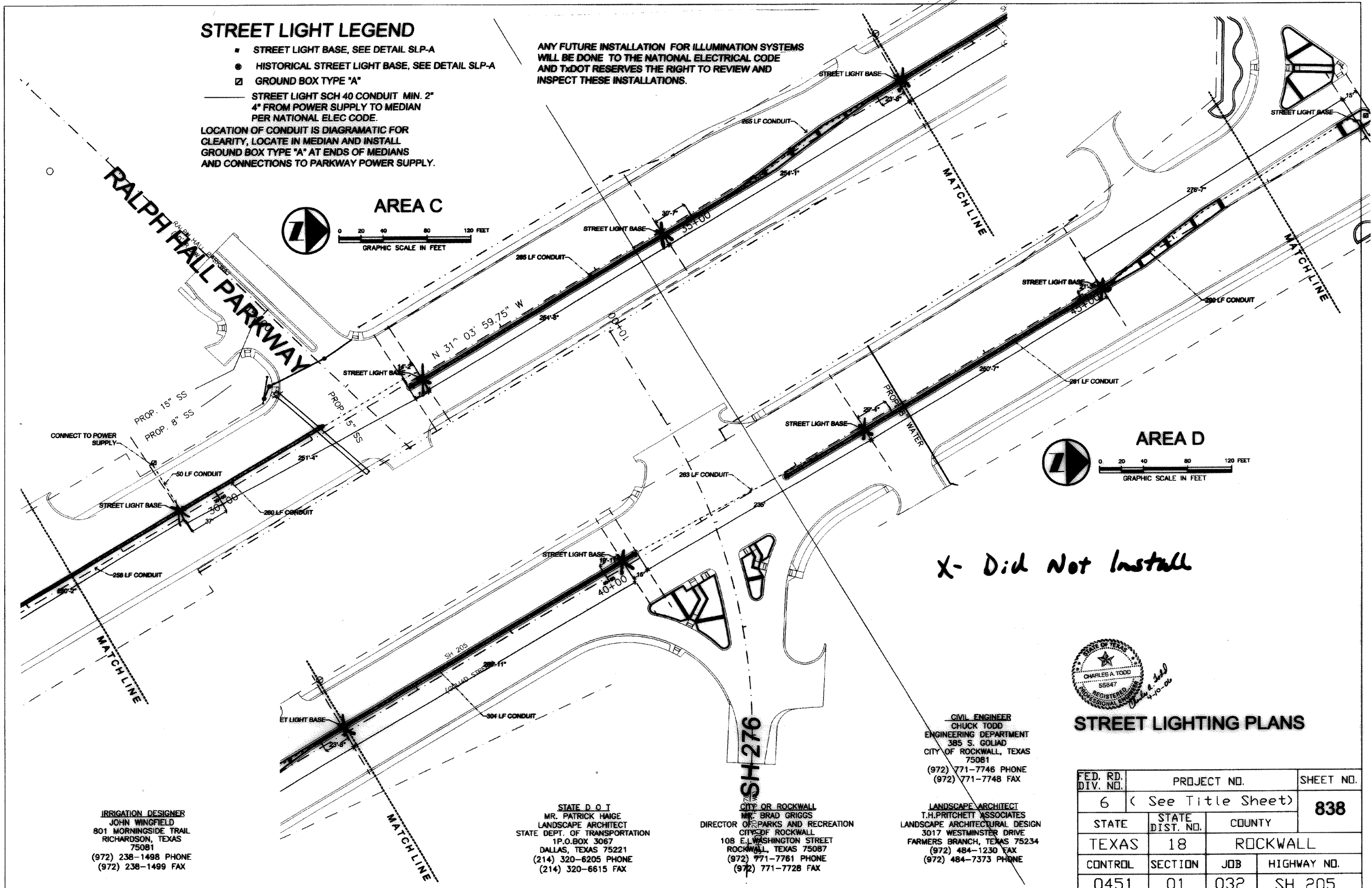

IRRIGATION DESIGNER
JOHN WINGFIELD
801 MORNINGSTAR TRAIL
RICHARDSON, TEXAS
75081
(972) 238-1498 PHONE
(972) 238-1499 FAX

STATE D O T
MR. PATRICK HAIGE
LANDSCAPE ARCHITECT
STATE DEPT. OF TRANSPORTATION
1 P.O. BOX 3067
DALLAS, TEXAS 75221
(214) 320-6205 PHONE
(214) 320-6615 FAX

CITY OF ROCKWALL
MR. BRAD GRIGGS
DIRECTOR OF PARKS AND RECREATION
CITY OF ROCKWALL
108 E. WASHINGTON STREET
ROCKWALL, TEXAS 75087
(972) 771-7761 PHONE
(972) 771-7728 FAX

CIVIL ENGINEER
CHUCK TODD
ENGINEERING DEPARTMENT
385 S. GOLIAD
CITY OF ROCKWALL, TEXAS
75081
(972) 771-7746 PHONE
(972) 771-7748 FAX

LANDSCAPE ARCHITECT
T.H. PRITCHETT ASSOCIATES
LANDSCAPE ARCHITECTURAL DESIGN
3017 WESTMINSTER DRIVE
FARMERS BRANCH, TEXAS 75234
(972) 484-1230 FAX
(972) 484-7373 PHONE



STREET LIGHTING PLANS

FED. RD. DIV. NO.	PROJECT NO.	SHEET NO.	
6	(See Title Sheet)	838	
STATE	STATE DIST. NO.	COUNTY	
TEXAS	18	ROCKWALL	
CONTROL	SECTION	JOB	HIGHWAY NO.
0451	01	032	SH 205

STREET LIGHT LEGEND

- STREET LIGHT BASE, SEE DETAIL SLP-A
- HISTORICAL STREET LIGHT BASE, SEE DETAIL SLP-A
- GROUND BOX TYPE "A"
- STREET LIGHT SCH 40 CONDUIT MIN. 2" 4" FROM POWER SUPPLY TO MEDIAN PER NATIONAL ELEC CODE.

LOCATION OF CONDUIT IS DIAGRAMATIC FOR CLARITY, LOCATE IN MEDIAN AND INSTALL GROUND BOX TYPE "A" AT ENDS OF MEDIANS AND CONNECTIONS TO PARKWAY POWER SUPPLY.

ANY FUTURE INSTALLATION FOR ILLUMINATION SYSTEMS WILL BE DONE TO THE NATIONAL ELECTRICAL CODE AND TxDOT RESERVES THE RIGHT TO REVIEW AND INSPECT THESE INSTALLATIONS.

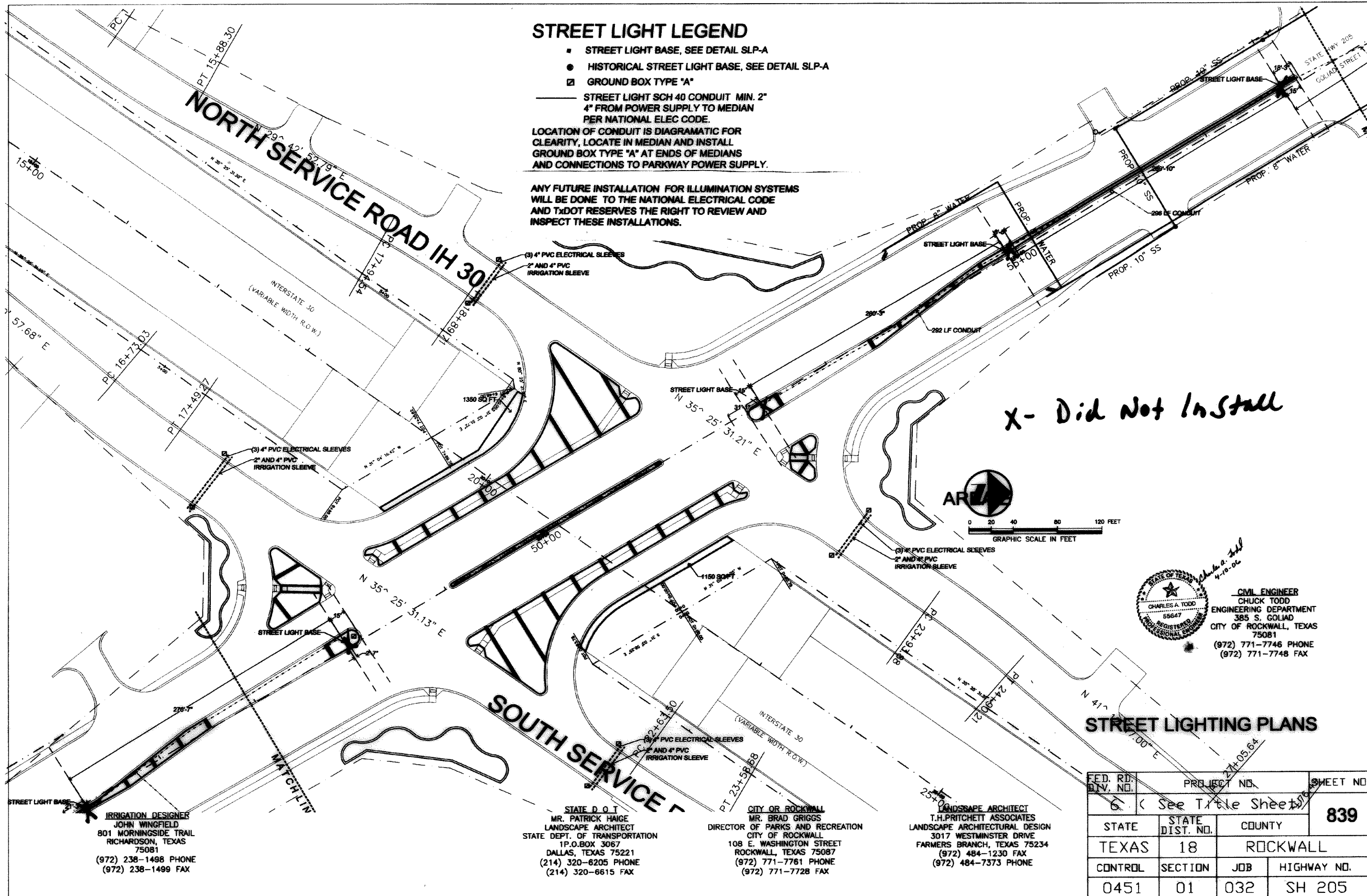

X- Did Not Install



CIVIL ENGINEER
 CHUCK TODD
 ENGINEERING DEPARTMENT
 385 S. GOLIAD
 CITY OF ROCKWALL, TEXAS
 75081
 (972) 771-7746 PHONE
 (972) 771-7748 FAX

STREET LIGHTING PLANS

IRRIGATION DESIGNER
 JOHN WINGFIELD
 801 MORNINGSIDE TRAIL
 RICHARDSON, TEXAS
 75081
 (972) 238-1498 PHONE
 (972) 238-1499 FAX

STATE D O T
 MR. PATRICK HAIGE
 LANDSCAPE ARCHITECT
 STATE DEPT. OF TRANSPORTATION
 1 P.O. BOX 3067
 DALLAS, TEXAS 75221
 (214) 320-8205 PHONE
 (214) 320-6615 FAX

CITY OF ROCKWALL
 MR. BRAD GRIGGS
 DIRECTOR OF PARKS AND RECREATION
 CITY OF ROCKWALL
 108 E. WASHINGTON STREET
 ROCKWALL, TEXAS 75087
 (972) 771-7761 PHONE
 (972) 771-7728 FAX

LANDSCAPE ARCHITECT
 T.H. PRITCHETT ASSOCIATES
 LANDSCAPE ARCHITECTURAL DESIGN
 3017 WESTMINSTER DRIVE
 FARMERS BRANCH, TEXAS 75234
 (972) 484-1230 FAX
 (972) 484-7373 PHONE

FED. RD. DIV. NO.	PROJECT NO.	SHEET NO.	
0451	01	839	
STATE	STATE DIST. NO.	COUNTY	
TEXAS	18	ROCKWALL	
CONTROL	SECTION	JOB	HIGHWAY NO.
0451	01	032	SH 205

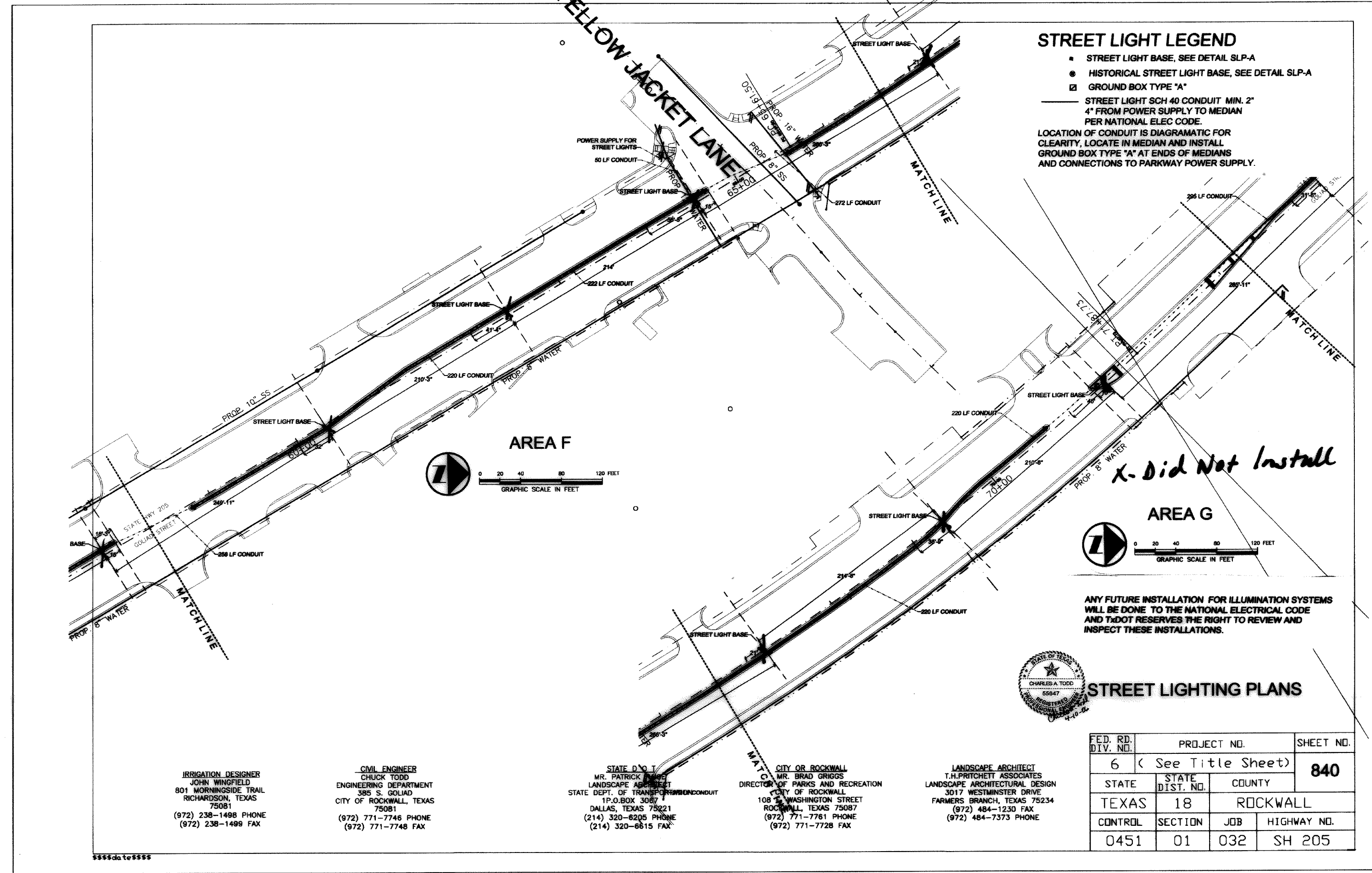

STREET LIGHT LEGEND

- STREET LIGHT BASE, SEE DETAIL SLP-A
- HISTORICAL STREET LIGHT BASE, SEE DETAIL SLP-A
- GROUND BOX TYPE "A"
- STREET LIGHT SCH 40 CONDUIT MIN. 2" 4" FROM POWER SUPPLY TO MEDIAN PER NATIONAL ELEC CODE.

LOCATION OF CONDUIT IS DIAGRAMATIC FOR CLARITY, LOCATE IN MEDIAN AND INSTALL GROUND BOX TYPE "A" AT ENDS OF MEDIANS AND CONNECTIONS TO PARKWAY POWER SUPPLY.

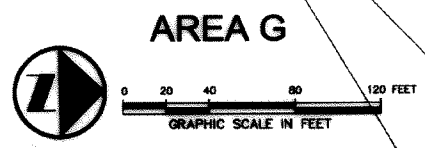
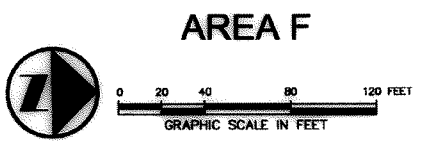

X-Did Not Install

ANY FUTURE INSTALLATION FOR ILLUMINATION SYSTEMS WILL BE DONE TO THE NATIONAL ELECTRICAL CODE AND TxDOT RESERVES THE RIGHT TO REVIEW AND INSPECT THESE INSTALLATIONS.



STREET LIGHTING PLANS

IRRIGATION DESIGNER
 JOHN WINGFIELD
 801 MORNINGSIDE TRAIL
 RICHARDSON, TEXAS 75081
 (972) 238-1498 PHONE
 (972) 238-1499 FAX

CIVIL ENGINEER
 CHUCK TODD
 ENGINEERING DEPARTMENT
 385 S. GOLIAD
 CITY OF ROCKWALL, TEXAS 75081
 (972) 771-7746 PHONE
 (972) 771-7748 FAX

STATE D.P.I.
 MR. PATRICK W. WELLS
 LANDSCAPE ARCHITECT
 STATE DEPT. OF TRANSPORTATION
 P.O. BOX 3087
 DALLAS, TEXAS 75221
 (214) 320-6205 PHONE
 (214) 320-6615 FAX

CITY OF ROCKWALL
 MR. BRAD GRIGGS
 DIRECTOR OF PARKS AND RECREATION
 CITY OF ROCKWALL
 108 1/2 WASHINGTON STREET
 ROCKWALL, TEXAS 75087
 (972) 771-7761 PHONE
 (972) 771-7728 FAX

LANDSCAPE ARCHITECT
 T.H. PRITCHETT ASSOCIATES
 LANDSCAPE ARCHITECTURAL DESIGN
 3017 WESTMINSTER DRIVE
 FARMERS BRANCH, TEXAS 75234
 (972) 484-1230 FAX
 (972) 484-7373 PHONE

FED. RD. DIV. NO.	PROJECT NO.	SHEET NO.	
6	(See Title Sheet)	840	
STATE	STATE DIST. NO.	COUNTY	
TEXAS	18	ROCKWALL	
CONTROL	SECTION	JOB	HIGHWAY NO.
0451	01	032	SH 205

STREET LIGHT LEGEND

- STREET LIGHT BASE, SEE DETAIL SLP-A
- HISTORICAL STREET LIGHT BASE, SEE DETAIL SLP-A
- ☐ GROUND BOX TYPE "A"
- STREET LIGHT SCH 40 CONDUIT MIN. 2" 4" FROM POWER SUPPLY TO MEDIAN PER NATIONAL ELEC CODE.

LOCATION OF CONDUIT IS DIAGRAMATIC FOR CLARITY, LOCATE IN MEDIAN AND INSTALL GROUND BOX TYPE "A" AT ENDS OF MEDIANS AND CONNECTIONS TO PARKWAY POWER SUPPLY.

ANY FUTURE INSTALLATION FOR ILLUMINATION SYSTEMS WILL BE DONE TO THE NATIONAL ELECTRICAL CODE AND TxDOT RESERVES THE RIGHT TO REVIEW AND INSPECT THESE INSTALLATIONS.

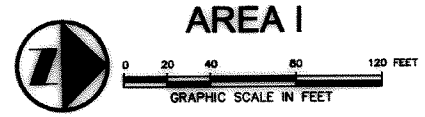
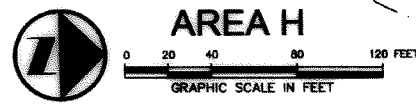
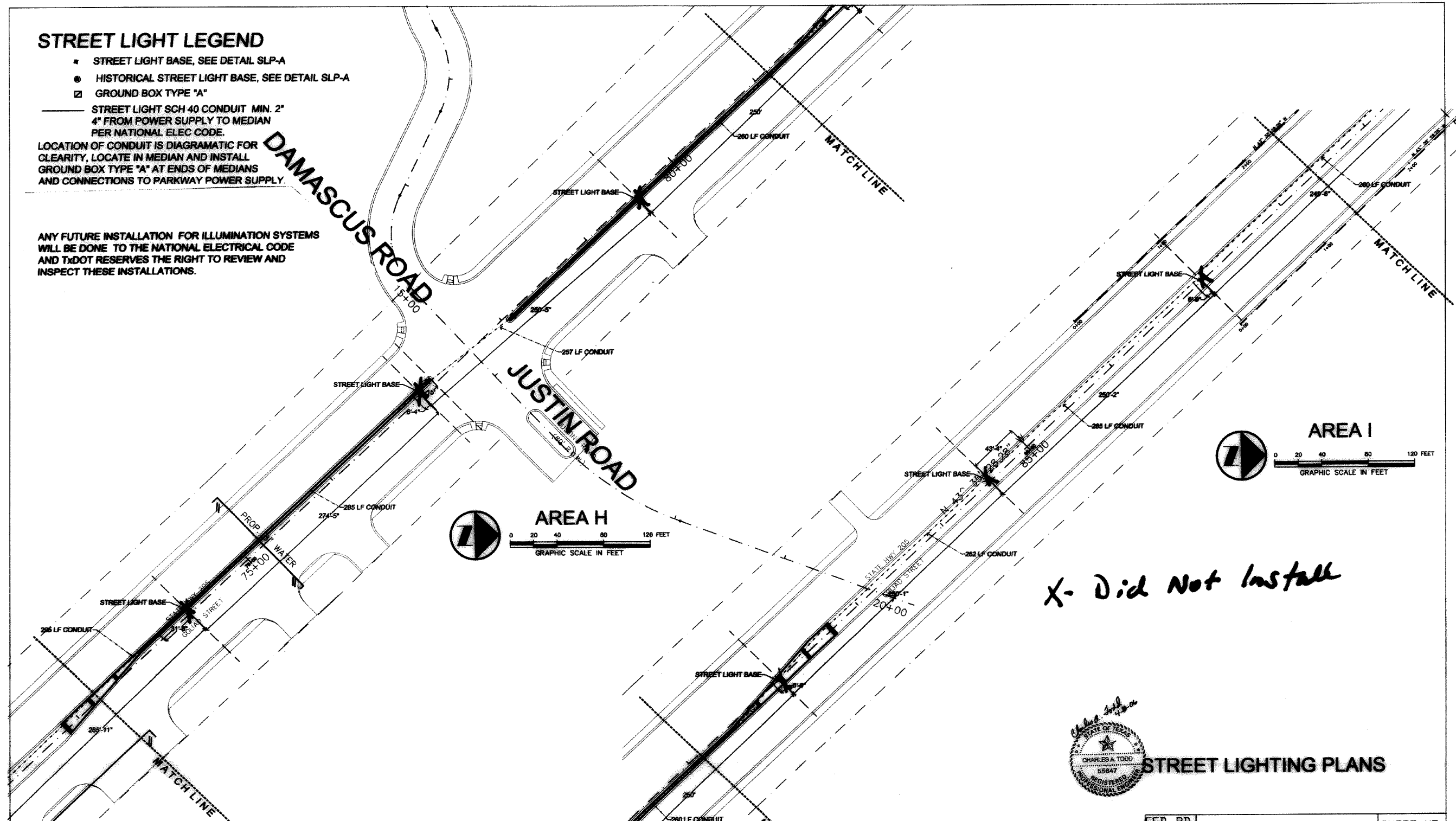

IRRIGATION DESIGNER
JOHN WINGFIELD
801 MORNINGSIDE TRAIL
RICHARDSON, TEXAS
75081
(972) 238-1498 PHONE
(972) 238-1499 FAX

CIVIL ENGINEER
CHUCK TODD
ENGINEERING DEPARTMENT
385 S. GOLJAD
CITY OF ROCKWALL, TEXAS
75081
(972) 771-7746 PHONE
(972) 771-7748 FAX

STATE D.O.T.
MR. PATRICK HARGE
LANDSCAPE ARCHITECT
STATE DEPT. OF TRANSPORTATION
1 P.O. BOX 3067
DALLAS, TEXAS 75221
(214) 320-6205 PHONE
(214) 320-6615 FAX

CITY OF ROCKWALL
MR. BOB GRIGGS
DIRECTOR OF PARKS AND RECREATION
CITY OF ROCKWALL
108 E. WASHINGTON STREET
ROCKWALL, TEXAS 75087
(972) 771-7761 PHONE
(972) 771-7728 FAX

LANDSCAPE ARCHITECT
T.H. PRITCHETT ASSOCIATES
LANDSCAPE ARCHITECTURAL DESIGN
3017 WESTMINSTER DRIVE
FARMERS BRANCH, TEXAS 75234
(972) 484-1230 FAX
(972) 484-7373 PHONE



STREET LIGHTING PLANS

FED. RD. DIV. NO.	PROJECT NO.		SHEET NO.
6	(See Title Sheet)		841
STATE	STATE DIST. NO.	COUNTY	
TEXAS	18	ROCKWALL	
CONTROL	SECTION	JOB	HIGHWAY NO.
0451	01	032	SH 205

\$\$\$\$date\$\$\$\$

STREET LIGHT LEGEND

- STREET LIGHT BASE, SEE DETAIL SLP-A
- HISTORICAL STREET LIGHT BASE, SEE DETAIL SLP-A
- GROUND BOX TYPE "A"
- STREET LIGHT SCH 40 CONDUIT MIN. 2" 4" FROM POWER SUPPLY TO MEDIAN PER NATIONAL ELEC CODE.

LOCATION OF CONDUIT IS DIAGRAMATIC FOR CLARITY, LOCATE IN MEDIAN AND INSTALL GROUND BOX TYPE "A" AT ENDS OF MEDIANS AND CONNECTIONS TO PARKWAY POWER SUPPLY.

ANY FUTURE INSTALLATION FOR ILLUMINATION SYSTEMS WILL BE DONE TO THE NATIONAL ELECTRICAL CODE AND TxDOT RESERVES THE RIGHT TO REVIEW AND INSPECT THESE INSTALLATIONS.

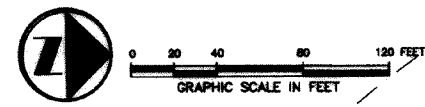
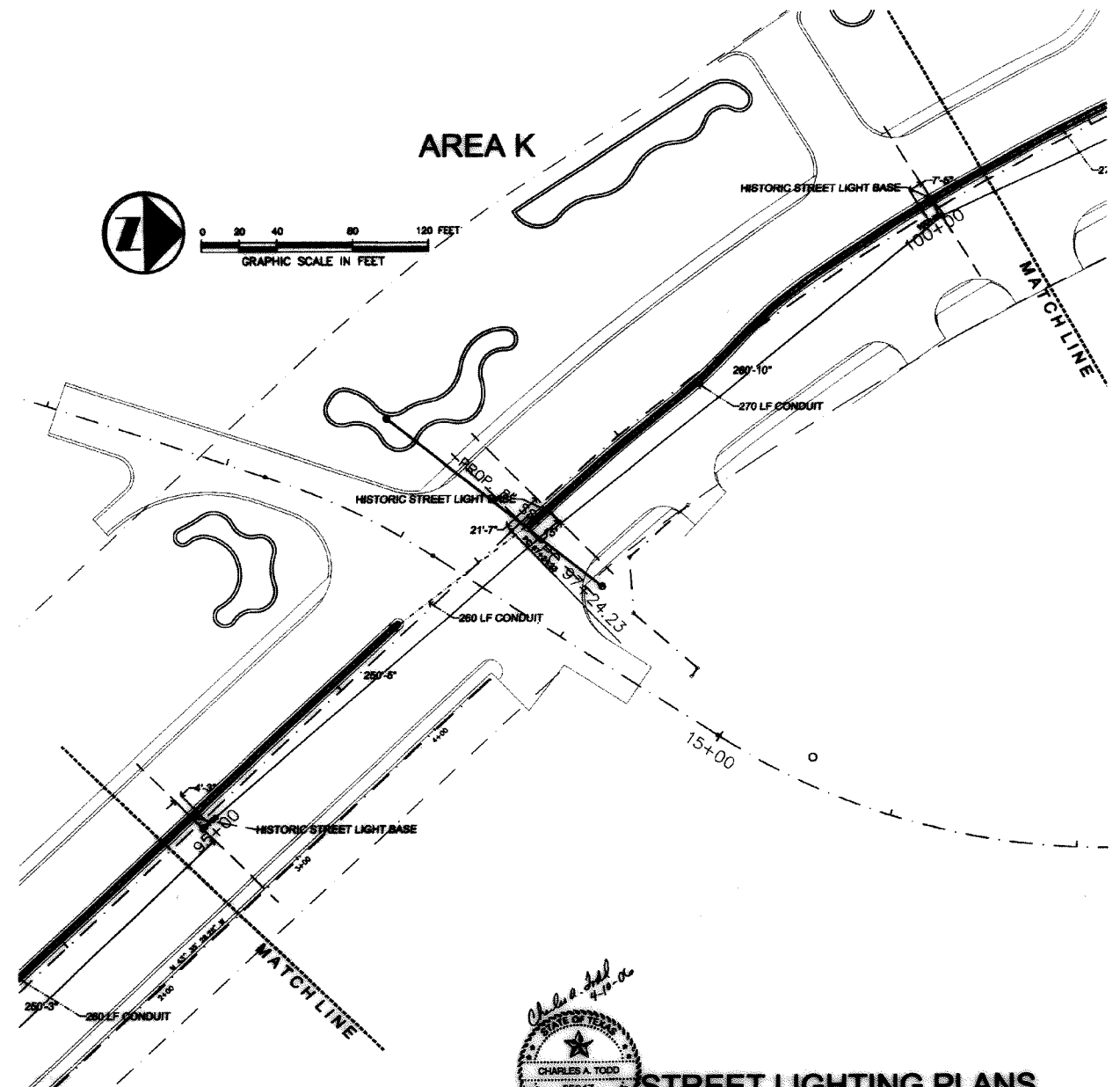
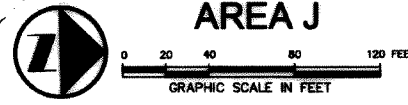
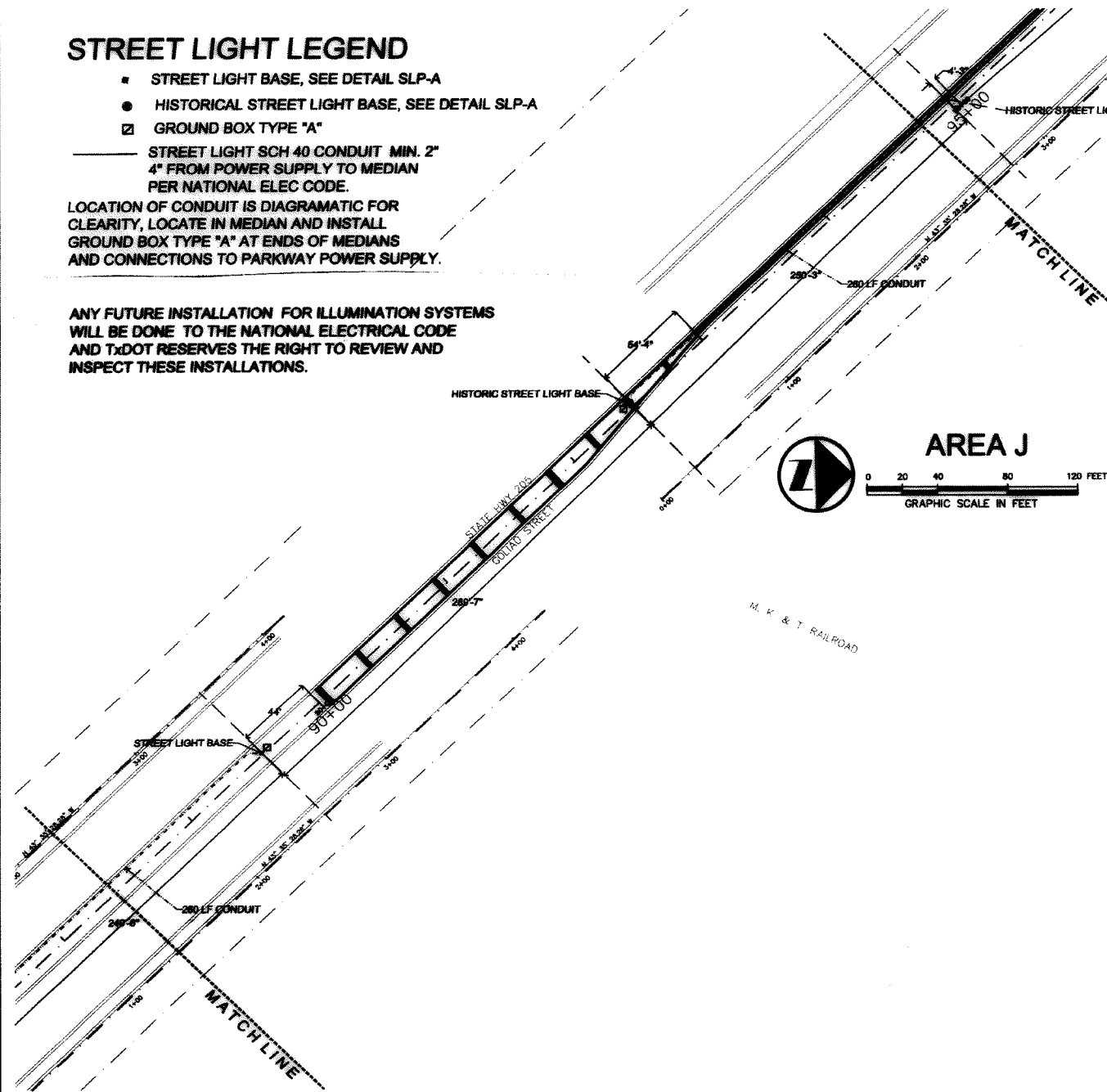

STREET LIGHTING PLANS

IRRIGATION DESIGNER
 JOHN WINGFIELD
 801 MORNINGSIDE TRAIL
 RICHARDSON, TEXAS 75081
 (972) 238-1498 PHONE
 (972) 238-1499 FAX

CIVIL ENGINEER
 CHUCK TODD
 ENGINEERING DEPARTMENT
 385 S. GOLIAD
 CITY OF ROCKWALL, TEXAS 75081
 (972) 771-7746 PHONE
 (972) 771-7748 FAX

STATE D O T
 MR. PATRICK HAIGE
 LANDSCAPE ARCHITECT
 STATE DEPT. OF TRANSPORTATION
 1 P.O. BOX 3067
 DALLAS, TEXAS 75221
 (214) 320-6205 PHONE
 (214) 320-6615 FAX

CITY OF ROCKWALL
 MR. BRAD GRIGGS
 DIRECTOR OF PARKS AND RECREATION
 CITY OF ROCKWALL
 108 E. WASHINGTON STREET
 ROCKWALL, TEXAS 75087
 (972) 771-7761 PHONE
 (972) 771-7728 FAX

LANDSCAPE ARCHITECT
 T.H. PRITCHETT ASSOCIATES
 LANDSCAPE ARCHITECTURAL DESIGN
 3017 WESTMINSTER DRIVE
 FARMERS BRANCH, TEXAS 75234
 (972) 484-1230 FAX
 (972) 484-7373 PHONE

FED. RD. DIV. NO.	PROJECT NO.	SHEET NO.	
6	(See Title Sheet)	842	
STATE	STATE DIST. NO.	COUNTY	
TEXAS	18	ROCKWALL	
CONTROL	SECTION	JOB	HIGHWAY NO.
0451	01	032	SH 205

STREET LIGHT LEGEND

- STREET LIGHT BASE, SEE DETAIL SLP-A
- HISTORICAL STREET LIGHT BASE, SEE DETAIL SLP-A
- ☐ GROUND BOX TYPE "A"
- STREET LIGHT SCH 40 CONDUIT MIN. 2" 4" FROM POWER SUPPLY TO MEDIAN PER NATIONAL ELEC CODE.

LOCATION OF CONDUIT IS DIAGRAMATIC FOR CLARITY, LOCATE IN MEDIAN AND INSTALL GROUND BOX TYPE "A" AT ENDS OF MEDIANS AND CONNECTIONS TO PARKWAY POWER SUPPLY.

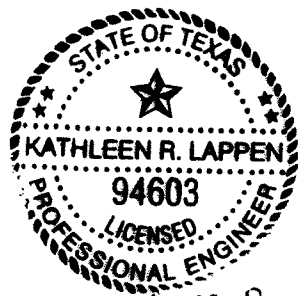
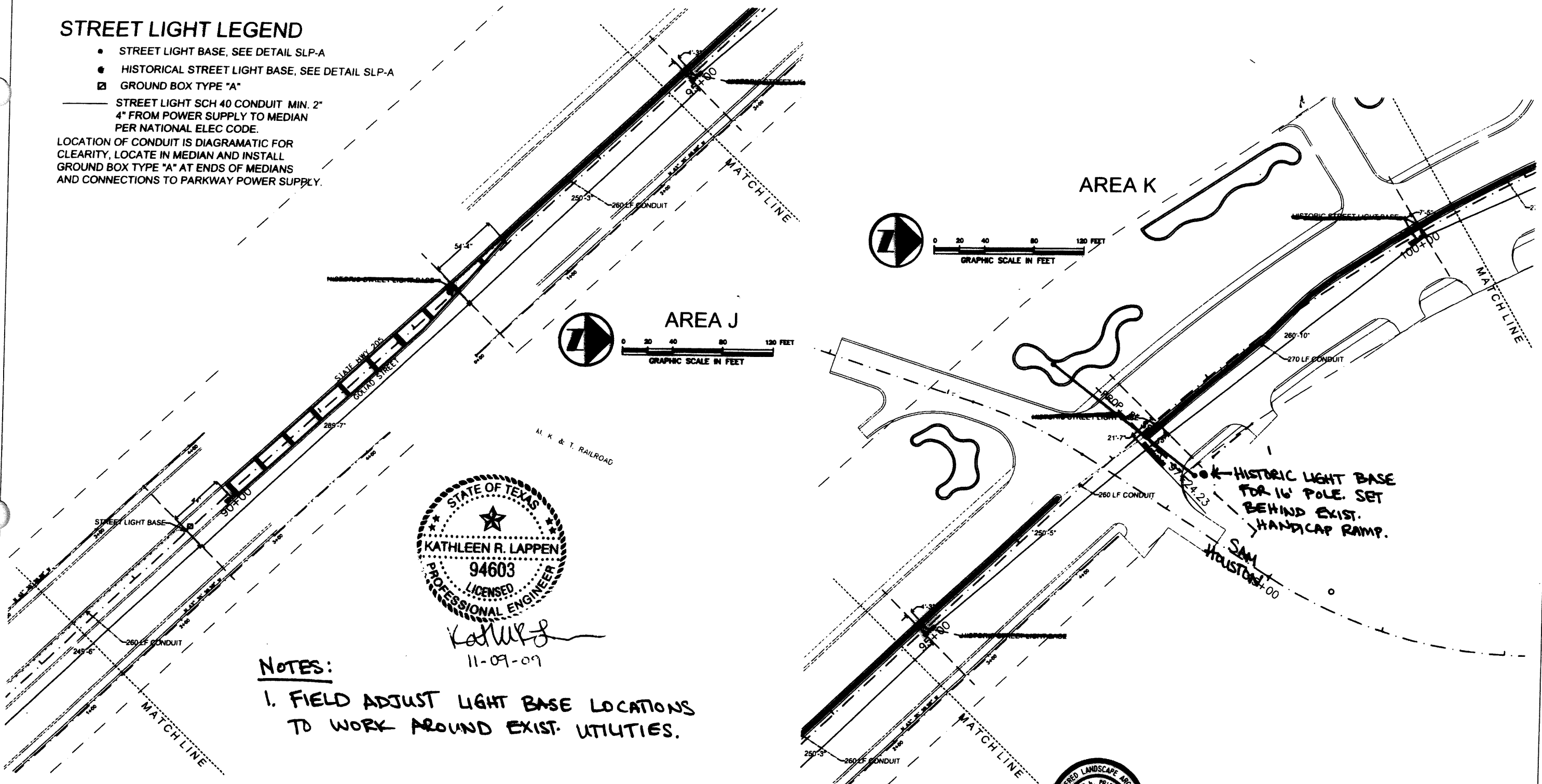

Kathleen R. Lappen
11-09-09

NOTES:

1. FIELD ADJUST LIGHT BASE LOCATIONS TO WORK AROUND EXIST. UTILITIES.



THE SEAL APPEARING ON THIS DOCUMENT WAS AUTHORIZED BY T. H. PRITCHETT, R.L.A. NO. 2115 ON 03/22/2006

STREET LIGHTING PLANS

FED. RD. DIV. NO.	PROJECT NO.		SHEET NO.
6	See Title Sheet		842A
STATE	STATE DIST. NO.	COUNTY	
TEXAS	18	ROCKWALL	
CONTROL	SECTION	JOB	HIGHWAY NO.
0451	01	032	SH 205

IRRIGATION DESIGNER
JOHN WINDFIELD
801 MORNINGSIDE TRAIL
RICHARDSON, TEXAS 75081
(972) 238-1488 PHONE
(972) 238-1489 FAX

STATE D.O.T.
MR. PATRICK HAIGE
LANDSCAPE ARCHITECT
STATE DEPT. OF TRANSPORTATION
1 P.O. BOX 3087
DALLAS, TEXAS 75221
(214) 320-8205 PHONE
(214) 320-8815 FAX

CITY OF ROCKWALL
MR. BRAD GRIGGS
DIRECTOR OF PARKS AND RECREATION
CITY OF ROCKWALL
108 E. WASHINGTON STREET
ROCKWALL, TEXAS 75087
(972) 771-7761 PHONE
(972) 771-7728 FAX

LANDSCAPE ARCHITECT
T.H. PRITCHETT ASSOCIATES
LANDSCAPE ARCHITECTURAL DESIGN
3017 WESTMINSTER DRIVE
FARMERS BRANCH, TEXAS 75234
(972) 484-1230 FAX
(972) 484-7373 PHONE

STREET LIGHT LEGEND

- STREET LIGHT BASE, SEE DETAIL SLP-A
- HISTORICAL STREET LIGHT BASE, SEE DETAIL SLP-A
- ☐ GROUND BOX TYPE "A"
- STREET LIGHT SCH 40 CONDUIT MIN. 2" 4" FROM POWER SUPPLY TO MEDIAN PER NATIONAL ELEC CODE.

LOCATION OF CONDUIT IS DIAGRAMATIC FOR CLARITY, LOCATE IN MEDIAN AND INSTALL GROUND BOX TYPE "A" AT ENDS OF MEDIANS AND CONNECTIONS TO PARKWAY POWER SUPPLY.

ANY FUTURE INSTALLATION FOR ILLUMINATION SYSTEMS WILL BE DONE TO THE NATIONAL ELECTRICAL CODE AND TxDOT RESERVES THE RIGHT TO REVIEW AND INSPECT THESE INSTALLATIONS.

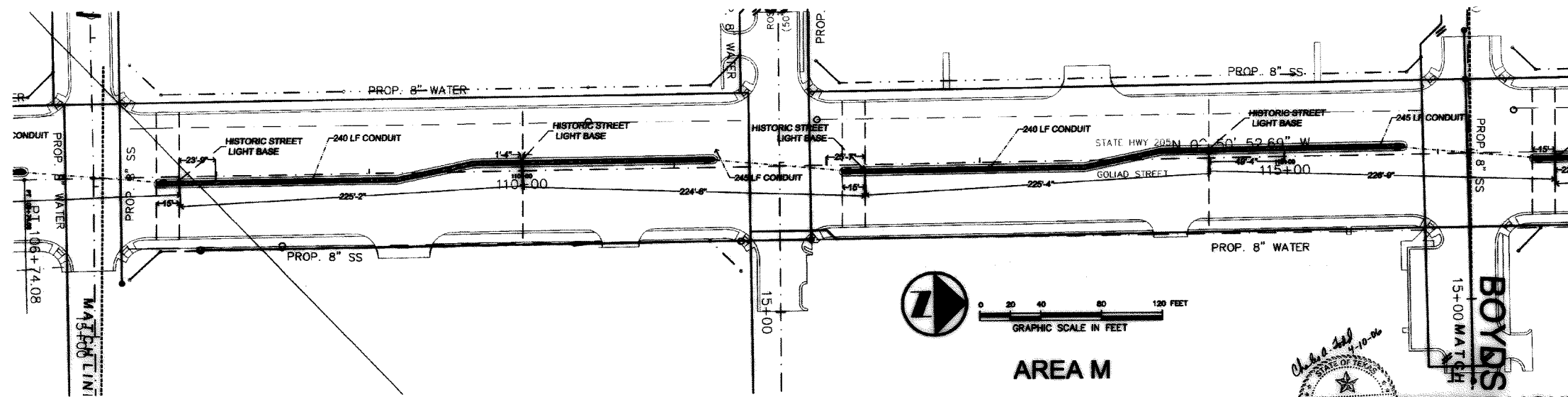
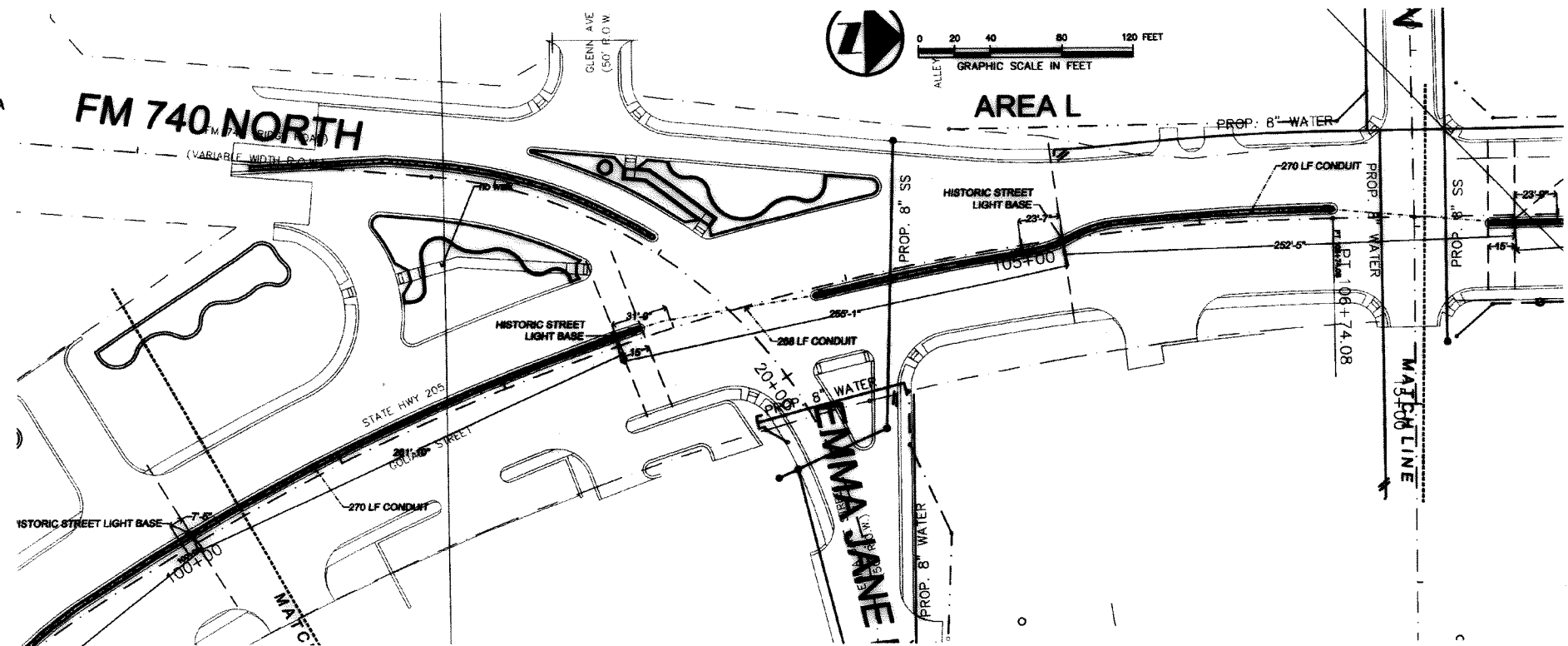

STREET LIGHTING PLANS

IRRIGATION DESIGNER
 JOHN WINGFIELD
 801 MORNINGSIDE TRAIL
 RICHARDSON, TEXAS 75081
 (972) 238-1498 PHONE
 (972) 238-1499 FAX

CIVIL ENGINEER
 CHUCK TODD
 ENGINEERING DEPARTMENT
 385 S. GOLIAD
 CITY OF ROCKWALL, TEXAS 75081
 (972) 771-7746 PHONE
 (972) 771-7748 FAX

STATE D.O.T.
 MR. PATRICK HAIGE
 LANDSCAPE ARCHITECT
 STATE DEPT. OF TRANSPORTATION
 1 P.O. BOX 3067
 DALLAS, TEXAS 75221
 (214) 320-6205 PHONE
 (214) 320-6615 FAX

CITY OF ROCKWALL
 MR. BRAD ORIGGS
 DIRECTOR OF PARKS AND RECREATION
 CITY OF ROCKWALL
 108 E. WASHINGTON STREET
 ROCKWALL, TEXAS 75087
 (972) 771-7761 PHONE
 (972) 771-7728 FAX

LANDSCAPE ARCHITECT
 T.H. PRITCHETT ASSOCIATES
 LANDSCAPE ARCHITECTURAL DESIGN
 3017 WESTMINSTER DRIVE
 FARMERS BRANCH, TEXAS 75234
 (972) 484-1230 FAX
 (972) 484-7373 PHONE

FED. RD. DIV. NO.	PROJECT NO.		SHEET NO.
6	(See Title Sheet)		843
STATE	STATE DIST. NO.	COUNTY	
TEXAS	18	ROCKWALL	
CONTROL	SECTION	JOB	HIGHWAY NO.
0451	01	032	SH 205

STREET LIGHT LEGEND

- STREET LIGHT BASE, SEE DETAIL SLP-A
- HISTORICAL STREET LIGHT BASE, SEE DETAIL SLP-A
- ☐ GROUND BOX TYPE "A"
- STREET LIGHT SCH 40 CONDUIT MIN. 2" 4" FROM POWER SUPPLY TO MEDIAN PER NATIONAL ELEC CODE.

LOCATION OF CONDUIT IS DIAGRAMATIC FOR CLARITY, LOCATE IN MEDIAN AND INSTALL GROUND BOX TYPE "A" AT ENDS OF MEDIANS AND CONNECTIONS TO PARKWAY POWER SUPPLY.

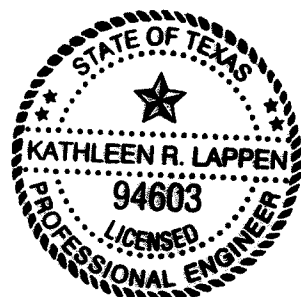

Kat Wilson
11-01-09

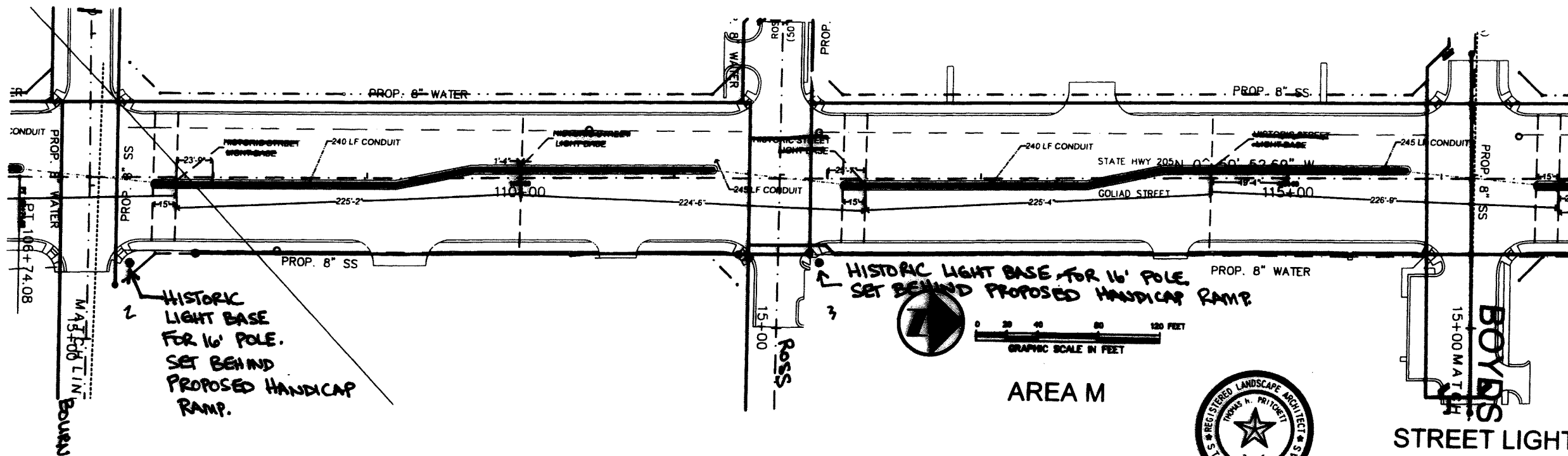
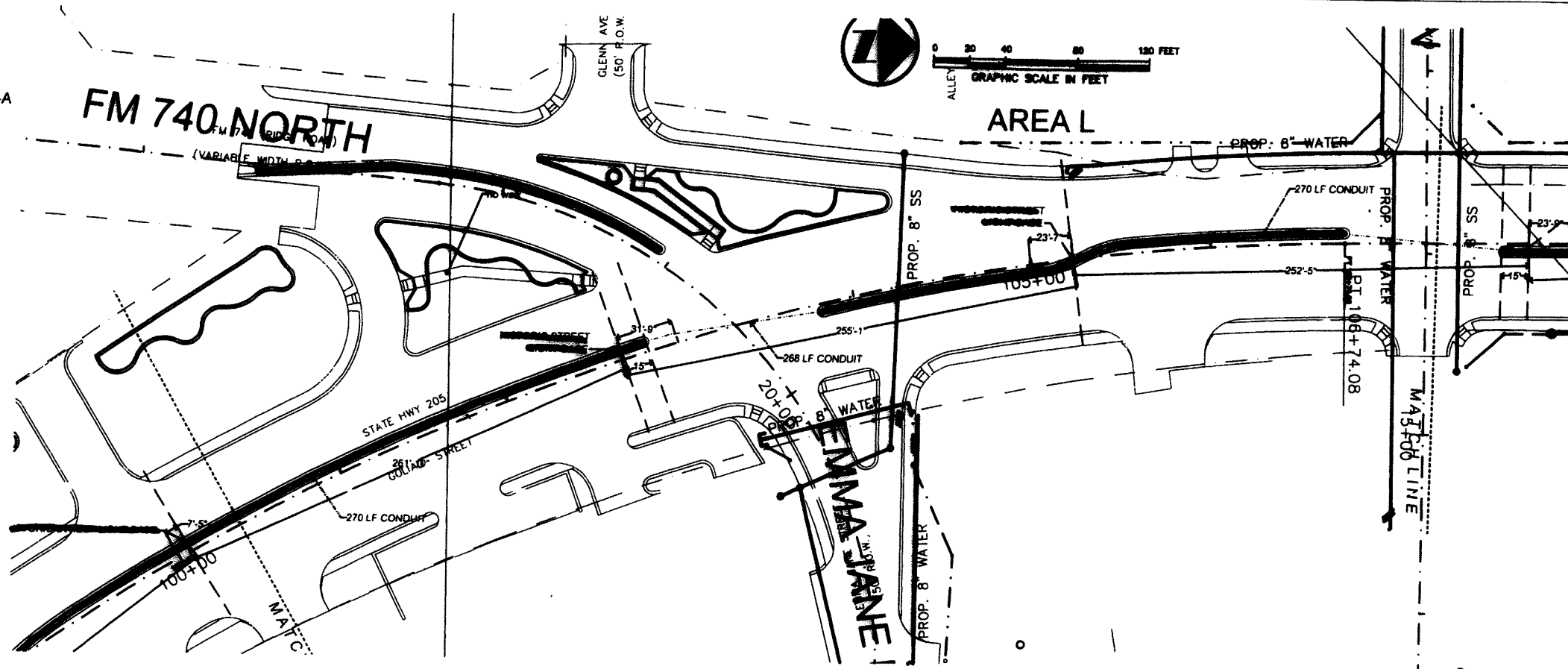

SEE NOTES, PAGE 1.

IRRIGATION DESIGNER
JOHN WINGFIELD
801 MORNINGSIDE TRAIL
RICHARDSON, TEXAS
75081
(972) 238-1488 PHONE
(972) 238-1488 FAX

STATE D.O.T
MR. PATRICK HAGE
LANDSCAPE ARCHITECT
STATE DEPT. OF TRANSPORTATION
1 P.O. BOX 3087
DALLAS, TEXAS 75221
(214) 320-6205 PHONE
(214) 320-8615 FAX

CITY OF ROCKWALL
MR. BRAD GRIGGS
DIRECTOR OF PARKS AND RECREATION
CITY OF ROCKWALL
108 E. WASHINGTON STREET
ROCKWALL, TEXAS 75087
(972) 771-7781 PHONE
(972) 771-7728 FAX

LANDSCAPE ARCHITECT
T.H. PRITCHETT ASSOCIATES
LANDSCAPE ARCHITECTURAL DESIGN
3017 WESTMINSTER DRIVE
FARMERS BRANCH, TEXAS 75234
(972) 484-1230 FAX
(972) 484-7373 PHONE



THE SEAL APPEARING ON THIS DOCUMENT WAS AUTHORIZED BY T. H. PRITCHETT, R.L.A. NO. 2115 ON 03/22/2006

STREET LIGHTING PLANS

FED. RD. DIV. NO.	PROJECT NO.		SHEET NO.
6	(See Title Sheet)		843A
STATE	STATE DIST. NO.	COUNTY	
TEXAS	18	ROCKWALL	
CTRL	SECTION	JOB	HIGHWAY NO.
0451	01	032	SH 205

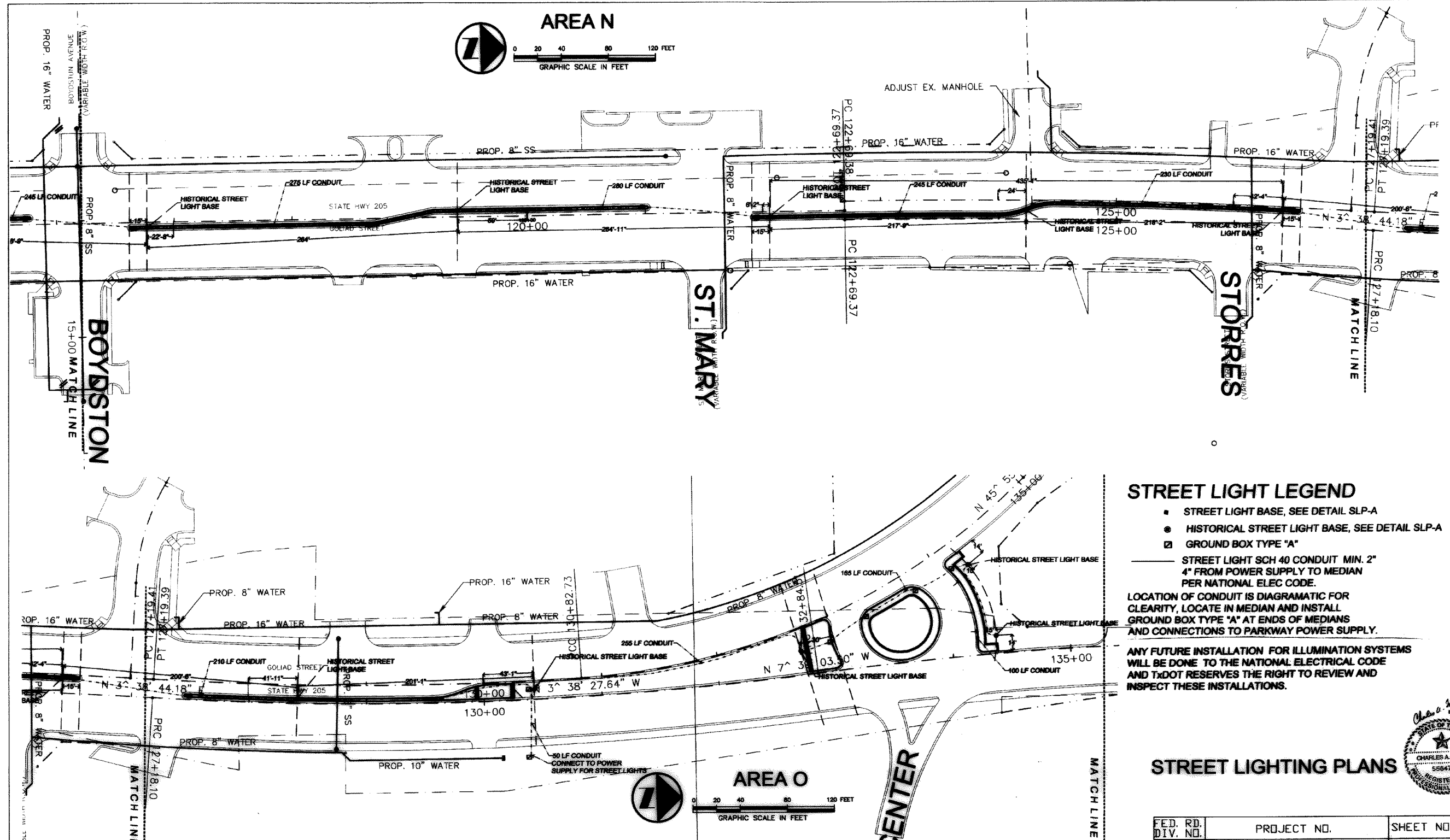

STREET LIGHT LEGEND

- STREET LIGHT BASE, SEE DETAIL SLP-A
- HISTORICAL STREET LIGHT BASE, SEE DETAIL SLP-A
- GROUND BOX TYPE "A"
- STREET LIGHT SCH 40 CONDUIT MIN. 2" 4" FROM POWER SUPPLY TO MEDIAN PER NATIONAL ELEC CODE.

LOCATION OF CONDUIT IS DIAGRAMATIC FOR CLARITY, LOCATE IN MEDIAN AND INSTALL GROUND BOX TYPE "A" AT ENDS OF MEDIANS AND CONNECTIONS TO PARKWAY POWER SUPPLY.

ANY FUTURE INSTALLATION FOR ILLUMINATION SYSTEMS WILL BE DONE TO THE NATIONAL ELECTRICAL CODE AND TxDOT RESERVES THE RIGHT TO REVIEW AND INSPECT THESE INSTALLATIONS.

STREET LIGHTING PLANS

FED. RD. DIV. NO.	PROJECT NO.	SHEET NO.	
6	(See Title Sheet)	844	
STATE	STATE DIST. NO.	COUNTY	
TEXAS	18	ROCKWALL	
CONTROL	SECTION	JOB	HIGHWAY NO.
0451	01	032	SH 205

IRRIGATION DESIGNER
 JOHN WINGFIELD
 801 MORNINGSTAR TRAIL
 RICHARDSON, TEXAS 75081
 (972) 238-1498 PHONE
 (972) 238-1499 FAX

CIVIL ENGINEER
 CHUCK TODD
 ENGINEERING DEPARTMENT
 385 S. GOLIAD
 CITY OF ROCKWALL, TEXAS 75081
 (972) 771-7746 PHONE
 (972) 771-7748 FAX

STATE D O T
 MR. PATRICK HAIGE
 LANDSCAPE ARCHITECT
 STATE DEPT. OF TRANSPORTATION
 1P.O. BOX 3067
 DALLAS, TEXAS 75221
 (214) 320-6205 PHONE
 (214) 320-6615 FAX

CITY OF ROCKWALL
 MR. BRAD GRIGGS
 DIRECTOR OF PARKS AND RECREATION
 CITY OF ROCKWALL
 108 E. WASHINGTON STREET
 ROCKWALL, TEXAS 75087
 (972) 771-7761 PHONE
 (972) 771-7728 FAX

LANDSCAPE ARCHITECT
 T.H. PRITCHETT ASSOCIATES
 LANDSCAPE ARCHITECTURAL DESIGN
 3017 WESTMINSTER DRIVE
 FARMERS BRANCH, TEXAS 75234
 (972) 484-1230 FAX
 (972) 484-7373 PHONE



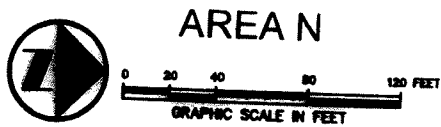

AREA N

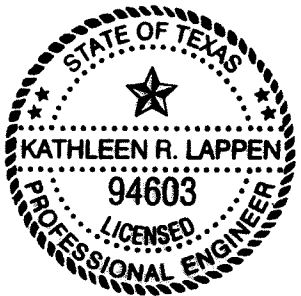
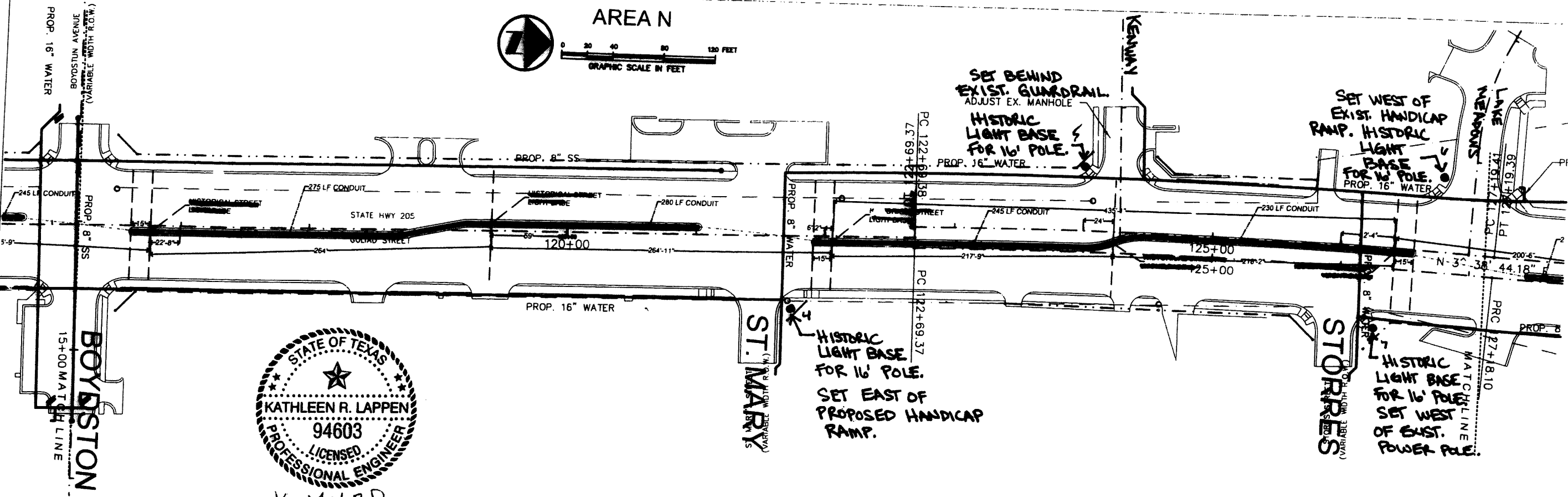

Kathleen R. Lappen
11-09-09

*** - USE BREAKAWAY BASE FOR 18' POLES IN MEDIAN. (2 TOTAL)**

STREET LIGHT LEGEND

- STREET LIGHT BASE, SEE DETAIL SLP-A
 - HISTORICAL STREET LIGHT BASE, SEE DETAIL SLP-A
 - ☐ GROUND BOX TYPE "A"
 - STREET LIGHT SCH 40 CONDUIT MIN. 2" 4" FROM POWER SUPPLY TO MEDIAN PER NATIONAL ELEC CODE.
- LOCATION OF CONDUIT IS DIAGRAMATIC FOR CLARITY, LOCATE IN MEDIAN AND INSTALL GROUND BOX TYPE "A" AT ENDS OF MEDIANS AND CONNECTIONS TO PARKWAY POWER SUPPLY.



AREA O

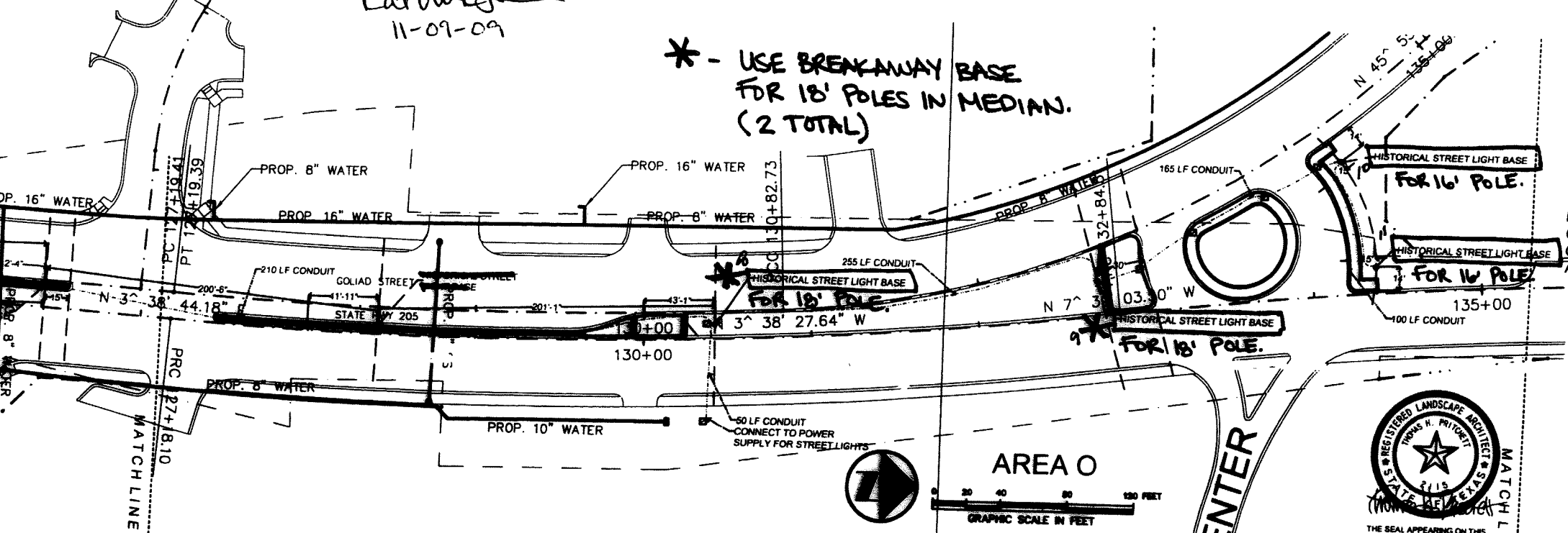

SEE NOTES, PAGE 1.

IRIGATION DESIGNER
JOHN WINDFIELD
801 MORNINGSIDE TRAIL
RICHARDSON, TEXAS 75081
(972) 238-1488 PHONE
(972) 238-1489 FAX

STATE D.O.T.
MR. PATRICK HANDE
LANDSCAPE ARCHITECT
STATE DEPT. OF TRANSPORTATION
1P.O. BOX 3087
DALLAS, TEXAS 75221
(214) 320-8205 PHONE
(214) 320-8815 FAX

CITY OF ROCKWALL
MR. BRAD GRIGGS
DIRECTOR OF PARKS AND RECREATION
CITY OF ROCKWALL
108 E. WASHINGTON STREET
ROCKWALL, TEXAS 75087
(972) 771-7781 PHONE
(972) 771-7728 FAX

LANDSCAPE ARCHITECT
T.H. PRITCHETT ASSOCIATES
LANDSCAPE ARCHITECTURAL DESIGN
3017 WESTMINSTER DRIVE
FARMERS BRANCH, TEXAS 75234
(972) 484-1230 FAX
(972) 484-7373 PHONE



STREET LIGHTING PLANS

FED. RD. DIV. NO.	PROJECT NO.	SHEET NO.
6	(See Title Sheet)	844A
STATE TEXAS	STATE DIST. NO. 18	COUNTY ROCKWALL
CONTROL 0451	SECTION 01	JOB 032
HIGHWAY NO. SH 205		

STREET LIGHT LEGEND

- STREET LIGHT BASE, SEE DETAIL SLP-A
- HISTORICAL STREET LIGHT BASE, SEE DETAIL SLP-A
- GROUND BOX TYPE "A"

— STREET LIGHT SCH 40 CONDUIT MIN. 2" 4" FROM POWER SUPPLY TO MEDIAN PER NATIONAL ELEC CODE.

LOCATION OF CONDUIT IS DIAGRAMATIC FOR CLARITY, LOCATE IN MEDIAN AND INSTALL GROUND BOX TYPE "A" AT ENDS OF MEDIANS AND CONNECTIONS TO PARKWAY POWER SUPPLY.

ANY FUTURE INSTALLATION FOR ILLUMINATION SYSTEMS WILL BE DONE TO THE NATIONAL ELECTRICAL CODE AND TxDOT RESERVES THE RIGHT TO REVIEW AND INSPECT THESE INSTALLATIONS.

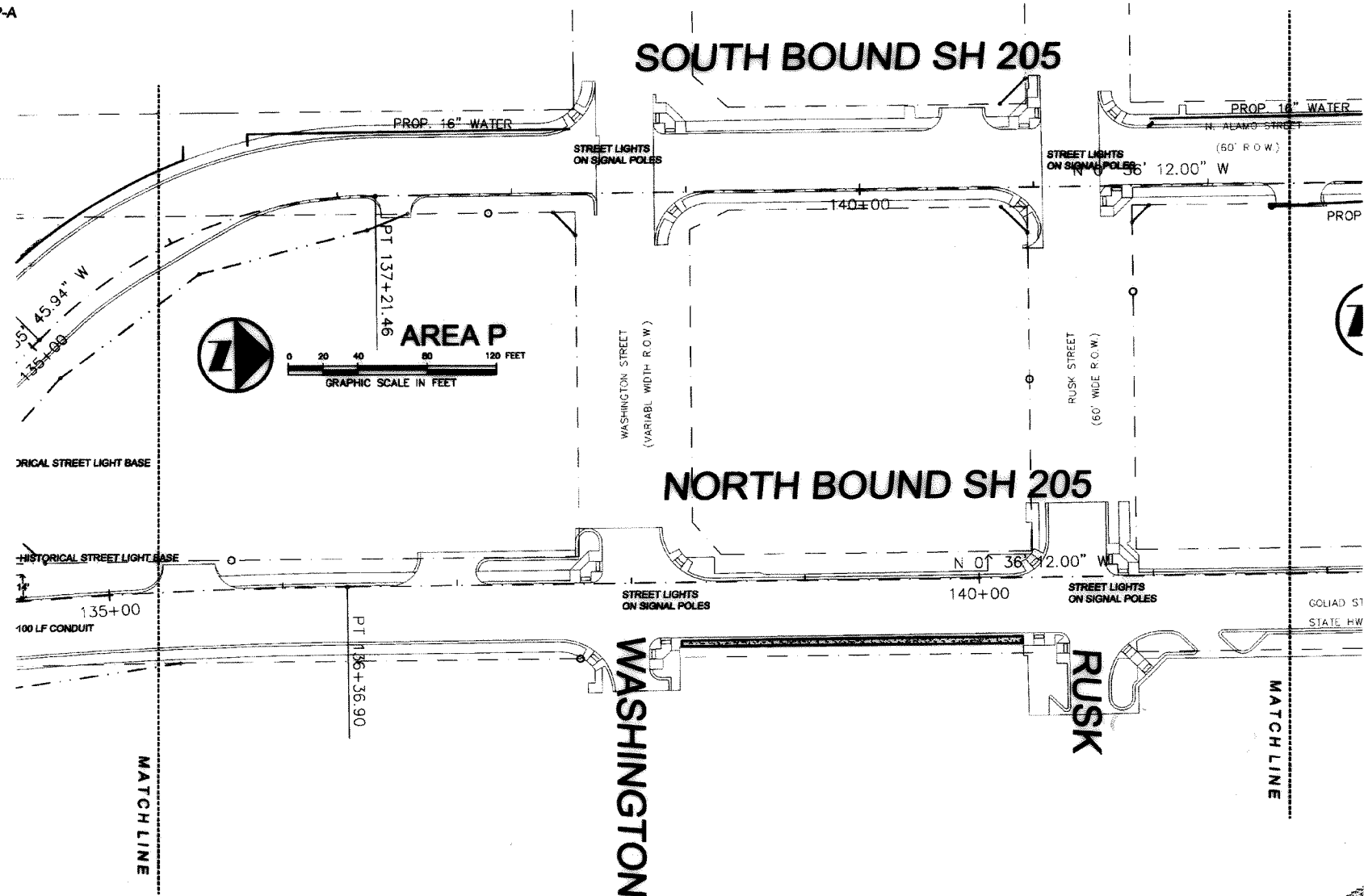

STREET LIGHTING PLANS

IRRIGATION DESIGNER
 JOHN WINGFIELD
 801 MORNINGSIDE TRAIL
 RICHARDSON, TEXAS 75081
 (972) 238-1498 PHONE
 (972) 238-1499 FAX

CIVIL ENGINEER
 CHUCK TODD
 ENGINEERING DEPARTMENT
 385 S. GOLIAD
 CITY OF ROCKWALL, TEXAS 75081
 (972) 771-7746 PHONE
 (972) 771-7748 FAX

STATE D.O.T.
 MR. PATRICK HAIGE
 LANDSCAPE ARCHITECT
 STATE DEPT. OF TRANSPORTATION
 1 P.O. BOX 3067
 DALLAS, TEXAS 75221
 (214) 320-6205 PHONE
 (214) 320-6615 FAX

CITY OF ROCKWALL
 MR. BRAD GRIGGS
 DIRECTOR OF PARKS AND RECREATION
 CITY OF ROCKWALL
 108 E. WASHINGTON STREET
 ROCKWALL, TEXAS 75087
 (972) 771-7761 PHONE
 (972) 771-7728 FAX

LANDSCAPE ARCHITECT
 T.H. PRITCHETT ASSOCIATES
 LANDSCAPE ARCHITECTURAL DESIGN
 3017 WESTMINSTER DRIVE
 FARMERS BRANCH, TEXAS 75234
 (972) 484-1230 FAX
 (972) 484-7373 PHONE

FED. RD. DIV. NO.	PROJECT NO.	SHEET NO.	
6	(See Title Sheet)	845	
STATE	STATE DIST. NO.	COUNTY	
TEXAS	18	ROCKWALL	
CONTROL	SECTION	JOB	HIGHWAY NO.
0451	01	032	SH 205

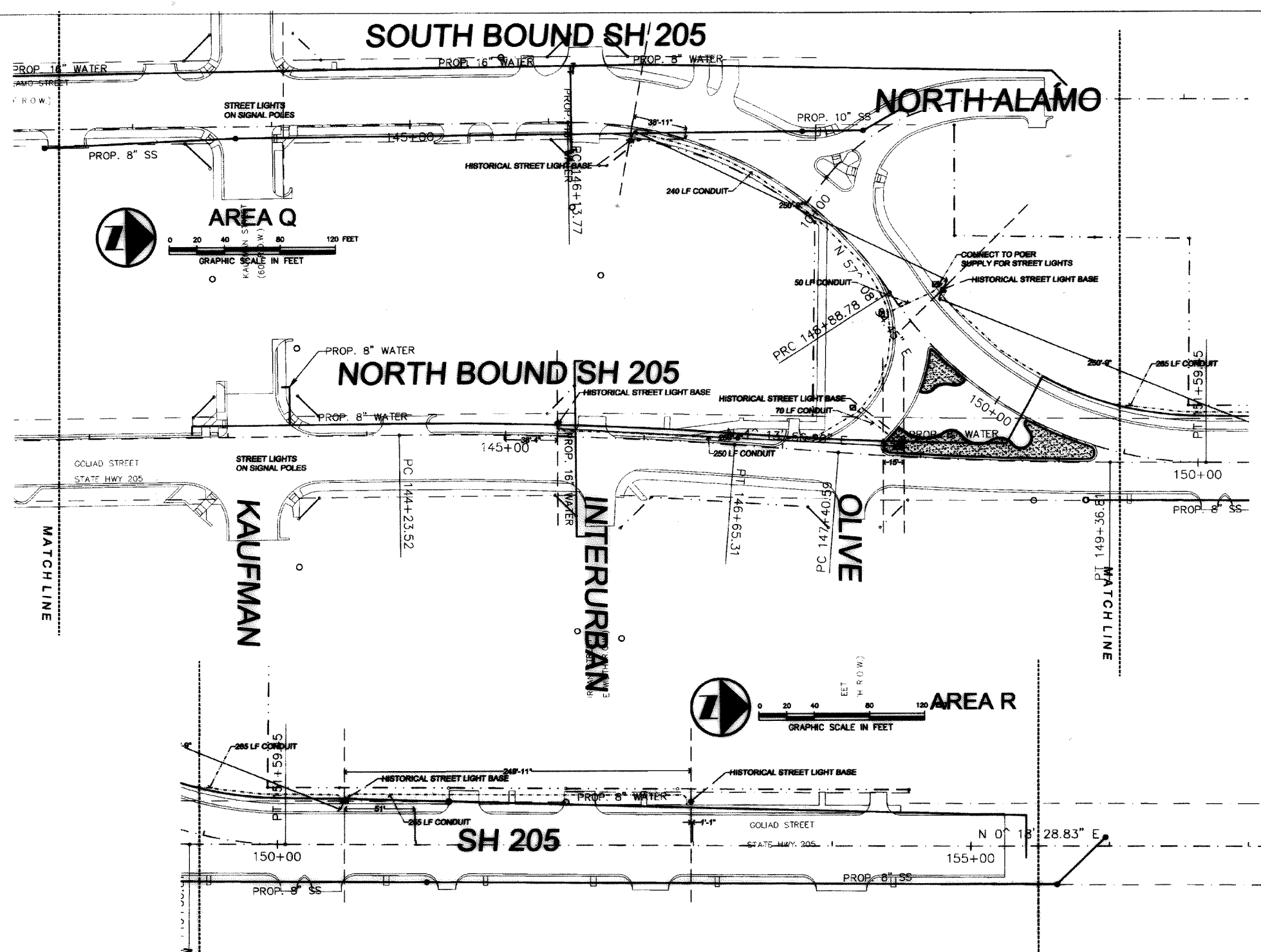

- ### STREET LIGHT LEGEND
- STREET LIGHT BASE, SEE DETAIL SLP-A
 - HISTORICAL STREET LIGHT BASE, SEE DETAIL SLP-A
 - GROUND BOX TYPE "A"
 - STREET LIGHT SCH 40 CONDUIT MIN. 2" 4" FROM POWER SUPPLY TO MEDIAN PER NATIONAL ELEC CODE.

LOCATION OF CONDUIT IS DIAGRAMATIC FOR CLARITY, LOCATE IN MEDIAN AND INSTALL GROUND BOX TYPE "A" AT ENDS OF MEDIANS AND CONNECTIONS TO PARKWAY POWER SUPPLY.

ANY FUTURE INSTALLATION FOR ILLUMINATION SYSTEMS WILL BE DONE TO THE NATIONAL ELECTRICAL CODE AND TxDOT RESERVES THE RIGHT TO REVIEW AND INSPECT THESE INSTALLATIONS.



STREET LIGHTING PLANS

IRRIGATION DESIGNER
 JOHN WINGFIELD
 801 MORNINGSIDE TRAIL
 RICHARDSON, TEXAS 75081
 (972) 238-1498 PHONE
 (972) 238-1499 FAX

CIVIL ENGINEER
 CHUCK TODD
 ENGINEERING DEPARTMENT
 385 S. GOLIAD
 CITY OF ROCKWALL, TEXAS 75081
 (972) 771-7746 PHONE
 (972) 771-7748 FAX

STATE D.O.T.
 MR. PATRICK HAIGE
 LANDSCAPE ARCHITECT
 STATE DEPT. OF TRANSPORTATION
 P.O. BOX 3067
 DALLAS, TEXAS 75221
 (214) 320-6205 PHONE
 (214) 320-6615 FAX

CITY OF ROCKWALL
 MR. BRAD GRIGGS
 DIRECTOR OF PARKS AND RECREATION
 CITY OF ROCKWALL
 108 E. WASHINGTON STREET
 ROCKWALL, TEXAS 75087
 (972) 771-7761 PHONE
 (972) 771-7728 FAX

LANDSCAPE ARCHITECT
 T.H. PRITCHETT ASSOCIATES
 LANDSCAPE ARCHITECTURAL DESIGN
 3017 WESTMINSTER DRIVE
 FARMERS BRANCH, TEXAS 75234
 (972) 484-1230 FAX
 (972) 484-7373 PHONE

FED. RD. DIV. NO.	PROJECT NO.	SHEET NO.	
6	(See Title Sheet)	846	
STATE	STATE DIST. NO.	COUNTY	
TEXAS	18	ROCKWALL	
CONTROL	SECTION	JOB	HIGHWAY NO.
0451	01	032	SH 205

NO LIGHT POLES OR LIGHTS OR WIRING ARE TO BE PROVIDED AS PART OF THESE PLANS FOR COORDINATION INFORMATION ONLY.

ARCHITECTURAL AREA LIGHTING (AAL) PROMENADE SERIES

FIXTURE:
2-PRMS DOUBLE PEDESTRIAN LIGHT STANDARD WITH H3 OR H5 HORIZONTAL LAMP REFLECTOR, 150 WATT TO 175 WATT METAL HALIDE LAMP, MEDIUM BASE SOCKET FOR USE WITH E-17 LAMPS; (VOLTAGE); CHM GLASS CHIMNEY WITH BRASS HOLDER, AND DBZ DARK BRONZE COLOR.

ARM:
#2-TRASU PERIOD ARM, ONE PIECE CAST ALUMINUM, AND DBZ DARK BRONZE COLOR.

POLE, BASE, AND POLE CAP: DB9 4R-125, 4" OD ROUND STRAIGHT ALUMINUM, 15' TALL (SPECIAL) WITH DB9 BASE, 36" HT X 15" BASE DIAMETER, PIN A50596-1, SMALL CAST FINIAL AT TOP, DBZ DARK BRONZE COLOR.

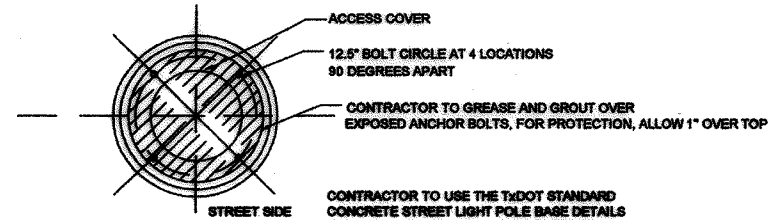

1 ARCHITECTURAL AREA LIGHTING BOLT PATTERN LAYOUT
NOT TO SCALE

CONTRACTOR TO USE THIS TEMPLATE FOR BIDDING PURPOSES. PRIOR TO CONSTRUCTION OF THE CONCRETE BASES. CONTRACTOR TO VERIFY WITH CITY OF ROCKWALL ENGINEERING DEPARTMENT, CHUCK TODD AND MANUFACTURER FOR THE MEASUREMENTS OF THE TEMPLATE REQUIRED FOR THE POLE CONNECTION REQUIRED BY THE SELECTED MANUFACTURER. THE CONTRACTOR TO COORDINATE J ANCHOR LOCATION, DEPTH AND MANUFACTURER SPECIFICATIONS ON SIZE AND LENGTH.

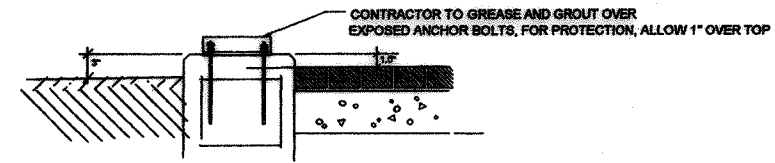

SECTION GROUT CAP

NO LIGHT POLES OR LIGHTS OR WIRING ARE TO BE PROVIDED AS PART OF THESE PLANS FOR COORDINATION INFORMATION ONLY.

LIGHT MANUFACTURER TO BE SELECTED:SERIES

FIXTURE:

ARM:

POLE, BASE, AND POLE CAP:DARK BRONZE COLOR.

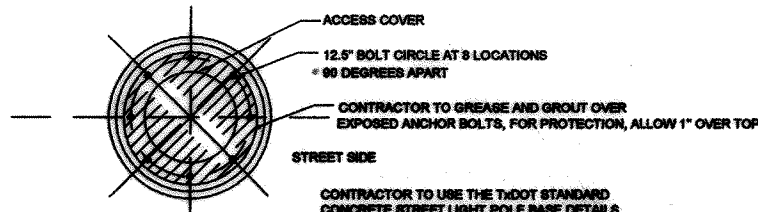

2 STREET LIGHTING BOLT PATTERN LAYOUT
NOT TO SCALE

CONTRACTOR TO USE THIS TEMPLATE FOR BIDDING PURPOSES. PRIOR TO CONSTRUCTION OF THE CONCRETE BASES. CONTRACTOR TO VERIFY WITH CITY OF ROCKWALL ENGINEERING DEPARTMENT, CHUCK TODD AND MANUFACTURER FOR THE MEASUREMENTS OF THE TEMPLATE REQUIRED FOR THE POLE CONNECTION REQUIRED BY THE SELECTED MANUFACTURER. THE CONTRACTOR TO COORDINATE J ANCHOR LOCATION, DEPTH AND MANUFACTURER SPECIFICATIONS ON SIZE AND LENGTH.

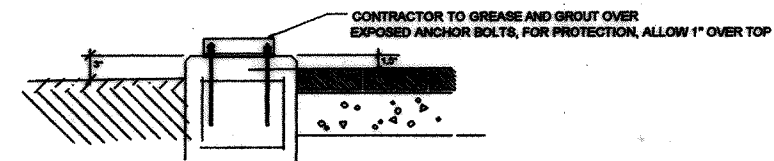

SECTION GROUT CAP

56 Change Order



THE SEAL APPEARING ON THIS DOCUMENT WAS AUTHORIZED BY T. H. PRITCHETT, R.L.A. NO. 2115 ON 03/24/2006

STREET LIGHTING DETAILS

IRRIGATION DESIGNER
JOHN WINGFIELD
801 MORNINGSIDE TRAIL
RICHARDSON, TEXAS 75081
(972) 238-1498 PHONE
(972) 238-1499 FAX

CIVIL ENGINEER
CHUCK TODD
ENGINEERING DEPARTMENT
385 S. GOLIAD
CITY OF ROCKWALL, TEXAS 75081
(972) 771-7746 PHONE
(972) 771-7748 FAX

STATE D O T
MR. PATRICK HAIGE
LANDSCAPE ARCHITECT
STATE DEPT. OF TRANSPORTATION
1P.O.BOX 3067
DALLAS, TEXAS 75221
(214) 320-6205 PHONE
(214) 320-6615 FAX

CITY OF ROCKWALL
MR. BRAD GRIGGS
DIRECTOR OF PARKS AND RECREATION
CITY OF ROCKWALL
108 E. WASHINGTON STREET
ROCKWALL, TEXAS 75087
(972) 771-7761 PHONE
(972) 771-7728 FAX

LANDSCAPE ARCHITECT
T.H. PRITCHETT ASSOCIATES
LANDSCAPE ARCHITECTURAL DESIGN
3017 WESTMINSTER DRIVE
FARMERS BRANCH, TEXAS 75234
(972) 484-1230 FAX
(972) 484-7373 PHONE

FED. RD. DIV. NO.	PROJECT NO.:		SHEET NO.
6	(See Title Sheet)		848
STATE	STATE DIST. NO.	COUNTY	
TEXAS	18	ROCKWALL	
CONTROL	SECTION	JOB	HIGHWAY NO.
0451	01	032	SH 205

DISCLAIMER: The use of this standard is governed by the "Texas Engineering Practice Act". No warranty of any kind is made by TxDOT for any purpose whatsoever. TxDOT assumes no responsibility for the design, construction or performance of any project or for incorrect information or for incorrect resulting from its use.

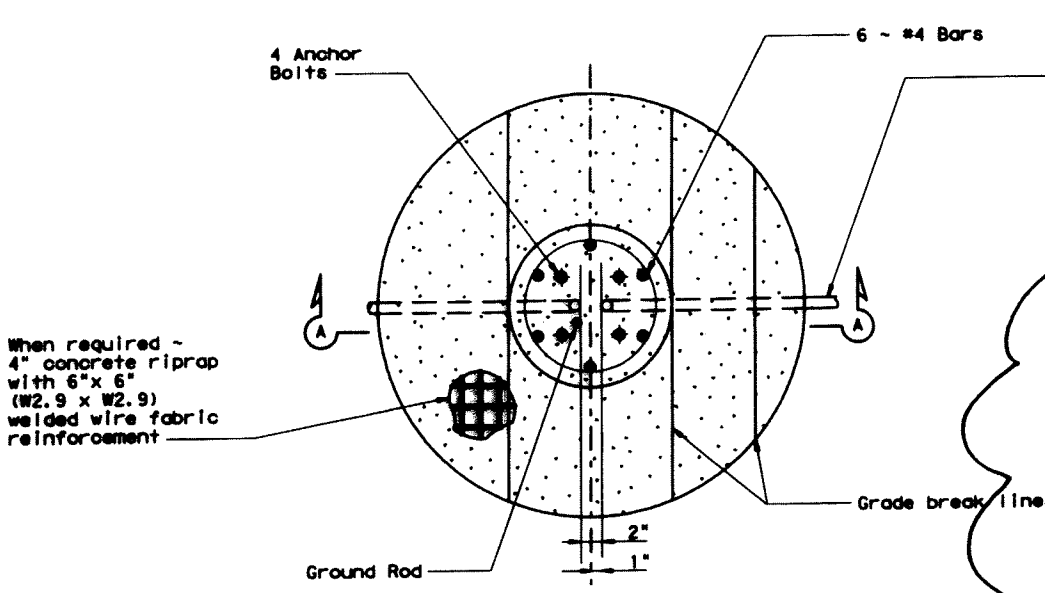

FOUNDATION DETAIL

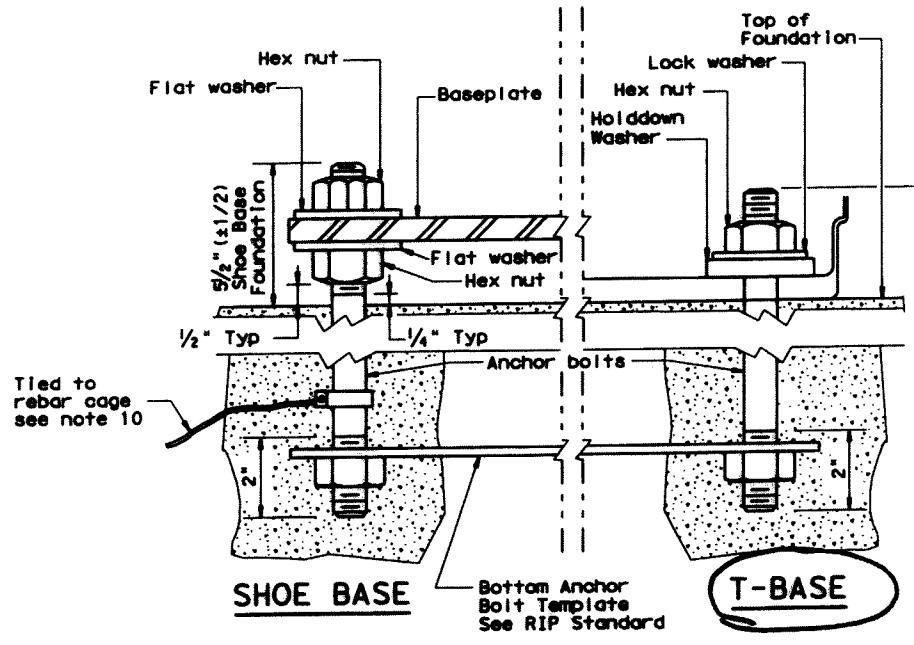

ANCHOR BOLT DETAIL

Conduit (See lighting layout for conduit size. Match duct cable size if used. See ED standard sheets.)

FOR BREAKAWAY BASE:

- Change length and have 4" bend
- Use bolt pattern supplied by manufacturer.

KATHLEEN R. LAPPEN
94603
LICENSED PROFESSIONAL ENGINEER
Kathleen R.
11-09-09

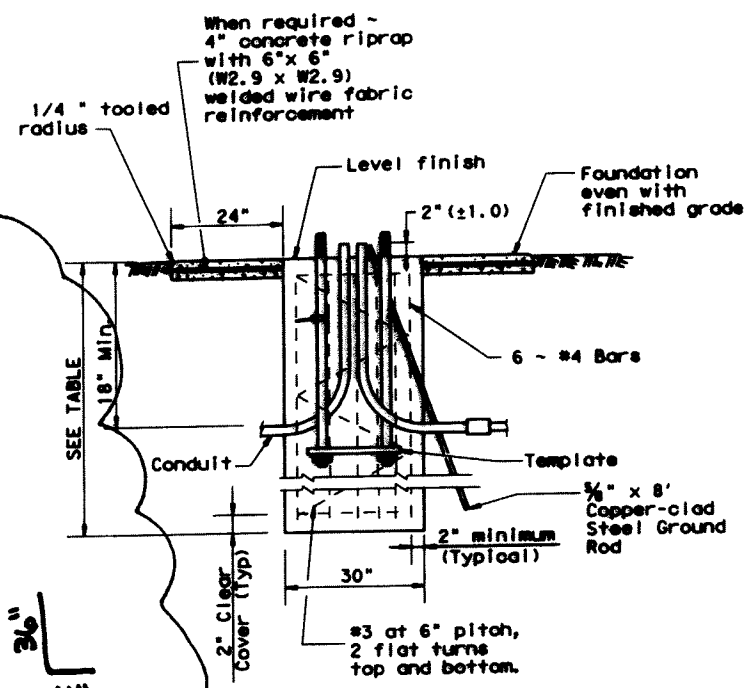

SECTION A-A
SHOWING CONSTANT GRADE

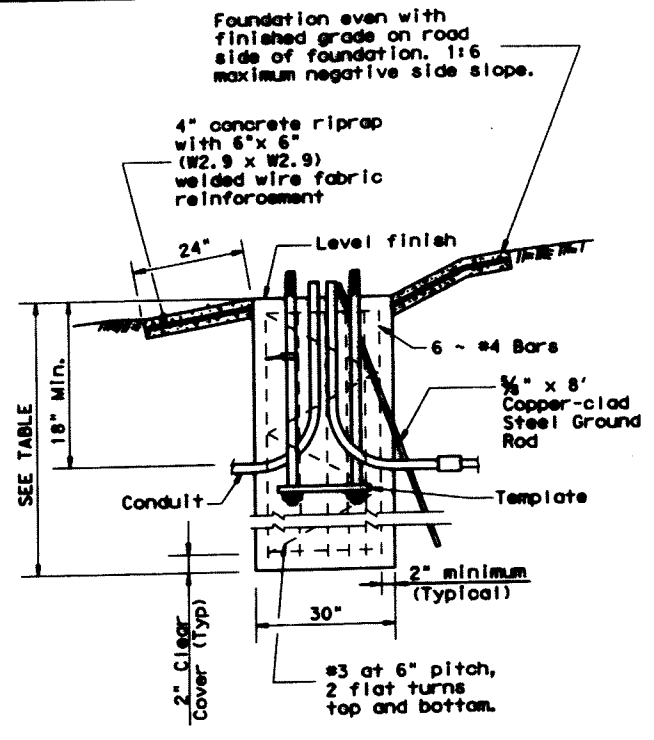

SECTION A-A
SHOWING SLOPED GRADE

PAY QUANTITY OF RIPRAP PER FOUNDATION (Install only when shown on the plans)

Foundation Diameter	RIPRAP DIAMETER	RIPRAP (CONC) (CL B)
30 in.	78 in.	0.35 CY

RECOMMENDED FOUNDATION LENGTHS (See note 1)

MOUNTING HEIGHT	TEXAS CONE PENETROMETER N Blows/ft		
	10	15	40
≤20 ft.	6'	6'	6'
>20 ft. to 30 ft.	8'	6'	6'
>30 ft. to 40 ft.	8'	8'	6'
>40 ft. to 50 ft.	10'	8'	6'

ANCHOR BOLTS

POLE MOUNTING HEIGHT	BOLT CIRCLE		ANCHOR BOLT SIZE
	Shoe Base	T-Base	
<40 ft.	13 in.	14 in.	1 in. x 30 in.
40-50 ft.	15 in.	17 1/4 in.	1 1/4 in. x 30 in.

1 in. x 3 1/2 in. x 4 in.

BREAKAWAY POLE PLACEMENT (See note 6)

Roadway Functional Classification	** Pole offset (distance to transformer base, tolerance + 6 in. - 0 in.)
Freeway Mainlanes (roadway with full control of access)	15 ft. (minimum and typical) from lane edge
All curbed, 45 mph or less design speed	2.5 ft. minimum (15 ft. desirable) from curb face
All others	10 ft. minimum (15 ft. desirable) from lane edge

* or as close to ROW line as is practical
 ** provide 2/5 of the luminaire mounting height behind the pole for "falling area" to prevent encroachment on the other travel lanes. See design guidelines.

- "Recommended Foundation Lengths" table is for information purposes only. Foundation lengths shall be as shown on the plans, or as directed by the Engineer. Foundations will be paid for under Item 416, "Drilled Shaft Foundations," unless otherwise shown on the plans.
- Erect roadway illumination assembly poles plumb and true. Form and level the top 6" of the foundation so the pole will be plumb. Use leveling nuts to plumb shoe base poles. Do not use shims or leveling nuts under transformer bases. Do not grout between baseplate and the foundation.
- Ensure Class 2A and 2B fit for anchor bolts and nuts. Tap and chase nuts after galvanizing. Anchor bolt body with rolled threads need not be full size.
- Use appropriate class of concrete as specified in Items 416 and 432.
- Place riprap around the foundation when called for elsewhere in the plans. Riprap will be paid for under Item 432.
- Locate breakaway roadway illumination assemblies as shown in the placement table, unless otherwise dimensioned on the plans. Protect non-breakaway illumination assemblies from vehicular impact (i.e. 2 ft. behind guard rail or mounted on traffic barrier), or located outside the clear zone, except that 2.5 ft. from curb face is minimum desired for light poles on city streets, 45 mph or less, see design guidelines for further information.
- Use 8 hold down washers on transformer base poles as recommended by the manufacturer and supplied with base.
- Install a minimum of 2 conduits in each foundation. See lighting layout sheets for locations of foundations with more than 2 conduits. Cap unused conduits in foundations on both ends.
- Conduit location in foundations is critical for breakaway devices. Place conduits 2 in. apart on centerline as shown.
- Band anchor bolt to rebar cage with #6 bare stranded copper conductor. Use listed mechanical connectors rated for embedment in concrete.
- Use rip rap on T-base foundations that are located on a sloped grades.

Texas Department of Transportation
Traffic Operations Division
ROADWAY ILLUMINATION DETAILS
(RDWY ILLUM FOUNDATIONS)
RID(FND)-07

© TxDOT January 2007

REVISIONS	DATE	SECTION	BY	CHKD	APP'D

SHEET NO. 72C