

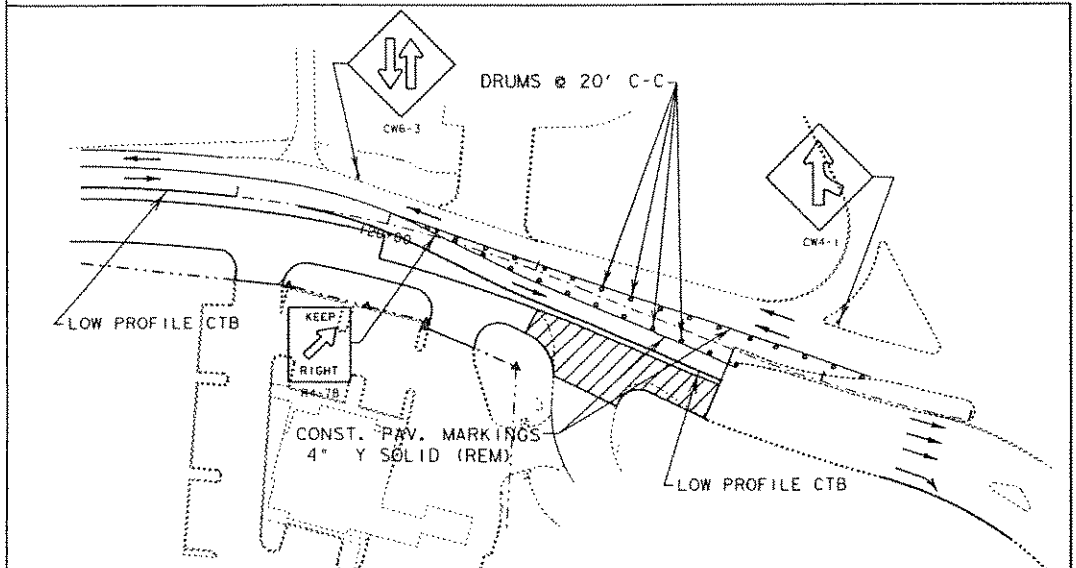

MATCH LINE STA 114+00

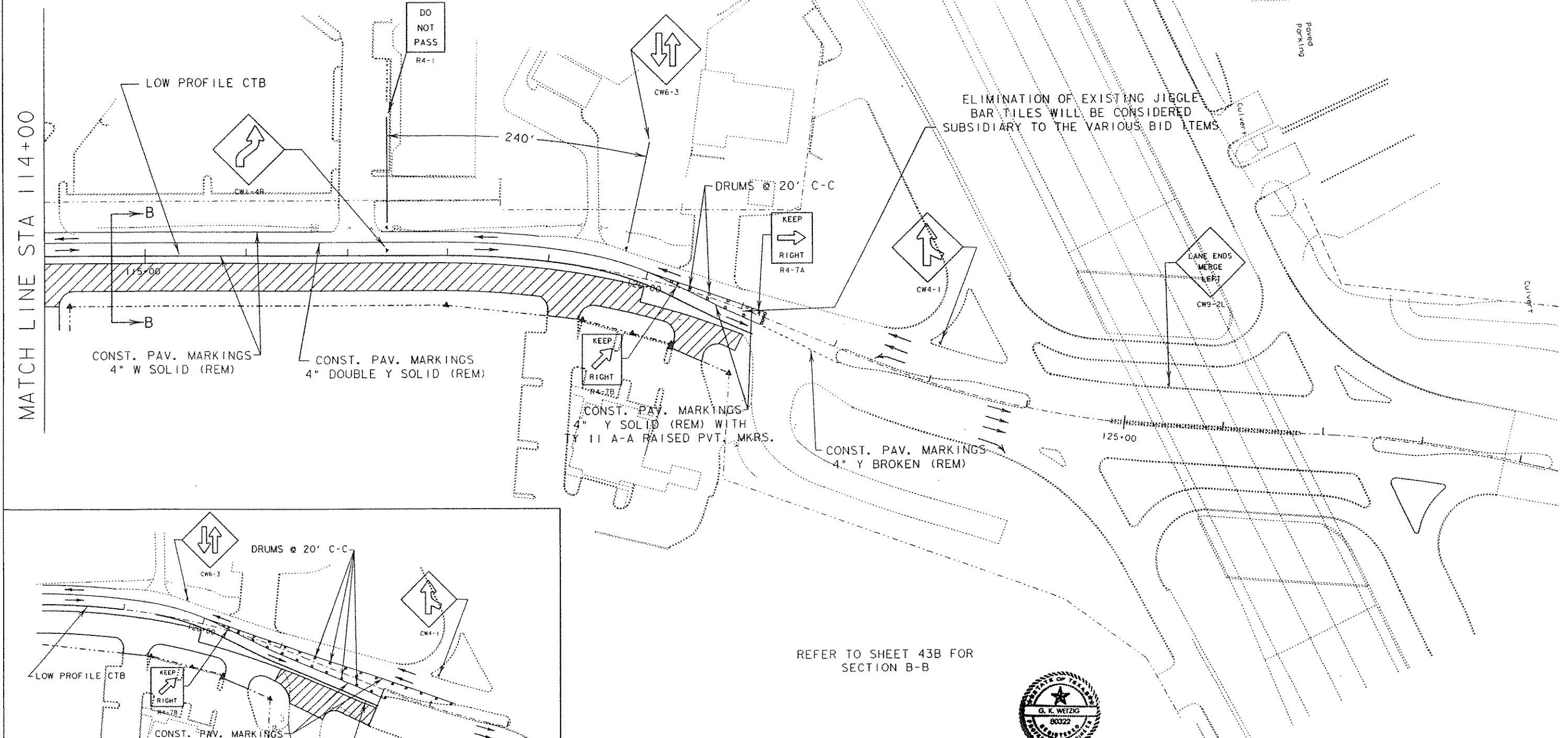

UPON COMPLETION OF DRIVEWAY AT STA 119+20, OPEN MEDIAN BARRIER AT THAT LOCATION TO FACILITATE THE COMPLETION OF THE CONCRETE PAVEMENT CONSTRUCTION

REFER TO SHEET 43B FOR SECTION B-B

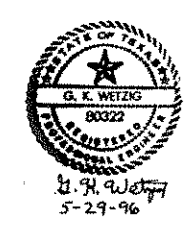

LEGEND

-- CONCRETE PAVEMENT CONSTRUCTION

TRAFFIC CONTROL PLAN  
PHASE II A

SHEET 5 OF 15

FED. RD. DIV. NO.	FEDERAL AID PROJECT NO.	SHEET NO.
6	STP 96 (830)MM	36
STATE	STATE DIST. NO.	COUNTY
TEXAS	DALLAS	ROCKWALL
CONT.	SECT.	JOB HIGHWAY NO.
1014	03	041 FM 740

\$\$\$\$date\$\$\$\$

EXT 4407