

Aug 11, 2009 - 4:11pm User: HP_Administrator
 C:\ROCK\SD\UTLEY\2009 ADDITIONS\2008 WILKERSON-SANDERS-REV11 TENNIS.dwg

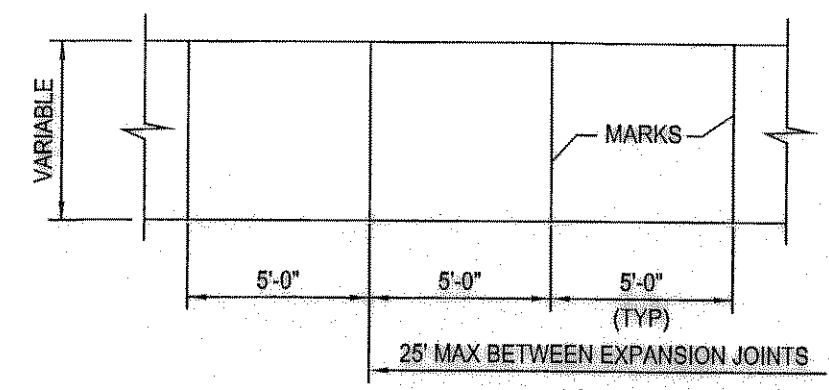

- NOTES:
- AT MARKINGS THE CONCRETE SHALL BE A TOOLED JOINT 3/4" DEEP, FOLLOWED BY GROOVING TOOL. STRENGTH SHALL BE 3000 p.s.i. WITH #3 BARS @ 24" O.C.
 - SIDEWALKS ADJACENT TO BUILDING TO BE PLACED ON LIME TREATED SUBGRADE THE SAME AS PAVING ALL OTHER SIDEWALKS TO BE PLACED OVER 2" COMPACTED SAND, (P1 < 15)

SIDEWALK PLAN
NTS

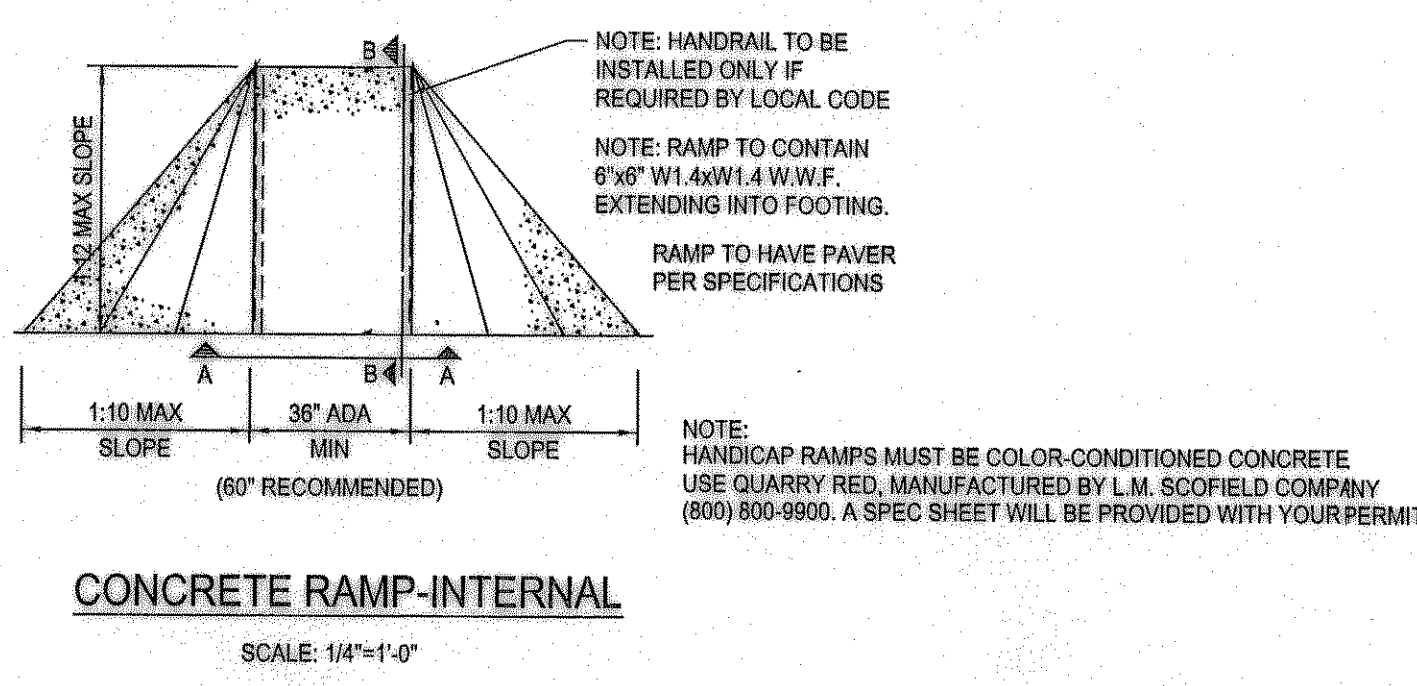
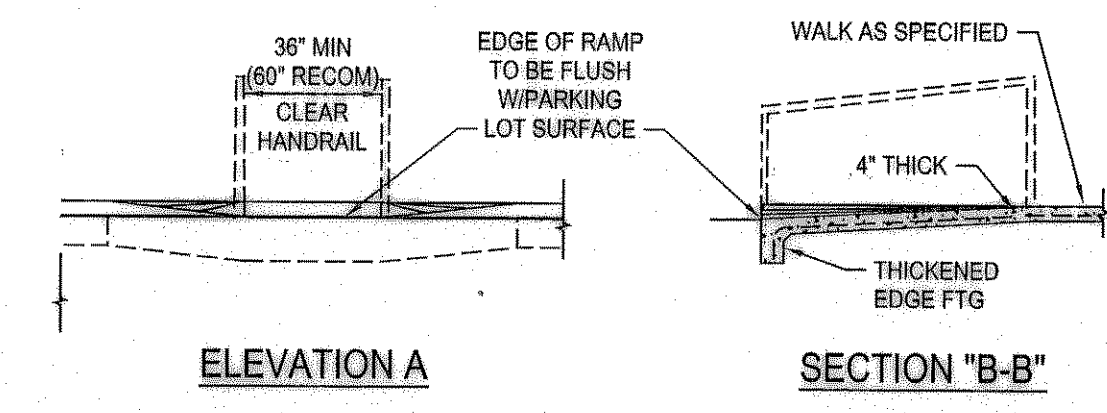

CONCRETE RAMP-INTERNAL
SCALE: 1/4"=1'-0"

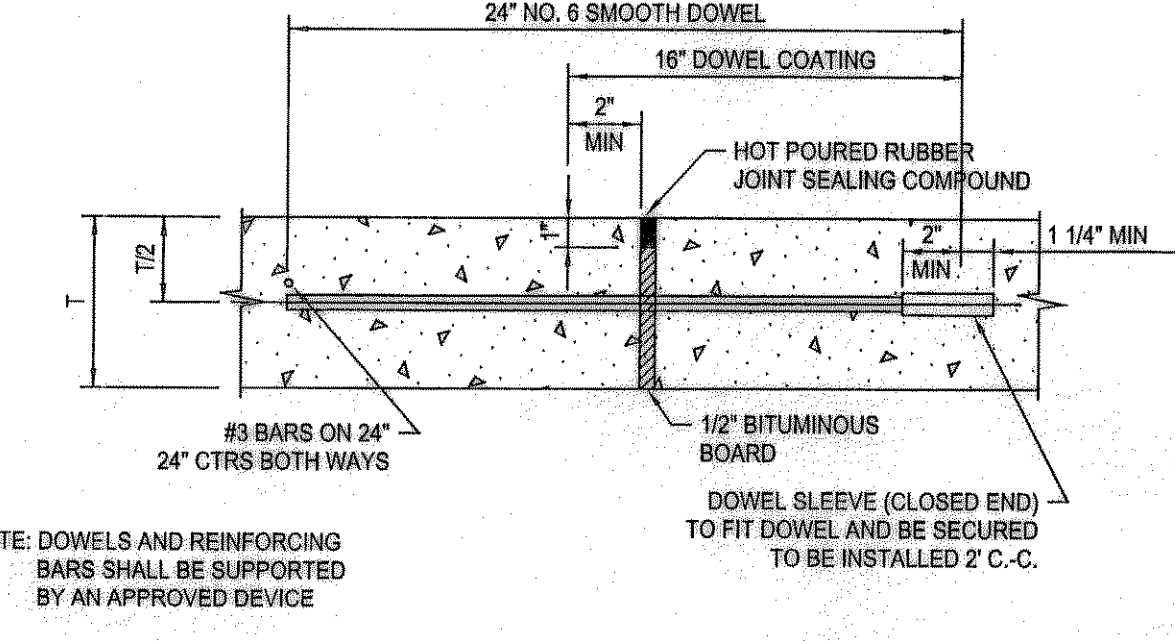

NOTE: DOWELS AND REINFORCING BARS SHALL BE SUPPORTED BY AN APPROVED DEVICE

EXPANSION JOINT DETAIL
NTS MAXIMUM SPACING = 150 FEET

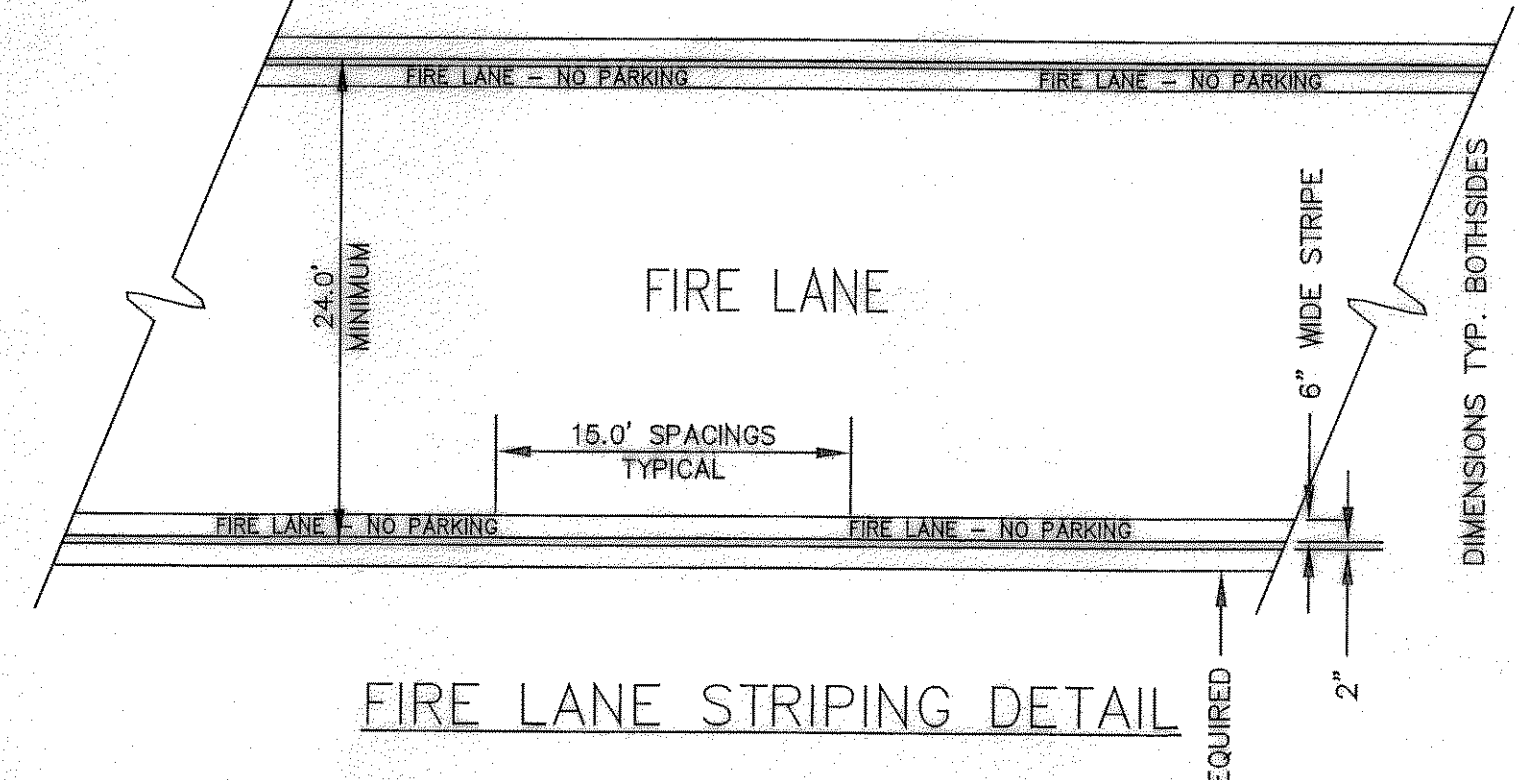

FIRE LANE STRIPING DETAIL

STRIPING DETAILS AND SPECIFICATIONS

- A. PAINT:
- STRIPE SHALL BE SIX(6) INCHES WIDE PAINTED WITH AN EXTERIOR ACRYLIC LATEX PAINT. COLOR SHALL BE "TRAFFIC RED" GILDDEN NO. 63251 OR EQUAL.
 - LETTERS SHALL BE FOUR(4) INCHES HIGH PAINTED WITH AN EXTERIOR ACRYLIC PAINT. COLOR SHALL BE "TRAFFIC WHITE" GILDDEN NO. 563245 OR EQUAL.
- B. APPLICATION:
- STRIPE MAY BE BRUSHED OR SPRAYED, ONE COAT TO FINISH.
 - LETTERS SHALL BE STENCIL FORMED, BRUSH APPLIED AND SPACED AS DETAILED ON THIS SHEET.

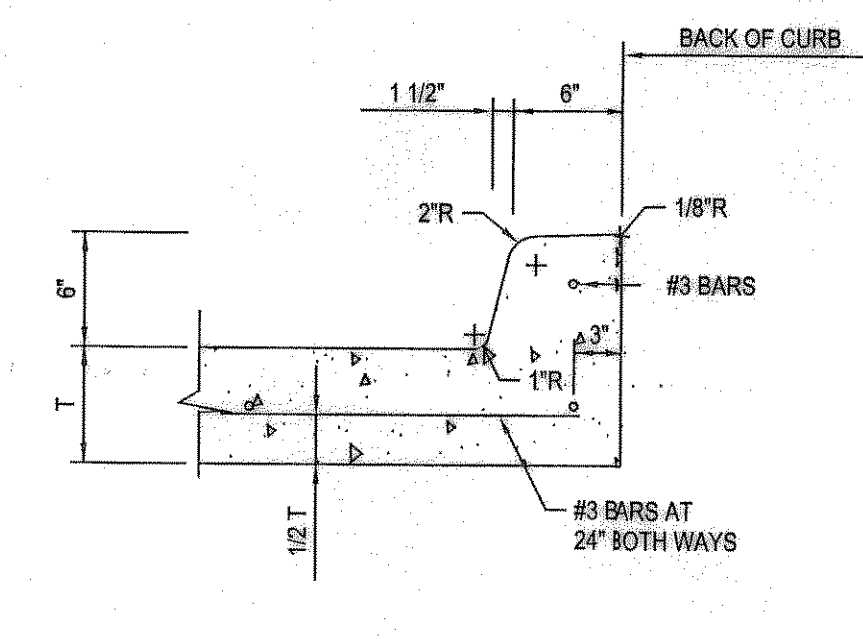

INTEGRAL CURB & GUTTER
NTS

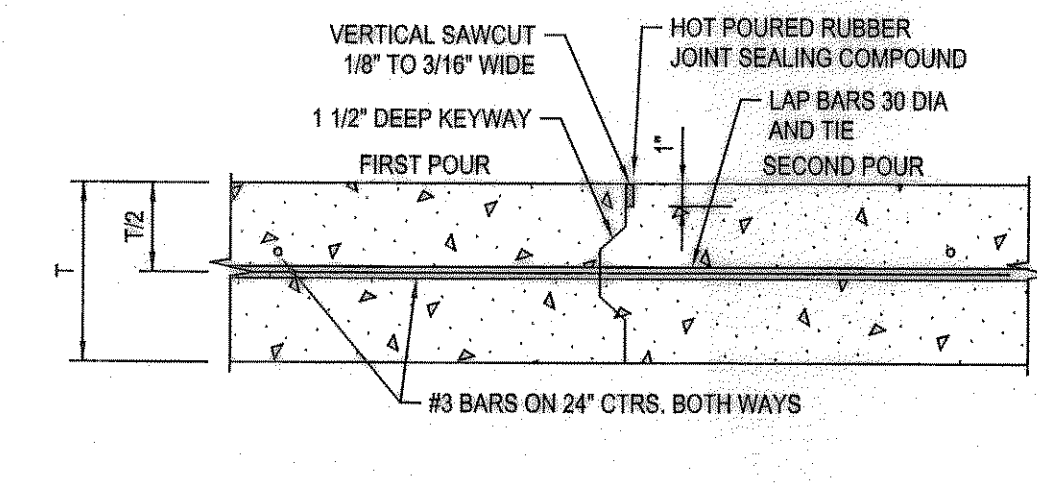

CONSTRUCTION JOINT DETAIL (L)
NTS

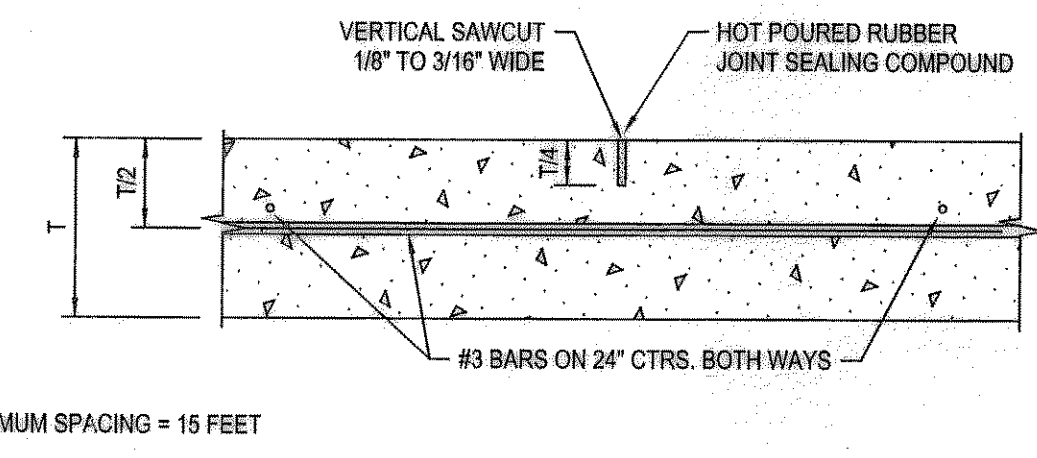

SAWED DUMMY JOINT DETAIL (T)
NTS MAXIMUM SPACING = 15 FEET

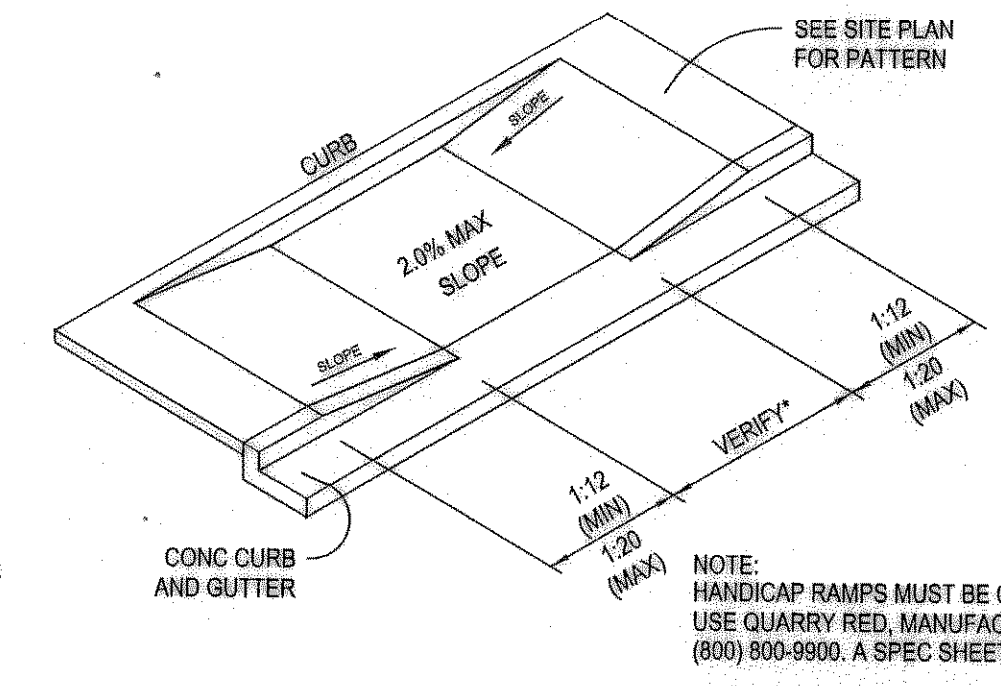

HANDICAP RAMP DETAIL
NTS

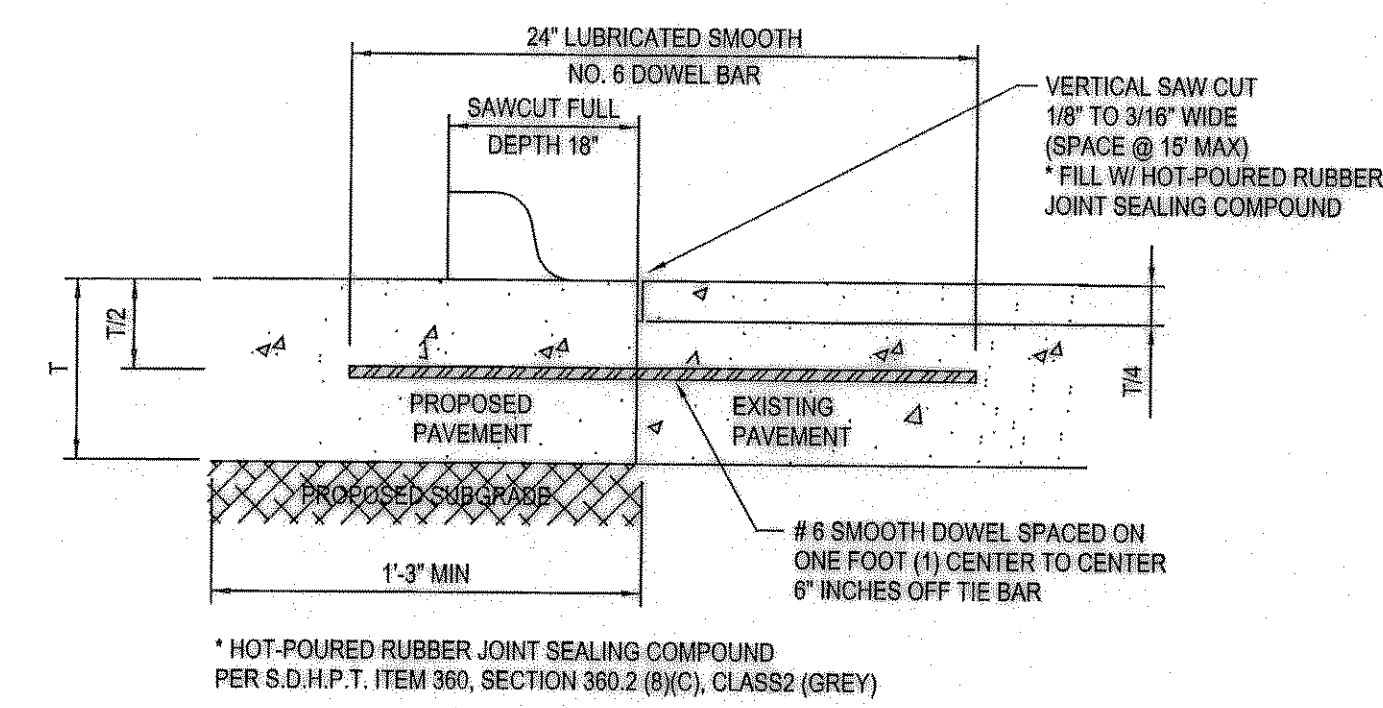

TO BE USED WHERE PROPOSED CONCRETE PAVEMENT MEETS EXISTING CONCRETE PAVEMENT

- NOTES:
- NO. 5 SMOOTH DOWEL BAR MAY BE USED IN 5', 6' AND 7' PAVEMENT THICKNESS.
 - LONGITUDINAL BUTT CONSTRUCTION MAY BE UTILIZED IN PLACE OF LONGITUDINAL HINGED (KEYWAY) JOINT AT CONTRACTOR'S OPTION.
 - DOWEL BARS SHALL BE DRILLED INTO PAVEMENT HORIZONTALLY BY USE OF A MECHANICAL RIG. DRILLING BY HAND IS NOT APPLICABLE. PUSHING DOWEL BARS INTO GREEN CONCRETE IS NOT ACCEPTABLE.

LONGITUDINAL BUTT DETAIL
NTS

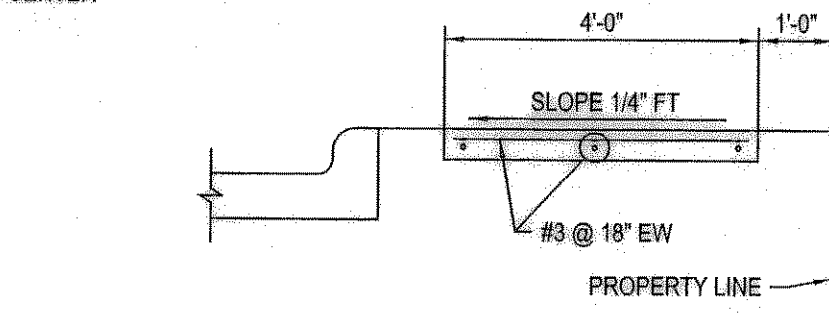

WALK/BUILDING/CURB INTERFACE
NTS

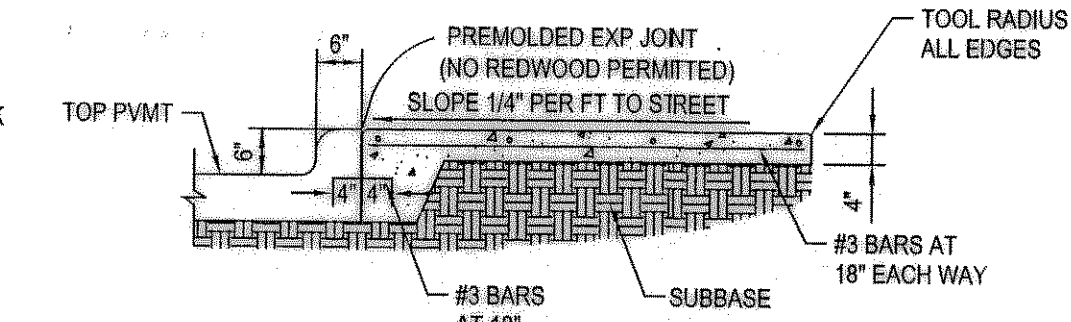

INTERIOR SIDEWALK TYPICAL SECTION
NTS

NOTE: NO SAND WILL BE PERMITTED UNDER PAVEMENT.

RECORD DRAWING

This is to certify that changes and corrections have been made to conform to the contractor's record of this project.

Signed: *[Signature]* Date: *5/26/10*
 Glenn Engineering Corporation



5717 Legacy Drive
Suite 250
Plano, TX 75024
P 214.473.2400
F 214.473.2731

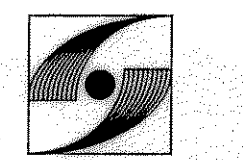

GLENN ENGINEERING
T.B.P.E. FIRM REGISTRATION NO. F - 303
PHONE 972-717-5151 FAX 972-717-2178
105 DECKER COURT-SUITE 910 IRVING, TEXAS 75062

Final Plans for Bidding and Construction

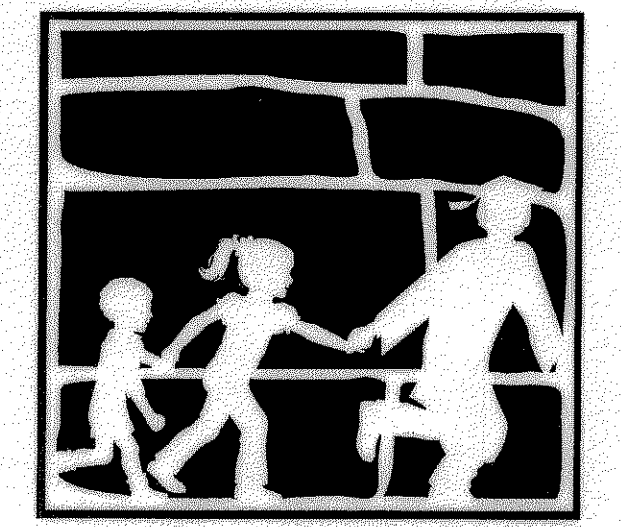
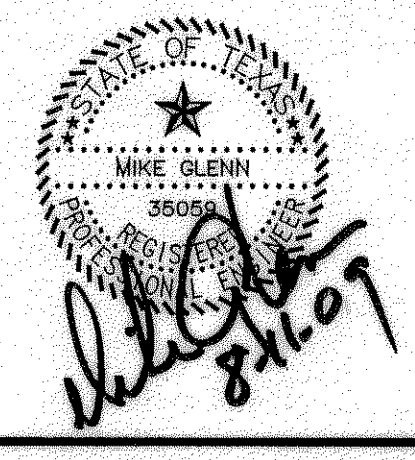

Rockwall
INDEPENDENT SCHOOL DISTRICT
TENNIS COMPLEX AT
WILKERSON SANDERS
STADIUM
ROCKWALL, TEXAS

CHECKED:
File:
© 2009 SHW Group LLP
ISSUE: 07/30/2009

Revisions:

1	08/06/09	CITY REVISIONS
2	08/11/09	CITY REVISIONS

Sheet Title:
PAVING DETAILS

CP 1.02