

Copyright Reserved

The Contractor shall verify and be responsible for all dimensions. DO NOT scale the drawing - any errors or omissions shall be reported to Stantec without delay.  
The Copyrights to all designs and drawings are the property of Stantec. Reproduction or use for any purpose other than that authorized by Stantec is forbidden.

Consultants

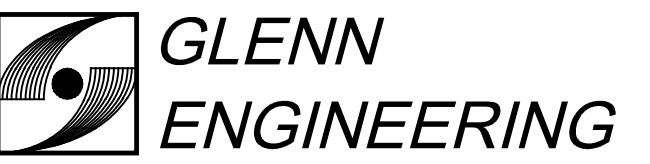

T.B.P.E. FIRM REGISTRATION NO. F - 303

PHONE 972-717-5151 FAX 972-717-2176  
4500 FULLER DRIVE - SUITE 220 IRVING, TEXAS 75038

Notes

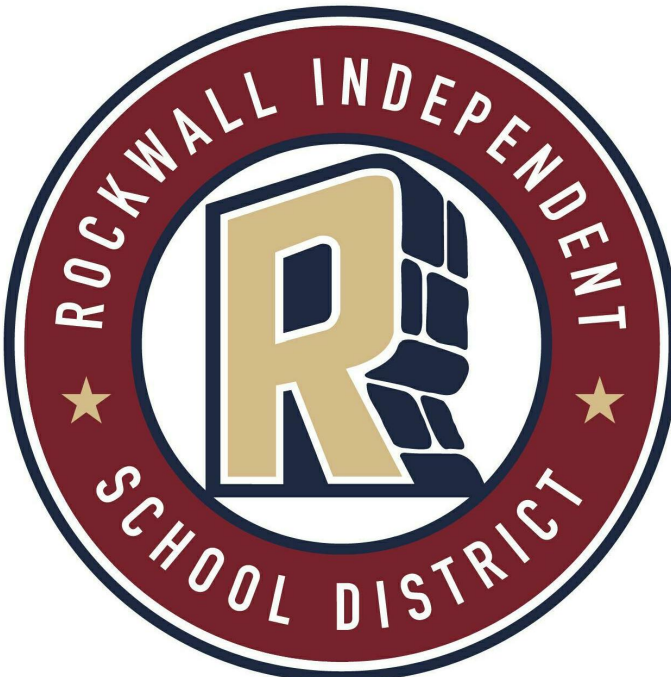

8 - RH #40	RAH	CMG	2020.05.13
7 - RH #79 - FC 20 - REV	RAH	CMG	2020.03.13
6 - RH #116 AND #117	RAH	CMG	2020.01.13
5 - RH #20 AND #21	RAH	CMG	2019.07.23
4 - RH #16	RAH	CMG	2019.07.12
3 - CITY COMMENTS	RAH	CMG	2019.04.30
2 - ASI #1 -CITY COMMENTS	RAH	CMG	2019.04.02

100%CD - For Bidding and Construction	RAH	CMG	2019.03.01
Issued	By	Appd	YYYY.MM.DD

Permit-Seal



The seal appearing on this document was authorized by Mike Glenn, P.E. 35059, on May 13, 2020.

Client/Project  
Rockwall ISD

Elementary School #15

2911 Greenway Drive  
Rockwall, TX 75087

Title  
**STORM SEWER PROFILES**

Project No. 214000654 Scale AS SHOWN

Revision Drawing No.



C  
05.06

LAT. 'A2' (PRIVATE)

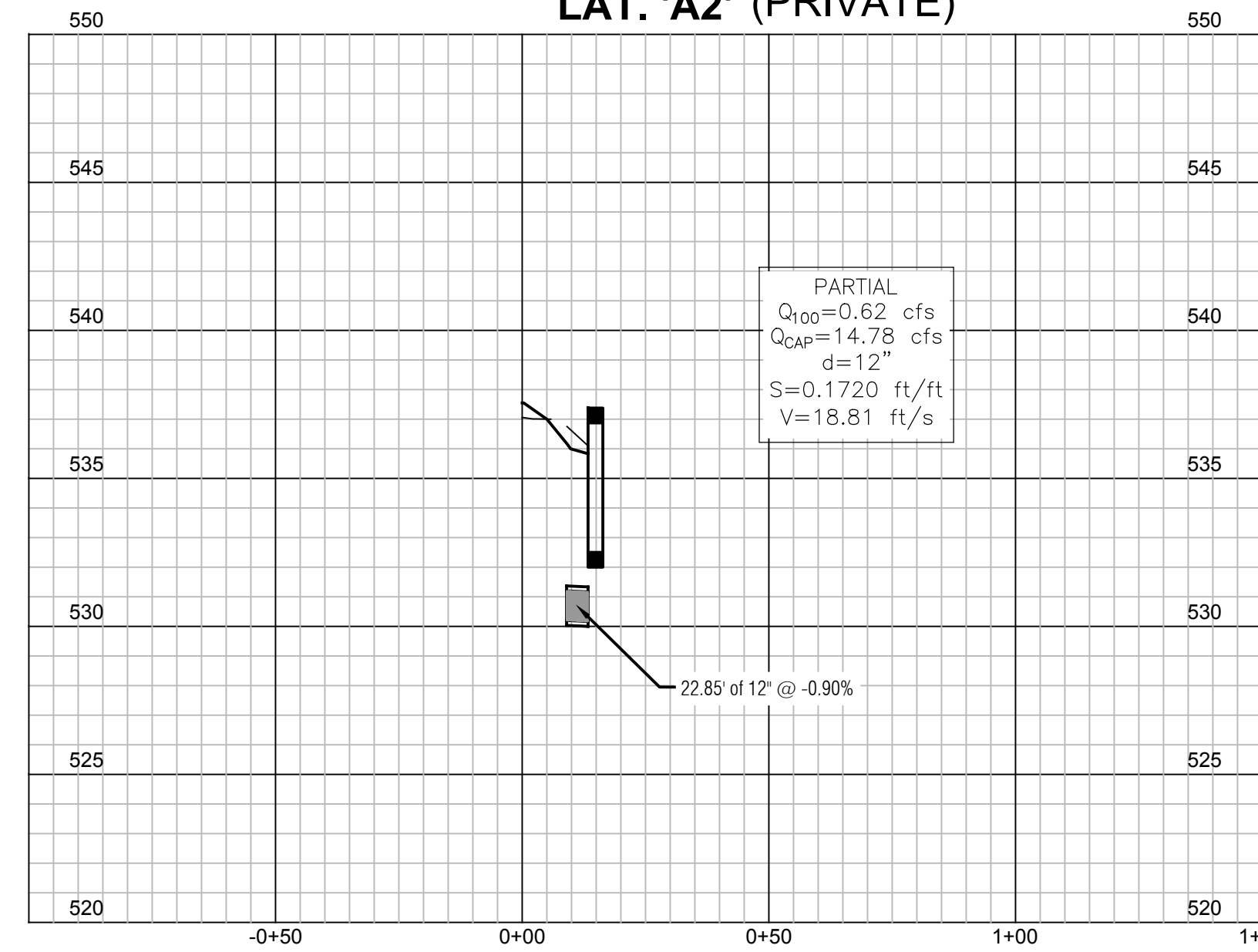

LAT. 'C3' (PRIVATE)

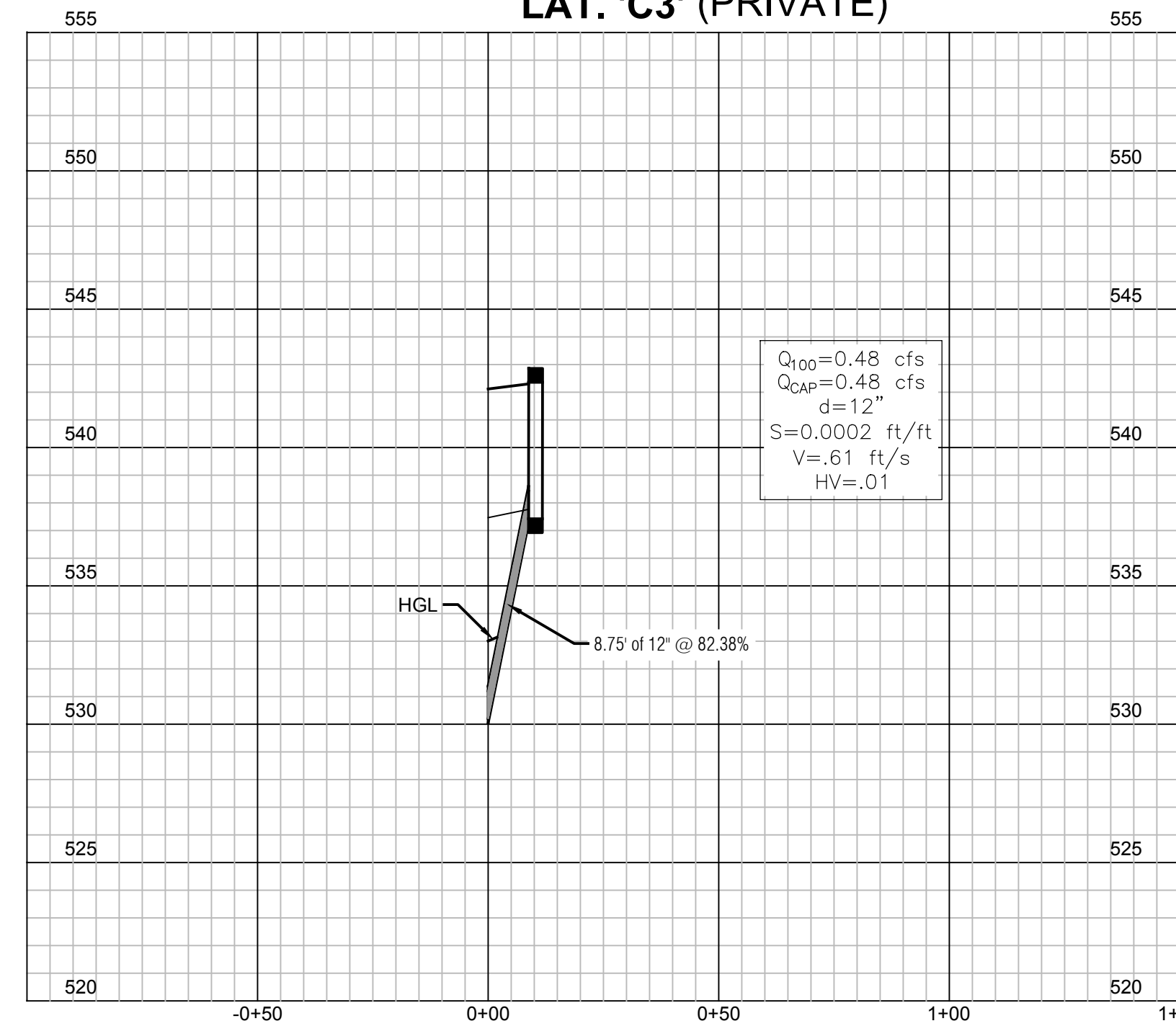

LAT. 'C16' (PRIVATE)

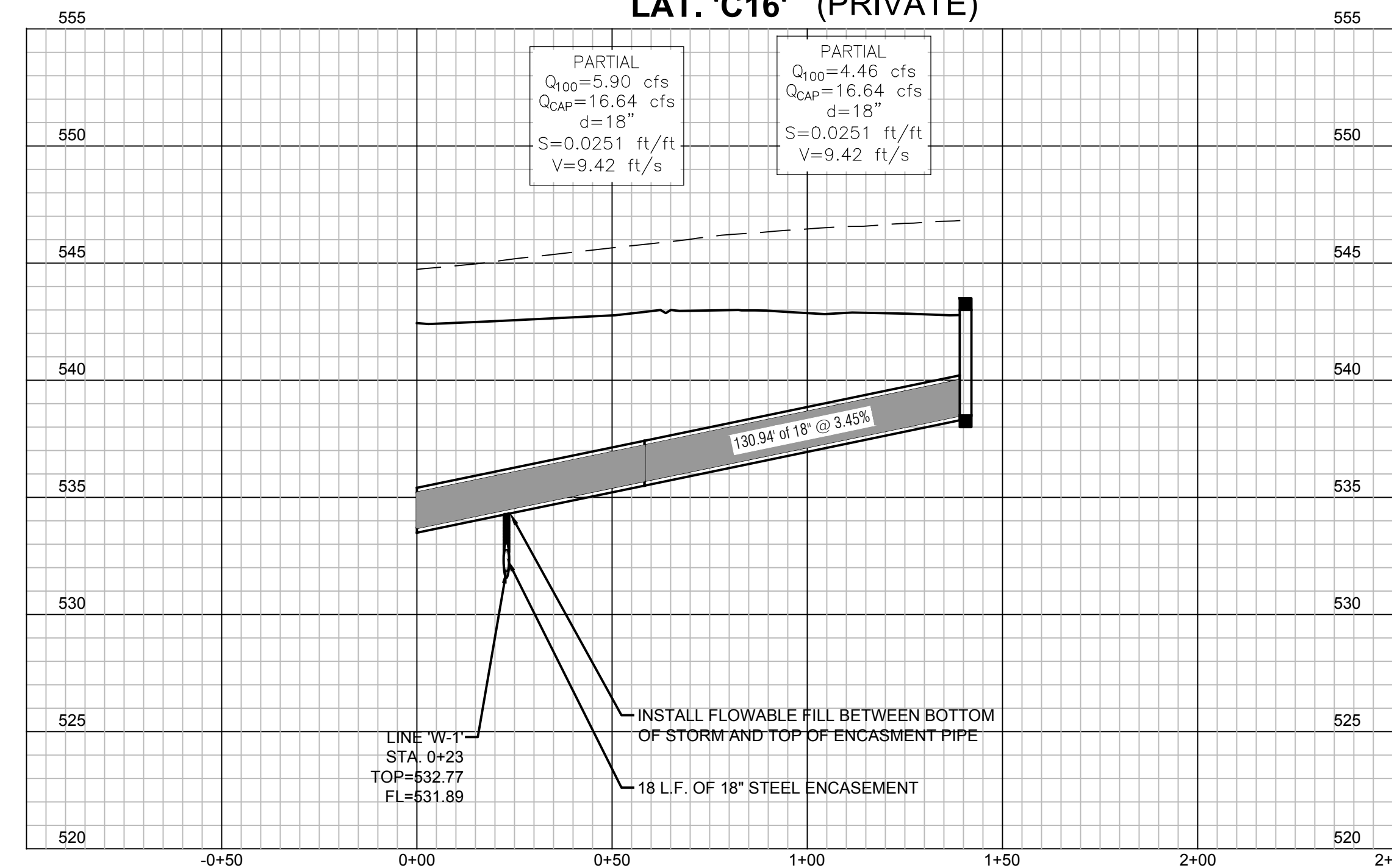

NOTE:  
ALL STORM SEWER IS  
CONSIDERED PRIVATE

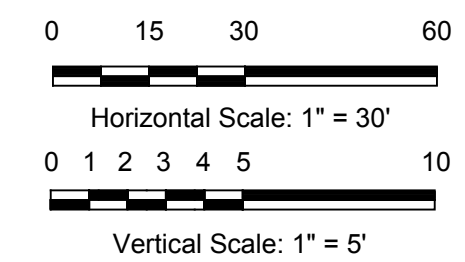

RECORD DRAWING  
THIS IS TO CERTIFY THAT CHANGES AND CORRECTIONS HAVE BEEN MADE TO CONFORM TO THE CONTRACTOR'S RECORD OF THIS PROJECT.  
SIGN: *Charlynn Amis*  
DATE: 06/01/2020  
Glenn Engineering Corporation