

Copyright Reserved

The Contractor shall verify and be responsible for all dimensions. DO NOT scale the drawing - any errors or omissions shall be reported to Stantec without delay. The Copyrights to all designs and drawings are the property of Stantec. Reproduction or use for any purpose other than that authorized by Stantec is forbidden.

Consultants



T.B.P.E. FIRM REGISTRATION NO. F - 303

PHONE 972-717-5151 FAX 972-717-2176
4500 FULLER DRIVE - SUITE 220 IRVING, TEXAS 75038

Notes



8 - RH #40	RAH	CMG	2020.05.13
7 - RH #79 - PC 20 - REV	RAH	CMG	2020.03.13
6 - RH #116 AND #117	RAH	CMG	2020.01.13
5 - RH #20 AND #21	RAH	CMG	2019.07.23
4 - RH #16	RAH	CMG	2019.07.12
3 - CITY COMMENTS	RAH	CMG	2019.04.30
2 - ASI #1 - CITY COMMENTS	RAH	CMG	2019.04.02

Revision By Appd YYYY.MM.DD

100%CD - For Bidding and Construction RAH CMG 2019.03.01

Issued By Appd YYYY.MM.DD

Permit-Seal



The seal appearing on this document was authorized by Mike Glenn, P.E. 35059, on May 13, 2020

Client/Project

Rockwall ISD

Elementary School #15

2911 Greenway Drive
Rockwall, TX 75087

Title

MIDDLE DETAILED GRADING PLAN

Project No. Scale

214000654 AS SHOWN

Revision Drawing No.

8 C04.02

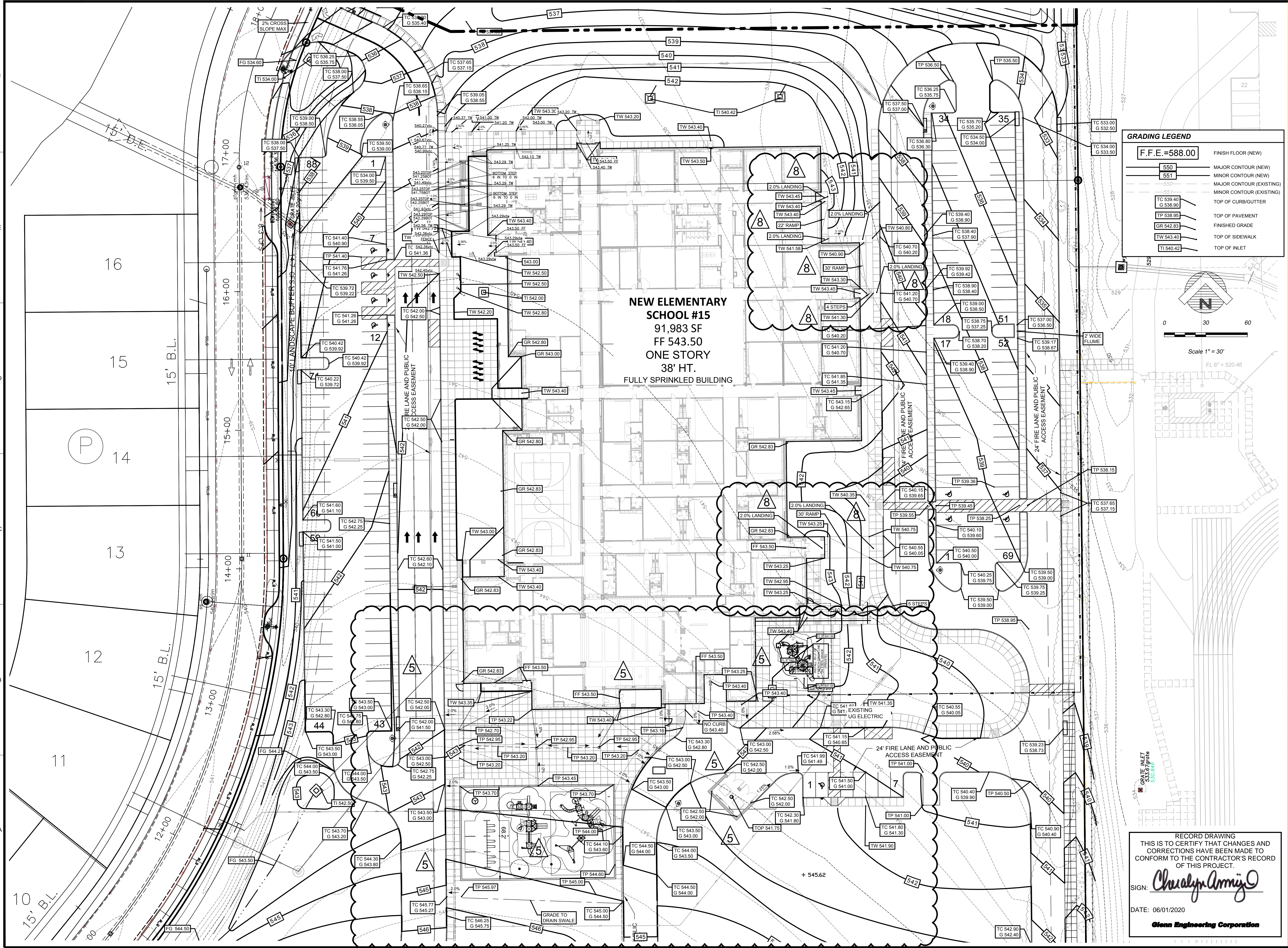

GRADING LEGEND

F.F.E.=588.00	FINISH FLOOR (NEW)
550	MAJOR CONTOUR (NEW)
551	MINOR CONTOUR (NEW)
552	MAJOR CONTOUR (EXISTING)
553	MINOR CONTOUR (EXISTING)
TC 539.40 G 538.90	TOP OF CURB/GUTTER
TP 538.95	TOP OF PAVEMENT
GR 542.83	FINISHED GRADE
TW 543.40	TOP OF SIDEWALK
TI 540.42	TOP OF INLET

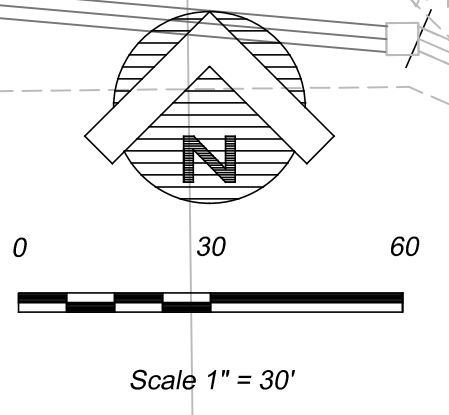

NEW ELEMENTARY SCHOOL #15
91,983 SF
FF 543.50
ONE STORY
38' HT.
FULLY SPRINKLED BUILDING

RECORD DRAWING
THIS IS TO CERTIFY THAT CHANGES AND CORRECTIONS HAVE BEEN MADE TO CONFORM TO THE CONTRACTOR'S RECORD OF THIS PROJECT.

SIGN: *Cheryl Amis*

DATE: 06/01/2020

Glenn Engineering Corporation

NOTE: THE CITY OF ROCKWALL CONSTRUCTION STANDARDS APPLY, WHETHER INDICATED ON THESE PLANS OR NOT.

Plotted: Jun 1, 2020, 1:46 PM by user: john - Saved: 6/1/2020 by user: john
R:\ROCKWALL\STONE CREEK ELEM\BIDSET\STONE CREEK ELEM ENG - RECORD SET.dwg