

Copyright Reserved

The Contractor shall verify and be responsible for all dimensions. DO NOT scale the drawing - any errors or omissions shall be reported to Stantec without delay. The Copyrights to all designs and drawings are the property of Stantec. Reproduction or use for any purpose other than that authorized by Stantec is forbidden.

Consultants

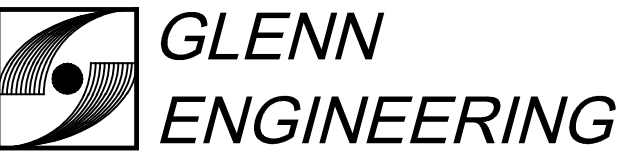

T.B.P.E. FIRM REGISTRATION NO. F - 303

PHONE 972-717-5151 FAX 972-717-2176
4500 FULLER DRIVE - SUITE 220 IRVING, TEXAS 75038

Notes



| | | | |
|----------------------------|-----|-----|------------|
| 8 - RH #40 | RAH | CMG | 2020.05.13 |
| 7 - RH #79 - PC 20 - REV | RAH | CMG | 2020.03.13 |
| 6 - RH #116 AND #117 | RAH | CMG | 2020.01.13 |
| 5 - RH #20 AND #21 | RAH | CMG | 2019.07.23 |
| 4 - RH #16 | RAH | CMG | 2019.07.12 |
| 3 - CITY COMMENTS | RAH | CMG | 2019.04.30 |
| 2 - ASI #1 - CITY COMMENTS | RAH | CMG | 2019.04.02 |

| | | | |
|---------------------------------------|-----|------|------------|
| 100%CD - For Bidding and Construction | RAH | CMG | 2019.03.01 |
| Issued | By | Appd | YYYY.MM.DD |

Permit-Seal



The seal appearing on this document was authorized by Mike Glenn, P.E. 35059, on May 13, 2020.

Client/Project
Rockwall ISD

Elementary School #15

2911 Greenway Drive
Rockwall, TX 75087

Title
STORM SEWER PROFILES

Project No. 214000654 Scale AS SHOWN
Revision Drawing No.



C
05.05

LINE 'D' (PRIVATE)

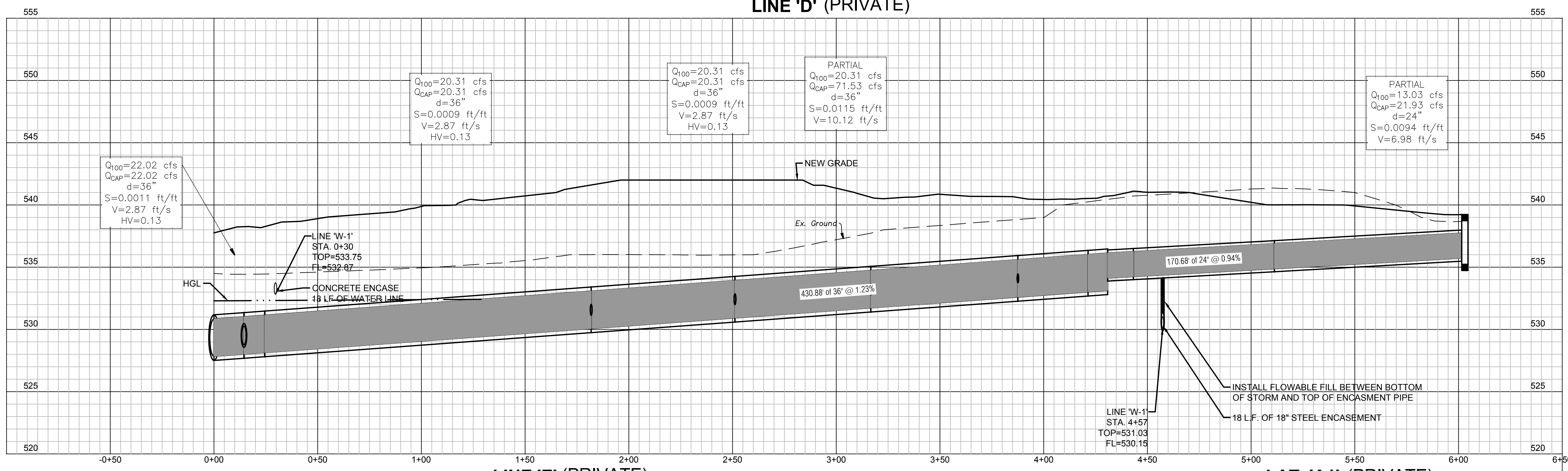

LINE 'E' (PRIVATE)

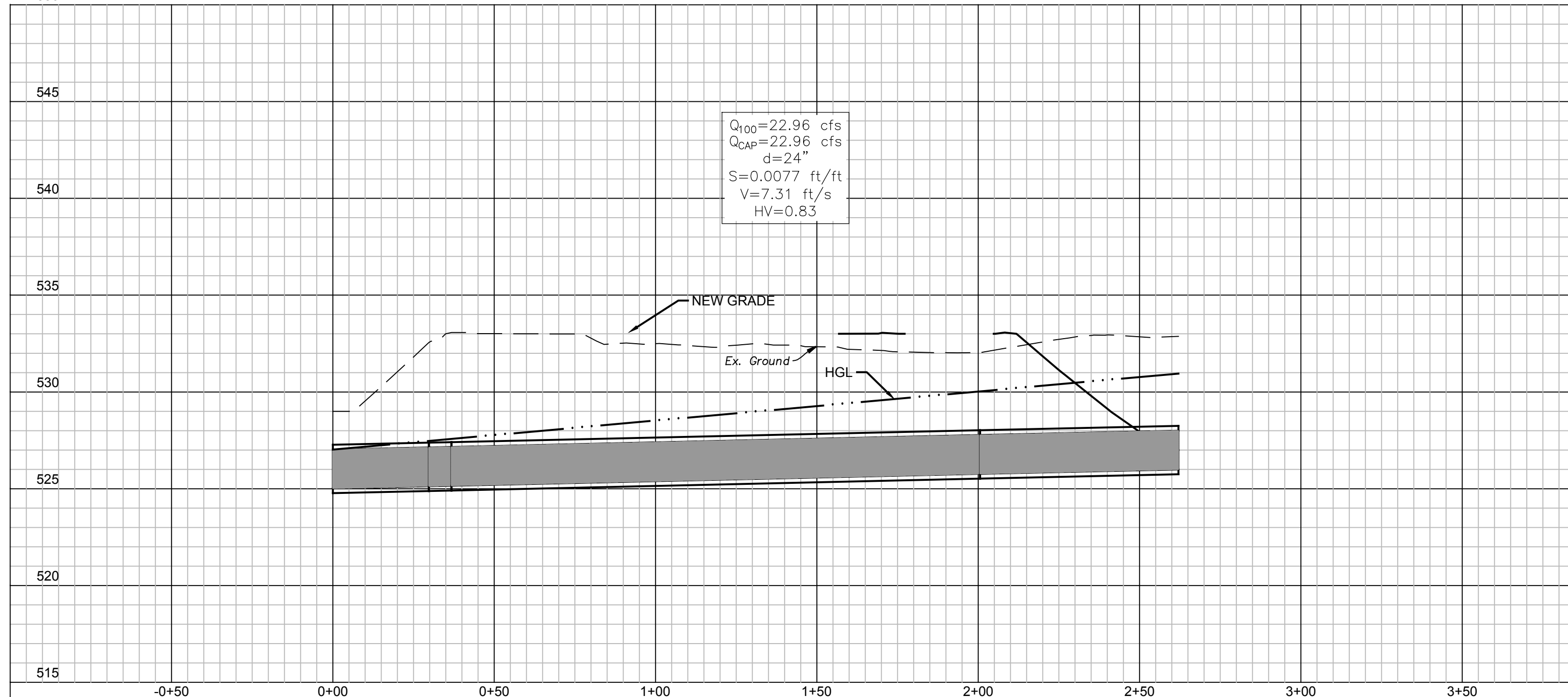

LAT. 'A1' (PRIVATE)

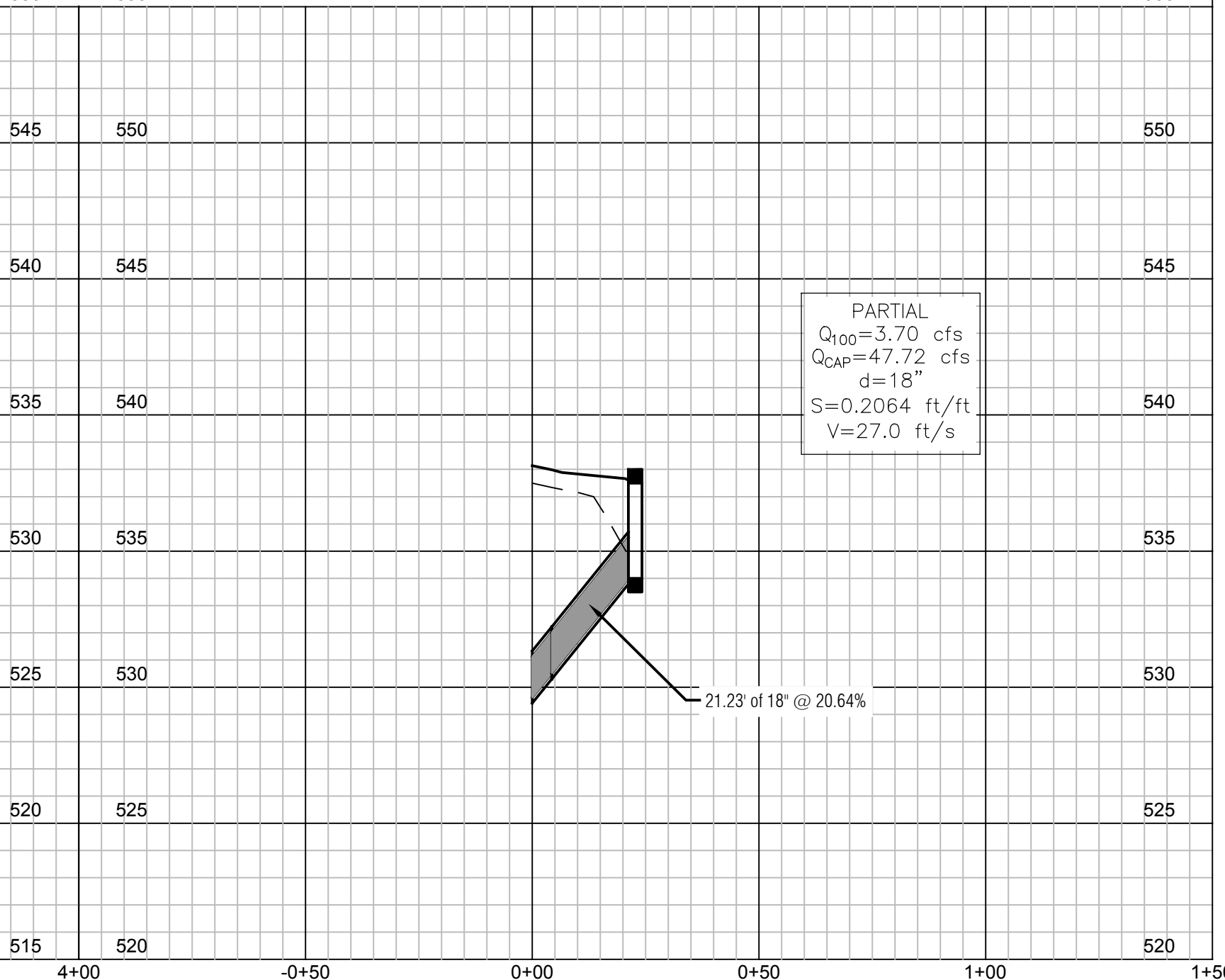

LAT. 'B1' (PRIVATE)

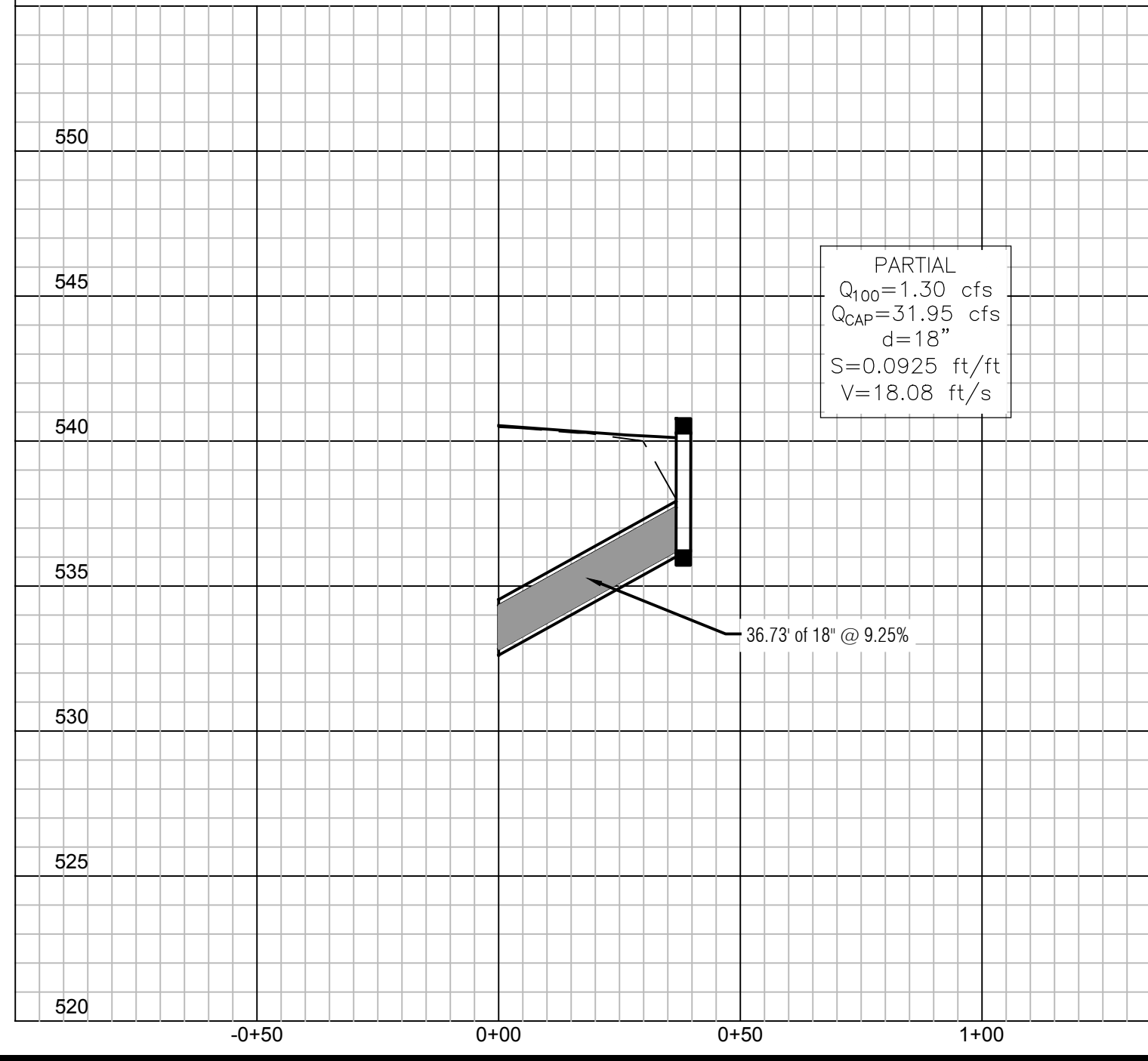

LAT. 'B2' (PRIVATE)

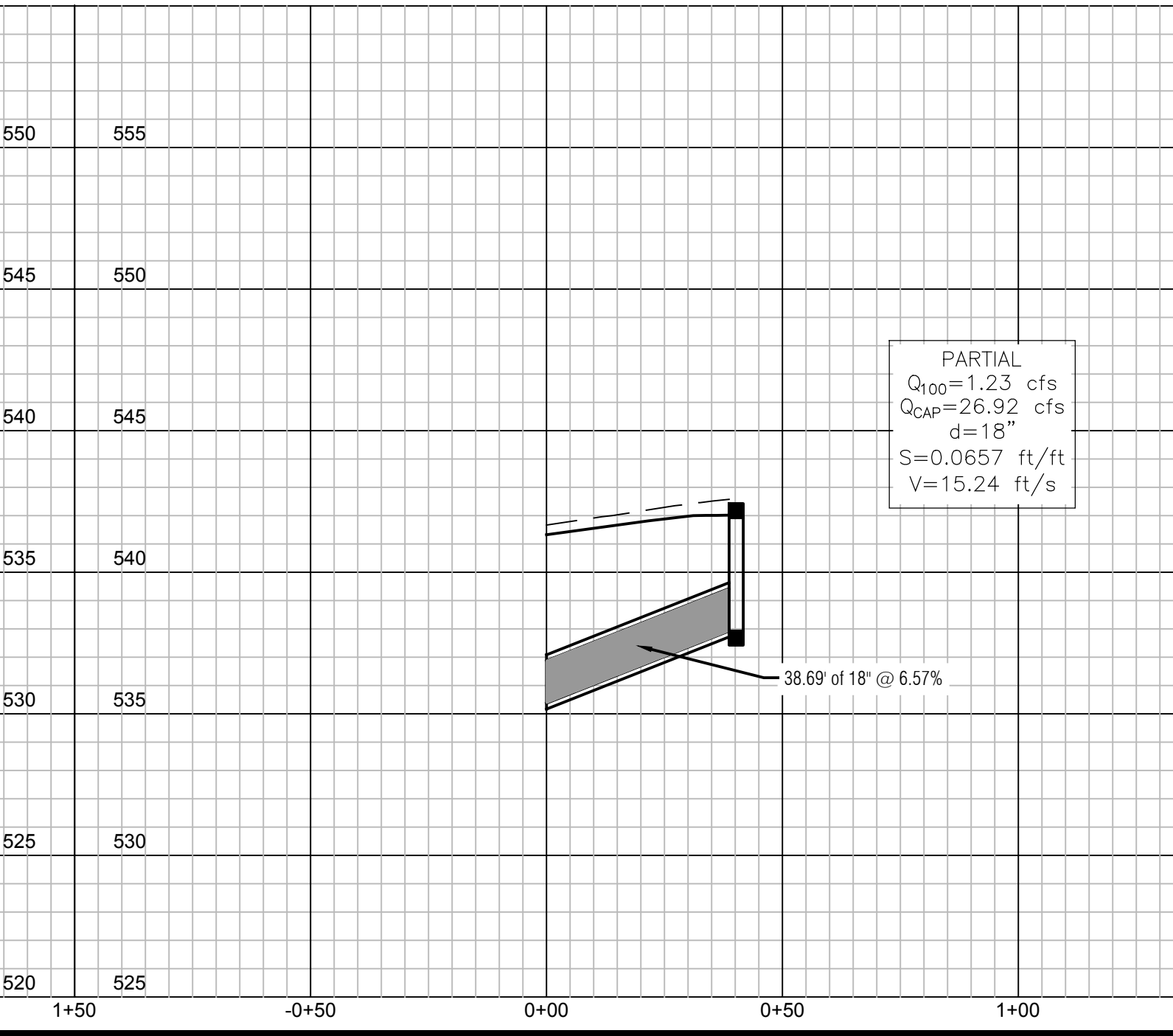

LAT. 'C2' (PRIVATE)

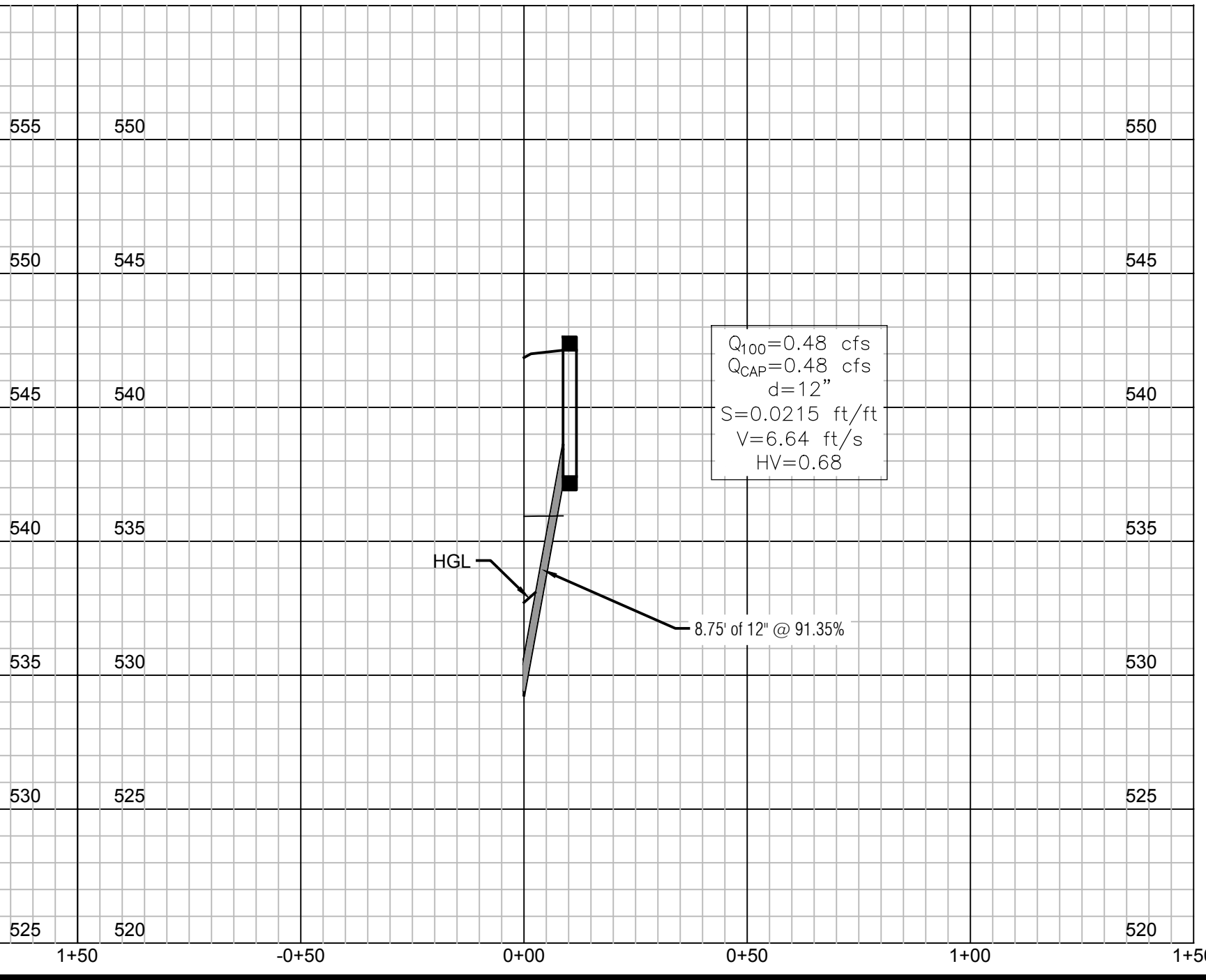

NOTE:
ALL STORM SEWER IS
CONSIDERED PRIVATE

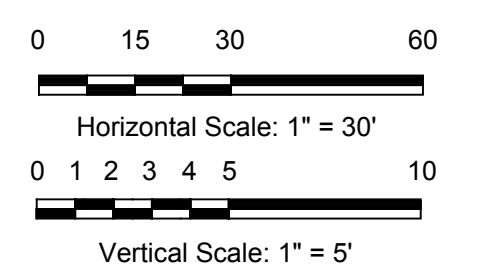

RECORD DRAWING
THIS IS TO CERTIFY THAT CHANGES AND CORRECTIONS HAVE BEEN MADE TO CONFORM TO THE CONTRACTOR'S RECORD OF THIS PROJECT.

SIGN: *Cheryl Army*

DATE: 06/01/2020

Glenn Engineering Corporation

NOTE: THE CITY OF ROCKWALL CONSTRUCTION STANDARDS APPLY, WHETHER INDICATED ON THESE PLANS OR NOT.

Plotted: Jun 1, 2020, 2:1 PM by user: john - Saved: 6/1/2020 by user: john
R:\ROCKWALL\STONE CREEK ELEM\BID\SET\STONE CREEK ELEM ENG - RECORD SET.dwg