

**SPRINGER ELEMENTARY SCHOOL
 ROCKWALL INDEPENDENT SCHOOL DISTRICT
 ROCKWALL, TEXAS**

FINAL PLANS FOR BIDDING AND CONSTRUCTION

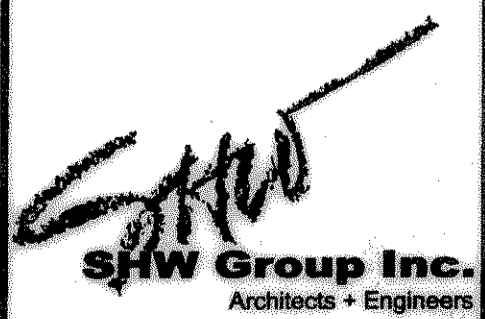

SHEET NUMBER: **C 2.24**
 SET NUMBER

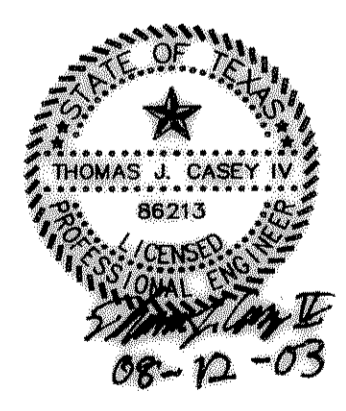
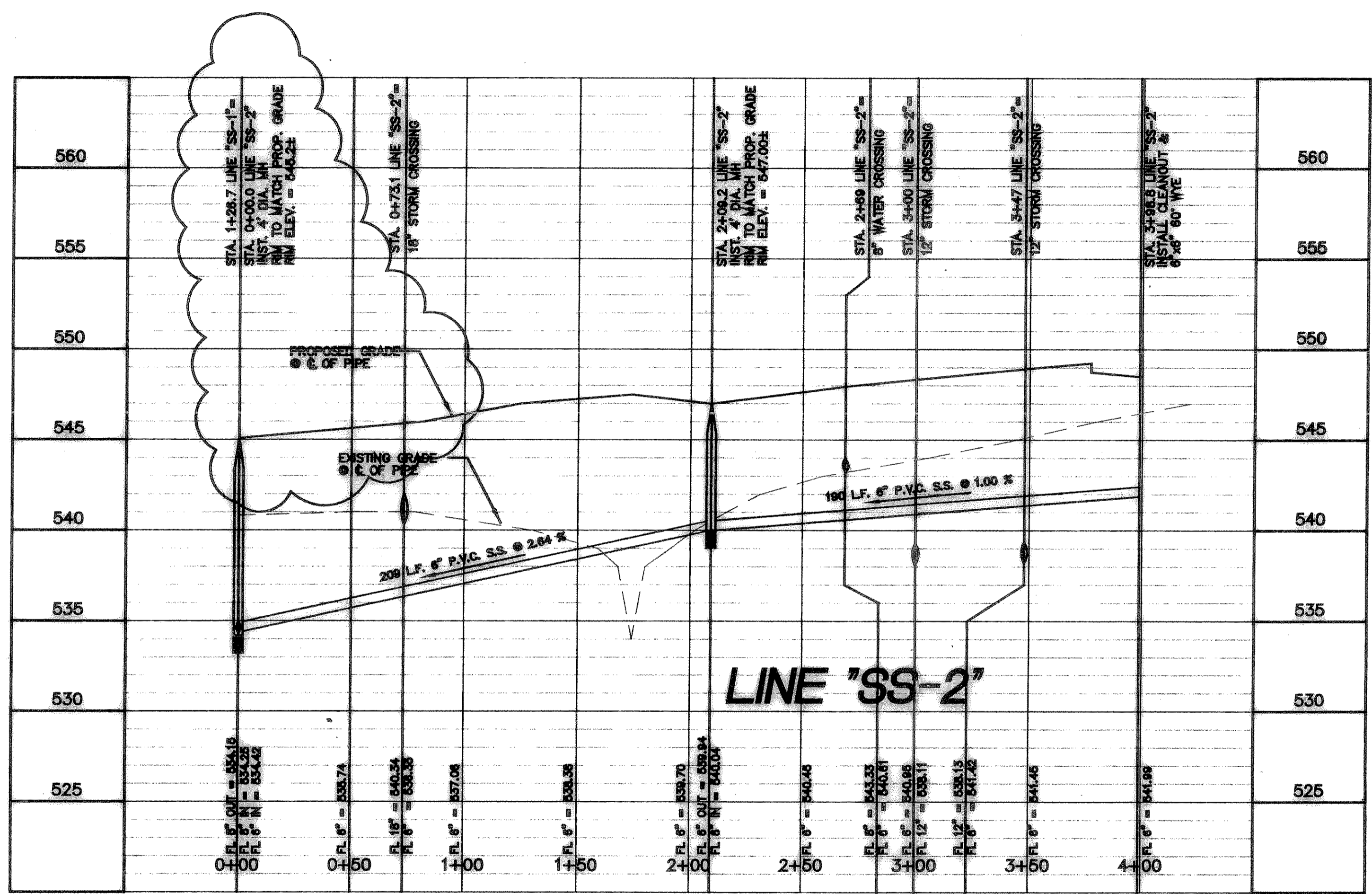
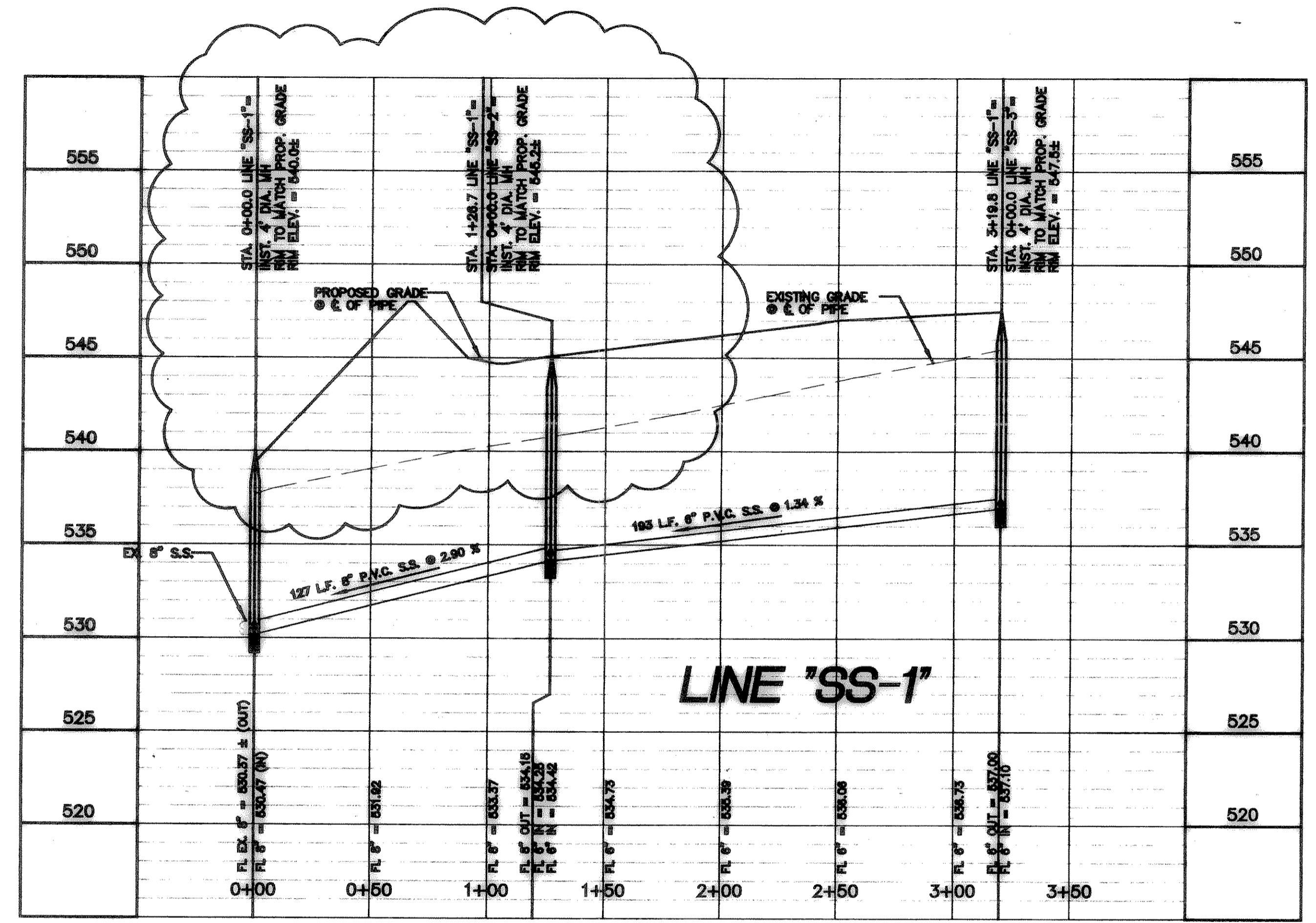

SANITARY SEWER PROFILES
 SCALE: 1" = 40' H
 1" = 5' V
 (PRIVATE LINES)

BENCH MARKS:
 BENCHMARK:
 SQUARE CUT ON TOP OF HEADWALL AT THE MOST NORTHERLY CORNER OF BRIDGE, NORTHEASTERLY SIDE OF FM 205. 1680' +/- NORTHWEST OF CL OF MIMS ROAD.
 ELEVATION = 529.11
 BENCHMARK:
 CITY OF ROCKWALL, TEXAS CONTROL MONUMENT #929, TOP OF HEADWALL IN NORTHWEST CORNER OF BRIDGE OVER SQUABBLE CREEK, SOUTHWESTERLY SIDE OF FM 205.
 ELEVATION = 524.55

These Drawings have been modified to conform to the Construction Records.
 Glenn Engineering Corporation
 By: *[Signature]* Date: 11-15-04

GLENN ENGINEERING
 PHONE 972-707-5911 FAX 972-707-2076
 105 DECKER COURT - SUITE 610 IRVING, TEXAS 75038