

CONTRACTOR TO SAW CUT & REMOVE EXISTING CURB AND GUTTER. CONTRACTOR TO CONSTRUCT LEFT TURN LANE PER CITY DETAILS. MATCH EXISTING CROSS SLOPE.

CEAL J AND RAY L UNRUTH
V.C. #2 PG. 300

SET NUMBER
OF
2.3

SHEET NUMBER
C
SW Group Inc.
Architects + Engineers

CONCRETE DRIVEWAYS
PARKING LOTS
PAVING

A. CONCRETE DRIVEWAYS
CONCRETE DRIVEWAYS SHALL BE AS INDICATED IN SECTION 020511. SIDEWALK APPROACHES SHALL BE A MINIMUM OF 6 INCHES WIDE. DRIVEWAYS SHALL BE COMPACTED TO 95% STANDARD PROCTOR DENSITY. AND AS INDICATED IN SECTION 020511. CURBS SHALL BE A MINIMUM OF 6 INCHES HIGH FROM THE FLOOR OF THE DRIVEWAY TO A POINT 2 FEET BEHIND THE FACE OF THE GUTTER. CONCRETE DRIVEWAYS SHALL BE A MINIMUM OF 4 FEET WIDE AT THE DRIVEWAY. DRIVEWAYS SHALL BE COMPACTED TO 95% STANDARD PROCTOR DENSITY. AND AS INDICATED IN SECTION 020511. DRIVEWAYS SHALL BE COMPACTED TO 95% STANDARD PROCTOR DENSITY. AND AS INDICATED IN SECTION 020511. DRIVEWAYS SHALL BE COMPACTED TO 95% STANDARD PROCTOR DENSITY. AND AS INDICATED IN SECTION 020511.

B. PARKING LOTS
PARKING LOTS SHALL BE AS INDICATED IN SECTION 020511. FINISHING SHALL BE AS INDICATED IN SECTION 020511. FINISHING SHALL BE AS INDICATED IN SECTION 020511. FINISHING SHALL BE AS INDICATED IN SECTION 020511. FINISHING SHALL BE AS INDICATED IN SECTION 020511. FINISHING SHALL BE AS INDICATED IN SECTION 020511. FINISHING SHALL BE AS INDICATED IN SECTION 020511. FINISHING SHALL BE AS INDICATED IN SECTION 020511. FINISHING SHALL BE AS INDICATED IN SECTION 020511.

C. ON-SITE SIDEWALKS
FINISHING SHALL BE AS INDICATED IN SECTION 020511. FINISHING SHALL BE AS INDICATED IN SECTION 020511. FINISHING SHALL BE AS INDICATED IN SECTION 020511. FINISHING SHALL BE AS INDICATED IN SECTION 020511. FINISHING SHALL BE AS INDICATED IN SECTION 020511. FINISHING SHALL BE AS INDICATED IN SECTION 020511. FINISHING SHALL BE AS INDICATED IN SECTION 020511. FINISHING SHALL BE AS INDICATED IN SECTION 020511.

D. DRIVEWAYS
DRIVEWAYS SHALL BE AS INDICATED IN SECTION 020511. DRIVEWAYS SHALL BE AS INDICATED IN SECTION 020511. DRIVEWAYS SHALL BE AS INDICATED IN SECTION 020511. DRIVEWAYS SHALL BE AS INDICATED IN SECTION 020511. DRIVEWAYS SHALL BE AS INDICATED IN SECTION 020511. DRIVEWAYS SHALL BE AS INDICATED IN SECTION 020511. DRIVEWAYS SHALL BE AS INDICATED IN SECTION 020511. DRIVEWAYS SHALL BE AS INDICATED IN SECTION 020511.

E. DRIVEWAYS
DRIVEWAYS SHALL BE AS INDICATED IN SECTION 020511. DRIVEWAYS SHALL BE AS INDICATED IN SECTION 020511. DRIVEWAYS SHALL BE AS INDICATED IN SECTION 020511. DRIVEWAYS SHALL BE AS INDICATED IN SECTION 020511. DRIVEWAYS SHALL BE AS INDICATED IN SECTION 020511. DRIVEWAYS SHALL BE AS INDICATED IN SECTION 020511. DRIVEWAYS SHALL BE AS INDICATED IN SECTION 020511. DRIVEWAYS SHALL BE AS INDICATED IN SECTION 020511.

F. DRIVEWAYS
DRIVEWAYS SHALL BE AS INDICATED IN SECTION 020511. DRIVEWAYS SHALL BE AS INDICATED IN SECTION 020511. DRIVEWAYS SHALL BE AS INDICATED IN SECTION 020511. DRIVEWAYS SHALL BE AS INDICATED IN SECTION 020511. DRIVEWAYS SHALL BE AS INDICATED IN SECTION 020511. DRIVEWAYS SHALL BE AS INDICATED IN SECTION 020511. DRIVEWAYS SHALL BE AS INDICATED IN SECTION 020511. DRIVEWAYS SHALL BE AS INDICATED IN SECTION 020511.

G. DRIVEWAYS
DRIVEWAYS SHALL BE AS INDICATED IN SECTION 020511. DRIVEWAYS SHALL BE AS INDICATED IN SECTION 020511. DRIVEWAYS SHALL BE AS INDICATED IN SECTION 020511. DRIVEWAYS SHALL BE AS INDICATED IN SECTION 020511. DRIVEWAYS SHALL BE AS INDICATED IN SECTION 020511. DRIVEWAYS SHALL BE AS INDICATED IN SECTION 020511. DRIVEWAYS SHALL BE AS INDICATED IN SECTION 020511. DRIVEWAYS SHALL BE AS INDICATED IN SECTION 020511.

H. DRIVEWAYS
DRIVEWAYS SHALL BE AS INDICATED IN SECTION 020511. DRIVEWAYS SHALL BE AS INDICATED IN SECTION 020511. DRIVEWAYS SHALL BE AS INDICATED IN SECTION 020511. DRIVEWAYS SHALL BE AS INDICATED IN SECTION 020511. DRIVEWAYS SHALL BE AS INDICATED IN SECTION 020511. DRIVEWAYS SHALL BE AS INDICATED IN SECTION 020511. DRIVEWAYS SHALL BE AS INDICATED IN SECTION 020511. DRIVEWAYS SHALL BE AS INDICATED IN SECTION 020511.

I. DRIVEWAYS
DRIVEWAYS SHALL BE AS INDICATED IN SECTION 020511. DRIVEWAYS SHALL BE AS INDICATED IN SECTION 020511. DRIVEWAYS SHALL BE AS INDICATED IN SECTION 020511. DRIVEWAYS SHALL BE AS INDICATED IN SECTION 020511. DRIVEWAYS SHALL BE AS INDICATED IN SECTION 020511. DRIVEWAYS SHALL BE AS INDICATED IN SECTION 020511. DRIVEWAYS SHALL BE AS INDICATED IN SECTION 020511. DRIVEWAYS SHALL BE AS INDICATED IN SECTION 020511.

J. DRIVEWAYS
DRIVEWAYS SHALL BE AS INDICATED IN SECTION 020511. DRIVEWAYS SHALL BE AS INDICATED IN SECTION 020511. DRIVEWAYS SHALL BE AS INDICATED IN SECTION 020511. DRIVEWAYS SHALL BE AS INDICATED IN SECTION 020511. DRIVEWAYS SHALL BE AS INDICATED IN SECTION 020511. DRIVEWAYS SHALL BE AS INDICATED IN SECTION 020511. DRIVEWAYS SHALL BE AS INDICATED IN SECTION 020511. DRIVEWAYS SHALL BE AS INDICATED IN SECTION 020511.

K. DRIVEWAYS
DRIVEWAYS SHALL BE AS INDICATED IN SECTION 020511. DRIVEWAYS SHALL BE AS INDICATED IN SECTION 020511. DRIVEWAYS SHALL BE AS INDICATED IN SECTION 020511. DRIVEWAYS SHALL BE AS INDICATED IN SECTION 020511. DRIVEWAYS SHALL BE AS INDICATED IN SECTION 020511. DRIVEWAYS SHALL BE AS INDICATED IN SECTION 020511. DRIVEWAYS SHALL BE AS INDICATED IN SECTION 020511. DRIVEWAYS SHALL BE AS INDICATED IN SECTION 020511.

L. DRIVEWAYS
DRIVEWAYS SHALL BE AS INDICATED IN SECTION 020511. DRIVEWAYS SHALL BE AS INDICATED IN SECTION 020511. DRIVEWAYS SHALL BE AS INDICATED IN SECTION 020511. DRIVEWAYS SHALL BE AS INDICATED IN SECTION 020511. DRIVEWAYS SHALL BE AS INDICATED IN SECTION 020511. DRIVEWAYS SHALL BE AS INDICATED IN SECTION 020511. DRIVEWAYS SHALL BE AS INDICATED IN SECTION 020511. DRIVEWAYS SHALL BE AS INDICATED IN SECTION 020511.

PAVING PLAN

SCALE: 1" = 50'

ROCKWALL INDEPENDENT SCHOOL DISTRICT EXISTING HIGH SCHOOL

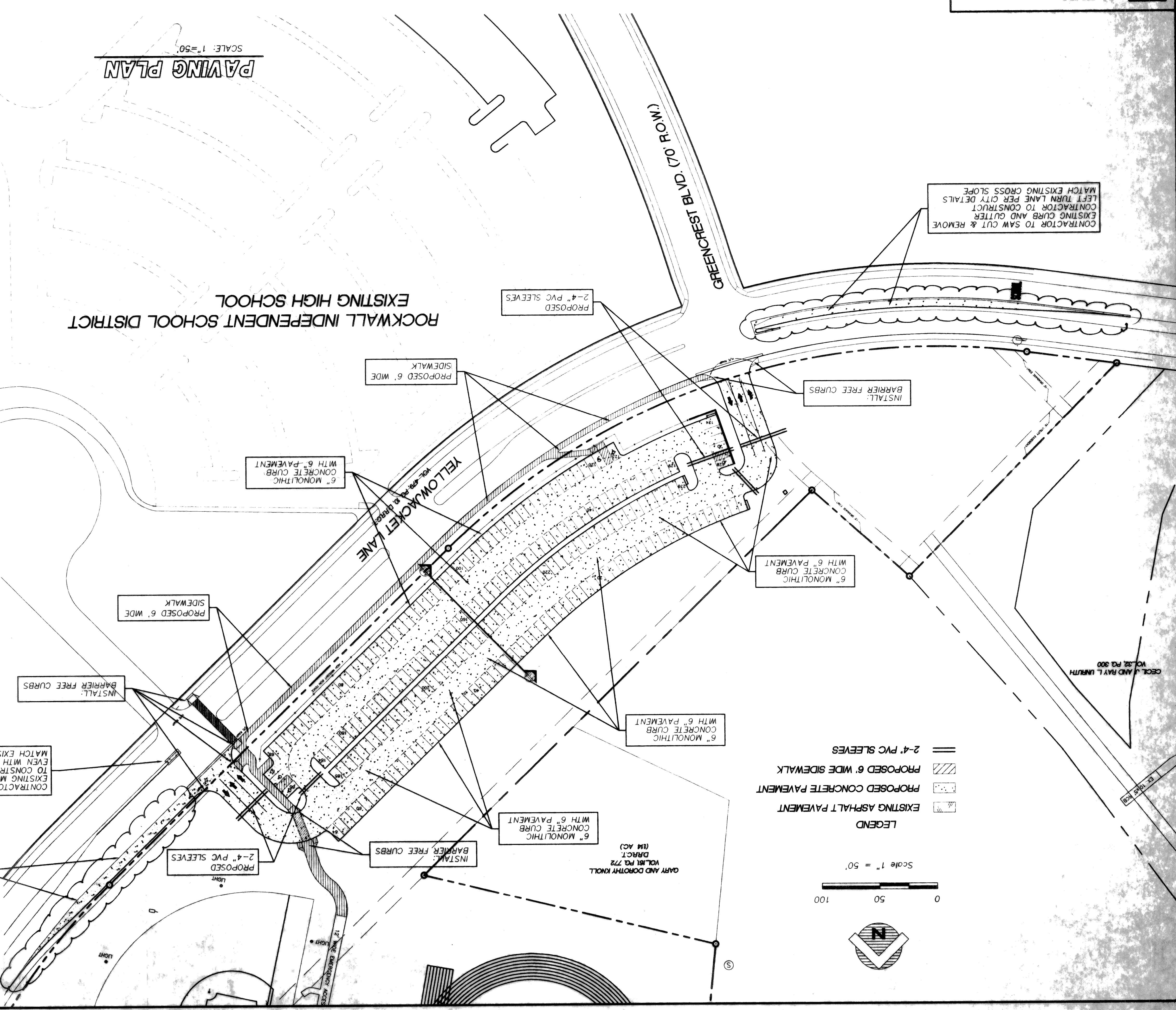

LEGEND

- EXISTING ASPHALT PAVEMENT
- PROPOSED CONCRETE PAVEMENT
- PROPOSED 6" WIDE SIDEWALK
- 2-4" PVC SLEEVES

Scale 1" = 50'

0 50 100

ROCKWALL I.S.D. 1998 PAVING IMPROVEMENTS

ROCKWALL HIGH SCHOOL PAVING IMPROVEMENTS

ROCKWALL I.S.D. ROCKWALL, TEXAS

DATE: JULY 7, 1998
DRAWN BY: R. HOSMAN
CHECKED BY: R. HOSMAN
SCALE: 1/4" = 10'-0"

REVISIONS:
NO. 01 (10/91) - PREPARED FOR THIS PROJECT BY FUGRO SOUTH, INC. OR OTHER AGENCY OR PROJECT.
NO. 02 (10/91) - REVISED TO REFLECT REVISIONS TO ANY SUCH REPORTS AND REPORTS PREPARED FOR THIS PROJECT BY FUGRO SOUTH, INC. OR OTHER AGENCY OR PROJECT.
NO. 03 (10/91) - REVISED TO REFLECT REVISIONS TO ANY SUCH REPORTS AND REPORTS PREPARED FOR THIS PROJECT BY FUGRO SOUTH, INC. OR OTHER AGENCY OR PROJECT.