

- GENERAL STORM SEWER NOTES**
- ALL CONSTRUCTION TO BE IN ACCORDANCE WITH THESE PLANS AND CITY OF ROCKWALL STANDARDS AND SPECIFICATIONS.
  - PRIOR TO STARTING CONSTRUCTION, THE CONTRACTOR SHALL MAKE CERTAIN THAT ALL REQUIRED PERMITS AND APPROVALS HAVE BEEN OBTAINED. NO CONSTRUCTION OR FABRICATION SHALL BEGIN UNTIL THE CONTRACTOR HAS RECEIVED AND THOROUGHLY REVIEWED ALL PLANS AND OTHER DOCUMENTS APPROVED BY ALL OF THE PERMITTING AUTHORITIES.
  - ALL WORK SHALL BE PERFORMED IN ACCORDANCE WITH THESE PLANS AND SPECIFICATIONS AND THE REQUIREMENTS AND STANDARDS OF THE LOCAL GOVERNING AUTHORITY.
  - IN THE EVENT AN ITEM IS NOT COVERED IN THE CITY OF ROCKWALL SPECIFICATIONS, THE ENGINEER'S DECISION SHALL APPLY.
  - BARRICADING, TRAFFIC CONTROL, AND PROJECT SIGNS SHALL CONFORM TO STATE DEPARTMENT OF HIGHWAYS AND PUBLIC TRANSPORTATION BARRICADING AND CONSTRUCTION STANDARDS.
  - THE GENERAL CONTRACTOR AND ALL SUBCONTRACTORS SHALL VERIFY THE SUITABILITY OF ALL EXISTING AND PROPOSED SITE CONDITIONS INCLUDING GRADES AND DIMENSIONS BEFORE COMMENCEMENT OF ANY CONSTRUCTION. IN THE EVENT OF ANY CONFLICT AND PRIOR TO COMMENCEMENT OF ANY CONSTRUCTION, IMMEDIATELY NOTIFY ENGINEER. MINOR ADJUSTMENTS OF FINISH GRADE TO ACCOMPLISH SPOT DRAINAGE ARE ACCEPTABLE. IF NECESSARY, OBTAIN PRIOR APPROVAL OF ENGINEER. PAVING INSTALLED SHALL "FLUSH OUT" AT ANY JUNCTURE WITH EXISTING PAVING.
  - THE LOCATIONS OF UNDERGROUND UTILITIES SHOWN ON THIS PLAN ARE BASED ON FIELD SURVEYS AND LOCAL UTILITY COMPANY RECORDS. IT SHALL BE THE CONTRACTOR'S FULL RESPONSIBILITY TO CONTACT THE VARIOUS UTILITY COMPANIES TO LOCATE THEIR UTILITIES PRIOR TO STARTING CONSTRUCTION.
  - CONTRACTOR SHALL VERIFY ALL EXISTING INVERTS AND RIM ELEVATIONS PRIOR TO CONSTRUCTION.
  - ALL PVC PIPE SHALL BE SCH 40, ADS, HANCOR OR APPROVED EQUAL.
  - ALL RCP SHALL BE CLASS III, ADS OR HANCOR OR APPROVED EQUAL.
  - CONTRACTOR SHALL CONNECT ALL EXISTING STORM SEWER TO NEW SEWER. REMOVE AND HAUL OFF EXISTING HEADWALLS.

CONTRACTOR SHALL VERIFY ALL EXISTING INVERTS AND ELEVATIONS PRIOR TO CONSTRUCTION.

ALL STORM SEWER CONSTRUCTION TO BE PER CITY OF ROCKWALL STANDARDS.

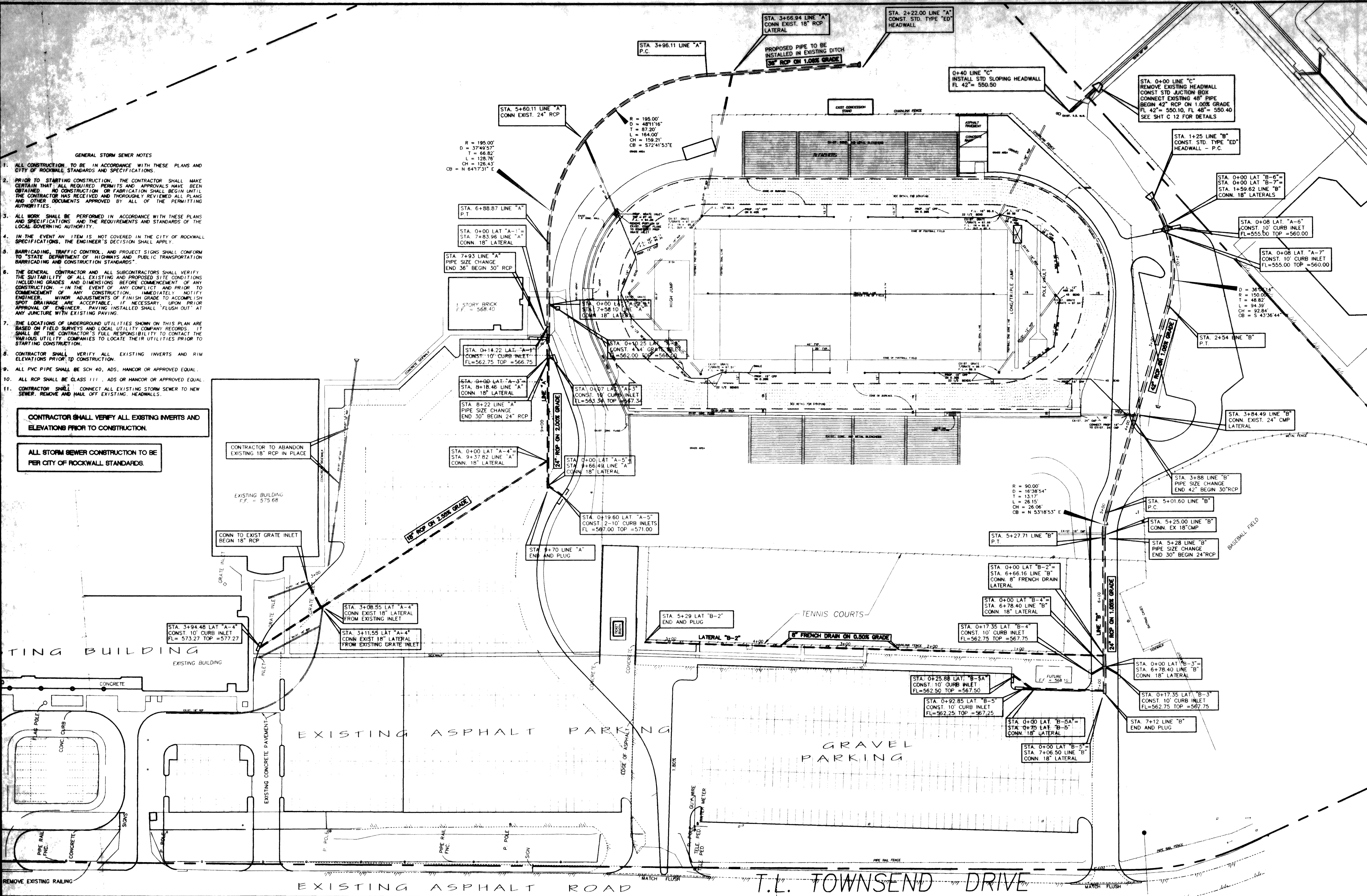

DATE MAY 15, 1998  
 DRAWN BY R. HOWMAN  
 CHECKED R.A.H.  
 CDM NO. 0494453  
 REVISIONS JULY 08, 1998

**ROCKWALL I.S.D. 1998 PAVING IMPROVEMENTS**  
**WILKERSON SANDERS STADIUM PAVING IMPROVEMENTS**  
**ROCKWALL, TEXAS**

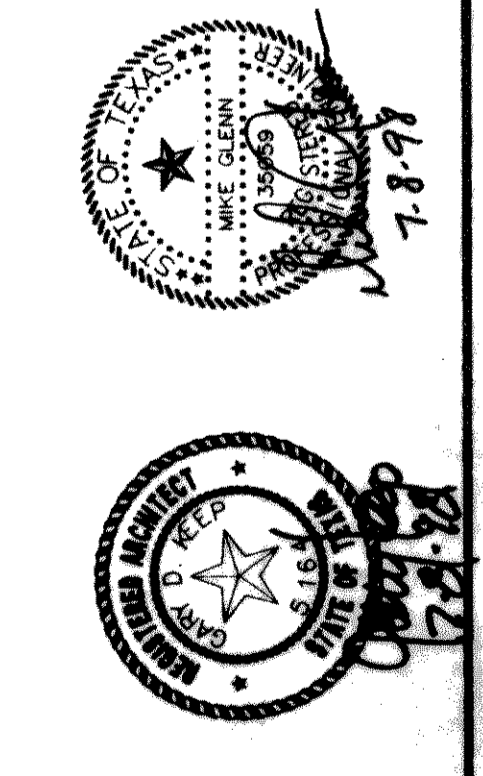

**Glenn Engineering, Inc.**  
 Architects + Engineers

SHEET NUMBER **C**  
 OF **16** **2.7R**  
 SET NUMBER

**STORM SEWER PLAN**  
 SCALE: 1"=50'

**GLENN ENGINEERING**  
 PHONE 214-777-5811  
 100 DECKER COURT - SUITE 300  
 FROWNTON, TEXAS 75042  
 FAX 214-778-0220  
 WWW.GLENN-ENG.COM

C:\WORK\UTLEY\UTLEY-ENG.dwg JUN 08 14:31:51 1998