

ROCKWALL I.S.D. 1998 PAVING IMPROVEMENTS
WILKERSON SNADERS STADIUM PAVING IMPROVEMENTS
ROCKWALL, TEXAS

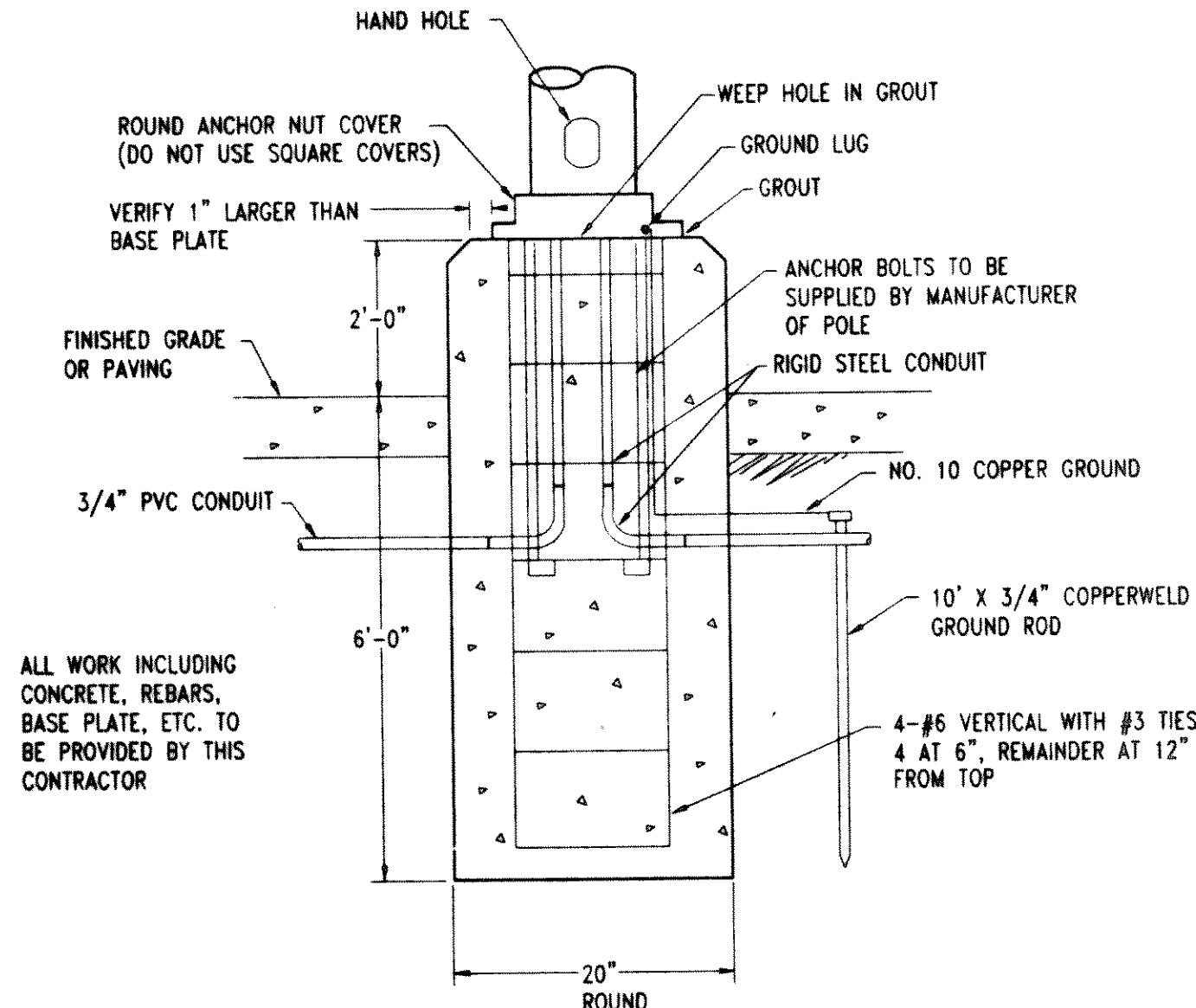
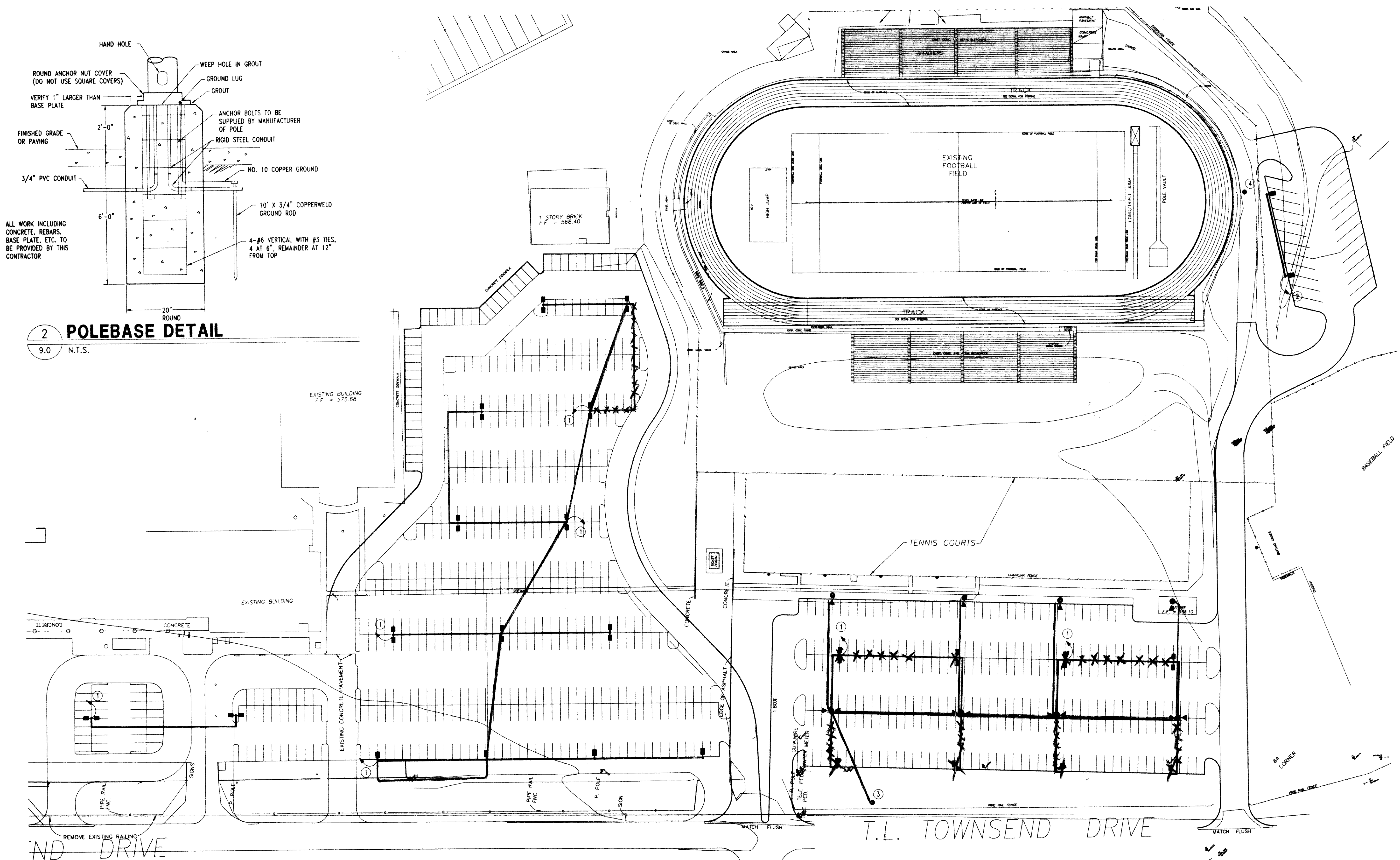

2 POLEBASE DETAIL
 9.0 N.T.S.

1 SITE PLAN - GRADING PACKAGE
 9.0 1"=50'-0"

- GENERAL NOTES:**
1. ALL CONDUIT BETWEEN PARKING LOT LIGHT FIXTURES SHALL BE 1" MINIMUM WITH PULLWIRE.
- SITE PLAN NOTES:**
- 1 PROVIDE 1" MINIMUM UNDERGROUND CONDUIT WITH PULLWIRE TO POWER POLE AT TOWNSEND ROAD. REFER TO NOTE #3.
 - 2 PROVIDE 1" MINIMUM UNDERGROUND CONDUIT WITH PULLWIRE TO LIGHTING PANEL AT FOOTBALL SCOREBOARD. VERIFY LOCATION OF PANEL.
 - 3 EXISTING POWER POLE. VERIFY EXACT LOCATION.
 - 4 EXISTING SCOREBOARD. VERIFY EXACT LOCATION.

SUBMISSION OF BID WILL BE CONSIDERED ACKNOWLEDGEMENT THAT THE CONTRACTOR HAS VISITED THE SITE AND HAS VERIFIED ALL EXISTING JOB CONDITIONS AND INCLUDED ANY NECESSARY MODIFICATION TO EXISTING AND NEW WORK REQUIRED FOR INSTALLATION OF A COMPLETE AND WORKING SYSTEM.

EM Estes, McClure & Assoc., Inc.
 CONSULTING ENGINEERS
 3608 West Way
 Tyler, Texas 75703
 903-581-2677

101 East Park Boulevard
 Suite 600
 Plano, Texas 75074