

DATE MAY 15, 1998  
 DRAWN BY R.A.H.  
 CHECKED C.M.G.  
 CHAM NO 0494453  
 REVISIONS JUNE 15, 1998

ROCKWALL I.S.D. 1998 PAVING IMPROVEMENTS  
 ROCHELLE ELEMENTARY SCHOOL  
 ROCKWALL I.S.D.  
 ROCKWALL, TEXAS

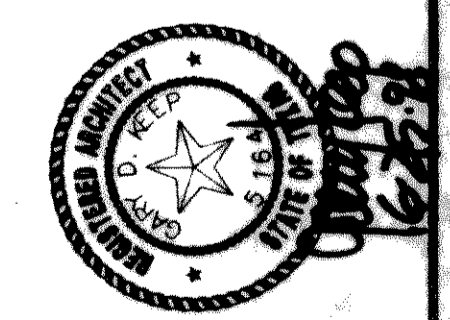
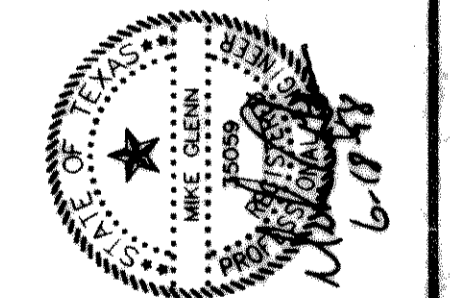

*SAW*  
 S.W. Group Inc.  
 Architects • Engineers

SHEET NUMBER C  
 OF 4 2.2R  
 SET NUMBER

**GENERAL NOTES**

1. THE GENERAL CONTRACTOR MUST VERIFY ALL EXISTING CONDITIONS AND REPORT ANY DISCREPANCIES TO THE ARCHITECT BEFORE BEGINNING WORK.
2. REPAIR AND REPLACE ALL EXISTING SIDEWALKS AND PAVING TO REMAIN THAT ARE THAT ARE DAMAGED DUE TO CONSTRUCTION.
3. PROTECT ALL PLANTING FROM DAMAGE DUE TO CONSTRUCTION. EXISTING TREES & SHRUBS WILL BE RELOCATED BY OWNER.
4. ALL AREAS OF CONSTRUCTION SHALL BE FENCED AND SECURED THROUGH OUT THE PROJECT. THE CONTRACTOR SHALL VERIFY EXTENT OF FENCING REQUIRED DUE TO STAGING AREAS, JOBSITE TRAILER LOCATIONS, ETC.
5. THE CONTRACTOR SHALL COORDINATE WITH THE OWNER TO DETERMINE ACCESSIBLE WALKING ROUTES FROM THE PARKING AREAS TO THE SCHOOL FOR SCHOOL DISTRICT EMPLOYEES TO USE. PROVIDE FENCING ALONG ACCESS ROUTE IF REQUIRED TO KEEP SCHOOL PERSONNEL SEPARATED FROM THE CONSTRUCTION AREAS.
6. THE GENERAL CONTRACTOR SHALL SEAL THE ENTIRE PARKING LOT WITH HOT-POURED RUBBER JOINT SEALING COMPOUND INCLUDING SAW CUTS, CRACKS AND CONSTRUCTION JOINTS.
7. THE GENERAL CONTRACTOR SHALL PATCH ALL DAMAGED CURBS AND DAMAGED CONCRETE SURFACES.
8. THE GENERAL CONTRACTOR SHALL RESTRIPE ENTIRE PARKING LOT AS CURRENTLY STRIPED.

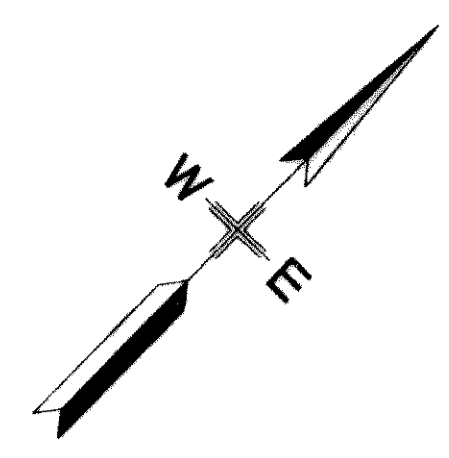

Scale 1" = 30'

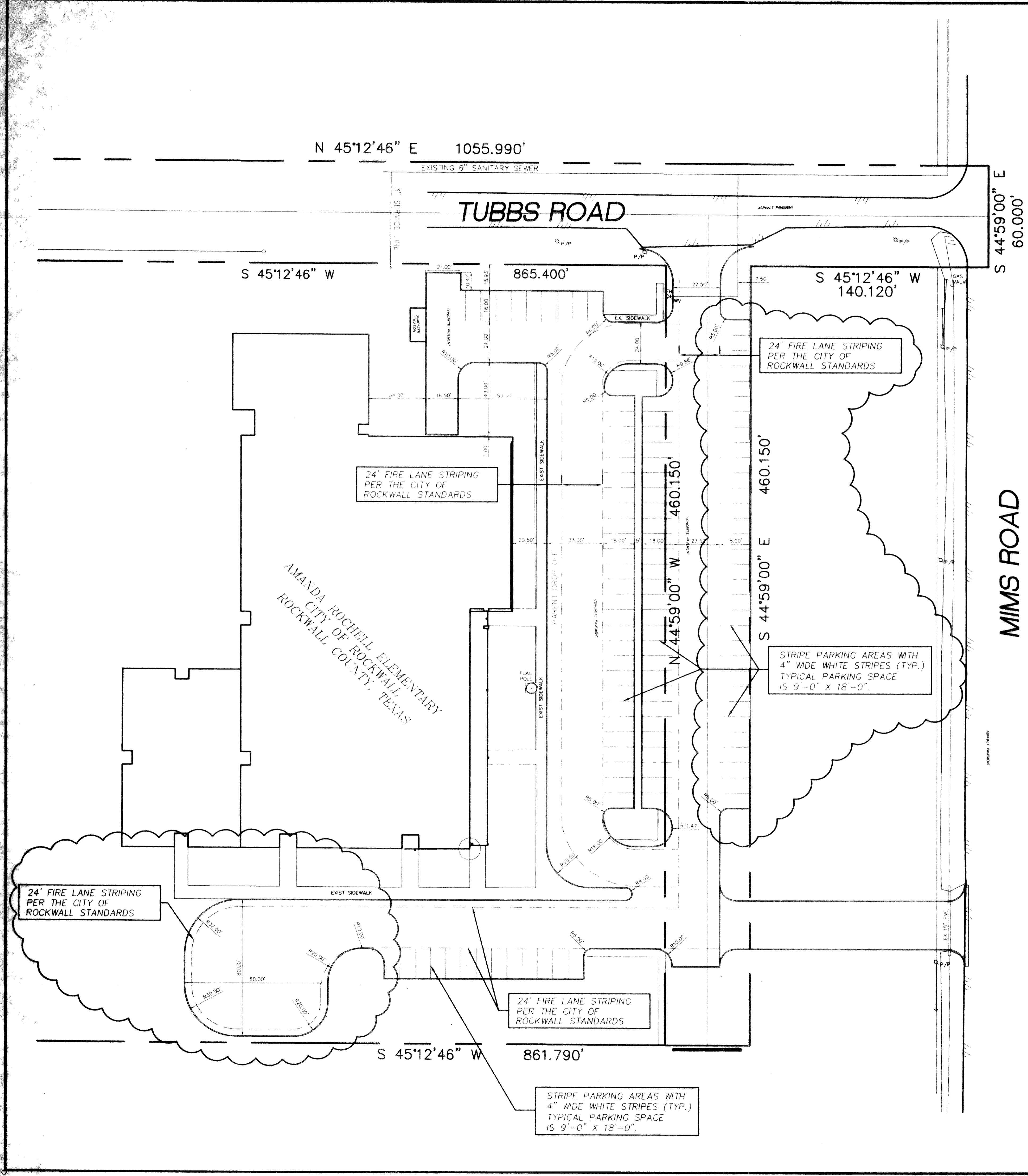

**SITE STRIPING AND DIMENSIONAL CONTROL PLAN**

SCALE: 1"=30'

**GLENN ENGINEERING**  
 PHONE 214-779-9551 FAX 214-779-4229  
 100 DECKER COURT - SUITE 250 IRVING, TEXAS 75038

C:\WORK\1998\11\1000\150-11-ANS.DWG Mod Jun 17 10:04:00 1998