

May 15, 2003 - 12:30pm User: Rick
 \\ROBERT-NIT-D-Drive\ROCKISO\WILLIAMS\2003_ADDITIONS\WORKING\WILLIAMS-NEW.dwg

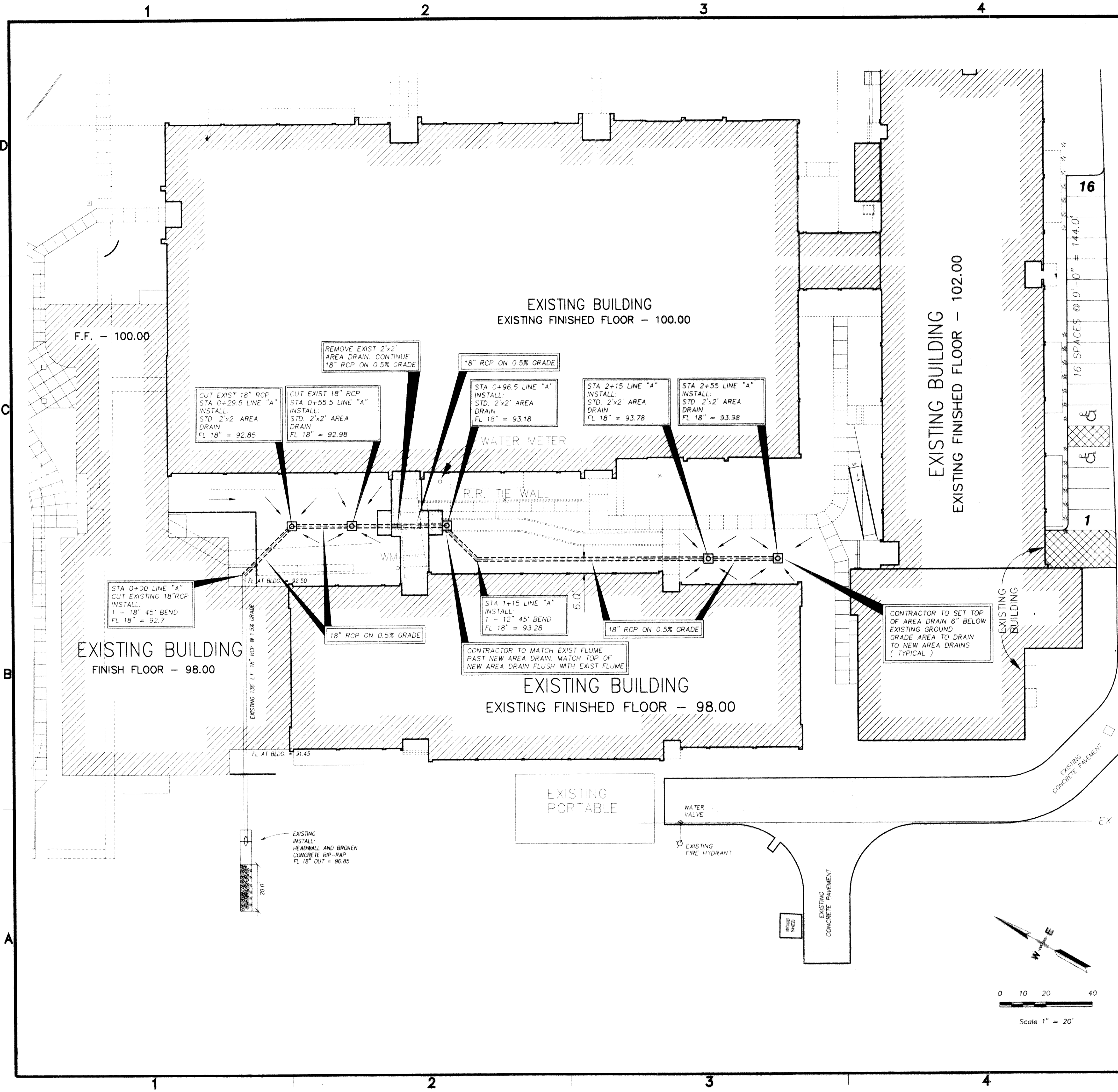

- GENERAL STORM SEWER NOTES
1. ALL CONSTRUCTION TO BE IN ACCORDANCE WITH THESE PLANS AND CITY OF ROCKWALL STANDARDS AND SPECIFICATIONS.
 2. PRIOR TO STARTING CONSTRUCTION, THE CONTRACTOR SHALL MAKE CERTAIN THAT ALL REQUIRED PERMITS AND APPROVALS HAVE BEEN OBTAINED. NO CONSTRUCTION OR FABRICATION SHALL BEGIN UNTIL THE CONTRACTOR HAS RECEIVED AND THOROUGHLY REVIEWED ALL PLANS AND OTHER DOCUMENTS APPROVED BY ALL OF THE PERMITTING AUTHORITIES.
 3. ALL WORK SHALL BE PERFORMED IN ACCORDANCE WITH THESE PLANS AND SPECIFICATIONS AND THE REQUIREMENTS AND STANDARDS OF THE LOCAL GOVERNING AUTHORITY.
 4. IN THE EVENT AN ITEM IS NOT COVERED IN THE CITY OF ROCKWALL SPECIFICATIONS, THE ENGINEER'S DECISION SHALL APPLY.
 5. BARRICADING, TRAFFIC CONTROL, AND PROJECT SIGNS SHALL CONFORM TO "STATE DEPARTMENT OF HIGHWAYS AND PUBLIC TRANSPORTATION BARRICADING AND CONSTRUCTION STANDARDS".
 6. THE GENERAL CONTRACTOR AND ALL SUBCONTRACTORS SHALL VERIFY THE SUITABILITY OF ALL EXISTING AND PROPOSED SITE CONDITIONS INCLUDING GRADES AND DIMENSIONS BEFORE COMMENCEMENT OF ANY CONSTRUCTION. IN THE EVENT OF ANY CONFLICT AND PRIOR TO COMMENCEMENT OF ANY CONSTRUCTION, IMMEDIATELY NOTIFY ENGINEER. MINOR ADJUSTMENTS OF FINISH GRADE TO ACCOMPLISH SPOT DRAINAGE ARE ACCEPTABLE, IF NECESSARY, UPON PRIOR APPROVAL OF ENGINEER. PAVING INSTALLED SHALL FLUSH OUT AT ANY JUNCTURE WITH EXISTING PAVING.
 7. THE LOCATIONS OF UNDERGROUND UTILITIES SHOWN ON THIS PLAN ARE BASED ON FIELD SURVEYS AND LOCAL UTILITY COMPANY RECORDS. IT SHALL BE THE CONTRACTOR'S FULL RESPONSIBILITY TO CONTACT THE VARIOUS UTILITY COMPANIES TO LOCATE THEIR UTILITIES PRIOR TO STARTING CONSTRUCTION.
 8. CONTRACTOR SHALL VERIFY ALL EXISTING INVERTS AND RIM ELEVATIONS PRIOR TO CONSTRUCTION.
 9. ALL RCP SHALL BE CLASS III. ADS WILL NOT BE PERMITTED, MUST BE RCP.
 10. CONTRACTOR SHALL CONNECT ALL EXISTING STORM SEWER TO NEW SEWER, REMOVE AND HAUL OFF EXISTING HEADWALLS.

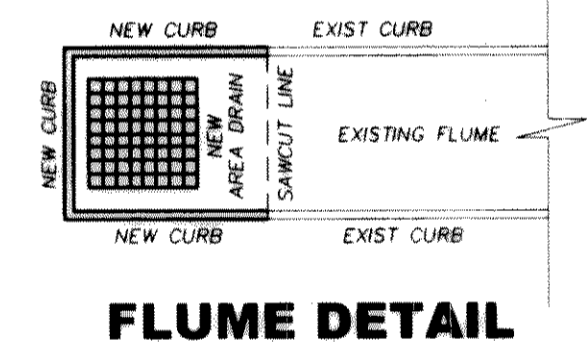

Consultants:

CIVIL:
 Glenn Engineering

STRUCTURAL:
 SHW GROUP, INC.

MEP:
 Estes, McClure and Assoc., Inc.

FOOD SERVICE:
 Hg Rice and Company, Inc.

LANDSCAPING:

Final Plans for Bidding and Construction



PHASE TWO
Administration Facility
Williams MS
Conversion
Rockwall Independent
School District

Project Number: 1441.02.109
 Drawing Date: 05/15/03
 Drawn: R.HOWMAN
 Checked: RAH
 Scale: 1"=30'

ACAD File: WILLIAMS-NEW.dwg
 © 2003 SHW Group, Inc.

Revisions:

| 1 | DESCRIPTION |
|---|-------------|
| | |
| | |
| | |
| | |
| | |

Sheet Title:
STORM PLAN

These Drawings have been modified to conform to the Construction Records.
 Glenn Engineering Corporation
 By *Armijo* Date: 2/10/04

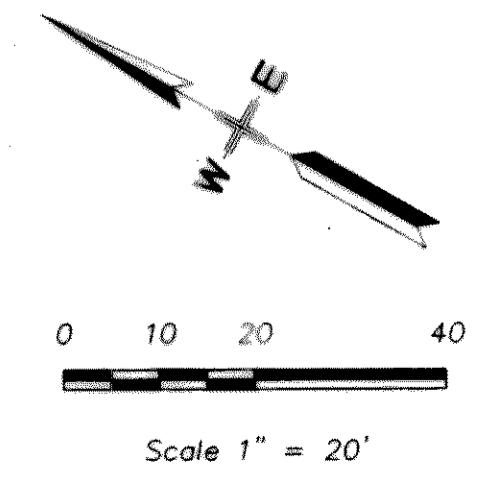

STORM PLAN
 SCALE: 1" = 20'

C2.11