

May 15, 2003 - 12:45pm User: Rick
 \\ROBERT-NT\Drive\ROCKISD\WILLIAMS\2003 ADDITIONS\WORKING\WILLIAMS-NEW.dwg

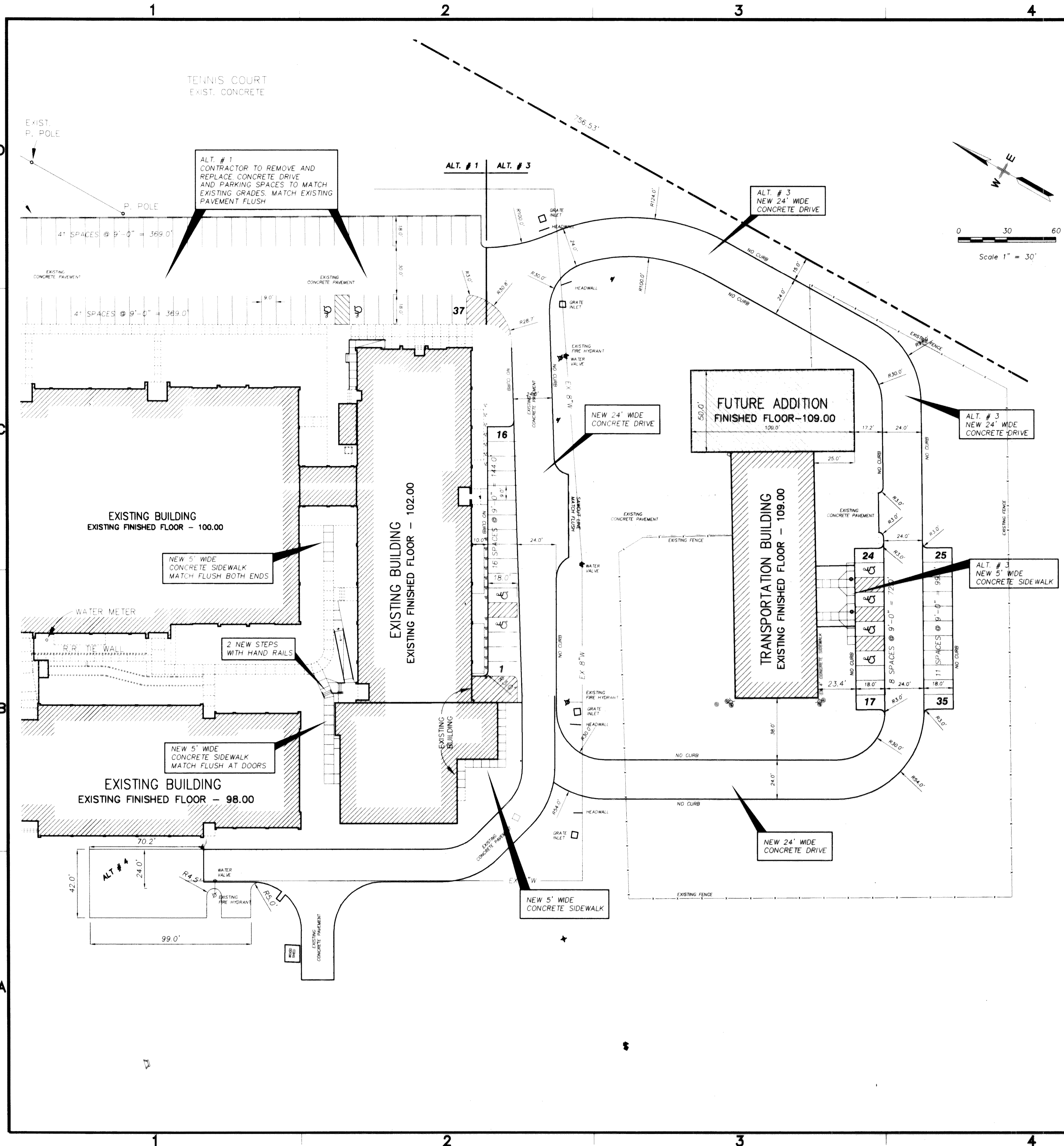

GENERAL NOTES:

1. STRIPING & SIGNAGE DIMENSIONS ARE FROM FACE OF CURB
2. ALL FIRE LANES, PARKING STRIPING, HOCP PARKING STRIPING & SIGNAGE ARE TO BE IN ACCORDANCE WITH CITY OF ROCKWALL REQUIREMENTS, TYP.
3. THE SANITATION CONTAINER SCREENING WALLS WILL BE THE SAME COLOR, MATERIAL, AND TEXTURE AS THE EXTERIOR WALLS OF THE PROPOSED BUILDING, INCLUDING A METAL GATE, PRIMED AND PAINTED, SUBJECT TO REVIEW AND APPROVAL BY THE CITY PLANNER.
4. THE SANITATION CONTAINER SCREENING WALLS, GATE, AND PAD SITE TO BE CONSTRUCTED IN ACCORDANCE WITH THE CITY OF ROCKWALL DESIGN SPECIFICATIONS, SUBJECT TO REVIEW AND APPROVAL BY THE SANITATION COORDINATOR.
5. THE PROPOSED LIGHTING FOR THE SUBJECT PROPERTY IS IN CONFORMANCE WITH THE LIGHTING AND GLARE REGULATIONS AS SPECIFIED WITHIN SECTION 41-106 OF THE CITY OF ROCKWALL CODE OF ORDINANCES.
6. THE SITE SHALL CONFORM TO THE CITY OF ROCKWALL STORM WATER MANAGEMENT ORDINANCE, DETENTION FOR THE SITE PROVIDED WITHIN THE EXISTING DETENTION BASIN (LOT 1 BLOCK 2 1.982 AC.) TO THE WEST OF THE SITE.

GENERAL NOTES:

1. PRIOR TO ANY CONSTRUCTION THE CONTRACTOR SHALL FAMILIARIZE HIMSELF WITH THE CONTRACT DOCUMENTS AND SPECIFICATIONS, THE PLANS INCLUDING ALL NOTES, THE CITY OF ROCKWALL SPECIFICATIONS AND ANY OTHER APPLICABLE STANDARDS OR SPECIFICATIONS RELEVANT TO THE PROPER COMPLETION OF THE WORK SPECIFIED. FAILURE ON THE PART OF THE CONTRACTOR TO FAMILIARIZE HIMSELF WITH ALL STANDARDS OR SPECIFICATIONS PERTAINING TO THIS WORK SHALL IN NO WAY RELIEVE THE CONTRACTOR OF RESPONSIBILITY FOR PERFORMING THE WORK IN ACCORDANCE WITH ALL SUCH APPLICABLE STANDARDS AND SPECIFICATIONS.
2. CONTRACTOR SHALL HAVE IN HIS POSSESSION, PRIOR TO CONSTRUCTION, ALL NECESSARY PERMITS, LICENSES, ETC. CONTRACTOR SHALL HAVE AT LEAST ONE SET OF APPROVED ENGINEERING PLANS AND SPECIFICATIONS ON-SITE AT ALL TIMES.
3. ALL WORK SHALL CONFORM TO THE CITY OF ROCKWALL SPECIFICATIONS, STANDARDS, AND DETAILS.
4. IF UNFORESEEN PROBLEMS OR CONFLICTS ARE ENCOUNTERED IN THE CONSTRUCTION, FOR WHICH AN IMMEDIATE SOLUTION IS NOT APPARENT, THE ENGINEER AND OWNER SHALL BE NOTIFIED IMMEDIATELY.
5. IT WILL BE THE RESPONSIBILITY OF EACH CONTRACTOR TO PROTECT ALL EXISTING PUBLIC AND PRIVATE UTILITIES THROUGHOUT THE CONSTRUCTION OF THIS PROJECT. CONTRACTOR SHALL CONTACT THE APPROPRIATE UTILITY COMPANIES FOR LINE LOCATIONS, PRIOR TO COMMENCEMENT OF CONSTRUCTION AND SHALL ASSUME FULL LIABILITY TO THOSE COMPANIES FOR ANY DAMAGES CAUSED TO THEIR FACILITIES.
6. CONTRACTORS SHALL BE RESPONSIBLE FOR FIELD LOCATING EXISTING UTILITIES AND IMPROVEMENTS PRIOR TO CONSTRUCTION.
7. TRENCH SAFETY DESIGN WILL BE THE RESPONSIBILITY OF THE UTILITY CONTRACTOR. CONTRACTOR SHALL SUBMIT DESIGN TO THE CITY OF ROCKWALL ENGINEERING DEPARTMENT FOR REVIEW.



Consultants:
 CIVIL:
 Glenn Engineering
 STRUCTURAL:
 SHW GROUP, INC.
 MEP:
 Estes, McClure and Assoc., Inc.
 FOOD SERVICE:
 Hg Rice and Company, Inc.
 LANDSCAPING:

Final Plans for Bidding and Construction



**PHASE TWO
 Administration Facility
 Williams MS
 Conversion
 Rockwall Independent
 School District**

Project Number: 1441.02.109
 Drawing Date: 05/15/03
 Drawn: R.HOWMAN
 Checked: RAH
 Scale: 1"=30'
 ACAD File: WILLIAMS-NEW.dwg
 © 2003 SHW Group, Inc.

Revisions:

1	DESCRIPTION

These Drawings have been modified to conform to the Construction Records.
 Glenn Engineering Corporation
 By: *Cheryl Ann Armijo* Date: 1-21-04

**ALT. # 3
 SITE PLAN EAST**
 SCALE: 1" = 30'

C2.4