

1

2

3

4

5

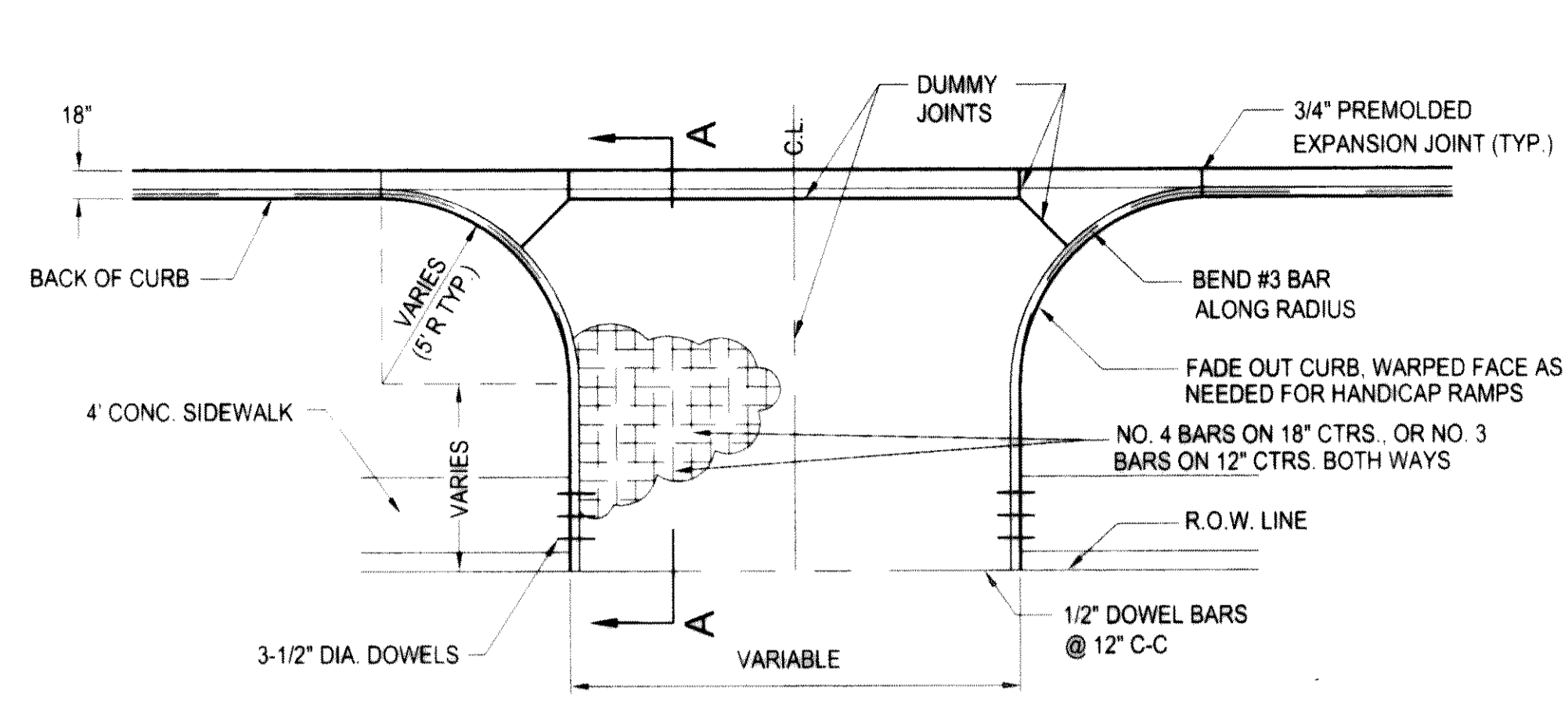

TYPICAL DRIVE APPROACH
SCALE: 1/8" = 1'-0"

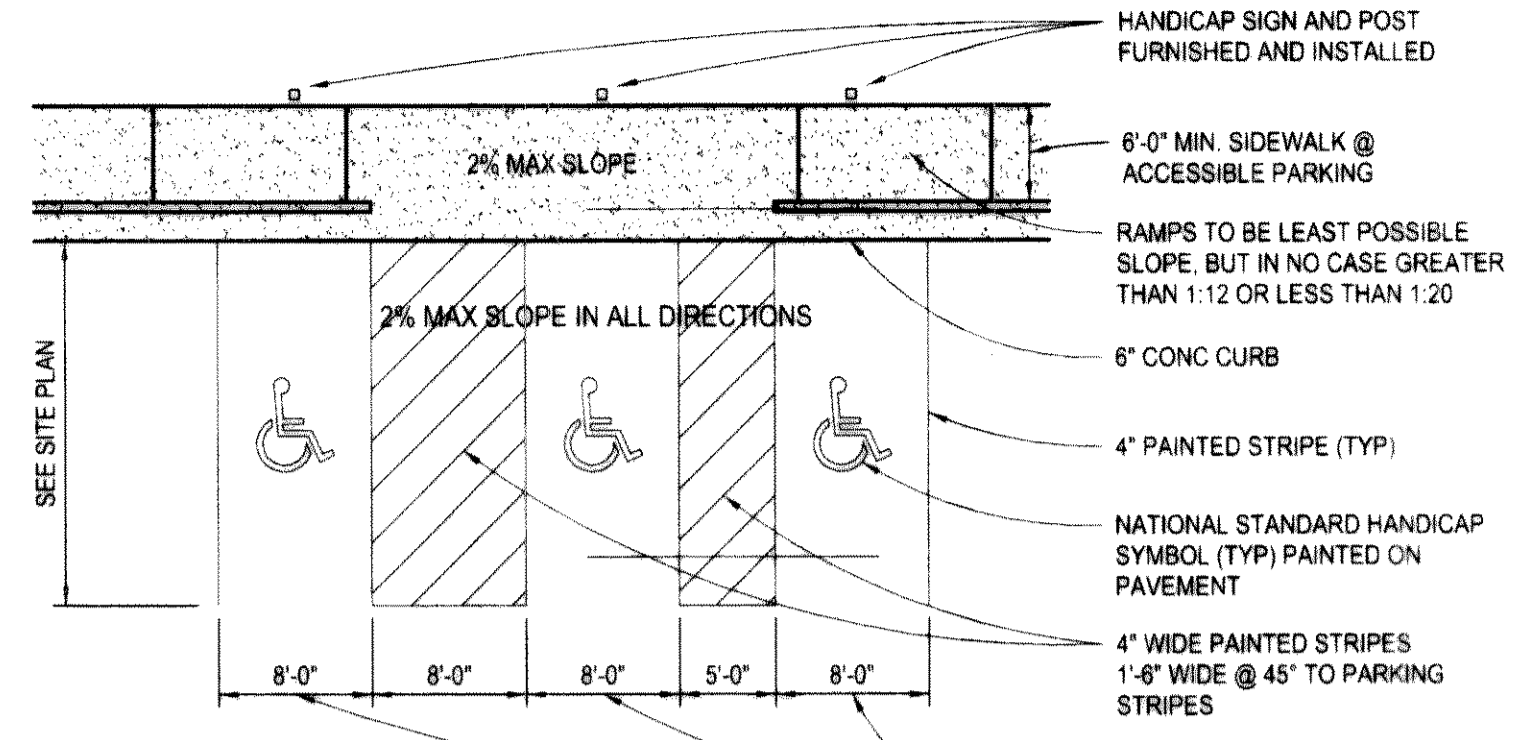

ACCESSIBLE PARKING STALL DETAILS
NOTE: PARKING STALL DIMENSIONS TO BE IN ACCORDANCE WITH A.D.A. OR APPROPRIATE GOVERNING AUTHORITY'S STANDARDS, WHICHEVER IS MORE RESTRICTIVE. MAX SLOPE 2%.

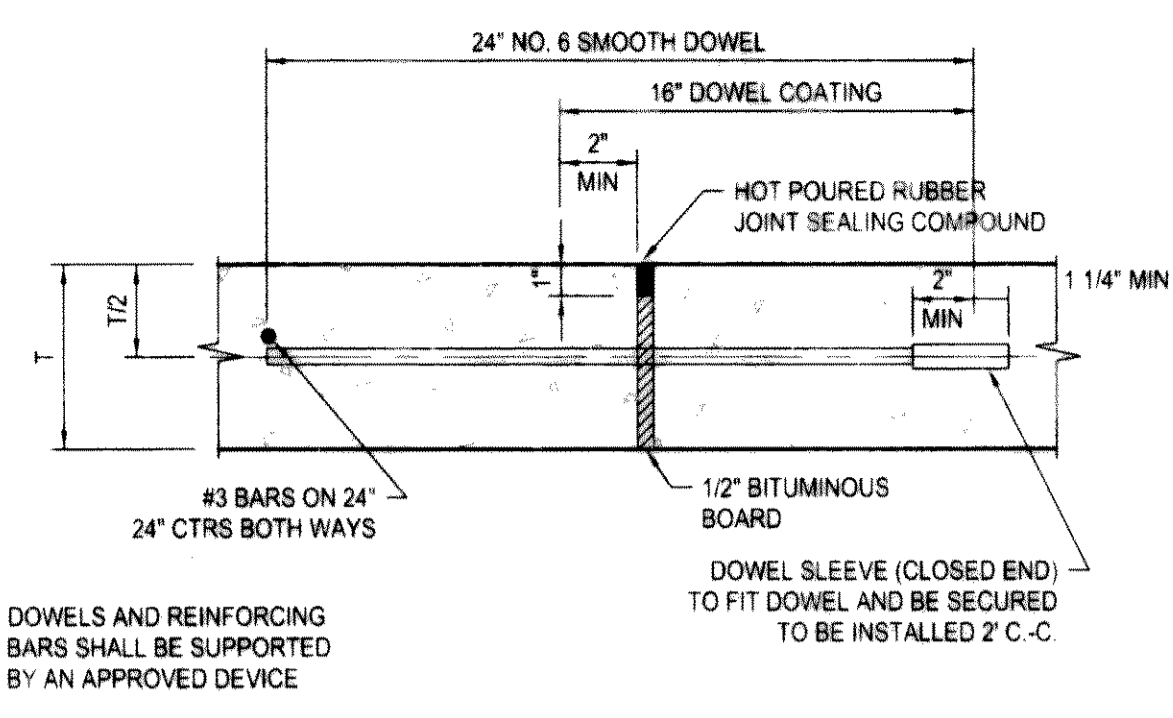

EXPANSION JOINT DETAIL
NTS MAXIMUM SPACING = 60 FEET

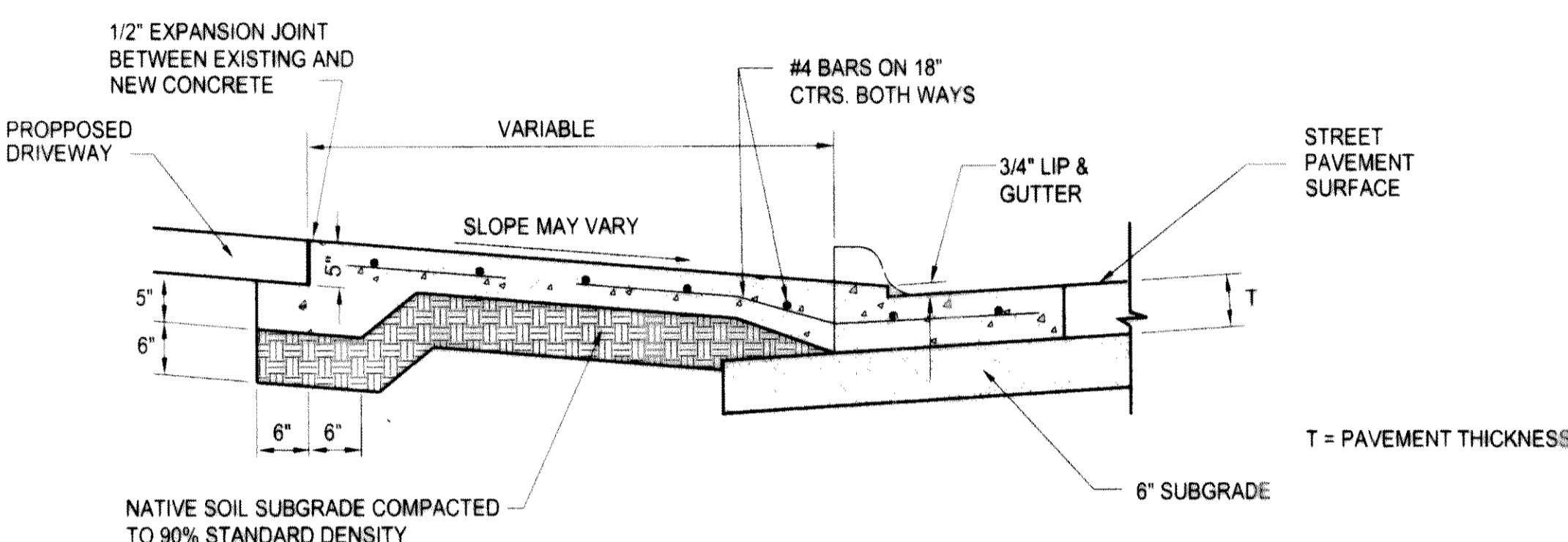

SECTION A-A
(FOR TYPICAL DRIVE APPROACH)
SCALE: 3/4" = 1'-0"

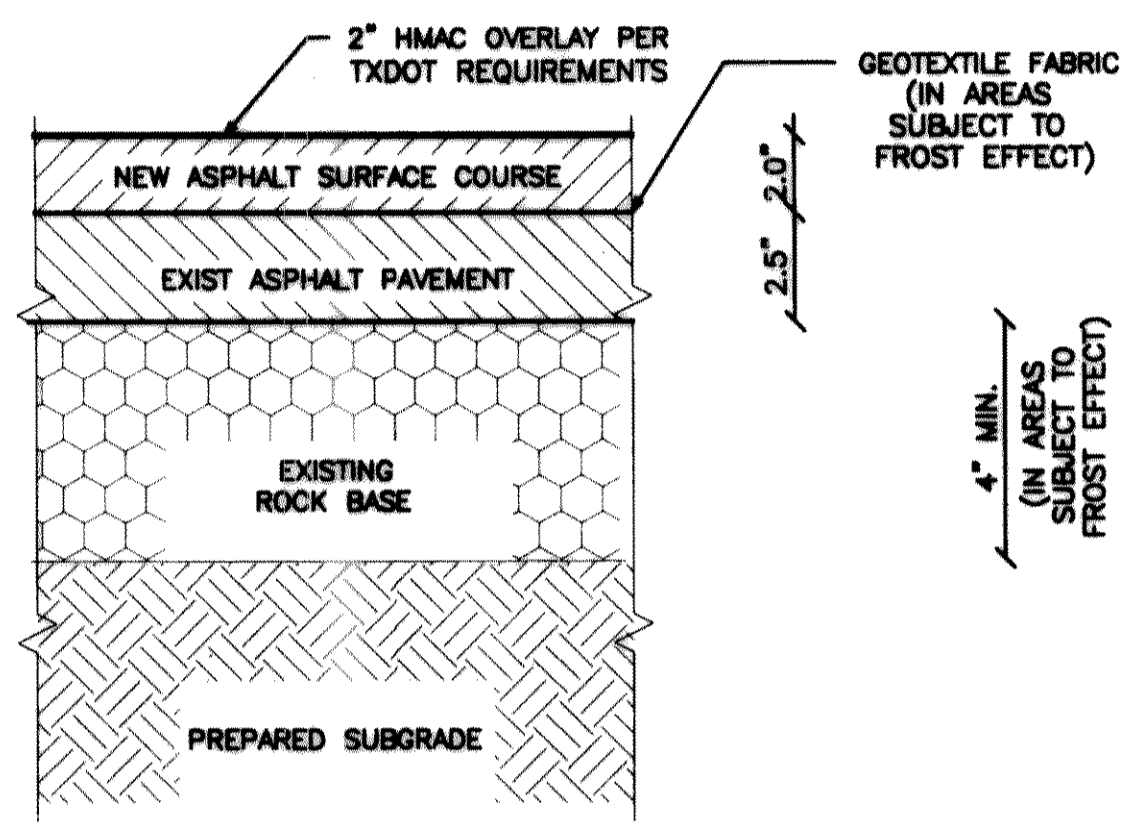

ASPHALT SECTION - ALT. # 2

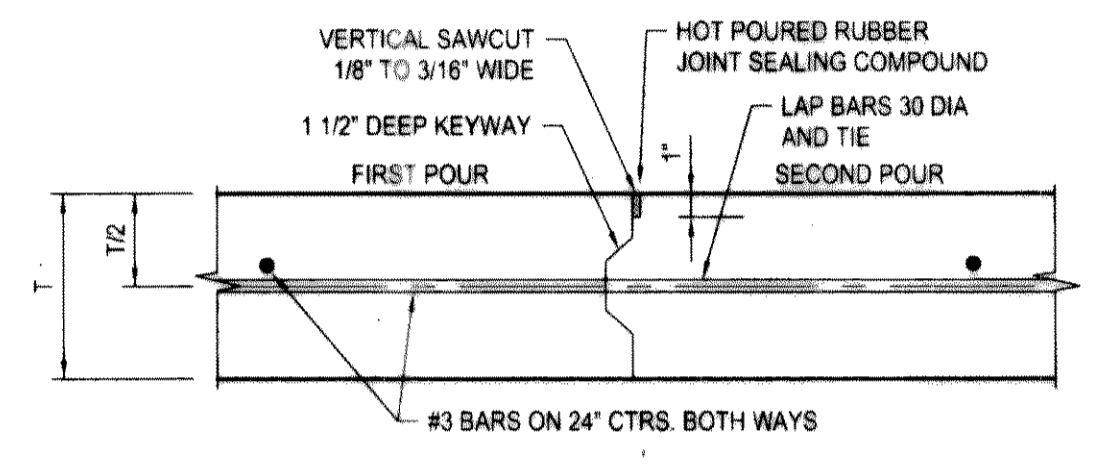

CONSTRUCTION JOINT DETAIL (L)
NTS

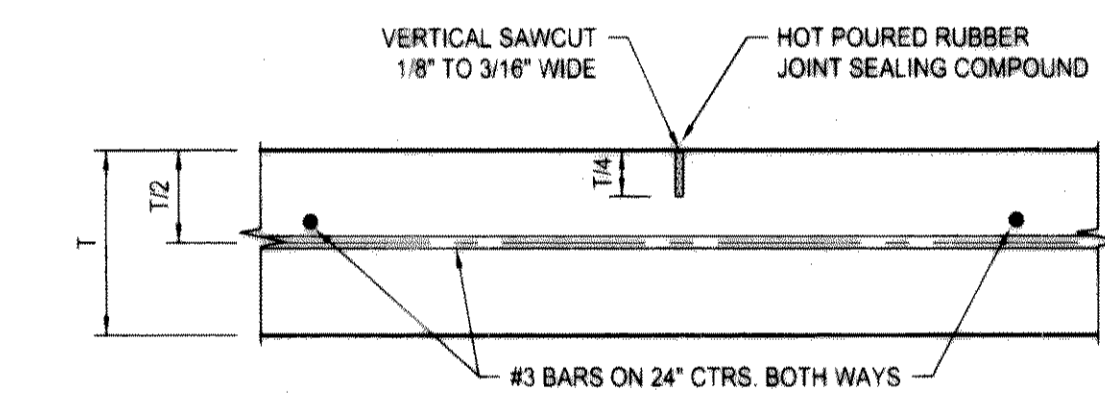

SAWED DUMMY JOINT DETAIL (T)
NTS MAXIMUM SPACING = 15 FEET

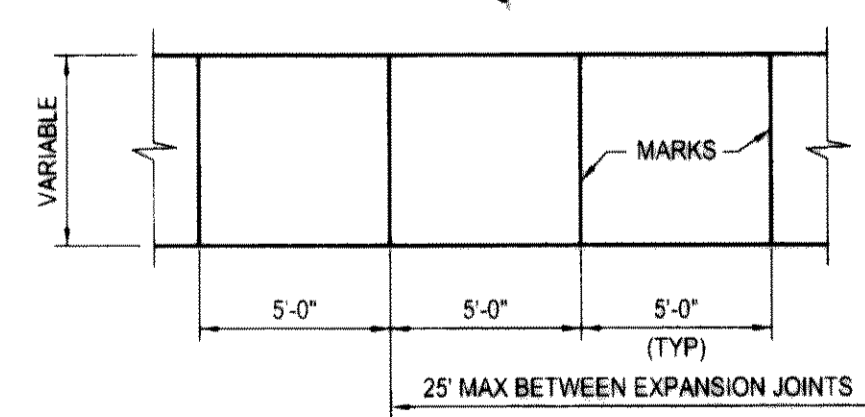

SIDEWALK PLAN
NTS

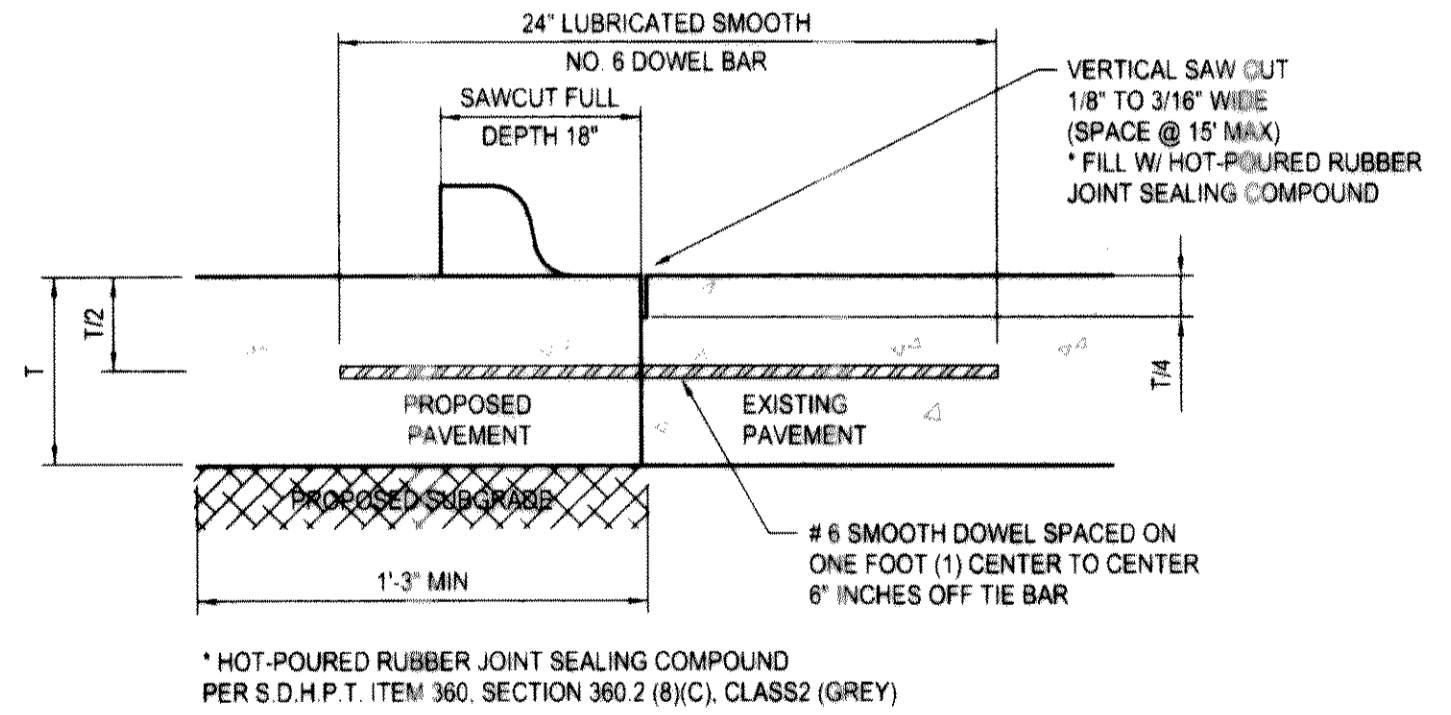

TO BE USED WHERE PROPOSED CONCRETE PAVEMENT MEETS EXISTING CONCRETE PAVEMENT

- NOTES:
- NO. 5 SMOOTH DOWEL BAR MAY BE USED IN 5", 6" AND 7" PAVEMENT THICKNESS.
 - LONGITUDINAL BUTT CONSTRUCTION MAY BE UTILIZED IN PLACE OF LONGITUDINAL HINGED (KEYWAY) JOINT AT CONTRACTOR'S OPTION.
 - DOWEL BARS SHALL BE DRILLED INTO PAVEMENT HORIZONTALLY BY USE OF A MECHANICAL RIG. DRILLING BY HAND IS NOT APPLICABLE. PUSHING DOWEL BARS INTO GREEN CONCRETE IS NOT ACCEPTABLE.

LONGITUDINAL BUTT DETAIL
NTS

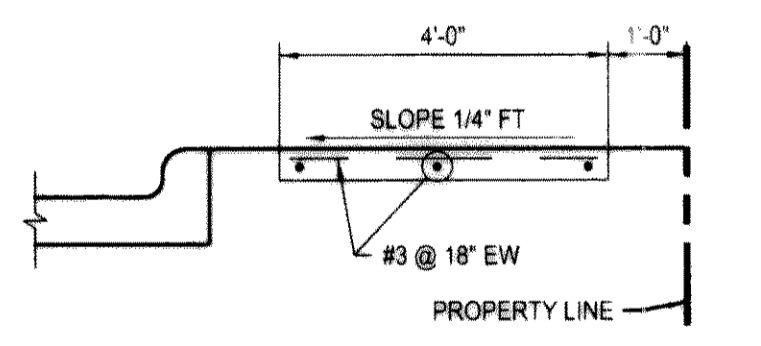

WALK/BUILDING/CURB INTERFACE
NTS

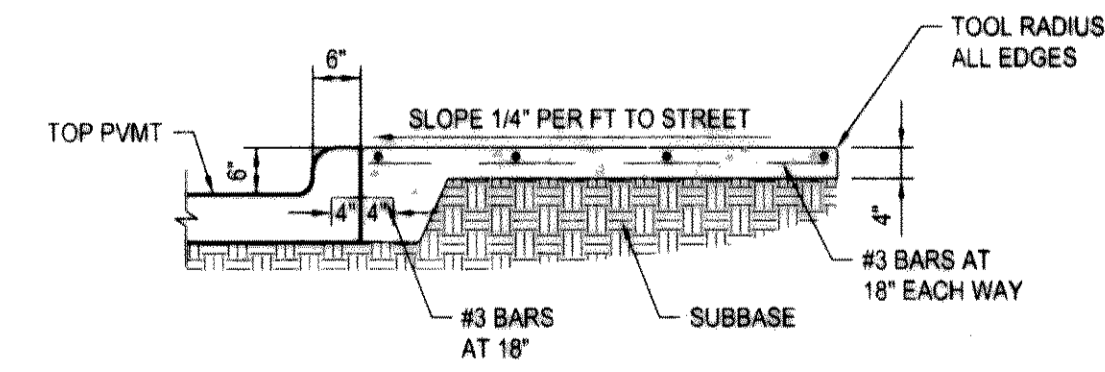

INTERIOR SIDEWALK TYPICAL SECTION
NTS



Consultants:
CIVIL: Glenn Engineering
STRUCTURAL: SHW GROUP, INC.
MEP: Estes, McClure and Assoc., Inc
FOOD SERVICE: Hg Rice and Company, Inc
LANDSCAPING:
Final Plans for Bidding and Construction

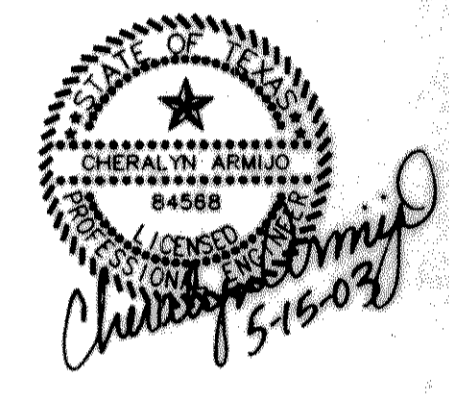

PHASE TWO
Administration Facility
Williams MS
Conversion
Rockwall Independent
School District

Project Number: 1441.02.109
Drawing Date: 05/15/03
Drawn: R.HOWMAN
Checked: RAH
Scale: 1"=30'
ACAD File: WILLIAMS-NEW.dwg
© 2003 SHW Group, Inc.

Revisions:	DESCRIPTION
1	

Sheet Title:
PAVING
DETAILS

These Drawings have been modified to conform to the Construction Records.
Glenn Engineering Corporation
By *Wm...* Date: 1-21-04

C2.18

May 15, 2003 11:31am User: Rick \\ROBERT-NT-D-Drive\ROCKISD\WILLIAMS\2003 ADDITIONS\WORKING\WILLIAMS-NEW.dwg