

May 15, 2003 - 11:36am User: Rick
 \\ROBERT-NT-D-Drive\ROCKISD\WILLIAMS\2003 ADDITIONS\WORKING\WILLIAMS-NEW.dwg

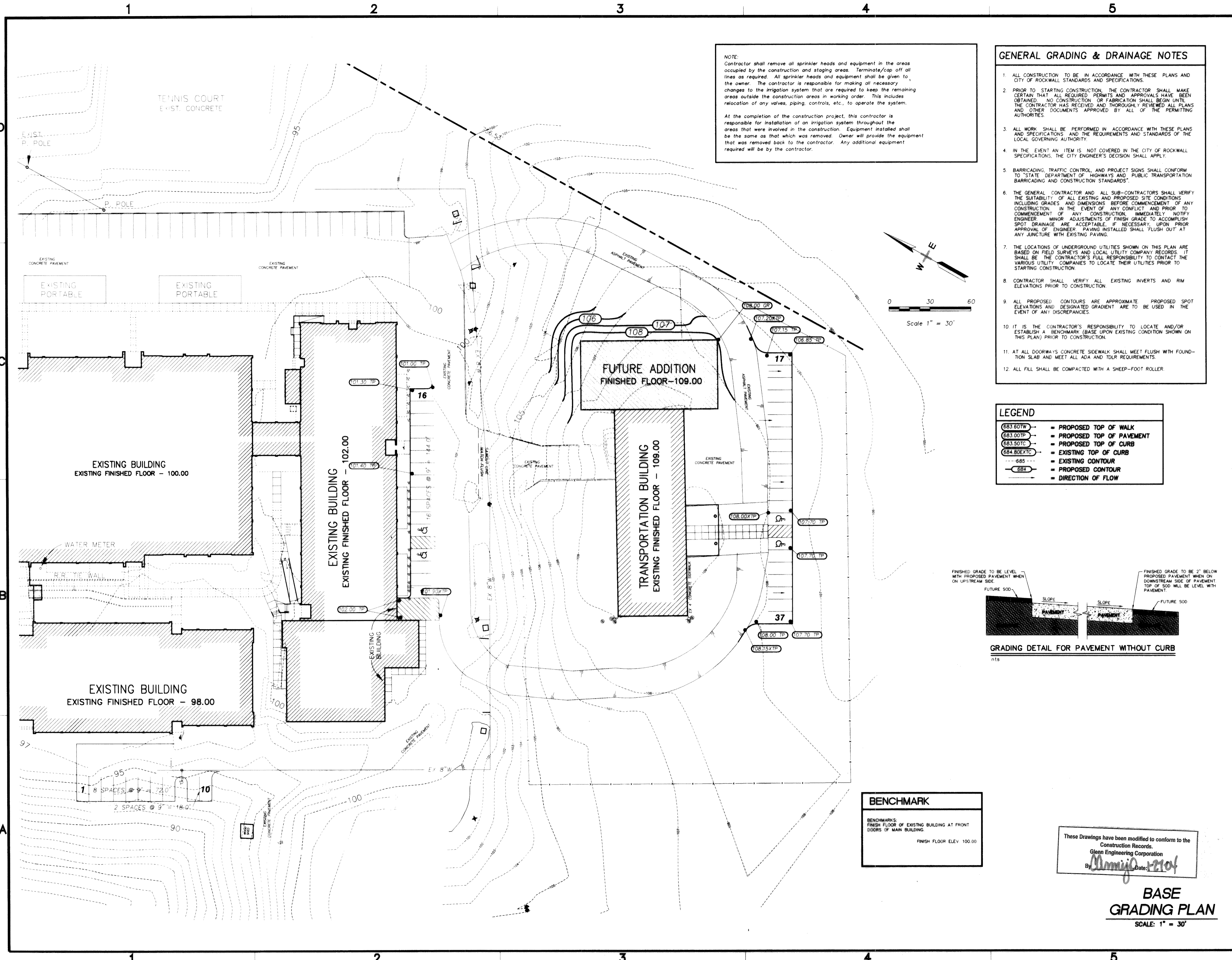

NOTE:
 Contractor shall remove all sprinkler heads and equipment in the areas occupied by the construction and staging areas. Terminate/cap off all lines as required. All sprinkler heads and equipment shall be given to the owner. The contractor is responsible for making all necessary changes to the irrigation system that are required to keep the remaining areas outside the construction areas in working order. This includes relocation of any valves, piping, controls, etc. to operate the system.
 At the completion of the construction project, this contractor is responsible for installation of an irrigation system throughout the areas that were involved in the construction. Equipment installed shall be the same as that which was removed. Owner will provide the equipment that was removed back to the contractor. Any additional equipment required will be by the contractor.

GENERAL GRADING & DRAINAGE NOTES

- ALL CONSTRUCTION TO BE IN ACCORDANCE WITH THESE PLANS AND CITY OF ROCKWALL STANDARDS AND SPECIFICATIONS.
- PRIOR TO STARTING CONSTRUCTION, THE CONTRACTOR SHALL MAKE CERTAIN THAT ALL REQUIRED PERMITS AND APPROVALS HAVE BEEN OBTAINED. NO CONSTRUCTION OR FABRICATION SHALL BEGIN UNTIL THE CONTRACTOR HAS RECEIVED AND THOROUGHLY REVIEWED ALL PLANS AND OTHER DOCUMENTS APPROVED BY ALL OF THE PERMITTING AUTHORITIES.
- ALL WORK SHALL BE PERFORMED IN ACCORDANCE WITH THESE PLANS AND SPECIFICATIONS AND THE REQUIREMENTS AND STANDARDS OF THE LOCAL GOVERNING AUTHORITY.
- IN THE EVENT AN ITEM IS NOT COVERED IN THE CITY OF ROCKWALL SPECIFICATIONS, THE CITY ENGINEER'S DECISION SHALL APPLY.
- BARRICADING, TRAFFIC CONTROL, AND PROJECT SIGNS SHALL CONFORM TO "STATE DEPARTMENT OF HIGHWAYS AND PUBLIC TRANSPORTATION BARRICADING AND CONSTRUCTION STANDARDS".
- THE GENERAL CONTRACTOR AND ALL SUB-CONTRACTORS SHALL VERIFY THE SUITABILITY OF ALL EXISTING AND PROPOSED SITE CONDITIONS INCLUDING GRADES AND DIMENSIONS BEFORE COMMENCEMENT OF ANY CONSTRUCTION. IN THE EVENT OF ANY CONFLICT AND PRIOR TO COMMENCEMENT OF ANY CONSTRUCTION, IMMEDIATELY NOTIFY ENGINEER. MINOR ADJUSTMENTS OF FINISH GRADE TO ACCOMPLISH SPOT DRAINAGE ARE ACCEPTABLE. IF NECESSARY, UPON PRIOR APPROVAL OF ENGINEER, PAVING INSTALLED SHALL FLUSH OUT AT ANY JUNCTURE WITH EXISTING PAVING.
- THE LOCATIONS OF UNDERGROUND UTILITIES SHOWN ON THIS PLAN ARE BASED ON FIELD SURVEYS AND LOCAL UTILITY COMPANY RECORDS. IT SHALL BE THE CONTRACTOR'S FULL RESPONSIBILITY TO CONTACT THE VARIOUS UTILITY COMPANIES TO LOCATE THEIR UTILITIES PRIOR TO STARTING CONSTRUCTION.
- CONTRACTOR SHALL VERIFY ALL EXISTING INVERTS AND RIM ELEVATIONS PRIOR TO CONSTRUCTION.
- ALL PROPOSED CONTOURS ARE APPROXIMATE. PROPOSED SPOT ELEVATIONS AND DESIGNATED GRADIENT ARE TO BE USED IN THE EVENT OF ANY DISCREPANCIES.
- IT IS THE CONTRACTOR'S RESPONSIBILITY TO LOCATE AND/OR ESTABLISH A BENCHMARK (BASE UPON EXISTING CONDITION SHOWN ON THIS PLAN) PRIOR TO CONSTRUCTION.
- AT ALL DOORWAYS CONCRETE SIDEWALK SHALL MEET FLUSH WITH FOUNDATION SLAB AND MEET ALL ADA AND TDR REQUIREMENTS.
- ALL FILL SHALL BE COMPACTED WITH A SHEEP-FOOT ROLLER.

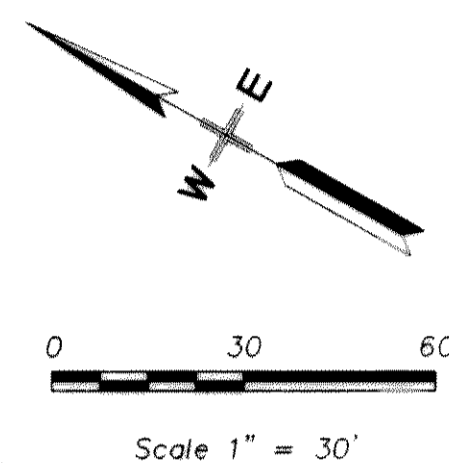

LEGEND

683.60TW	= PROPOSED TOP OF WALK
683.00TP	= PROPOSED TOP OF PAVEMENT
683.50TC	= PROPOSED TOP OF CURB
684.80EXTC	= EXISTING TOP OF CURB
---	= EXISTING CONTOUR
---	= PROPOSED CONTOUR
---	= DIRECTION OF FLOW

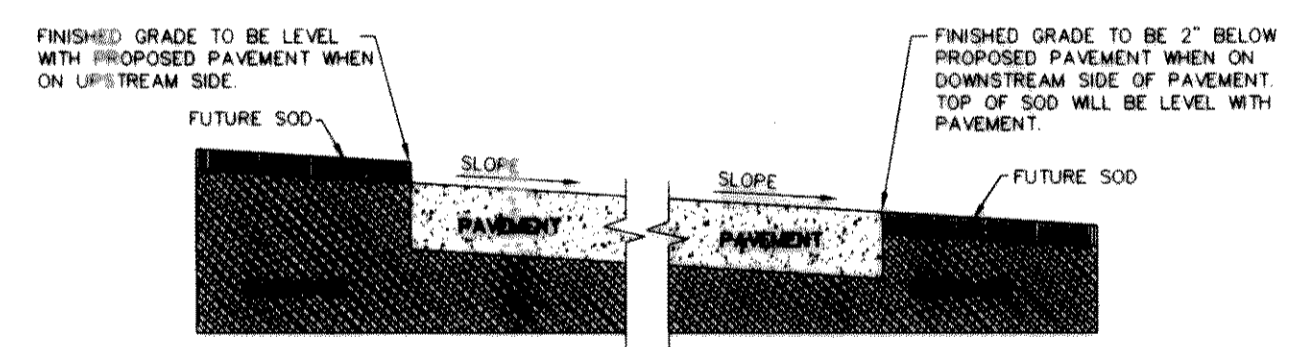

BENCHMARK
 BENCHMARKS:
 FINISH FLOOR OF EXISTING BUILDING AT FRONT DOORS OF MAIN BUILDING.
 FINISH FLOOR ELEV. 100.00

These Drawings have been modified to conform to the Construction Records.
 Glenn Engineering Corporation
 By *Almijig* Date: 12/04

BASE GRADING PLAN
 SCALE: 1" = 30'

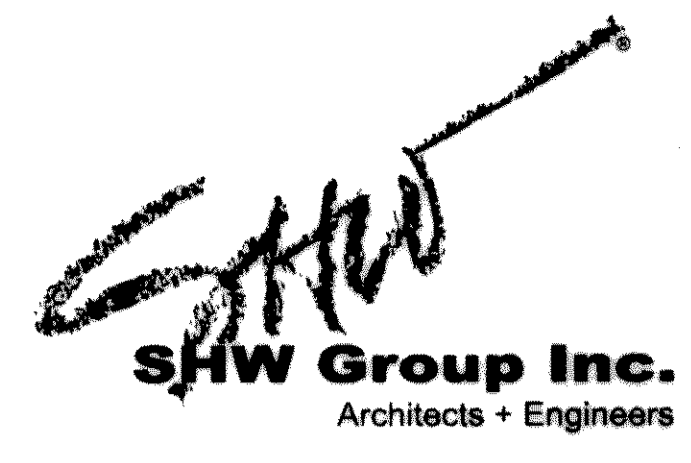

Consultants:
 CIVIL:
 Glenn Engineering
 STRUCTURAL:
 SHW GROUP, INC.
 MEP:
 Estes, McClure and Assoc., Inc.
 FOOD SERVICE:
 Hg Rice and Company, Inc.
 LANDSCAPING:



PHASE TWO
Administration Facility
Williams MS
Conversion
Independent
School District

Project Number: 1441.02.109
 Drawing Date: 05/15/03
 Drawn: R.HOWMAN
 Checked: RAH
 Scale: 1"=30'
 ACAD File: WILLIAMS-NEW.dwg
 © 2003 SHW Group, Inc.

Revisions:

1	DESCRIPTION

Sheet Title:
GRADING PLAN

C2.6