

08/17/1995 * 13:09 * Y:\ACAD\005\0485417\REV\HW2_3R
PLOT DATE/TIME

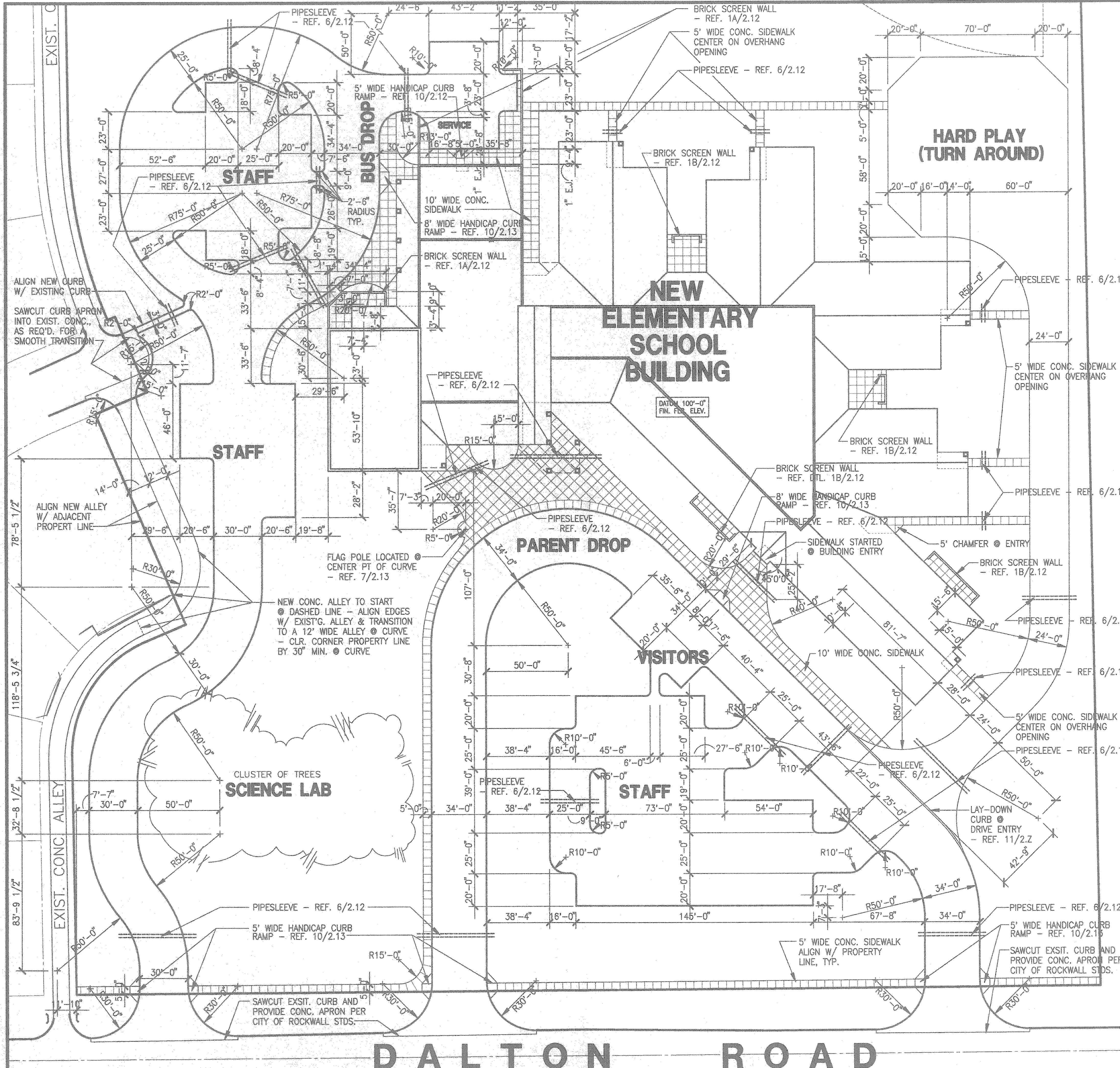

DALTON ROAD

- ### GENERAL NOTES
- PAVING DIMENSIONS ARE INDICATED TO THE BACK OF CURB, U.O.N.
 - 1/2" EXPANSION JOINTS WITH COMPRESSIBLE FILLER AND AND TRAFFIC GRADE NON-TRACKING SEALANT SHALL BE CONSTRUCTED WHERE PAVEMENT INTERFACES WITH ANY STRUCTURES.
 - ALL SIDEWALKS INDICATED ON THIS PLAN ARE TO BE 4" THICK CONCRETE, PER DETAIL 10/2.12. TOOLED CONTROL JOINTS, @ 5'-0" O.C. MAXIMUM. PROVIDE 1x CONSTRUCTION GRADE REDWOOD DIVIDERS @ 20'-0" O.C. AT ALL SIDEWALKS AND PROVIDE 18" LONG No.3 REBARS AT 18" O.C. ACROSS THE LENGTH
 - REFER TO 1/1.2 FOR OVERALL BUILDING DIMENSIONS. RADIUS DIMENSION ONLY, U.O.N., TYP.
 - ALL CURB RADI NOT INDICATED ARE TO BE 5'-0" TO B.O.C., TYP. VERIFY WITH ARCHITECT IF RADIUS DOES NOT APPEAR APPROPRIATE, TYP.
 - RADIUS POINTS @ 90° TURNS ARE LOCATED BY THEIR RADIUS DIMENSION, TYP.
 - ALL SIDEWALK ARE 5'-0" WIDE, U.O.N.
 - PROVIDE PAVED PADS @ ALL MECH. YARDS W/ MASONRY SCREEN WALLS W/ C.J.S. @ 5'-0" O.C., TYP.

DATE 26/JUN/95
 DRAWN BY JMB
 CHECKED
 COIN NO 0485417
 REVISED 8/11/95

NEBBIE WILLIAMS ELEMENTARY SCHOOL ROCKWALL INDEPENDENT SCHOOL DISTRICT ROCKWALL, TEXAS

FINAL PLANS FOR BIDDING AND CONSTRUCTION

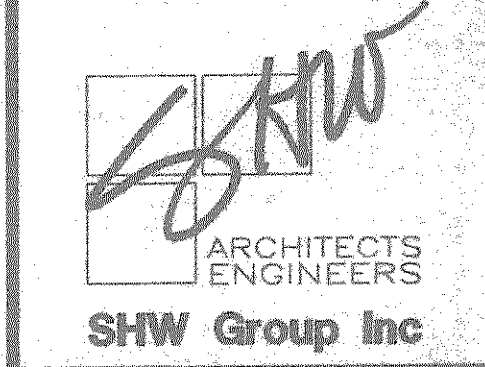
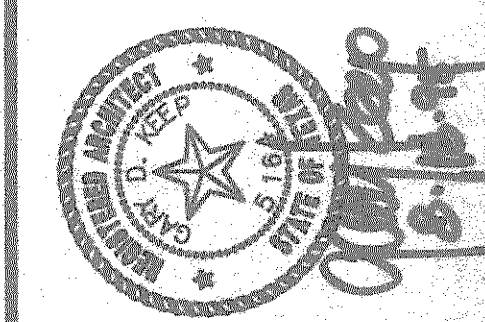

SHEET NUMBER **C 2.3**
 OF 13
 SET NUMBER