

**NEBBIE WILLIAMS ELEMENTARY SCHOOL  
 ROCKWALL INDEPENDENT SCHOOL DISTRICT  
 ROCKWALL, TEXAS**

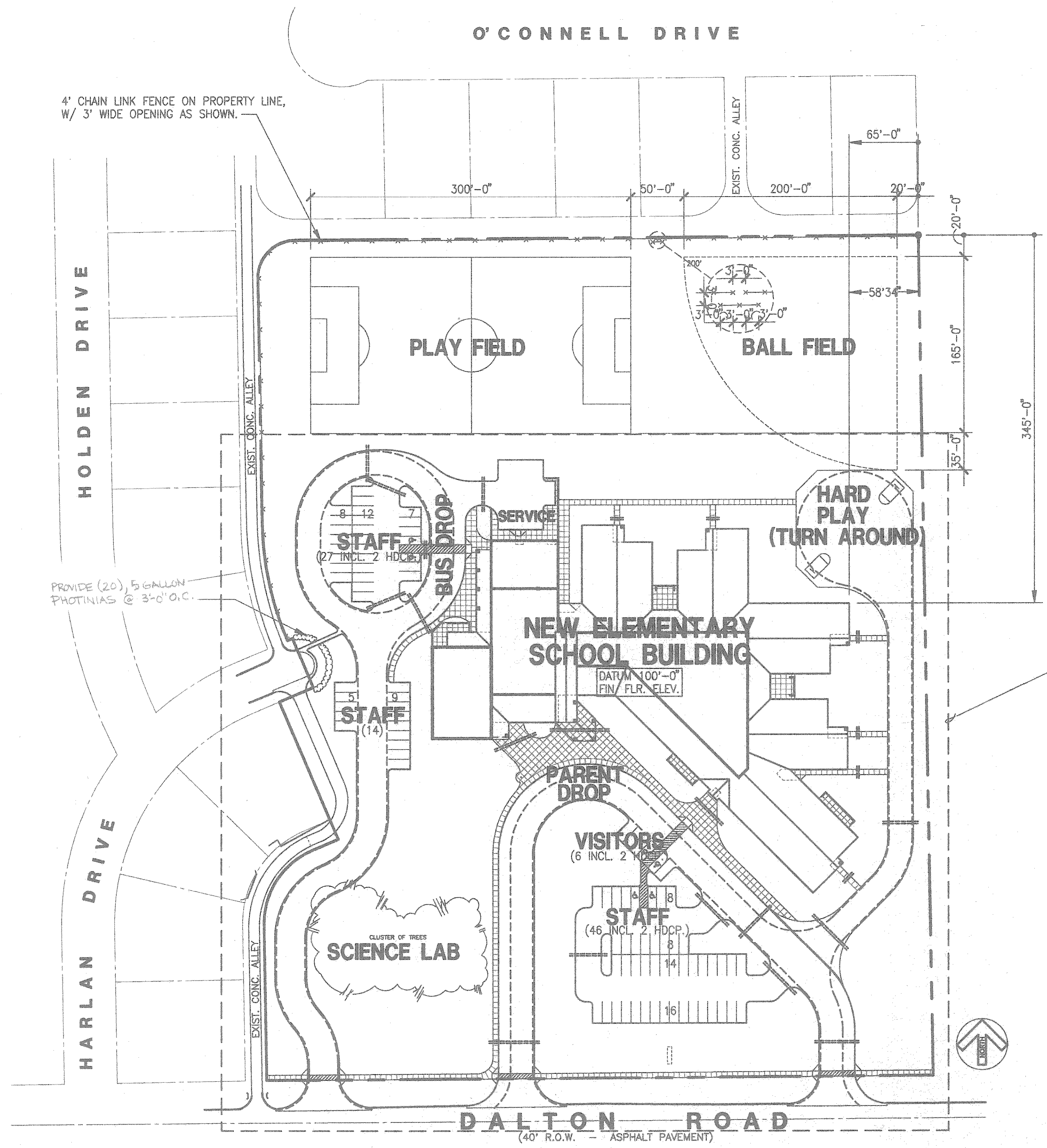

REFER TO SHEET 2.3 FOR ADDITIONAL INFORMATION WITHIN THIS AREA

- GENERAL NOTES**
- PAVING DIMENSIONS ARE INDICATED TO THE BACK OF CURB, U.O.N..
  - 1/2" EXPANSION JOINTS WITH COMPRESSIBLE FILLER AND AND TRAFFIC GRADE NON-TRACKING SEALANT SHALL BE CONSTRUCTED WHERE PAVEMENT INTERFACES WITH ANY STRUCTURES.
  - ALL SIDEWALKS INDICATED ON THIS PLAN ARE TO BE 4" THICK CONCRETE, PER DETAIL 10/2.12. TOOLED CONTROL JOINTS, @ 5'-0" O.C. MAXIMUM. PROVIDE 1x CONSTRUCTION GRADE REDWOOD DIVIDERS @ 20'-0" O.C. AT ALL SIDEWALKS AND PROVIDE 18" LONG No.3 REBARS AT 18" O.C. ACROSS THE LENGTH OF THE REDWOOD DIVIDER.
  - REFER TO 1/1.2 FOR OVERALL BUILDING DIMENSIONS.

**PARKING DATA**  
 85 STANDARD PARKING SPACES PROVIDED  
 6 HDCP PARKING SPACES PROVIDED  
 91 TOTAL PARKING SPACES PROVIDED

**1 ARCHITECTURAL OVERALL HORIZONTAL CONTROL PLAN**  
 2.2 1:60

FINAL PLANS FOR BIDDING AND CONSTRUCTION

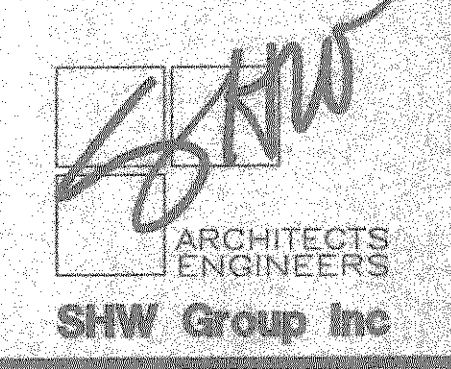
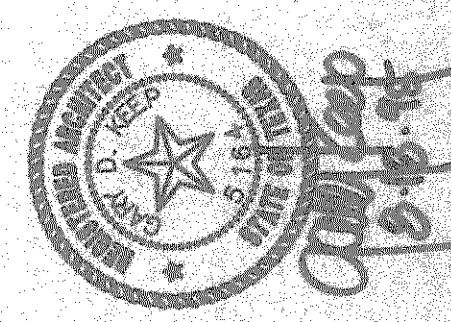

SHEET NUMBER	C
OF 13	2.2
SET NUMBER	