

**BARRIER FREE RAMP DETAIL**

NOTE: PARKING STALL DIMENSIONS TO BE IN ACCORDANCE WITH A.D.A. OR APPROPRIATE GOVERNING AUTHORITIES STANDARDS, WHICHEVER IS MORE RESTRICTIVE.

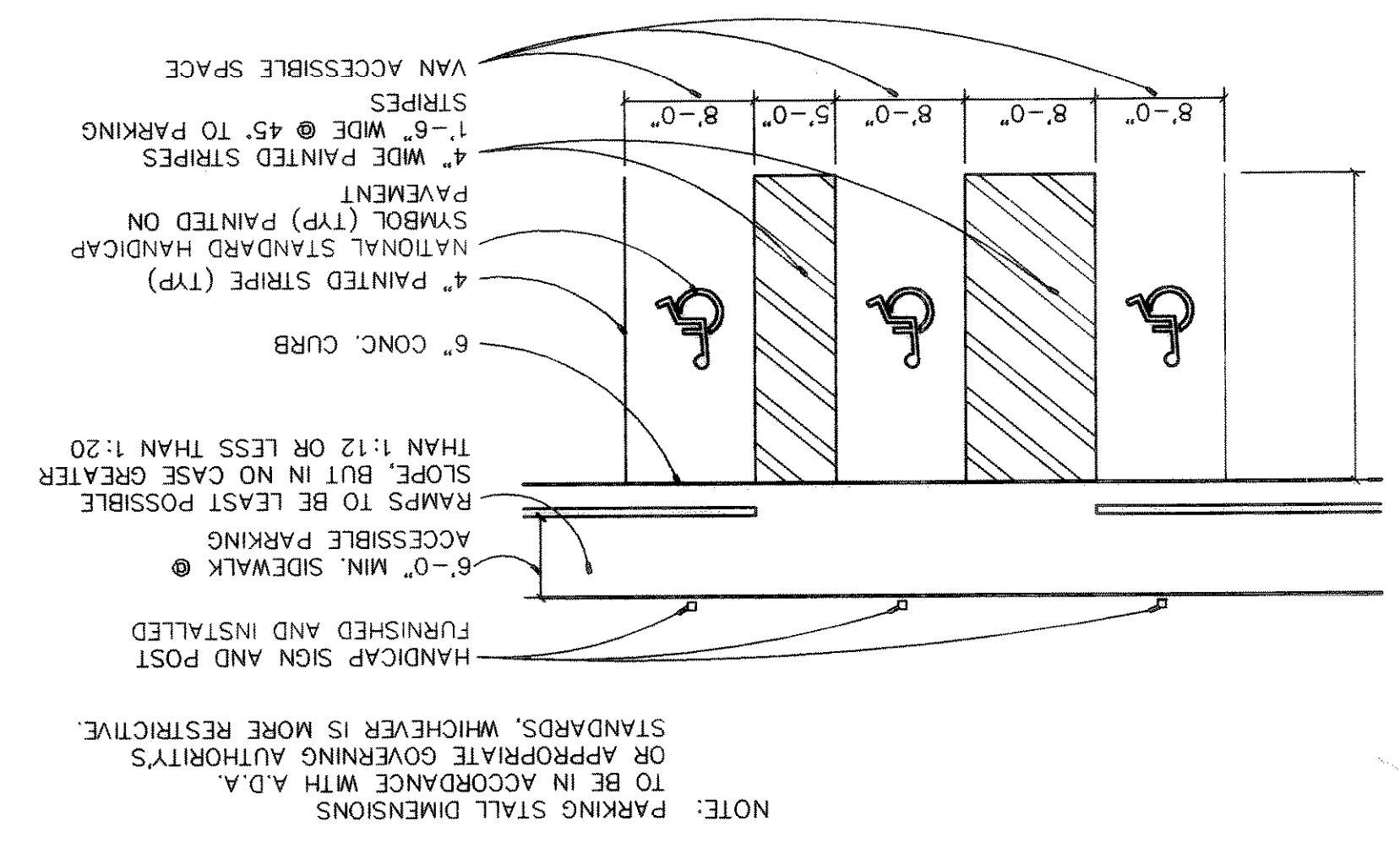

**ACCESSIBLE PARKING STALL DETAILS**

FOR 'X' DIM. PURPOSES ONLY.

PROVIDE NEW "ADA" COMPLIANT "DETECTABLE/TACTILE WARNING" UNIT

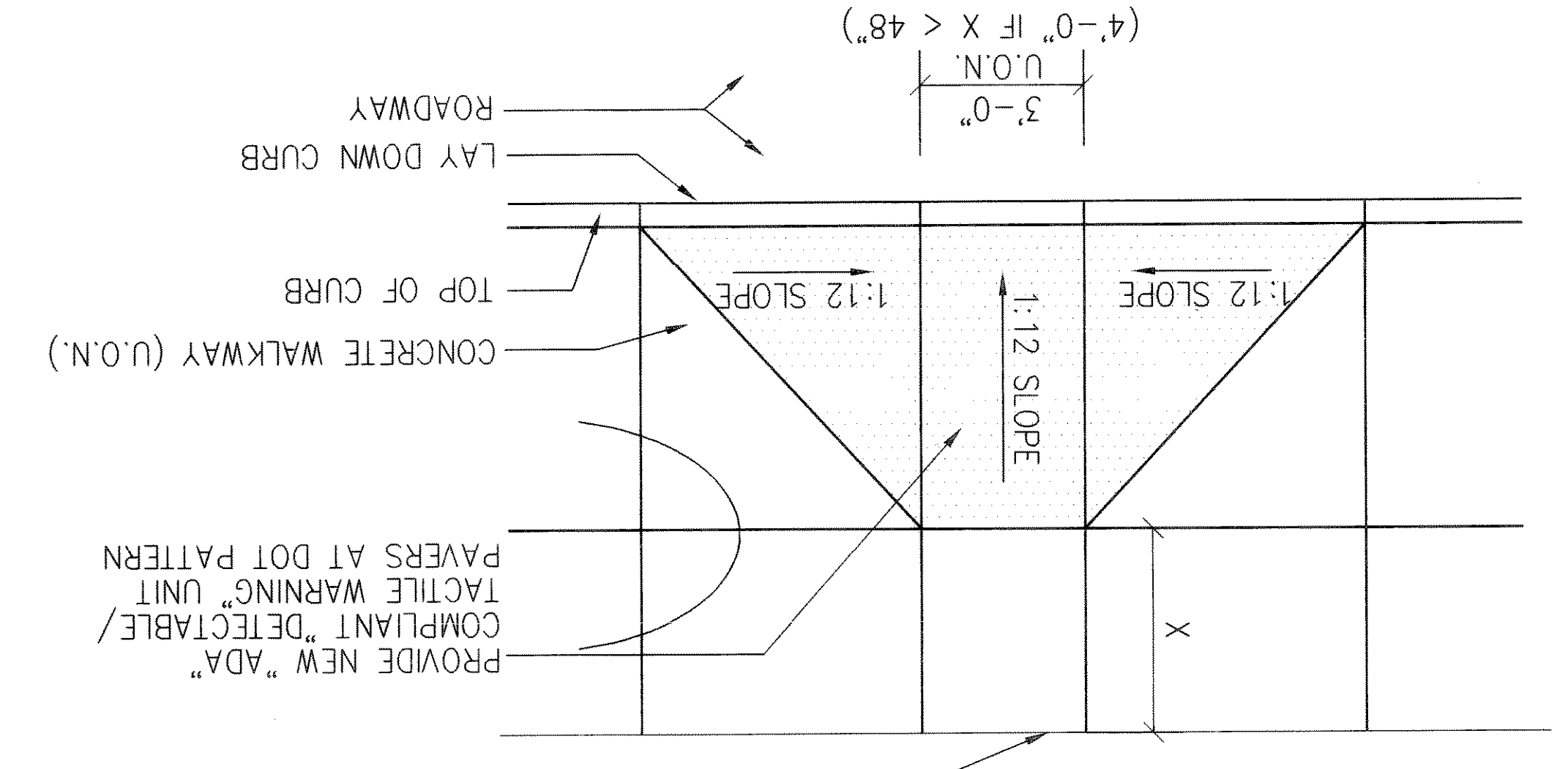

**CURB RAMP DETAIL**

NTS

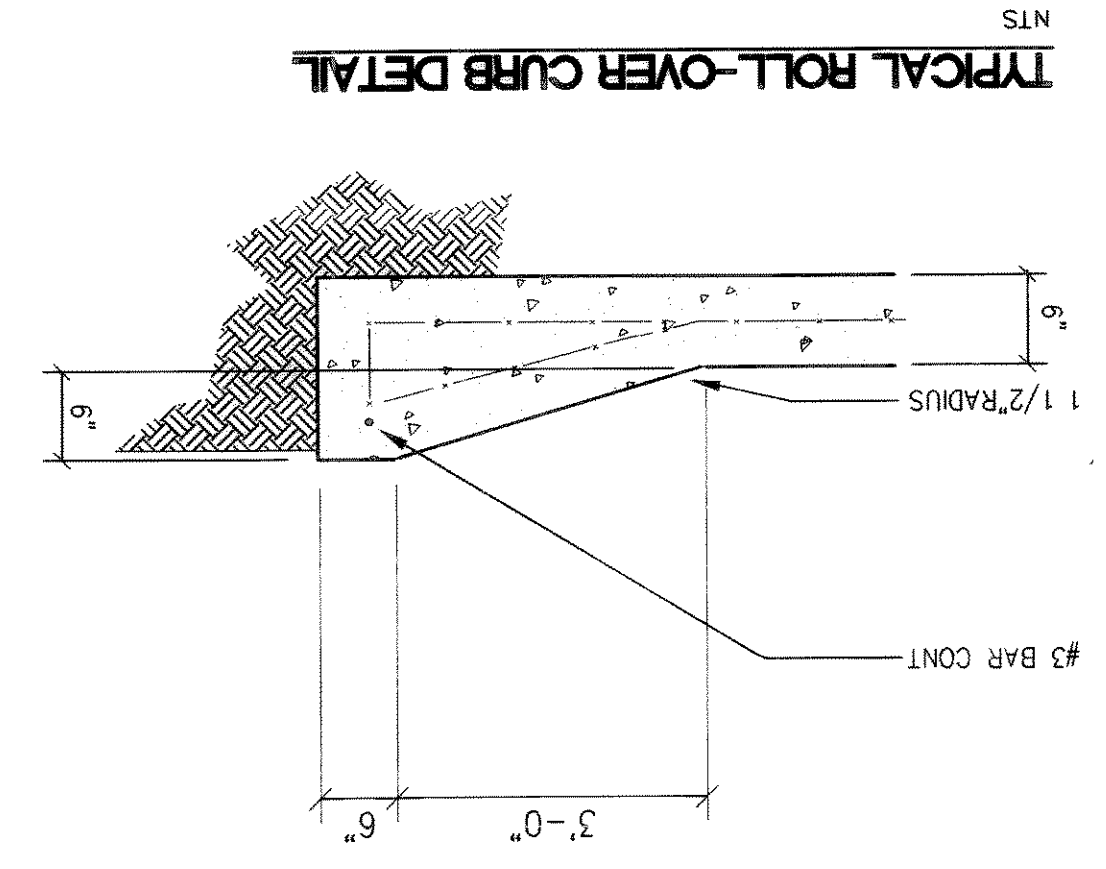

**TYPICAL ROLL-OVER CURB DETAIL**

NTS

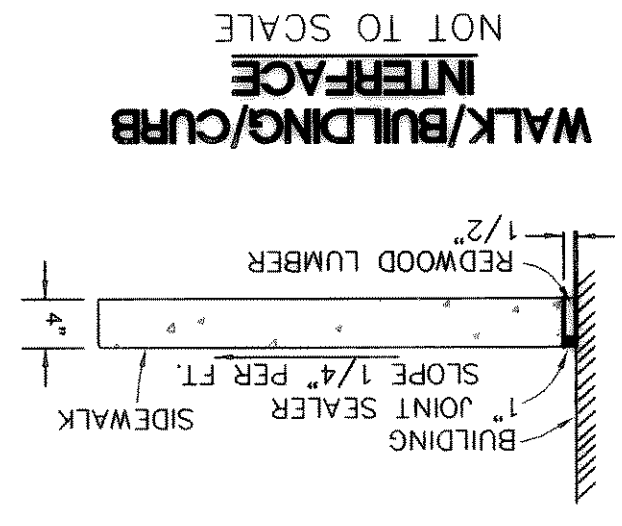

**WALK/BUILDING/CURB INTERFACE**

NOT TO SCALE

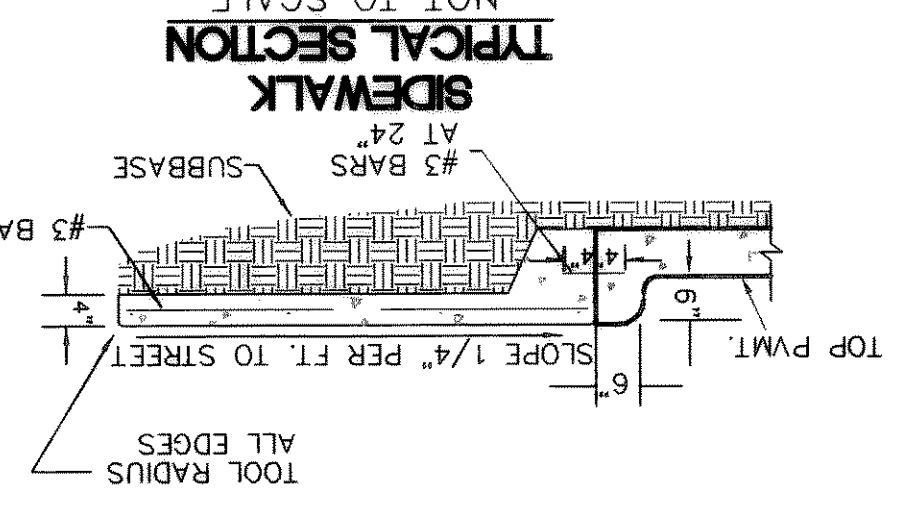

**TYPICAL SECTION SIDEWALK**

NOT TO SCALE

**SIDEWALK PLAN**

NOT TO SCALE

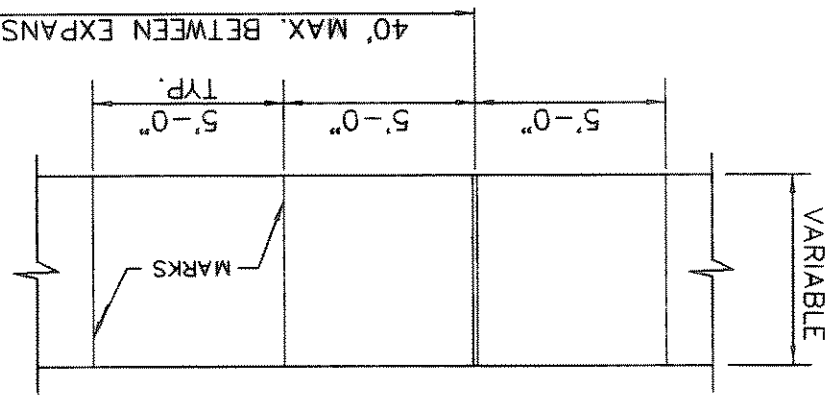

NOTE: AT MARKINGS THE CONCRETE SHALL BE CUT 1" DEEP, FOLLOWED BY GROOVING TOOL. STRENGTH SHALL BE 3000 P.S.I. WITH #3 BARS @ 24" O.C.

NOT TO SCALE

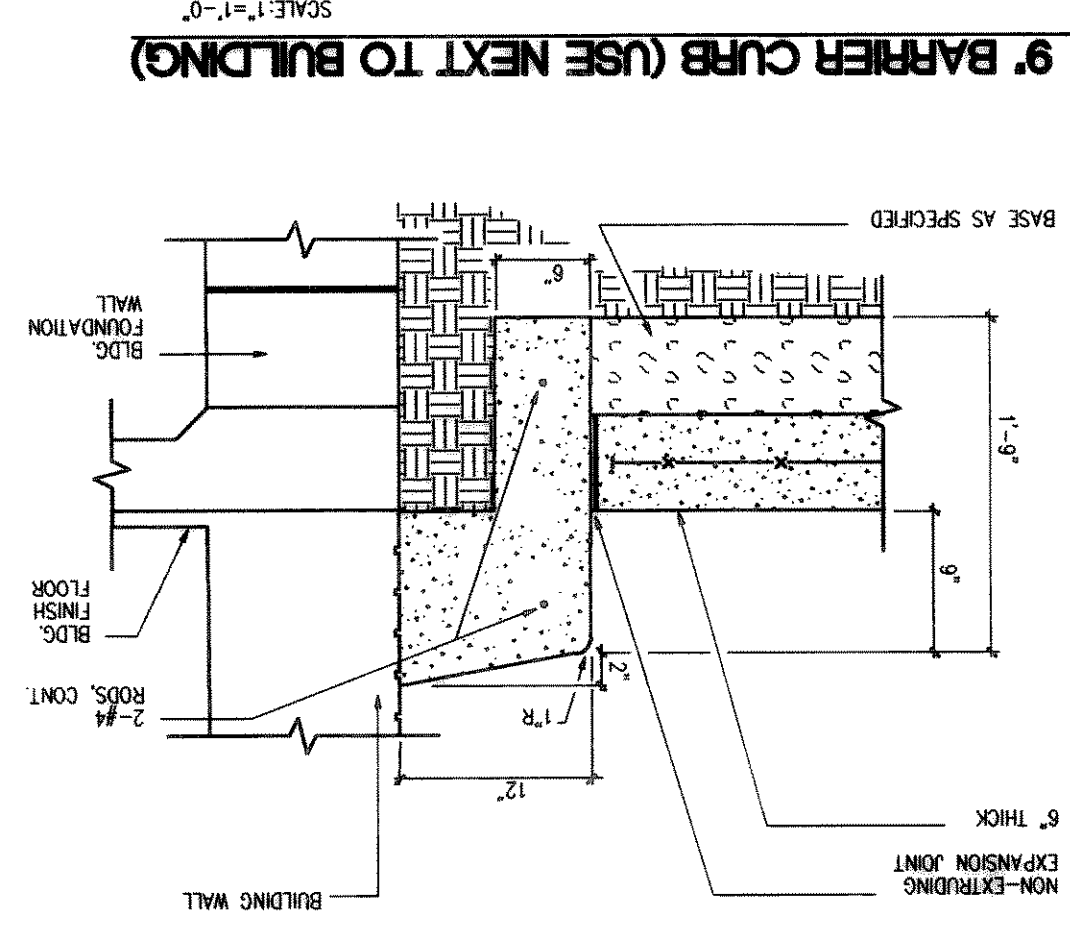

**9' BARRIER CURB (USE NEXT TO BUILDING)**

SCALE: 1/4"=1'-0"

**PAVING NOTES**  
THE INITIAL SOIL TEST AND REPORT PREPARED BY FUGRO - MCCOLLAND REPORT NO. 0771-1240 AND ANY AND ALL SUBSEQUENT REPORTS PREPARED FOR THIS PROJECT BY FUGRO - MCCOLLAND OR BY OTHER FIRM, AGENCY OR ENTITY, EVEN THOUGH NO SPECIFIC REFERENCE TO ANY SUCH REPORTS ARE CONTAINED IN THE PLANS AND/OR SPECIFICATIONS FOR THIS PROJECT, ARE MADE A PART OF THIS SITE PLAN. A COPY CAN BE OBTAINED THROUGH THE ARCHITECT OR ENGINEER.

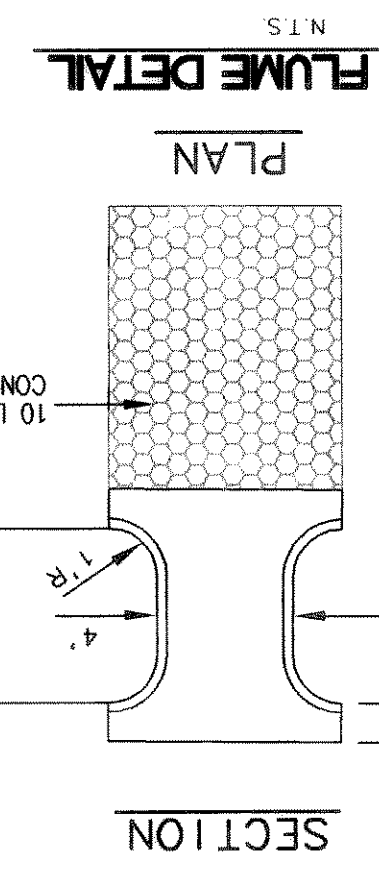

**FLUME DETAIL**

NTS

**LONGITUDINAL BUTT DETAIL**

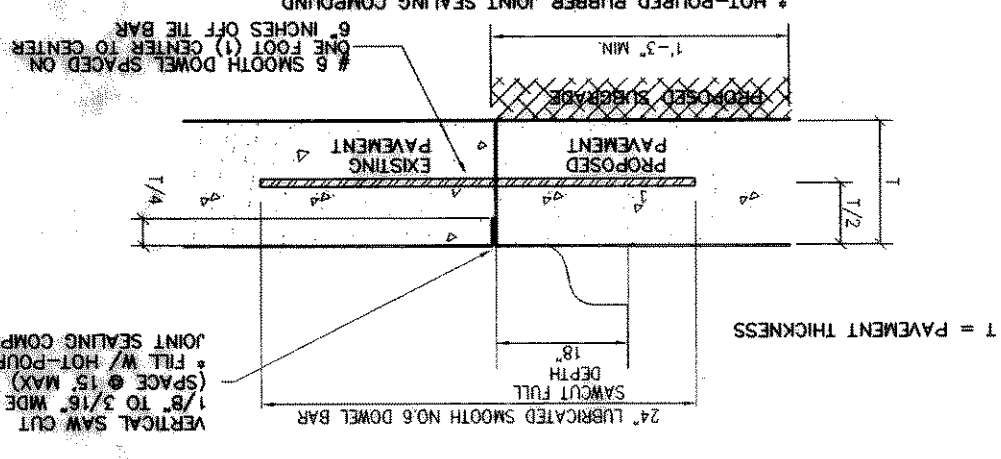

NOTES:

- NO. 5 SMOOTH DOWEL BAR MAY BE USED IN 5", 6" AND 7" PAVEMENT THICKNESS.
- LONGITUDINAL BUTT CONSTRUCTION MAY BE UTILIZED IN PLACE OF LONGITUDINAL HINGED (KEYWAY) JOINT AT CONTRACTOR'S OPTION.
- DOWEL BARS SHALL BE DRILLED INTO PAVEMENT HORIZONTALLY BY USE OF A MECHANICAL RIG. DRILLING BY HAND IS NOT APPLICABLE. PUSHING DOWEL BARS INTO GREEN CONCRETE IS NOT ACCEPTABLE.

These Drawings have been modified to conform to the Construction Records.  
Glenn Engineering Corporation  
By *[Signature]* Date: 2-23-01

**PAVING DETAILS**

**SAWED DUMMY JOINT DETAIL (T)**

NOT TO SCALE (PAVEMENT ONLY)

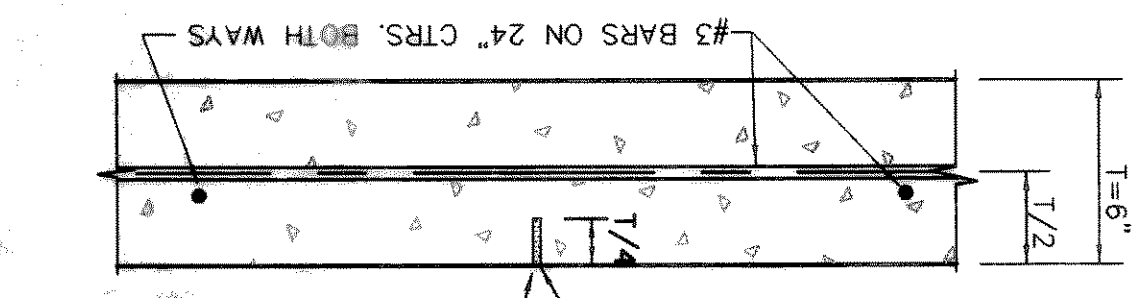

**CONSTRUCTION JOINT DETAIL (L)**

NOT TO SCALE

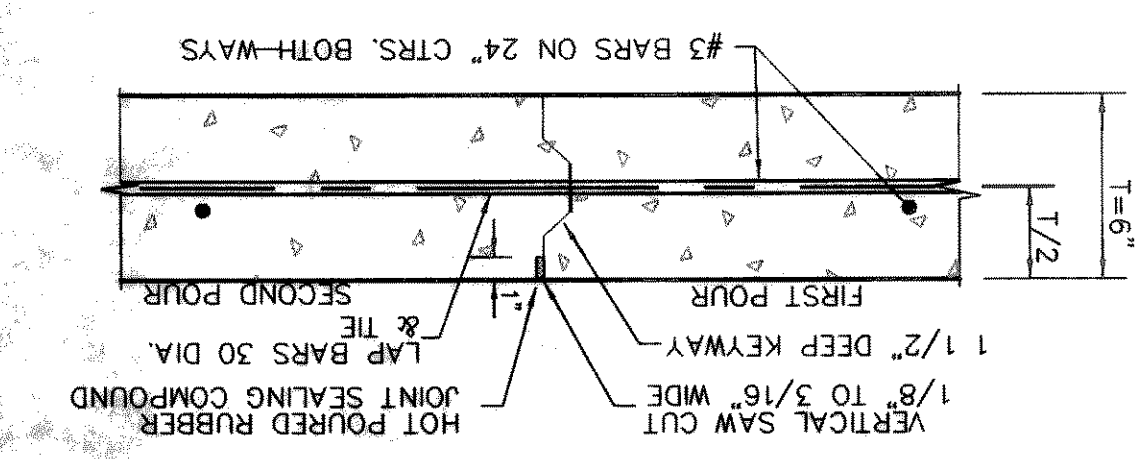

**TRANSVERSE EXPANSION JOINT DETAIL (E)**

NOT TO SCALE

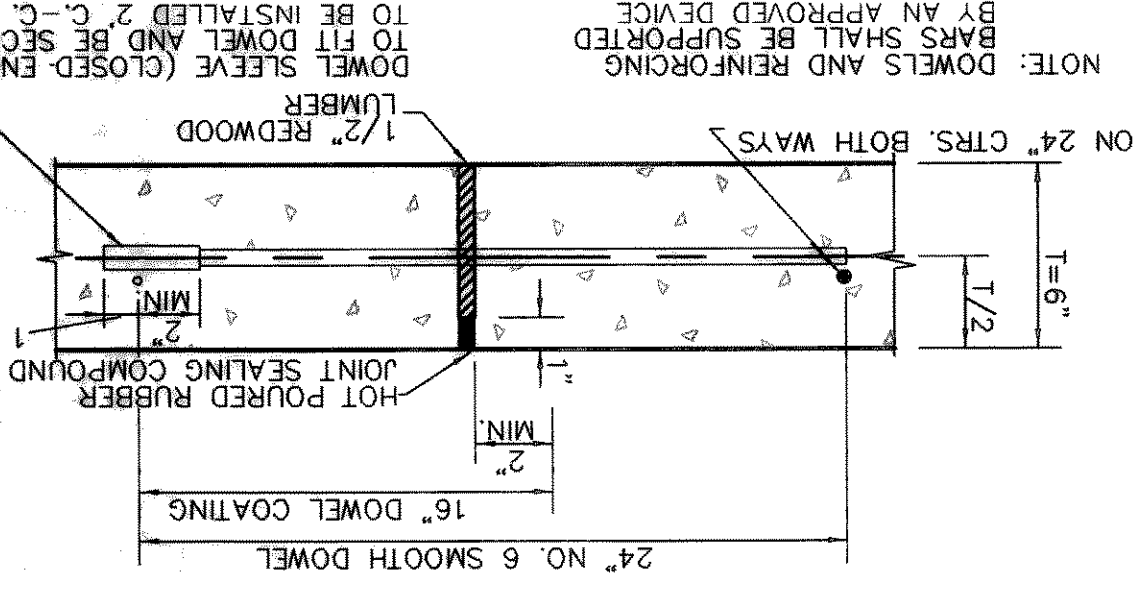

NOTE: DOWELS AND REINFORCING BARS SHALL BE SUPPORTED BY AN APPROVED DEVICE TO BE INSTALLED 2" C.-C. DOWEL SHALL BE SECURED TO FIT DOWEL AND BE SECURED TO LUMBER.

**ROCKWALL ELEMENTARY #8**  
**ROCKWALL INDEPENDENT SCHOOL DISTRICT**  
**ROCKWALL, TEXAS**

SET NUMBER OF SHEET NUMBER  
2.25  
SHEET NUMBER  
C  
SHW Group Inc. Architects + Engineers  
FINAL PLANS FOR BIDDING AND CONSTRUCTION  
MAY 2, 2001  
DRAWN BY R. HOSMAN  
CHECKED RAH  
DATE MAY 2, 2001  
REVISIONS