

PARKING REQUIREMENTS:	
2.6 PER EACH CLASSROOM	(40 x 2.6) = 100 TOTAL REQUIRED
HC PARKING REQUIRED	101 = 100 SPACES IN LOT = 6 HC SPACES
PARKING TABULATIONS:	
PARKING PROVIDED = VISITOR/STAFF REGULAR (8.0' X 20.0')	124
VISITOR/STAFF HANDICAP (8.0' X 16.0' WITH 8.0' WIDE STRIPED ACCESS)	6
TOTAL PARKING PROVIDED	130

- GENERAL NOTES:**
- STRIPING & SIGNAGE DIMENSIONS ARE FROM FACE OF CURB
  - ALL FIRE LANES, PARKING STRIPING, HOCP PARKING STRIPING & SIGNAGE ARE TO BE IN ACCORDANCE WITH CITY OF ROCKWALL REQUIREMENTS, TYP.
  - THE SANITATION CONTAINER SCREENING WALLS WILL BE THE SAME COLOR, MATERIAL, AND TEXTURE AS THE EXTERIOR WALLS OF THE PROPOSED BUILDING, INCLUDING A METAL GATE, PRIMED AND PAINTED. SUBJECT TO REVIEW AND APPROVAL BY THE CITY PLANNER.
  - THE SANITATION CONTAINER SCREENING WALLS, GATE, AND PAD SITE TO BE CONSTRUCTED IN ACCORDANCE WITH THE CITY OF ROCKWALL DESIGN SPECIFICATIONS, SUBJECT TO REVIEW AND APPROVAL BY THE SANITATION COORDINATOR.
  - PRIOR TO ANY CONSTRUCTION THE CONTRACTOR SHALL FAMILIARIZE HIMSELF WITH THE CONTRACT DOCUMENTS AND SPECIFICATIONS, THE PLANS INCLUDING ALL NOTES, THE CITY OF ROCKWALL SPECIFICATIONS AND ANY OTHER APPLICABLE STANDARDS OR SPECIFICATIONS RELIANT TO THE PROPER COMPLETION OF THE WORK SPECIFIED. FAILURE ON THE PART OF THE CONTRACTOR TO FAMILIARIZE HIMSELF WITH ALL STANDARDS OR SPECIFICATIONS PERTAINING TO THIS WORK SHALL IN NO WAY RELIEVE THE CONTRACTOR OF RESPONSIBILITY FOR PERFORMING THE WORK IN ACCORDANCE WITH ALL SUCH APPLICABLE STANDARDS AND SPECIFICATIONS.
  - CONTRACTOR SHALL HAVE IN HIS POSSESSION, PRIOR TO CONSTRUCTION, ALL NECESSARY PERMITS, LICENSES, ETC. CONTRACTOR SHALL HAVE AT LEAST ONE SET OF APPROVED ENGINEERING PLANS AND SPECIFICATIONS ON-SITE AT ALL TIMES.
  - ALL WORK SHALL CONFORM TO THE CITY OF ROCKWALL SPECIFICATIONS, STANDARDS, AND DETAILS.
  - IF UNFORESEEN PROBLEMS OR CONFLICTS ARE ENCOUNTERED IN THE CONSTRUCTION, FOR WHICH AN IMMEDIATE SOLUTION IS NOT APPARENT, THE ENGINEER AND OWNER SHALL BE NOTIFIED IMMEDIATELY.
  - IT WILL BE THE RESPONSIBILITY OF EACH CONTRACTOR TO PROTECT ALL EXISTING PUBLIC AND PRIVATE UTILITIES THROUGHOUT THE CONSTRUCTION OF THIS PROJECT. CONTRACTOR SHALL CONTACT THE APPROPRIATE UTILITY COMPANIES FOR LINE LOCATIONS, PRIOR TO COMMENCEMENT OF CONSTRUCTION AND SHALL ASSUME FULL LIABILITY TO THOSE COMPANIES FOR ANY DAMAGES CAUSED TO THEIR FACILITIES.
  - CONTRACTORS SHALL BE RESPONSIBLE FOR FIELD LOCATING EXISTING UTILITIES AND IMPROVEMENTS PRIOR TO CONSTRUCTION.
  - TRENCH SAFETY DESIGN WILL BE THE RESPONSIBILITY OF THE UTILITY CONTRACTOR. CONTRACTOR SHALL SUBMIT DESIGN TO THE CITY OF ROCKWALL ENGINEERING DEPARTMENT FOR REVIEW.

DRAINAGE REQUIREMENTS:	
NEW PERVIOUS AREA	6.60 Ac.
NEW IMPERVIOUS AREA	9.538 Ac.
EXISTING PERVIOUS AREA	11.136 Ac.

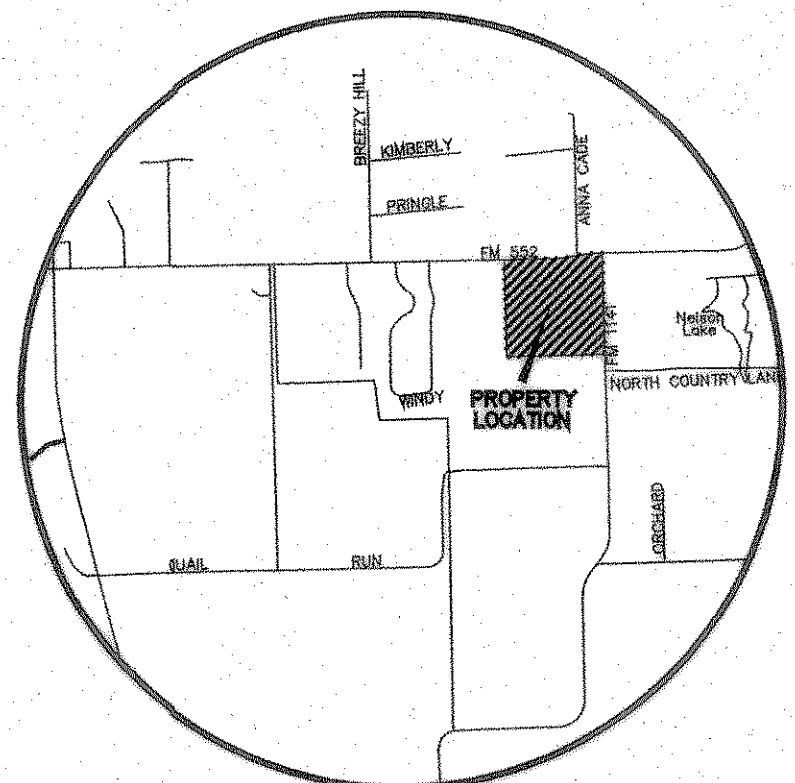
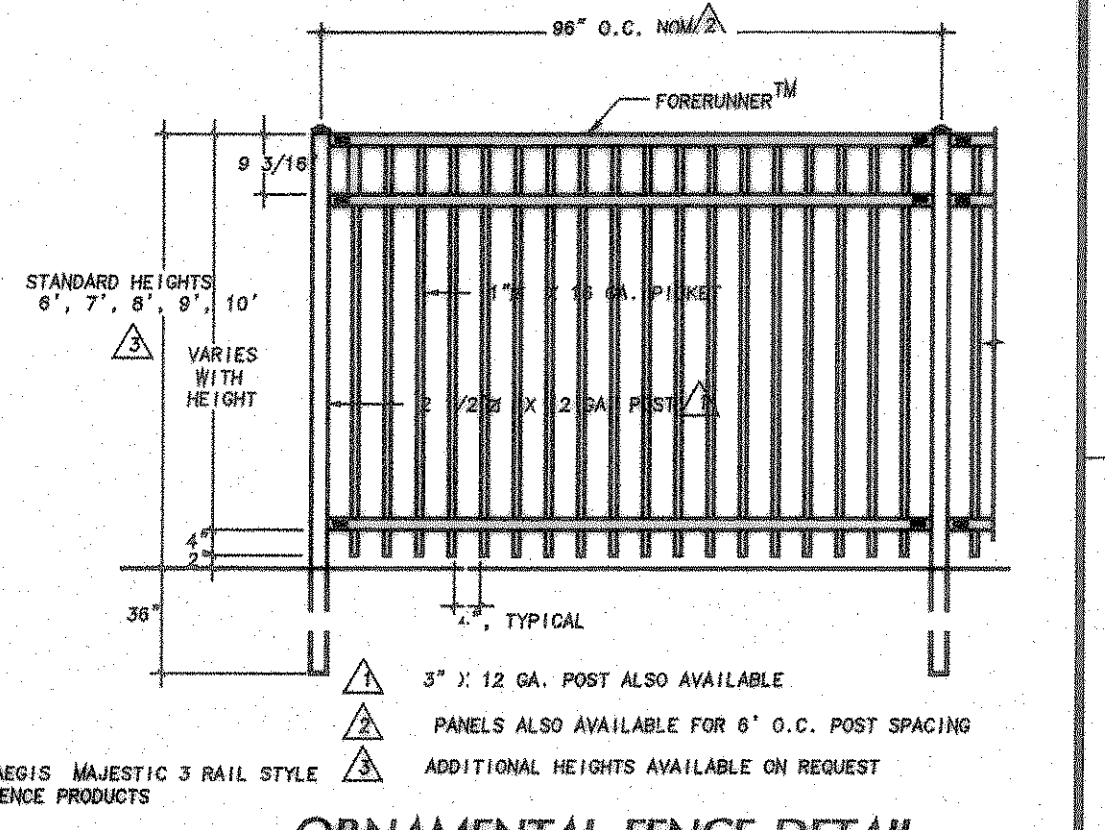

**RECORD DRAWING**  
 This is to certify that changes and corrections have been made to conform to the contractor's record of this project.  
 Signed: *Glenn* 8.7.07  
 Glenn Engineering Corporation

**SITE PLAN**  
 SCALE: 1" = 50'

**GLENN ENGINEERING**  
 PHONE 972-717-2511 FAX 972-717-2716  
 105 DECKER COURT - SUITE 910 IRVING, TEXAS 75062

**SHW Group LLP**  
 Architects + Engineers + Planners

- Consultants:
- CIVIL: GLENN ENGINEERING CORP
  - STRUCTURAL: SHW GROUP, LLP
  - MEP: ESTES McCURE AND ASSOCIATES.
  - FOOD SERVICE: H. G. RICE Inc.
  - LANDSCAPING: GRUBBS RAMSEY

FINAL PLANS FOR BIDDING AND CONSTRUCTING

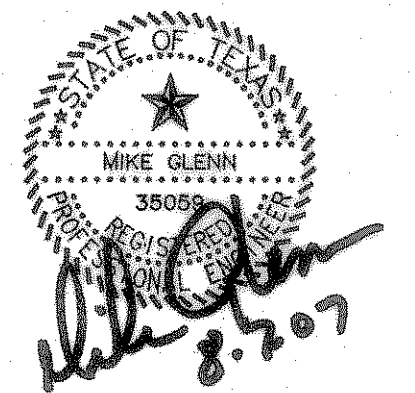

**Rockwall Independent School District**

**ROCKWALL ELEMENTARY SCHOOL #11**  
 RISD, TEXAS

Project Number: 1441.05.021  
 Drawing Date: 3/09/2006  
 Drawn: R.HOWMAN  
 Checked: RAH  
 Scale: AS SHOWN  
 ACAD File: BUSIEK-ENG-SITE2\_CITYREV3.dwg  
 © 2006 SHW Group, LLP

Revisions:

1	07/20/2006	CITY COMMENTS
2	08/15/2006	CITY COMMENTS
3	10/17/2006	REVISED BOX ELEVATIONS
4	10/23/2006	WATER REVISIONS

Sheet Title:  
**OVERALL SITE PLAN**

**CS 1.00**

User: Rick  
 Aug 07, 2007 - 3:47pm  
 \\roberthp\c-drive\rockisd\dalton ranch busiek elem\final set\busiek-ENG-SITE2\_CITYREV3.dwg