

LINE H

GRAPHIC SCALE

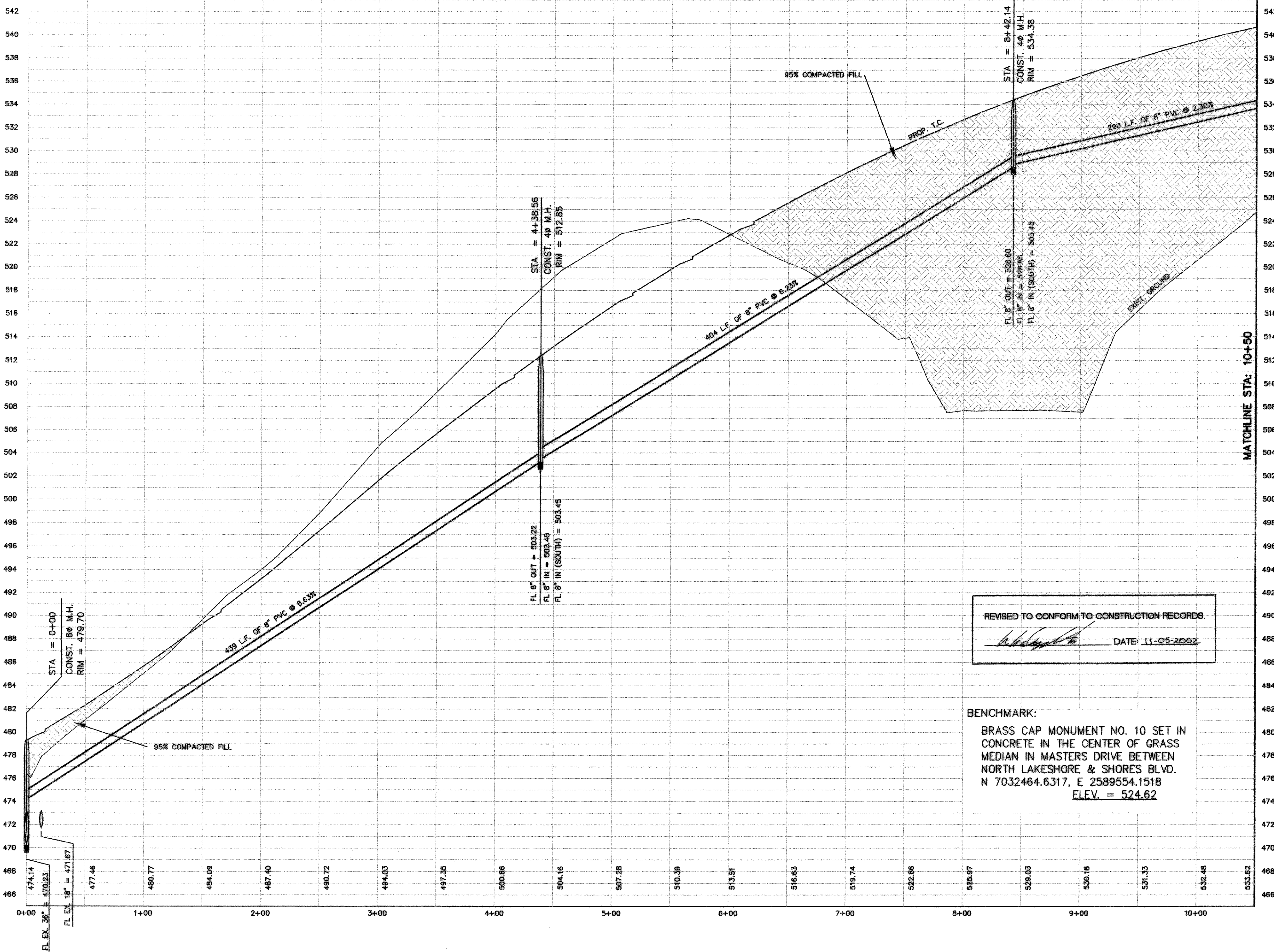
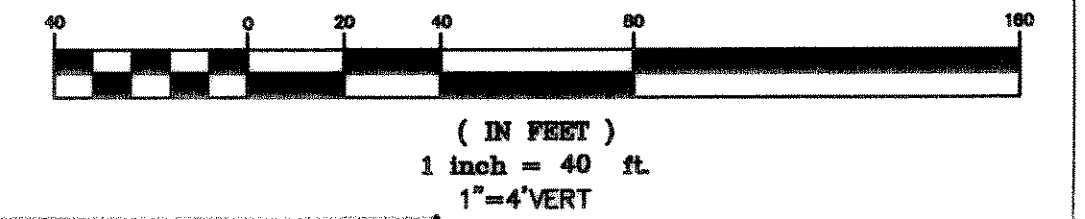

REVISED TO CONFORM TO CONSTRUCTION RECORDS.
[Signature] DATE: 11-05-2002

BENCHMARK:
 BRASS CAP MONUMENT NO. 10 SET IN
 CONCRETE IN THE CENTER OF GRASS
 MEDIAN IN MASTERS DRIVE BETWEEN
 NORTH LAKESHORE & SHORES BLVD.
 N 7032464.6317, E 2589554.1518
 ELEV. = 524.62

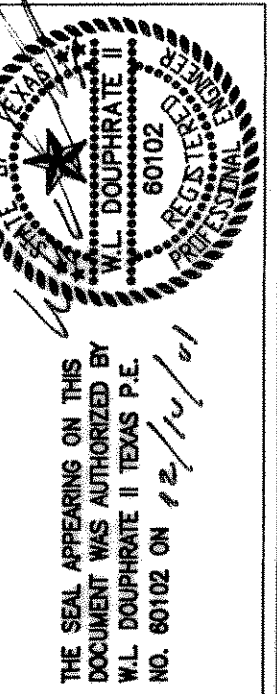

DOUPHRA
& ASSOCIATES, INC.
 ENGINEERING - PROJECT MANAGEMENT - SURVEYING
 2236 RIDGE RD., # 200 ROCKWALL, TEXAS 75087
 PHONE: (972)771-8004 FAX: (972)771-8006

SANITARY SEWER PROFILE
 LINE H
 ROCKWALL ELEMENTARY SCHOOL #9 AREA
 CITY OF ROCKWALL, ROCKWALL COUNTY, TEXAS

REVISIONS PER
 CITY 12/05/01

W.L.D.
 CHECKED

KEB.
 DRAWN

6/01
 DATE

0918-0-00
 PROJECT

11
 OF