

SHWGROUP  
ARCHITECTS | ENGINEERS | PLANNERS

CIVIL:  
GLENN ENGINEERING, INC.

STRUCTURAL:  
SHW GROUP LLP

MEP:  
ESTES, McCLURE & ASSOCIATES

LANDSCAPING:  
RAMSEY LANDSCAPE ARCHITECTS

FOOD SERVICE:  
JMK DESIGNS

FINAL PLANS FOR PERMITTING AND CONSTRUCTION

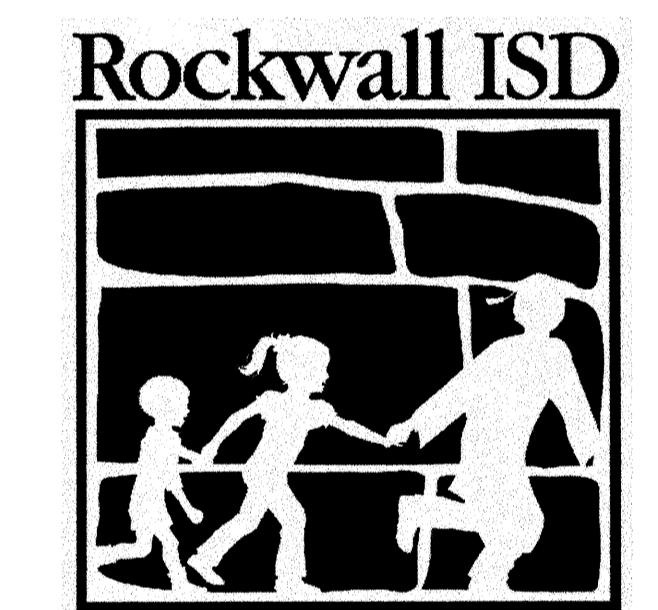
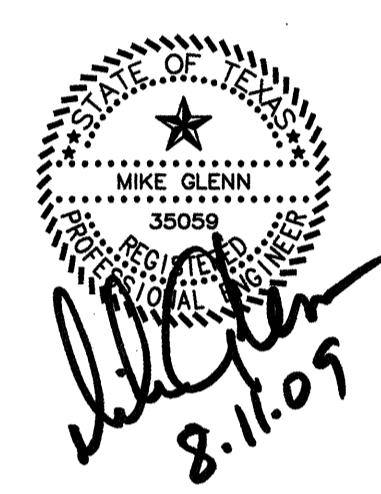

ROCKWALL  
HIGH SCHOOL  
ROCKWALL, TEXAS

CHECKED:

© 2008 SHW Group LLP

ISSUE: 5/27/2008

Revisions:

- 1 ADDENDA #1 - MARCH 17, 2008
- 2 ADDENDA #2 - MARCH 25, 2008
- 3 ADDENDA #3 - APRIL 1, 2008
- 4 CITY REVIEW COMMENTS - APRIL 22, 2008
- 5 CITY REVIEW COMMENTS - SEPT. 09, 2008
- 6 RECORD SET - MARCH 04, 2009
- 7 REVISED RECORD SET - JUNE 04, 2009

Sheet Title:  
**EXISTING  
DRAINAGE  
AREA MAP**

**CG 1.10**

SHW Project: 4107.049.00

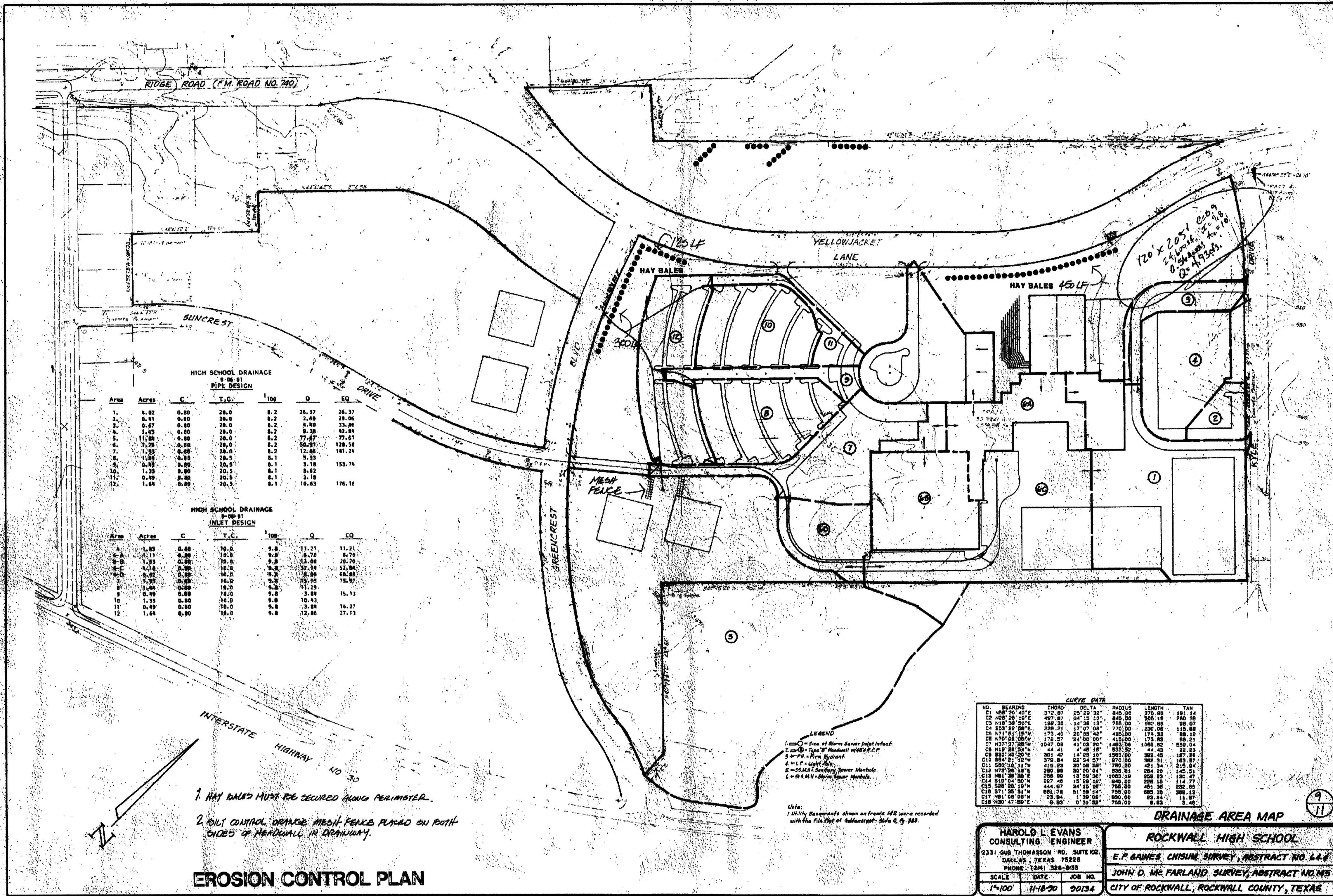

**HIGH SCHOOL DRAINAGE  
8-08-01  
PIPE DESIGN**

| Area | Acres | C    | T.C. | 100' | Q     | EQ     |
|------|-------|------|------|------|-------|--------|
| 1    | 4.82  | 0.80 | 26.0 | 8.2  | 26.37 | 26.37  |
| 2    | 0.41  | 0.80 | 26.0 | 8.2  | 2.49  | 26.06  |
| 3    | 0.57  | 0.80 | 26.0 | 8.2  | 3.40  | 26.06  |
| 4    | 1.93  | 0.80 | 26.0 | 8.2  | 9.38  | 43.84  |
| 5    | 11.86 | 0.80 | 26.0 | 8.2  | 77.67 | 77.67  |
| 6    | 12.25 | 0.80 | 26.0 | 8.2  | 80.91 | 128.58 |
| 7    | 1.35  | 0.80 | 26.0 | 8.2  | 12.86 | 181.24 |
| 8    | 1.08  | 0.80 | 26.0 | 8.2  | 9.33  | 181.24 |
| 9    | 0.48  | 0.80 | 26.0 | 8.2  | 3.18  | 153.74 |
| 10   | 1.23  | 0.80 | 26.0 | 8.2  | 8.62  | 153.74 |
| 11   | 0.79  | 0.80 | 26.0 | 8.2  | 6.1   | 153.74 |
| 12   | 1.64  | 0.80 | 26.0 | 8.2  | 16.43 | 176.18 |

**HIGH SCHOOL DRAINAGE  
8-08-01  
INLET DESIGN**

| Area | Acres | C    | T.C. | 100' | Q     | EQ    |
|------|-------|------|------|------|-------|-------|
| A    | 1.43  | 0.80 | 10.0 | 8.0  | 11.21 | 11.21 |
| B-A  | 0.11  | 0.80 | 10.0 | 8.0  | 0.76  | 11.21 |
| B    | 1.32  | 0.80 | 10.0 | 8.0  | 10.45 | 26.79 |
| C    | 1.10  | 0.80 | 10.0 | 8.0  | 9.2   | 51.99 |
| D    | 0.20  | 0.80 | 10.0 | 8.0  | 1.36  | 68.63 |
| E    | 0.20  | 0.80 | 10.0 | 8.0  | 1.36  | 75.97 |
| F    | 0.66  | 0.80 | 10.0 | 8.0  | 4.79  | 15.17 |
| G    | 0.48  | 0.80 | 10.0 | 8.0  | 3.48  | 15.17 |
| H    | 1.33  | 0.80 | 10.0 | 8.0  | 10.43 | 15.17 |
| I    | 0.49  | 0.80 | 10.0 | 8.0  | 3.48  | 15.17 |
| J    | 1.64  | 0.80 | 10.0 | 8.0  | 12.86 | 27.13 |

**CURVE DATA**

| NO. | BEARING     | CHORD   | DELTA     | RADIUS  | LENGTH  | TAN    |
|-----|-------------|---------|-----------|---------|---------|--------|
| C1  | N87°20'40"E | 272.87  | 25°35'20" | 840.00  | 379.88  | 131.14 |
| C2  | N20°26'10"E | 487.87  | 94°15'10" | 840.00  | 505.18  | 280.58 |
| C3  | N18°26'50"E | 182.38  | 14°38'15" | 780.00  | 180.88  | 68.87  |
| C4  | S23°33'58"E | 238.21  | 17°07'08" | 770.00  | 230.08  | 118.88 |
| C5  | N71°17'00"E | 173.84  | 28°08'40" | 490.00  | 171.32  | 68.14  |
| C6  | N70°28'58"W | 172.57  | 24°50'00" | 410.00  | 173.82  | 68.21  |
| C7  | N23°20'20"W | 1347.08 | 41°32'00" | 1495.00 | 1096.02 | 680.14 |
| C8  | N18°26'53"W | 44.41   | 48°48'18" | 533.00  | 41.43   | 22.23  |
| C9  | S23°33'52"E | 381.40  | 14°38'15" | 780.00  | 381.40  | 137.04 |
| C10 | S84°0'10"W  | 379.84  | 80°34'57" | 870.00  | 382.31  | 183.87 |
| C11 | S20°11'18"E | 412.28  | 20°52'51" | 780.00  | 412.28  | 214.04 |
| C12 | N73°26'10"E | 280.88  | 30°20'01" | 538.01  | 284.20  | 143.51 |
| C13 | N68°08'18"E | 236.86  | 27°08'20" | 408.54  | 236.86  | 132.42 |
| C14 | S18°04'50"W | 627.48  | 18°26'12" | 840.00  | 598.18  | 114.71 |
| C15 | S48°08'18"W | 444.87  | 41°16'00" | 780.00  | 451.38  | 236.86 |
| C16 | S71°26'51"W | 688.78  | 51°58'24" | 780.00  | 685.28  | 388.13 |
| C17 | N61°08'08"W | 23.84   | 17°08'00" | 826.00  | 23.84   | 11.87  |
| C18 | N20°47'30"E | 6.83    | 0°31'30"  | 755.00  | 6.83    | 1.48   |

**LEGEND**

- 1. (C) = End of Storm Sewer Inlet Inlet
- 2. (C) = Top of Manhole at 60" D.I.P.
- 3. (C) = Storm Sewer
- 4. (C) = Light Pole
- 5. (C) = 54" M.P. Secondary Storm Manhole
- 6. (C) = 48" M.P. Storm Sewer Manhole

**Notes:**  
1. Utility Measurements shown on sheets 1-6 were recorded with the File Plot of Stationary-Slide 0, 9, 385.

**HAROLD L. EVANS**  
CONSULTING ENGINEER  
9331 GUS THOMASSON RD. SUITE 202  
DALLAS, TEXAS 75228  
PHONE (214) 328-8133

**ROCKWALL HIGH SCHOOL**  
E.P. GAINES CHISUM SURVEY, ABSTRACT NO. 444  
JOHN D. FARLAND SURVEY, ABSTRACT NO. 145  
CITY OF ROCKWALL, ROCKWALL COUNTY, TEXAS

SCALE: 1"=100' DATE: 11-18-00 JOB NO: 90134  
Rev. 7-12-01

**RECORD DRAWING**  
This is to certify that changes and corrections have been made to conform to the contractor's record of this project.  
Signed: *[Signature]* Date: 8.11.09  
Glenn Engineering Corporation

**EXISTING DRAINAGE AREA MAP  
FOR INFORMATION ONLY**

Printed: Aug 11, 2008, 2:34 PM by user: ragan. Saved: 8/11/2008 by user: fct. W:\comp\dwg\rockwall\high-school\2007\_ADDITON\ROCKWALL-HS-ADD-REV-06.dwg