

Aug 03, 2009 - 3:28pm User: Rick
 \\roberthpc-dfve\rock\SD\UTLEY\2008 ADDITIONS\IBID SET\2008 WILKERSON-SANDERS STADIUM\2008WILKERSON-SANDERS-REV8.dwg

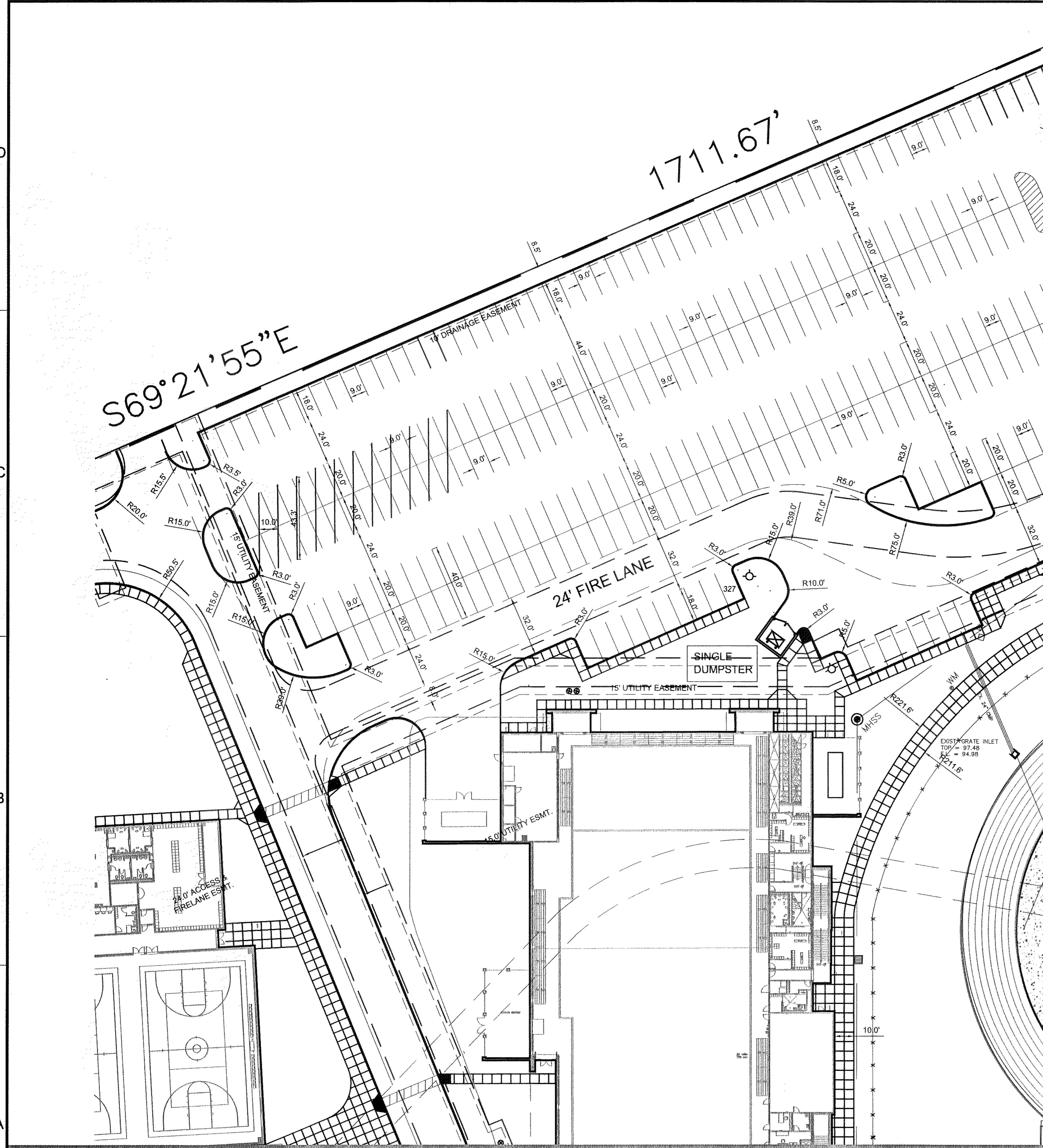

- GENERAL NOTES:**
1. STRIPING & SIGNAGE DIMENSIONS ARE FROM FACE OF CURB
 2. ALL FIRE LANES, PARKING STRIPING, HD/CP PARKING STRIPING & SIGNAGE ARE TO BE IN ACCORDANCE WITH CITY OF ROCKWALL REQUIREMENTS, TYP.
 3. THE SANITATION CONTAINER SCREENING WALLS WILL BE THE SAME COLOR, MATERIAL, AND TEXTURE AS THE EXTERIOR WALLS OF THE PROPOSED BUILDING, INCLUDING A METAL GATE, PRIMED AND PAINTED, SUBJECT TO REVIEW AND APPROVAL BY THE CITY PLANNER.
 4. THE SANITATION CONTAINER SCREENING WALLS, GATE, AND PAD SITE TO BE CONSTRUCTED IN ACCORDANCE WITH THE CITY OF ROCKWALL DESIGN SPECIFICATIONS, SUBJECT TO REVIEW AND APPROVAL BY THE SANITATION COORDINATOR.
 5. PRIOR TO ANY CONSTRUCTION THE CONTRACTOR SHALL FAMILIARIZE HIMSELF WITH THE CONTRACT DOCUMENTS AND SPECIFICATIONS, THE PLANS INCLUDING ALL NOTES, THE CITY OF ROCKWALL SPECIFICATIONS AND ANY OTHER APPLICABLE STANDARDS OR SPECIFICATIONS RELEVANT TO THE PROPER COMPLETION OF THE WORK SPECIFIED. FAILURE ON THE PART OF THE CONTRACTOR TO FAMILIARIZE HIMSELF WITH ALL STANDARDS OR SPECIFICATIONS PERTAINING TO THIS WORK SHALL IN NO WAY RELIEVE THE CONTRACTOR OF RESPONSIBILITY FOR PERFORMING THE WORK IN ACCORDANCE WITH ALL SUCH APPLICABLE STANDARDS AND SPECIFICATIONS.
 6. CONTRACTOR SHALL HAVE IN HIS POSSESSION, PRIOR TO CONSTRUCTION, ALL NECESSARY PERMITS, LICENSES, ETC. CONTRACTOR SHALL HAVE AT LEAST ONE SET OF APPROVED ENGINEERING PLANS AND SPECIFICATIONS ON-SITE AT ALL TIMES.
 7. ALL WORK SHALL CONFORM TO THE CITY OF ROCKWALL SPECIFICATIONS, STANDARDS, AND DETAILS.
 8. IF UNFORESEEN PROBLEMS OR CONFLICTS ARE ENCOUNTERED IN THE CONSTRUCTION, FOR WHICH AN IMMEDIATE SOLUTION IS NOT APPARENT, THE ENGINEER AND OWNER SHALL BE NOTIFIED IMMEDIATELY.
 9. IT WILL BE THE RESPONSIBILITY OF EACH CONTRACTOR TO PROTECT ALL EXISTING PUBLIC AND PRIVATE UTILITIES THROUGHOUT THE CONSTRUCTION OF THIS PROJECT. CONTRACTOR SHALL CONTACT THE APPROPRIATE UTILITY COMPANIES FOR LINE LOCATIONS. PRIOR TO COMMENCEMENT OF CONSTRUCTION AND SHALL ASSUME FULL LIABILITY TO THOSE COMPANIES FOR ANY DAMAGES CAUSED TO THEIR FACILITIES.
 10. CONTRACTORS SHALL BE RESPONSIBLE FOR FIELD LOCATING EXISTING UTILITIES AND IMPROVEMENTS PRIOR TO CONSTRUCTION.
 11. TRENCH SAFETY DESIGN WILL BE THE RESPONSIBILITY OF THE UTILITY CONTRACTOR. CONTRACTOR SHALL SUBMIT DESIGN TO THE CITY OF ROCKWALL ENGINEERING DEPARTMENT FOR REVIEW.
 12. ALL FIRE LANES SHALL BE MIN. 6" THK. - 3600 PSI CONC. WITH MIN. 6 SACK FOR MACHINE PLACEMENT & 1/2 SACK FOR HAND PLACEMENT IN ACCORDANCE WITH THE CITY OF ROCKWALL STANDARDS.
 13. MARK FIRE LANE TO CITY SPECIFICATION, "NO PARKING FIRE LANE" EVERY 25' WHITE 4" LETTERS ON A 6" RED STRIPED BACKGROUND.
 14. ANY GATES OR FENCING THAT CROSSES FIRE LANE SHALL BE PERMITTED THROUGH THE ROCK WALL FIRE DEPARTMENT.
 15. PROVIDE A LEVEL, CLEAR, AND UNOBSTRUCTED TEN FOOT (10 FOOT) WIDE PATHWAY WITH A MAXIMUM 5% SLOPE AROUND EXTERNAL WALLS OF THE STRUCTURE. ANY FENCES THAT OBSTRUCTS THIS PATHWAY SHALL BE PROVIDED WITH PERSONNEL GATES AND KNOX LOCKS.



Consultants:

CIVIL:
 GLENN ENGINEERING CORP

STRUCTURAL:
 SHW GROUP, LLP

MEP:
 ESTES McCCLURE & ASSOCIATES, INC.
 FOOD SERVICE:
 JMK FOODSERVICE CONSULTING & DESIGN, LLC

LANDSCAPING:
 RAMSEY LANDSCAPE ARCHITECTS, LLP

Final Plans for Bidding and Construction

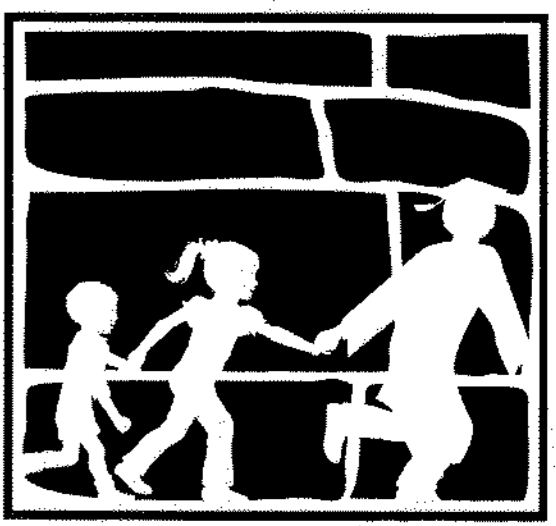
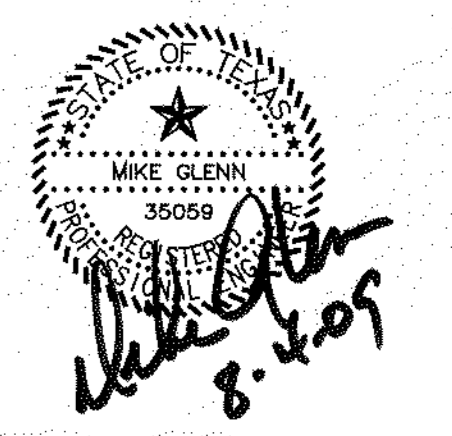

Rockwall
 INDEPENDENT SCHOOL DISTRICT

WILKERSON SANDERS STADIUM RENOVATIONS
 ROCKWALL, TEXAS

Project Number: 4107.048.00
 Drawing Date: 05/29/2008
 Drawn:
 Checked:
 Scale:
 ACAD File: 2008WILKERSON-SANDERS-REV8.d
 © 2008 SHW Group, LLP

Revisions:

1	11/05/08	CITY REVISIONS
2	12/02/08	CITY REVISIONS #2
3	12/12/08	CITY REVISIONS #3
4	12/16/08	CITY REVISIONS #4
5	01/26/09	CITY REVISIONS #5
6	08/03/09	RECORD SET

RECORD DRAWING

This is to certify that changes and corrections have been made to conform to the contractor's record of this project.

Signed: *W. Glenn* Date: *8-4-09*
 Glenn Engineering Corporation

Sheet Title:
WEST SITE PLAN

CS 1.02