



**SHW GROUP**

ARCHITECTS | ENGINEERS | PLANNERS

CIVIL:  
GLENN ENGINEERING, INC.

STRUCTURAL:  
SHW GROUP LLP

MEP:  
ESTES, McCURE &  
ASSOCIATES

LANDSCAPING:  
GRUBBS-RAMSEY, INC.

FOOD SERVICE:  
JMK DESIGNS

AQUATICS:  
AQUATIC EXCELLENCE

**FINAL PLANS**  
FOR BIDDING AND CONSTRUCTION



**Rockwall ISD**



**HERMAN E. UTLEY  
MIDDLE SCHOOL**

CHECKED:  
File:  
© 2008 SHW Group LLP  
ISSUE: 08/22/2008

1	09/19/08	CITY REVISIONS #1
2	09/28/08	CITY REVISIONS #2
3	10/01/08	CITY REVISIONS #3
4	10/13/08	REVISIONS #4
5	11/18/08	GRADING REVISIONS
6	12/02/08	UTILITY REVISIONS
7	01/14/09	GRADING REVISIONS
8	02/26/09	GRADING REVISIONS
9	05/20/09	COURTYARD STORM
10	07/27/09	RECORD SET

Sheet Title:  
**UTLEY EAST  
STORM SEWER  
PLAN**

**CU 1.08**

SHW Project: 4107.043.00

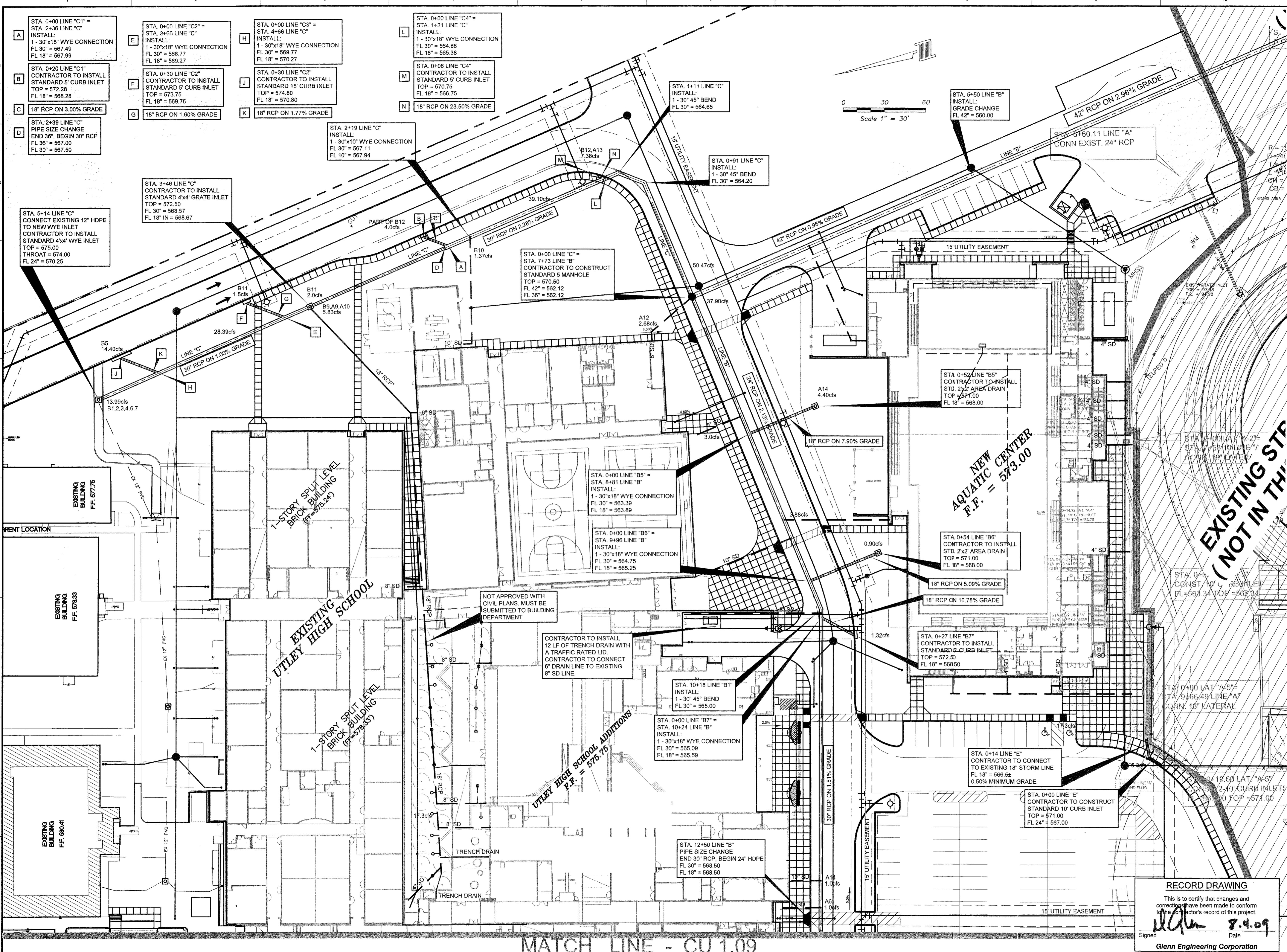

**A** STA. 0+00 LINE "C1" = STA. 2+36 LINE "C" INSTALL: 1 - 30"x18" WYE CONNECTION FL 30" = 567.49 FL 18" = 567.99

**B** STA. 0+20 LINE "C1" CONTRACTOR TO INSTALL STANDARD 5' CURB INLET TOP = 572.28 FL 18" = 568.28

**C** 18" RCP ON 3.00% GRADE

**D** STA. 2+39 LINE "C" PIPE SIZE CHANGE END 36", BEGIN 30" RCP FL 36" = 567.00 FL 30" = 567.50

**E** STA. 0+00 LINE "C2" = STA. 3+66 LINE "C" INSTALL: 1 - 30"x18" WYE CONNECTION FL 30" = 568.77 FL 18" = 569.27

**F** STA. 0+30 LINE "C2" CONTRACTOR TO INSTALL STANDARD 5' CURB INLET TOP = 573.75 FL 18" = 569.75

**G** 18" RCP ON 1.60% GRADE

**H** STA. 0+00 LINE "C3" = STA. 4+66 LINE "C" INSTALL: 1 - 30"x18" WYE CONNECTION FL 30" = 569.77 FL 18" = 570.27

**J** STA. 0+30 LINE "C2" CONTRACTOR TO INSTALL STANDARD 15' CURB INLET TOP = 574.80 FL 18" = 570.80

**K** 18" RCP ON 1.77% GRADE

**L** STA. 0+00 LINE "C4" = STA. 1+21 LINE "C" INSTALL: 1 - 30"x18" WYE CONNECTION FL 30" = 564.88 FL 18" = 565.38

**M** STA. 0+06 LINE "C4" CONTRACTOR TO INSTALL STANDARD 5' CURB INLET TOP = 570.75 FL 18" = 566.75

**N** 18" RCP ON 23.50% GRADE

**O** STA. 0+00 LINE "C" = STA. 7+73 LINE "B" CONTRACTOR TO CONSTRUCT STANDARD 5 MANHOLE TOP = 570.50 FL 42" = 562.12 FL 36" = 562.12

**P** STA. 1+11 LINE "C" INSTALL: 1 - 30" 45° BEND FL 30" = 564.65

**Q** STA. 0+91 LINE "C" INSTALL: 1 - 30" 45° BEND FL 30" = 564.20

**R** STA. 5+50 LINE "B" INSTALL: GRADE CHANGE FL 42" = 560.00

**S** STA. 5+14 LINE "C" CONNECT EXISTING 12" HDPE TO NEW WYE INLET CONTRACTOR TO INSTALL STANDARD 4x4' WYE INLET THROAT = 574.00 FL 24" = 570.25

**T** STA. 3+46 LINE "C" CONTRACTOR TO INSTALL STANDARD 4x4' GRATE INLET TOP = 573.50 FL 30" = 568.57 FL 18" IN = 568.67

**U** STA. 0+00 LINE "C" = STA. 7+73 LINE "B" CONTRACTOR TO CONSTRUCT STANDARD 5 MANHOLE TOP = 570.50 FL 42" = 562.12 FL 36" = 562.12

**V** STA. 0+00 LINE "B5" = STA. 8+81 LINE "B" INSTALL: 1 - 30"x18" WYE CONNECTION FL 30" = 563.39 FL 18" = 563.89

**W** STA. 0+00 LINE "B6" = STA. 9+96 LINE "B" INSTALL: 1 - 30"x18" WYE CONNECTION FL 30" = 564.75 FL 18" = 565.25

**X** STA. 0+52 LINE "B5" CONTRACTOR TO INSTALL STD. 2x2' AREA DRAIN TOP = 571.00 FL 18" = 568.00

**Y** STA. 0+54 LINE "B6" CONTRACTOR TO INSTALL STD. 2x2' AREA DRAIN TOP = 571.00 FL 18" = 568.00

**Z** STA. 10+18 LINE "B1" INSTALL: 1 - 30" 45° BEND FL 30" = 565.00

**AA** STA. 0+00 LINE "B7" = STA. 10+24 LINE "B" INSTALL: 1 - 30"x18" WYE CONNECTION FL 30" = 565.09 FL 18" = 565.59

**AB** STA. 12+50 LINE "B" PIPE SIZE CHANGE END 30" RCP, BEGIN 24" HDPE FL 30" = 568.50 FL 18" = 568.50

**AC** STA. 0+14 LINE "E" CONTRACTOR TO CONNECT TO EXISTING 18" STORM LINE FL 18" = 566.52 0.50% MINIMUM GRADE

**AD** STA. 0+14 LINE "E" CONTRACTOR TO CONNECT TO EXISTING 18" STORM LINE FL 18" = 566.52 0.50% MINIMUM GRADE

**AE** STA. 0+14 LINE "E" CONTRACTOR TO CONNECT TO EXISTING 18" STORM LINE FL 18" = 566.52 0.50% MINIMUM GRADE

**AF** STA. 0+00 LINE "E" CONTRACTOR TO CONSTRUCT STANDARD 10' CURB INLET TOP = 571.00 FL 24" = 567.00

**AG** STA. 0+19.60 LAT. "A5" CONTRACTOR TO CONSTRUCT STANDARD 24" CURB INLETS TOP = 570.00

**AH** STA. 0+19.60 LAT. "A5" CONTRACTOR TO CONSTRUCT STANDARD 24" CURB INLETS TOP = 570.00

**AI** STA. 0+19.60 LAT. "A5" CONTRACTOR TO CONSTRUCT STANDARD 24" CURB INLETS TOP = 570.00

**AJ** STA. 0+19.60 LAT. "A5" CONTRACTOR TO CONSTRUCT STANDARD 24" CURB INLETS TOP = 570.00

**AK** STA. 0+19.60 LAT. "A5" CONTRACTOR TO CONSTRUCT STANDARD 24" CURB INLETS TOP = 570.00

**AL** STA. 0+19.60 LAT. "A5" CONTRACTOR TO CONSTRUCT STANDARD 24" CURB INLETS TOP = 570.00

**AM** STA. 0+19.60 LAT. "A5" CONTRACTOR TO CONSTRUCT STANDARD 24" CURB INLETS TOP = 570.00

**AN** STA. 0+19.60 LAT. "A5" CONTRACTOR TO CONSTRUCT STANDARD 24" CURB INLETS TOP = 570.00

**AO** STA. 0+19.60 LAT. "A5" CONTRACTOR TO CONSTRUCT STANDARD 24" CURB INLETS TOP = 570.00

**AP** STA. 0+19.60 LAT. "A5" CONTRACTOR TO CONSTRUCT STANDARD 24" CURB INLETS TOP = 570.00

**AQ** STA. 0+19.60 LAT. "A5" CONTRACTOR TO CONSTRUCT STANDARD 24" CURB INLETS TOP = 570.00

**AR** STA. 0+19.60 LAT. "A5" CONTRACTOR TO CONSTRUCT STANDARD 24" CURB INLETS TOP = 570.00

**AS** STA. 0+19.60 LAT. "A5" CONTRACTOR TO CONSTRUCT STANDARD 24" CURB INLETS TOP = 570.00

**AT** STA. 0+19.60 LAT. "A5" CONTRACTOR TO CONSTRUCT STANDARD 24" CURB INLETS TOP = 570.00

**AV** STA. 0+19.60 LAT. "A5" CONTRACTOR TO CONSTRUCT STANDARD 24" CURB INLETS TOP = 570.00

**AW** STA. 0+19.60 LAT. "A5" CONTRACTOR TO CONSTRUCT STANDARD 24" CURB INLETS TOP = 570.00

**AX** STA. 0+19.60 LAT. "A5" CONTRACTOR TO CONSTRUCT STANDARD 24" CURB INLETS TOP = 570.00

**AY** STA. 0+19.60 LAT. "A5" CONTRACTOR TO CONSTRUCT STANDARD 24" CURB INLETS TOP = 570.00

**AZ** STA. 0+19.60 LAT. "A5" CONTRACTOR TO CONSTRUCT STANDARD 24" CURB INLETS TOP = 570.00

**BA** STA. 0+19.60 LAT. "A5" CONTRACTOR TO CONSTRUCT STANDARD 24" CURB INLETS TOP = 570.00

**BB** STA. 0+19.60 LAT. "A5" CONTRACTOR TO CONSTRUCT STANDARD 24" CURB INLETS TOP = 570.00

Printed: Aug 2, 2008 1:23 PM by user: ash, Sheet: 701 (2/2008) by user: ash, W:\projects\shw\rockwall\utley\storm\additions\802\SET2008\UTLEY\SCH\NAT\REV3.dwg