

ROCKWALL COUNTY
COURTHOUSE
ROCKWALL COUNTY
ROCKWALL, TEXAS

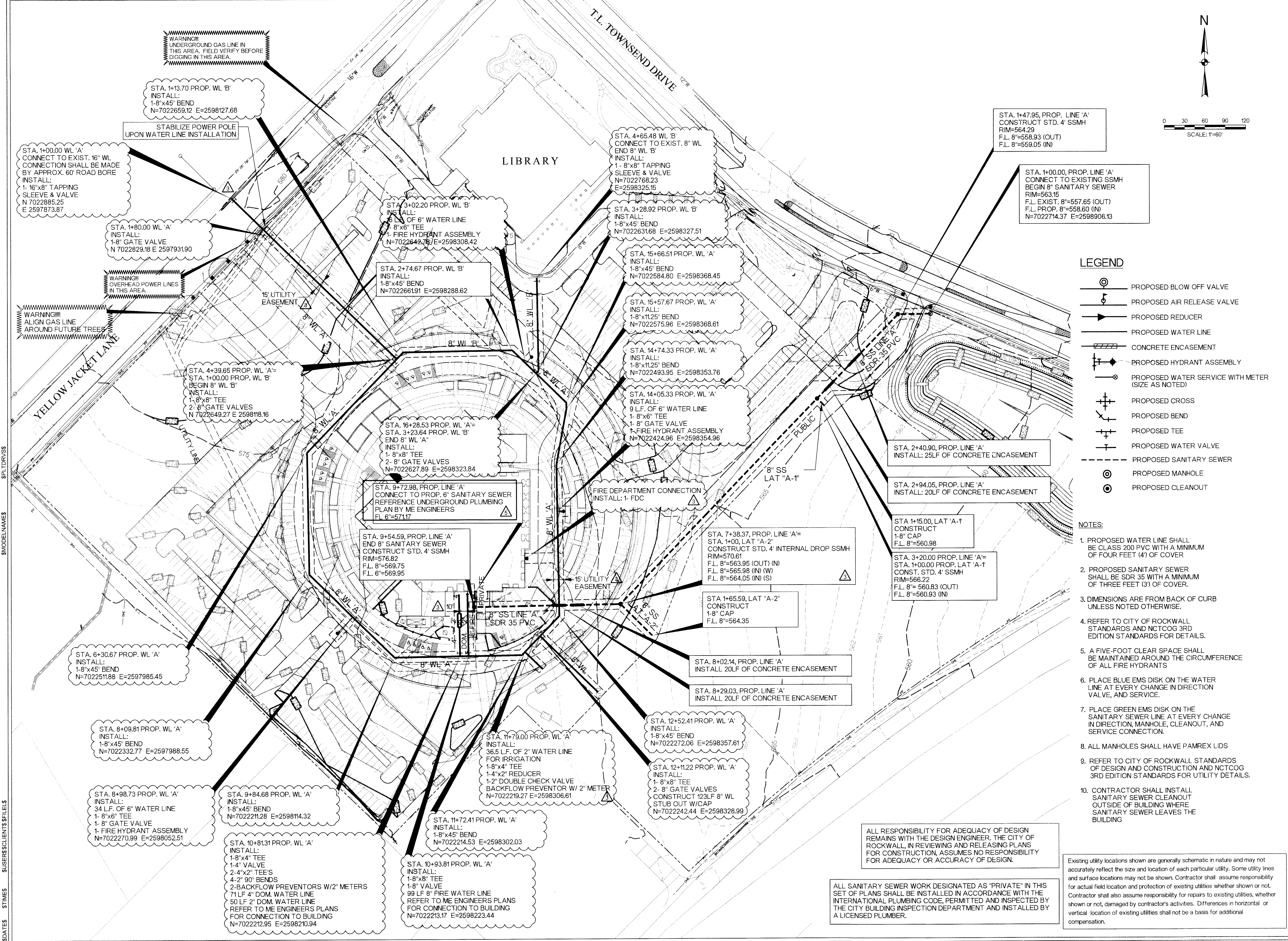
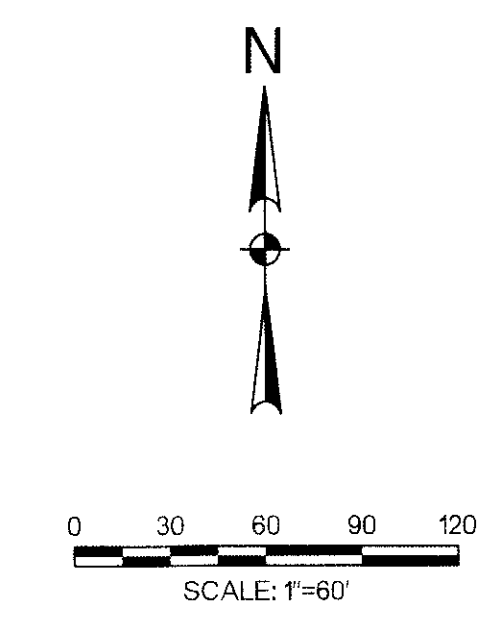

LEGEND

- PROPOSED BLOW OFF VALVE
- PROPOSED AIR RELEASE VALVE
- PROPOSED REDUCER
- PROPOSED WATER LINE
- CONCRETE ENCASUREMENT
- PROPOSED HYDRANT ASSEMBLY
- PROPOSED WATER SERVICE WITH METER (SIZE AS NOTED)
- PROPOSED CROSS
- PROPOSED BEND
- PROPOSED TEE
- PROPOSED WATER VALVE
- PROPOSED SANITARY SEWER
- PROPOSED MANHOLE
- PROPOSED CLEANOUT

NOTES:

1. PROPOSED WATER LINE SHALL BE CLASS 200 PVC WITH A MINIMUM OF FOUR FEET (4') OF COVER
2. PROPOSED SANITARY SEWER SHALL BE SDR 35 WITH A MINIMUM OF THREE FEET (3') OF COVER.
3. DIMENSIONS ARE FROM BACK OF CURB UNLESS NOTED OTHERWISE.
4. REFER TO CITY OF ROCKWALL STANDARDS AND NCTCOG 3RD EDITION STANDARDS FOR DETAILS.
5. A FIVE-FOOT CLEAR SPACE SHALL BE MAINTAINED AROUND THE CIRCUMFERENCE OF ALL FIRE HYDRANTS
6. PLACE BLUE EMS DISK ON THE WATER LINE AT EVERY CHANGE IN DIRECTION VALVE, AND SERVICE.
7. PLACE GREEN EMS DISK ON THE SANITARY SEWER LINE AT EVERY CHANGE IN DIRECTION, MANHOLE, CLEANOUT, AND SERVICE CONNECTION.
8. ALL MANHOLES SHALL HAVE PAMREX LIDS
9. REFER TO CITY OF ROCKWALL STANDARDS OF DESIGN AND CONSTRUCTION AND NCTCOG 3RD EDITION STANDARDS FOR UTILITY DETAILS.
10. CONTRACTOR SHALL INSTALL SANITARY SEWER CLEANOUT OUTSIDE OF BUILDING WHERE SANITARY SEWER LEAVES THE BUILDING

ALL RESPONSIBILITY FOR ADEQUACY OF DESIGN REMAINS WITH THE DESIGN ENGINEER. THE CITY OF ROCKWALL, IN REVIEWING AND RELEASING PLANS FOR CONSTRUCTION, ASSUMES NO RESPONSIBILITY FOR ADEQUACY OR ACCURACY OF DESIGN.

ALL SANITARY SEWER WORK DESIGNATED AS 'PRIVATE' IN THIS SET OF PLANS SHALL BE INSTALLED IN ACCORDANCE WITH THE INTERNATIONAL PLUMBING CODE, PERMITTED AND INSPECTED BY THE CITY BUILDING INSPECTION DEPARTMENT AND INSTALLED BY A LICENSED PLUMBER.

Existing utility locations shown are generally schematic in nature and may not accurately reflect the size and location of each particular utility. Some utility lines and surface locations may not be shown. Contractor shall assume responsibility for actual field location and protection of existing utilities whether shown or not. Contractor shall also assume responsibility for repairs to existing utilities, whether shown or not, damaged by contractor's activities. Differences in horizontal or vertical location of existing utilities shall not be a basis for additional compensation.

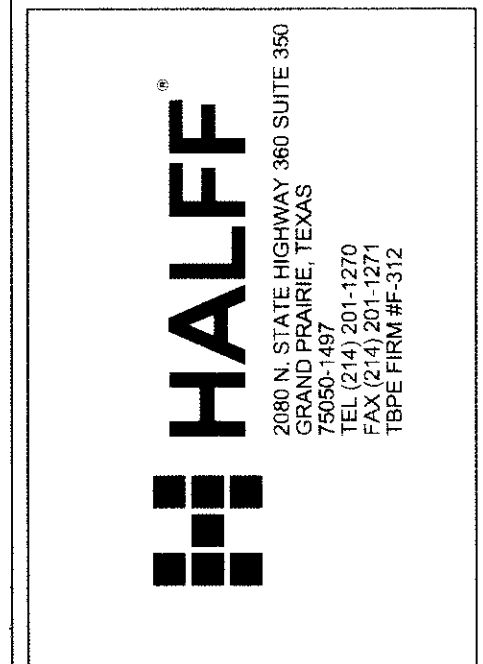

Revision No.	Date	Description
1	04/06/2010	SITE PLAN REVISIONS
2	05/05/2010	CITY COMMENTS
3	08/16/2010	REVISE SS FLOWLINE

RECORD DRAWING
APRIL 2011
These Record Documents have been prepared based upon information provided by Manhattan Construction. The Design Professional has not verified the accuracy and / or completeness of this information and shall not be responsible for any errors or omissions which may be incorporated herein as a result. Design Consultant: Half Associates, Inc. RECORD DRAWING SUBMITTAL

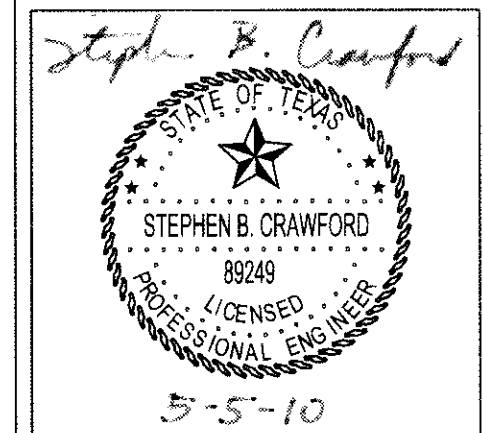

Project No.:	26244
Issued:	APRIL 2011
Drawn By:	BJG
Checked By:	SBC
Scale:	AS NOTED
Sheet Title:	UTILITY PLAN
Sheet Number:	C6.01

SDATES STIMES SUBSERSCLIENTS\$FILELS \$PLTDIVS\$