

ALL RESPONSIBILITY FOR ADEQUACY OF DESIGN REMAINS WITH THE DESIGN ENGINEER. THE CITY OF ROCKWALL, IN REVIEWING AND RELEASING PLANS FOR CONSTRUCTION, ASSUMES NO RESPONSIBILITY FOR ADEQUACY OR ACCURACY OF DESIGN.

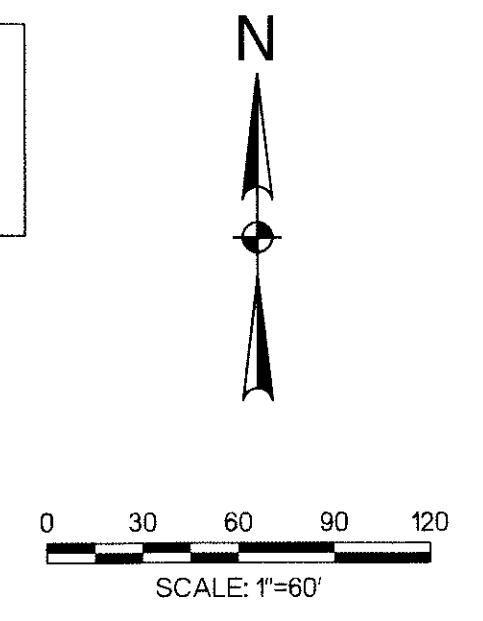

**ROCKWALL COUNTY
COURTHOUSE**
ROCKWALL COUNTY
ROCKWALL, TEXAS



2000 N. STATE HIGHWAY 960, SUITE 350
GRAND PRAIRIE, TEXAS
TEL: (214) 201-1270
FAX: (214) 201-1271
TYPE: PRR#-512

Revision No.	Date	Description

RECORD DRAWING
APRIL, 2011
These Record Documents have been prepared based upon information provided by Manhattan Construction. The Design Professional has not verified the accuracy and / or completeness of this information and shall not be responsible for any errors or omissions which may be incorporated herein as a result of Design Consultant, Half Associates, Inc.
RECORD DRAWING SUBMITTAL

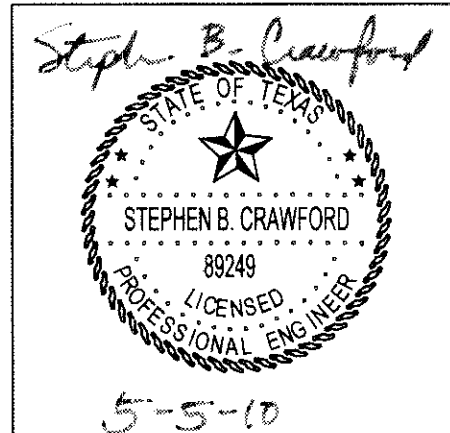

Project No.: 26244
Issued: APRIL 2011
Drawn By: B.J.G.
Checked By: SBC
Scale: AS NOTED

Sheet Title
SURVEY CONTROL PLAN

C0.03
Sheet Number

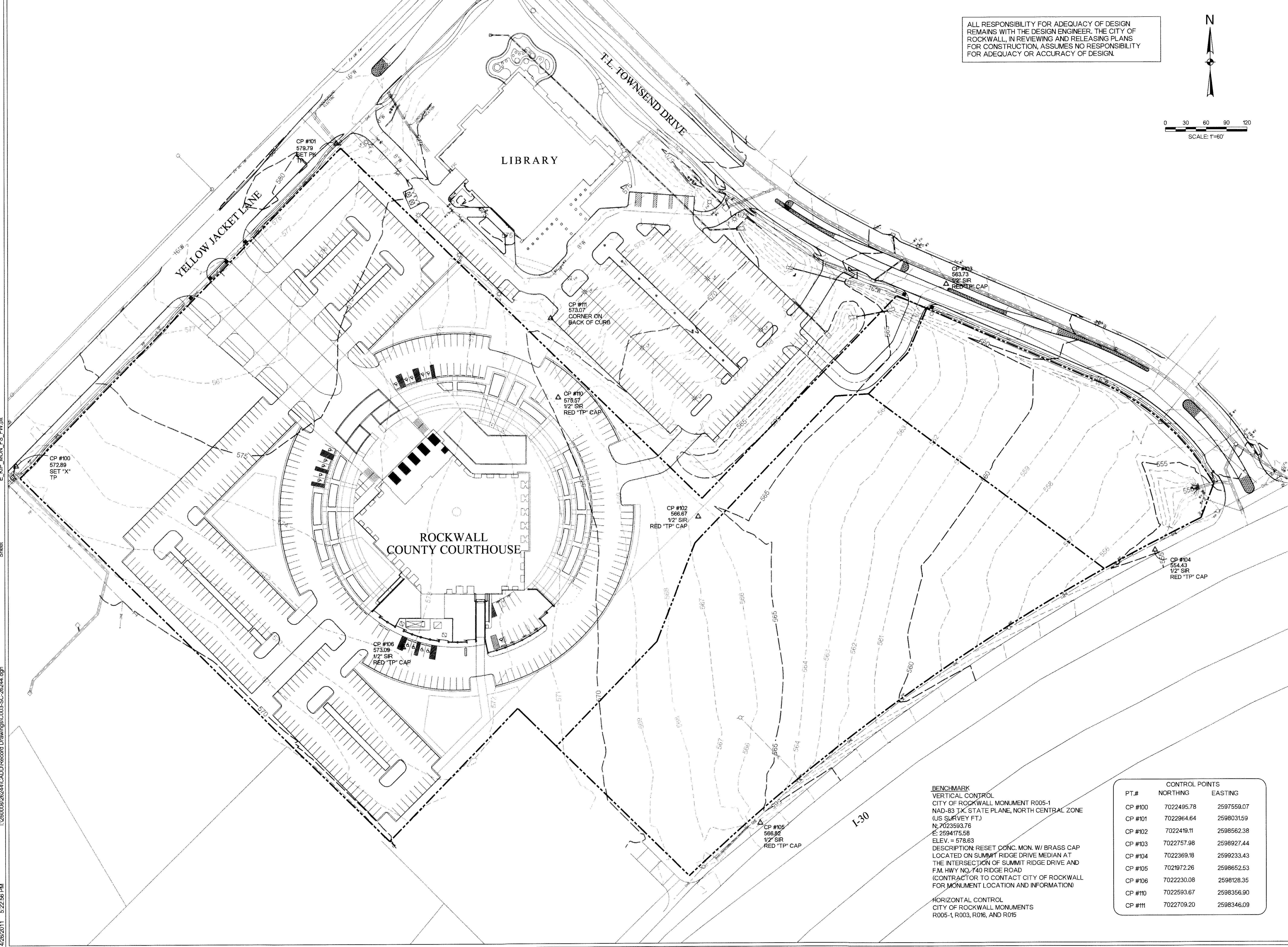

BENCHMARK
VERTICAL CONTROL
CITY OF ROCKWALL MONUMENT R005-1
NAD-83 TX. STATE PLANE, NORTH CENTRAL ZONE
(US SURVEY FT.)
N: 7023593.76
E: 2594175.58
ELEV. = 578.63
DESCRIPTION: RESET CONC. MON. W/ BRASS CAP
LOCATED ON SUMMIT RIDGE DRIVE MEDIAN AT
THE INTERSECTION OF SUMMIT RIDGE DRIVE AND
F.M. HWY NO. 740 RIDGE ROAD
(CONTRACTOR TO CONTACT CITY OF ROCKWALL
FOR MONUMENT LOCATION AND INFORMATION)

HORIZONTAL CONTROL
CITY OF ROCKWALL MONUMENTS
R005-1, R003, R016, AND R015

PT.#	CONTROL POINTS	
	NORTHING	EASTING
CP #100	7022495.78	2597559.07
CP #101	7022964.64	2598031.59
CP #102	7022419.11	2598562.38
CP #103	7022757.98	2598927.44
CP #104	7022369.18	2599233.43
CP #105	7021972.26	2598652.53
CP #106	7022230.08	2598128.35
CP #110	7022593.67	2598356.90
CP #111	7022709.20	2598346.09

E:\KIP_MON_FS_FW.dwg

Sheet

I:\26000s\26244\CADD\Record Drawings\C003-SC-26244.dgn

4/26/2011 5:22:56 PM