

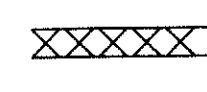

**ROCKWALL COUNTY
COURTHOUSE
ROCKWALL COUNTY
ROCKWALL, TEXAS**

DEMOLITION LEGEND

-  CONCRETE PAVEMENT TO BE SAWCUT AND REMOVED
-  CONCRETE CURB AND GUTTER TO BE REMOVED
-  FULL DEPTH SAWCUT LINE
-  EXISTING TREE TO BE REMOVED

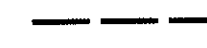

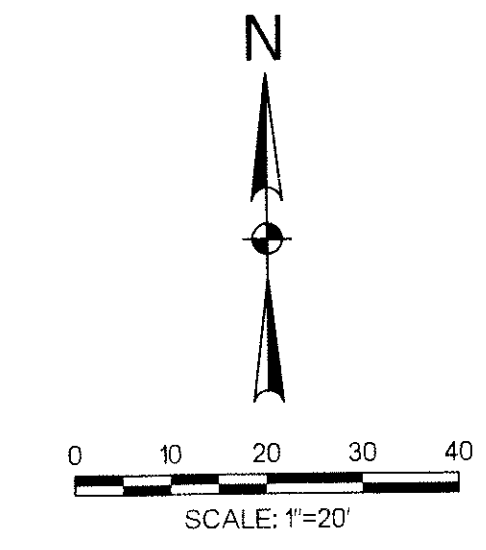
Existing utility locations shown are generally schematic in nature and may not accurately reflect the size and location of each particular utility. Some utility lines and surface locations may not be shown. Contractor shall assume responsibility for actual field location and protection of existing utilities whether shown or not. Contractor shall also assume responsibility for repairs to existing utilities, whether shown or not, damaged by contractor's activities. Differences in horizontal or vertical location of existing utilities shall not be a basis for additional compensation.

ALL RESPONSIBILITY FOR ADEQUACY OF DESIGN REMAINS WITH THE DESIGN ENGINEER. THE CITY OF ROCKWALL, IN REVIEWING AND RELEASING PLANS FOR CONSTRUCTION, ASSUMES NO RESPONSIBILITY FOR ADEQUACY OR ACCURACY OF DESIGN.

NOTES:

1. ALL DIMENSIONS ARE TO BACK OF CURB UNLESS OTHERWISE NOTED.
2. FRANCHISED UTILITIES TO BE RELOCATED BY OTHERS AS REQUIRED
3. REFER TO GENERAL NOTES SHEET FOR ADDITIONAL INFORMATION.

TEMPORARY TRAFFIC CONTROL GENERAL NOTES

1. THE CONTRACTOR SHALL PROVIDE A PROPOSED BARRICADE PLAN AND A TRAFFIC CONTROL PLAN FOR ALL WORK SITE CONDITIONS FOR APPROVAL BY THE CITY OF ROCKWALL.
2. THE CONTRACTOR SHALL BE RESPONSIBLE TO MAINTAIN ALL WORK ZONE TRAFFIC CONTROL DEVICES, INCLUDING SIGNING AND BARRICADING, 24-HOURS A DAY, UNTIL ALL WORK IS COMPLETED.
3. THE INSPECTOR SHALL HAVE THE AUTHORITY TO STOP ALL WORK UNTIL THE CONTRACTOR PROVIDES THE PROPER TRAFFIC CONTROL FOR THE GIVEN CONDITIONS.
4. THE CONTRACTOR SHALL GIVE ALL RESIDING AND/OR BUSINESSES AT LEAST 24-HOUR ADVANCED NOTICE BEFORE CLOSING ANY DRIVEWAYS OR ALLEYS.
5. NO ROADWAY SHALL BE COMPLETELY CLOSED TO THROUGH TRAFFIC WITHOUT AUTHORIZATION FROM THE CITY OF ROCKWALL. THE CONTRACTOR SHALL NOTIFY THE CITY TWO (2) WEEKS PRIOR TO ANY REQUESTED ROADWAY CLOSURE.

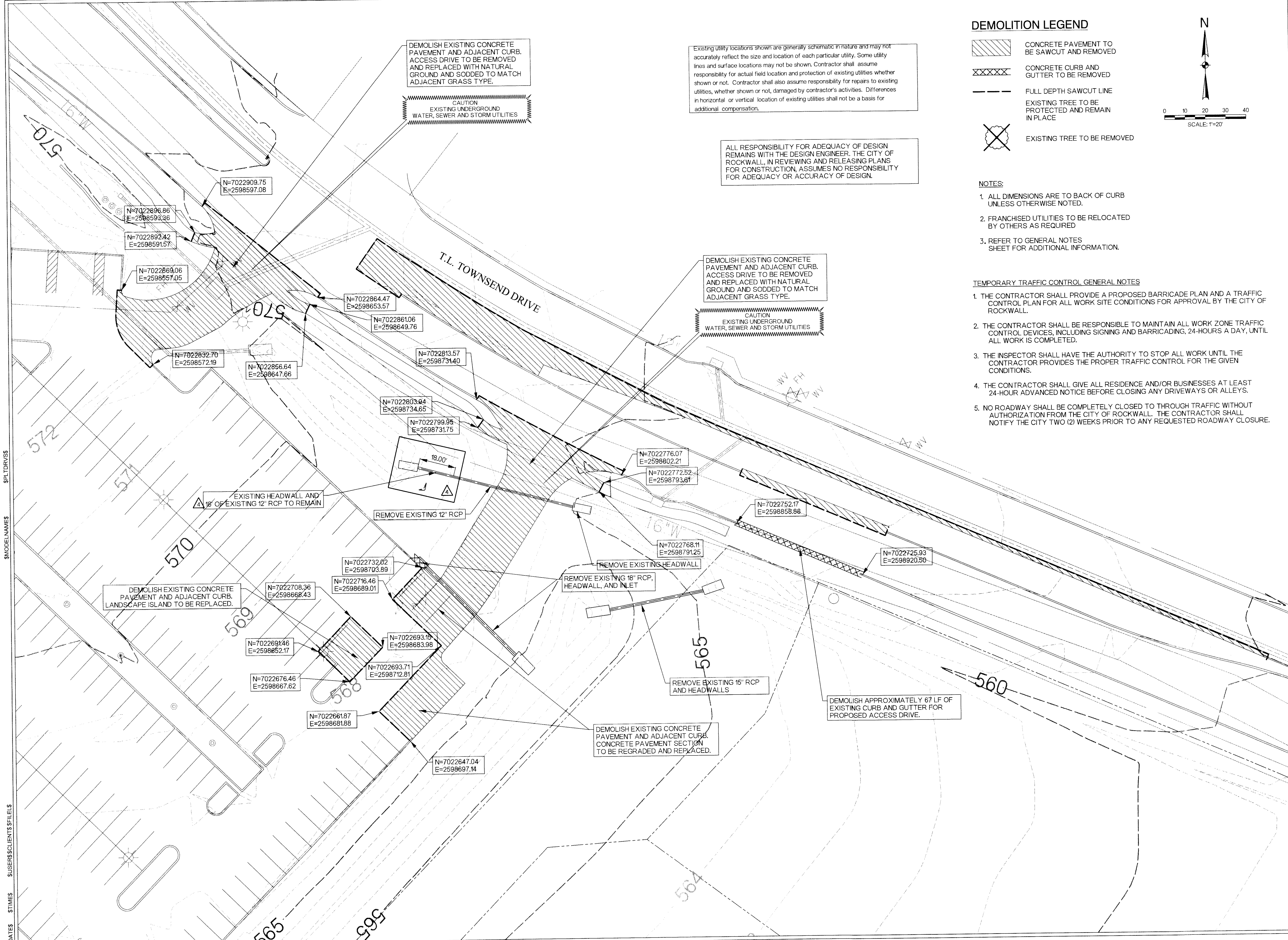

DEMOLISH EXISTING CONCRETE PAVEMENT AND ADJACENT CURB. ACCESS DRIVE TO BE REMOVED AND REPLACED WITH NATURAL GROUND AND SODDED TO MATCH ADJACENT GRASS TYPE.

CAUTION
EXISTING UNDERGROUND WATER, SEWER AND STORM UTILITIES

DEMOLISH EXISTING CONCRETE PAVEMENT AND ADJACENT CURB. ACCESS DRIVE TO BE REMOVED AND REPLACED WITH NATURAL GROUND AND SODDED TO MATCH ADJACENT GRASS TYPE.

CAUTION
EXISTING UNDERGROUND WATER, SEWER AND STORM UTILITIES

DEMOLISH EXISTING CONCRETE PAVEMENT AND ADJACENT CURB. LANDSCAPE ISLAND TO BE REPLACED.

EXISTING HEADWALL AND 18' OF EXISTING 12" RCP TO REMAIN

REMOVE EXISTING 12" RCP

REMOVE EXISTING 18" RCP, HEADWALL, AND INLET

REMOVE EXISTING 15" RCP AND HEADWALLS

DEMOLISH EXISTING CONCRETE PAVEMENT AND ADJACENT CURB. CONCRETE PAVEMENT SECTION TO BE REGRADED AND REPLACED.

DEMOLISH APPROXIMATELY 67 LF OF EXISTING CURB AND GUTTER FOR PROPOSED ACCESS DRIVE.

Revision No.	Date	Description
1	04/06/2010	DEMO LANDSCAPE ISLAND
2	07/19/2010	12" RCP TO REMAIN

RECORD DRAWING
APRIL 2011
These Record Documents have been prepared based upon information provided by Manhattan Construction. The Design Professional has not verified the accuracy and/or completeness of this information and shall not be responsible for any errors or omissions which may be incorporated herein as a result of Design Consultant: Halff Associates, Inc.
RECORD DRAWING SUBMITTAL

Stephen B. Crawford

 7/19/10

Project No:	26244
Issued:	APRIL 2011
Drawn By:	BJG
Checked By:	SBC
Scale:	AS NOTED
Sheet Title:	LIBRARY DEMOLITION PLAN
Sheet Number:	C2.02

SP1.TDR.VSS

MODEL NAMES

SUSERS\$CLIENTS\$FILES

STATES \$TIMES