

TYPICAL RIPRAP DETAIL
N.T.S.

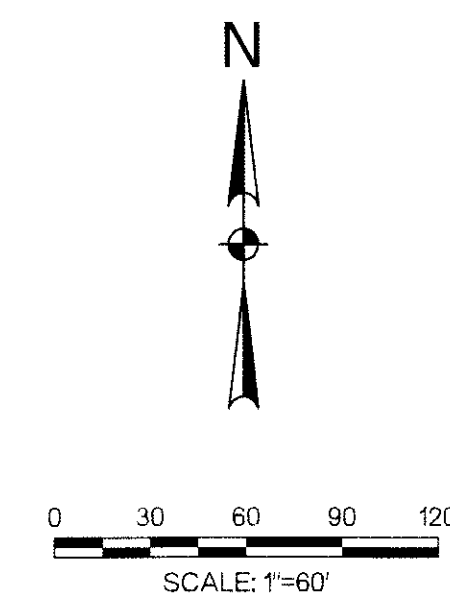

ROCKWALL COUNTY
COURTHOUSE
ROCKWALL COUNTY
ROCKWALL, TEXAS

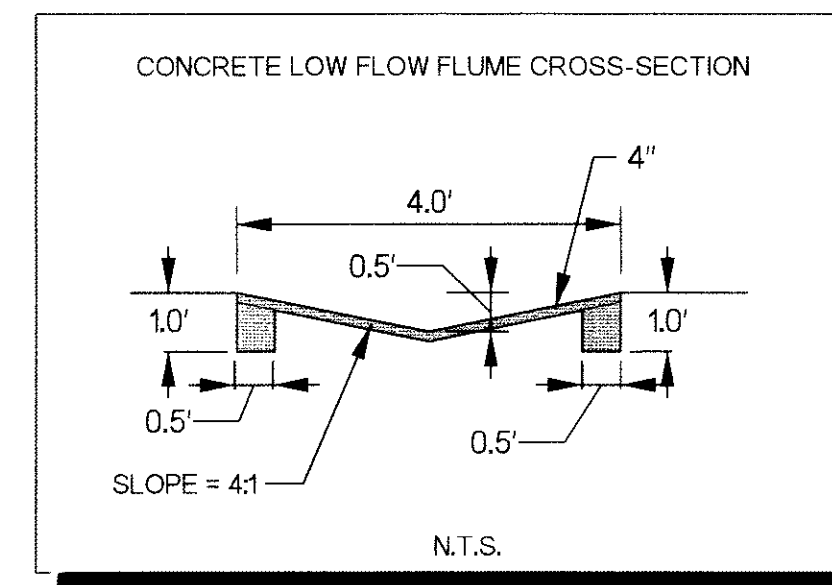

Revision No.	Date	Description
1	04/06/2010	SITE PLAN REVISIONS
2	04/19/2010	PIPE MATERIAL CHANGE FROM HDPE TO RCP
3	05/05/2010	LABEL STORM DRAIN PRIVATE
4	07/19/2010	ADD 12" STORM DRAIN
5	03/28/2011	CHANGE HDPE TO RCP AS-BUILT ELEVATIONS

RECORD DRAWING

APRIL 2011
These Record Drawings have been prepared based upon information provided by Manhattan Construction. The Design Professional has not verified the accuracy and / or completeness of this information and shall not be responsible for any errors or omissions which may be incorporated herein as a result. Design Consultant: Halff Associates, Inc. RECORD DRAWING SUBMITTAL

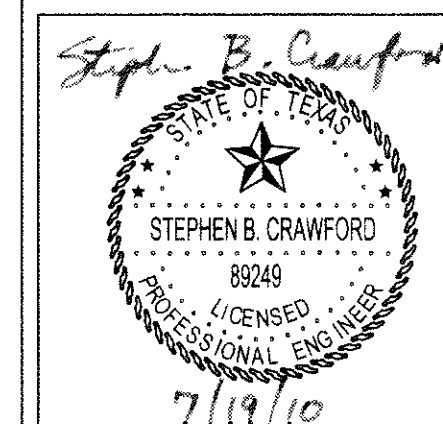

Project No.:	26244
Issued:	APRIL 2011
Drawn By:	BJG
Checked By:	SBG
Scale:	AS NOTED

Sheet Title
ROOF DRAIN COLLECTOR & FLUME PLAN

C5.04

Sheet Number

SPL'DRVSS

\$MODEL\$NAMES

\$DATES \$TIMES \$USERS\$CLIENTS\$FILES

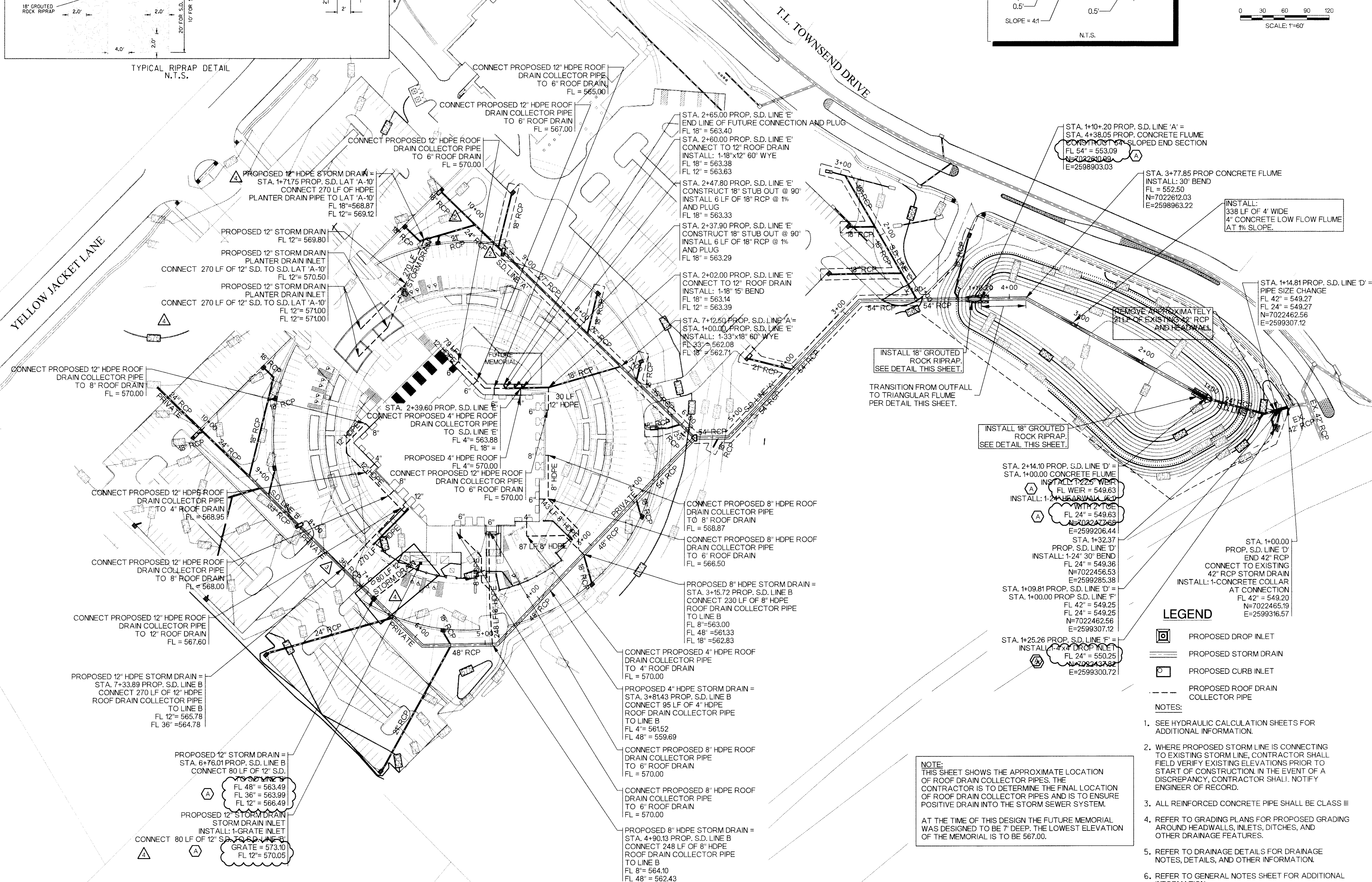

INSTALL 18" GROUTED ROCK RIPRAP SEE DETAIL THIS SHEET.
TRANSITION FROM OUTFALL TO TRIANGULAR FLUME PER DETAIL THIS SHEET.

INSTALL 18" GROUTED ROCK RIPRAP SEE DETAIL THIS SHEET.

STA. 2+14.00 PROP. S.D. LINE 'D' = STA. 1+00.00 CONCRETE FLUME
INSTALL: 1-24" 30" BEND
FL 24" = 549.63
FL 24" = 549.63
N=7022462.56
E=2599206.44

STA. 1+32.37 PROP. S.D. LINE 'D' INSTALL: 1-24" 30" BEND
FL 24" = 549.36
N=7022462.56
E=2599285.38

STA. 1+09.81 PROP. S.D. LINE 'D' = STA. 1+00.00 PROP. S.D. LINE 'F'
FL 42" = 549.25
FL 24" = 549.25
N=7022462.56
E=2599307.12

STA. 1+25.26 PROP. S.D. LINE 'F' = INSTALL: 1-4" X 24" DROP INLET
FL 24" = 550.25
N=7022462.56
E=2599300.72

LEGEND

- PROPOSED DROP INLET
- PROPOSED STORM DRAIN
- PROPOSED CURB INLET
- PROPOSED ROOF DRAIN COLLECTOR PIPE

NOTES:

1. SEE HYDRAULIC CALCULATION SHEETS FOR ADDITIONAL INFORMATION.
2. WHERE PROPOSED STORM LINE IS CONNECTING TO EXISTING STORM LINE, CONTRACTOR SHALL FIELD VERIFY EXISTING ELEVATIONS PRIOR TO START OF CONSTRUCTION. IN THE EVENT OF A DISCREPANCY, CONTRACTOR SHALL NOTIFY ENGINEER OF RECORD.
3. ALL REINFORCED CONCRETE PIPE SHALL BE CLASS III
4. REFER TO GRADING PLANS FOR PROPOSED GRADING AROUND HEADWALLS, INLETS, DITCHES, AND OTHER DRAINAGE FEATURES.
5. REFER TO DRAINAGE DETAILS FOR DRAINAGE NOTES, DETAILS, AND OTHER INFORMATION.
6. REFER TO GENERAL NOTES SHEET FOR ADDITIONAL INFORMATION.

NOTE:
THIS SHEET SHOWS THE APPROXIMATE LOCATION OF ROOF DRAIN COLLECTOR PIPES. THE CONTRACTOR IS TO DETERMINE THE FINAL LOCATION OF ROOF DRAIN COLLECTOR PIPES AND IS TO ENSURE POSITIVE DRAIN INTO THE STORM SEWER SYSTEM.

AT THE TIME OF THIS DESIGN THE FUTURE MEMORIAL WAS DESIGNED TO BE 7' DEEP. THE LOWEST ELEVATION OF THE MEMORIAL IS TO BE 567.00.