

1 SODDING WITH PINS
 L2 SCALE: N.T.S.

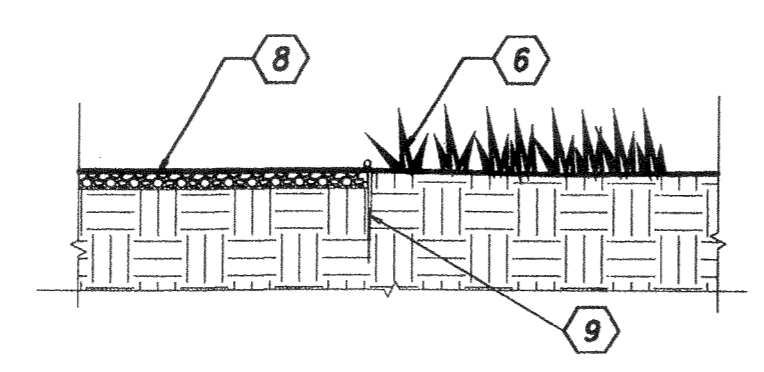

2 GRAVEL/LANDSCAPE FABRIC
 L2 SCALE: 3/8" = 1'-0"

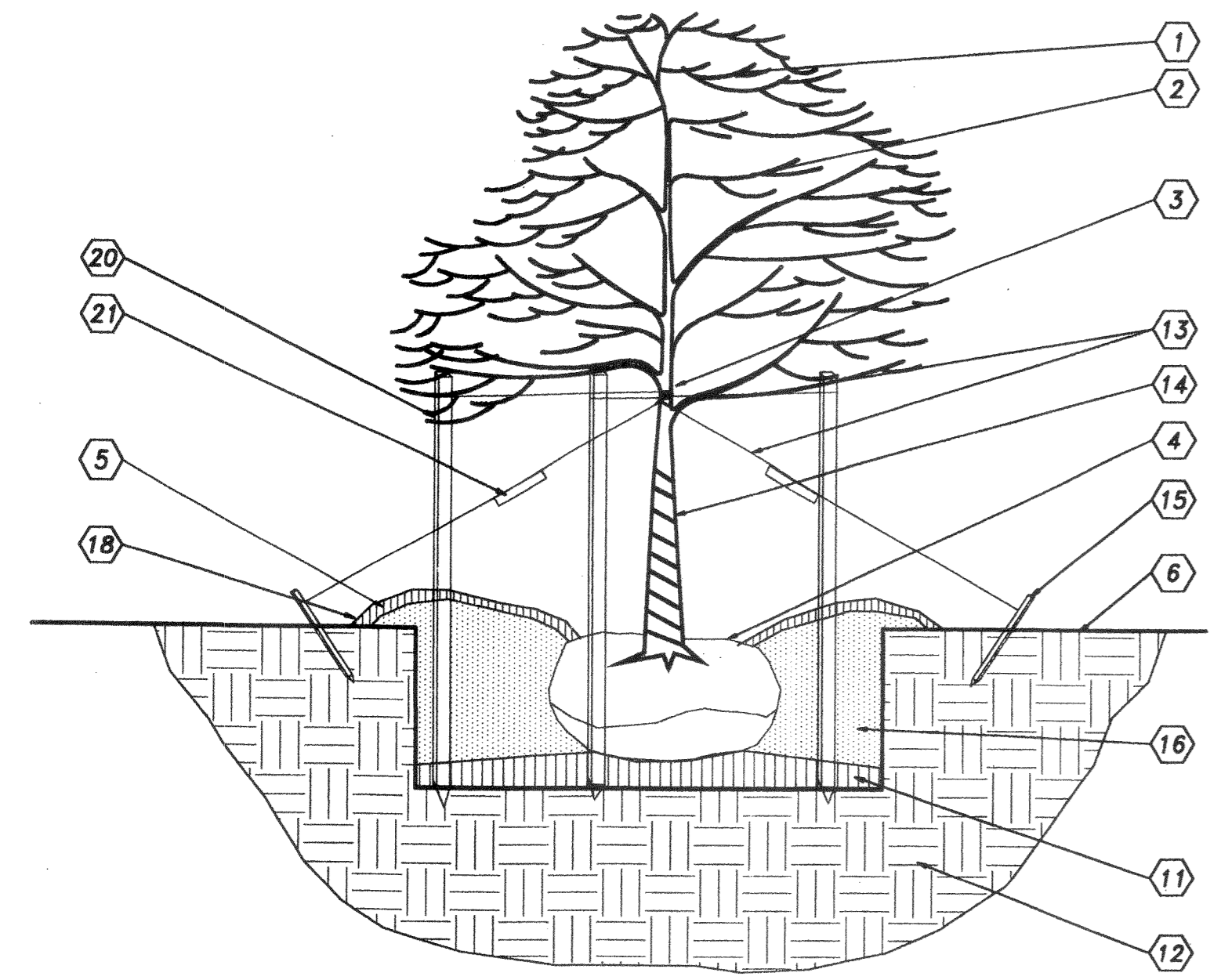

3 LARGE DECIDUOUS TREE PLANTING
 L2 SCALE: 1/4" = 1'-0"

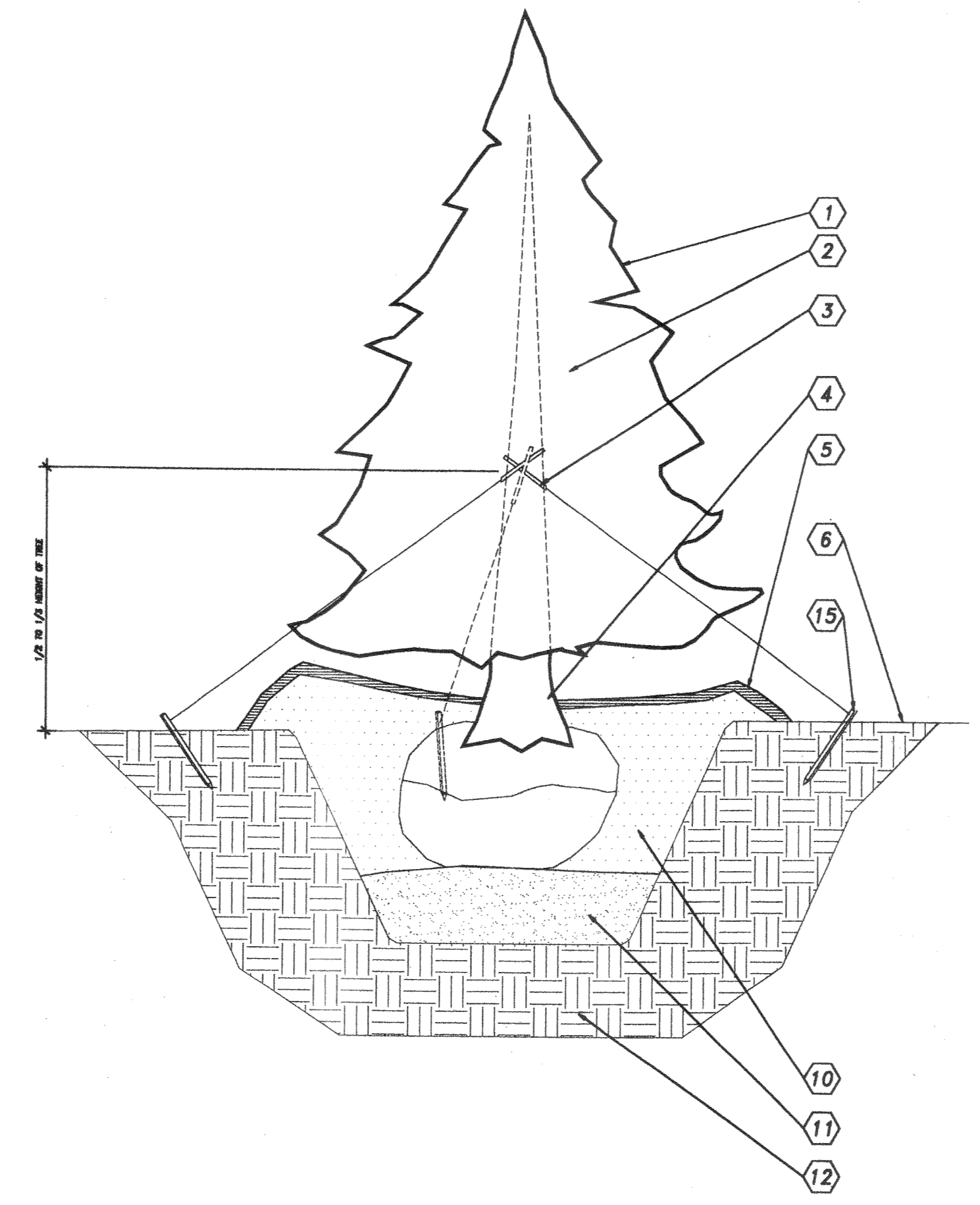
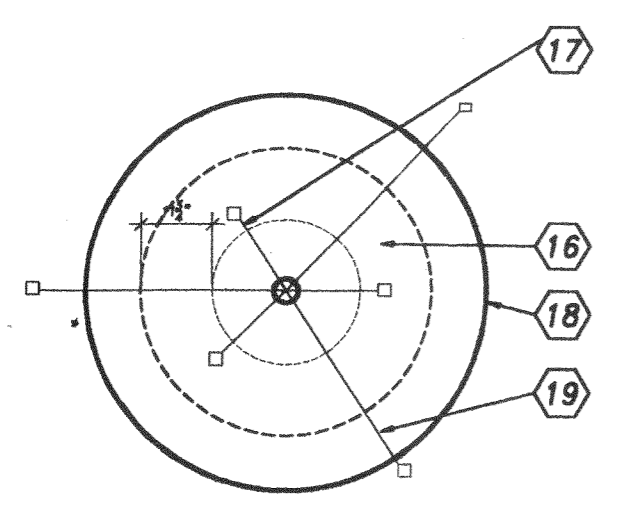

4 LARGE EVERGREEN TREE PLANTING
 L2 SCALE: 3/8" = 1'-0"

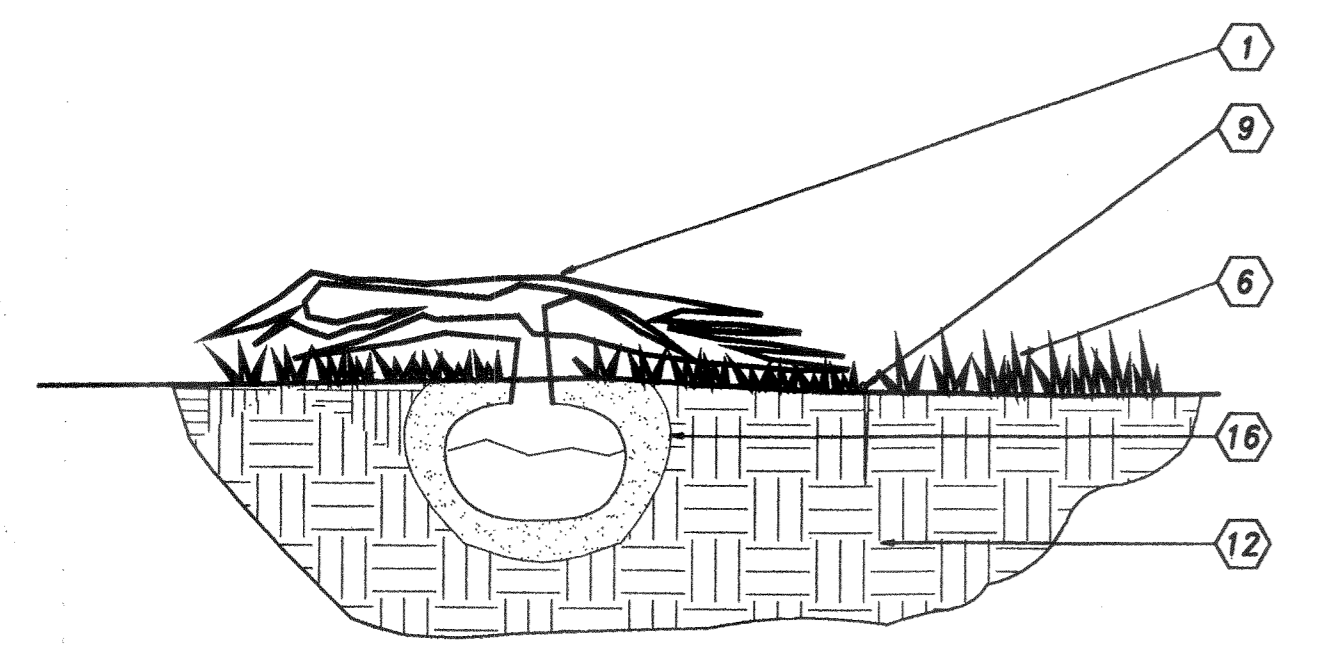

5 SMALL SHRUB PLANTING
 L2 SCALE: N.T.S.

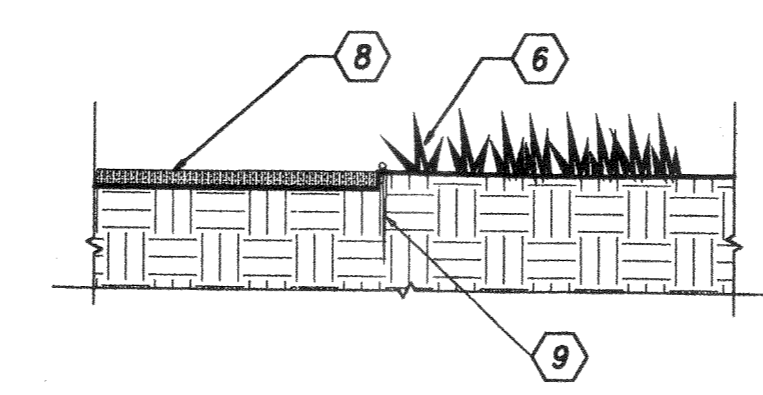

6 MULCH/LANDSCAPE FABRIC
 L2 SCALE: 3/8" = 1'-0"

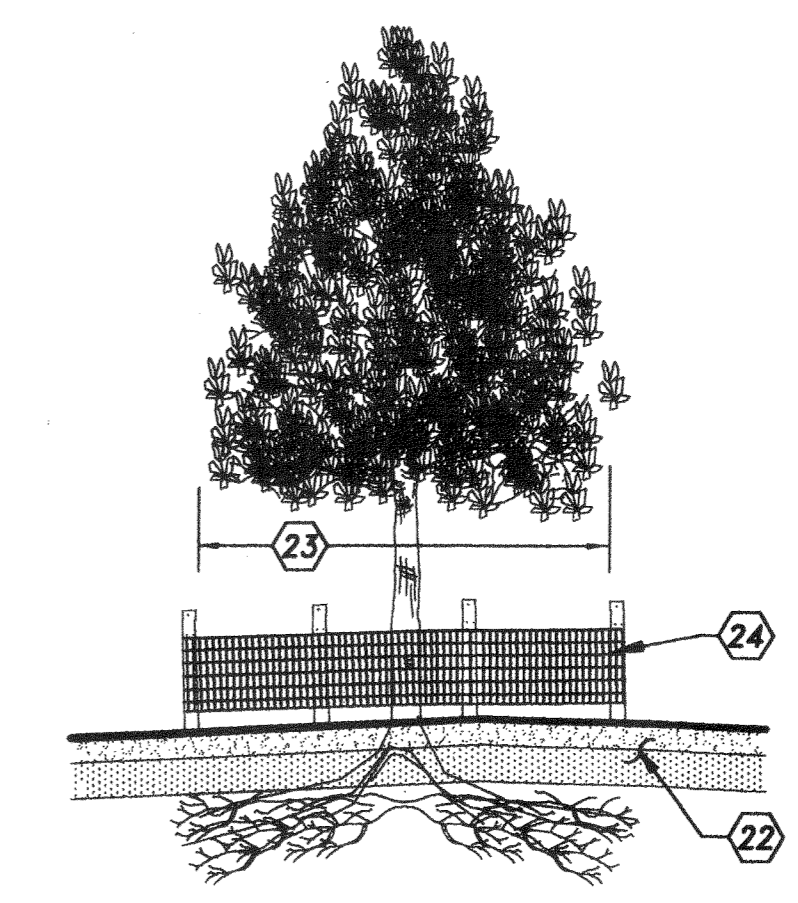

7 TREE PROTECTION DETAIL
 L2 SCALE: N.T.S.

GENERAL NOTES:
 A. REFER TO PROJECT MANUAL FOR ADDITIONAL REQUIREMENTS.
 B. COORDINATE WORK WITH OTHER SITE RELATED DEVELOPMENT DRAWINGS.

LANDSCAPE DETAIL KEY NOTES:

- 1 PLANTING, REFER SCHEDULE FOR TYPE.
- 2 SET TREE LEVEL & PLUM - STRAIGHTEN AFTER SETTLEMENT IF REQUIRED
- 3 ENCASE WIRE AROUND TRUNK IN BLACK RUBBER. MOVE UP ABOVE EQUAL TO 1/2 TO 1/3 HEIGHT OF TREE
- 4 SET TREE WITH TOP 1/3 OF ROOT ABOVE FINISH GRADE
- 5 REFER TO LANDSCAPE PLAN FOR GROUND COVER TYPE AND LOCATIONS. PROVIDE 3" DEEP 5/8" CREEK GRAVEL OVER FILTER FABRIC - OR - 3" TO 4" SHREDDED CYPRESS MULCH OVER FILTER FABRIC.
- 6 LAWN AREA
- 7 REFER TO SITE GRADING PLAN FOR SLOPE. PLACE THREE PINS EVERY 2'-0", SPACING EQUALLY. SEE SPEC'S FOR ACCEPTABLE SOD VARIETIES.
- 8 3" DEEP 5/8" CREEK GRAVEL OR 3" SHREDDED CYPRESS MULCH OVER FILTER FABRIC
- 9 4" BLACK POLY VINYL EDGING
- 10 PREFERRED SOIL
- 11 COMPACTED PLANTING
- 12 SUBGRADE
- 13 TWO STRANDS OF WIRE
- 14 TRUNK WRAP
- 15 2" x 2" x 10" WOOD STAKES BURY BELOW FINISH GRADE
- 16 PREPARED PLANTING MIXTURE
- 17 TREES 6'-0" IN HEIGHT OR LESS SHALL BE STAKED
- 18 EXTENTS OF PLANTING BERM TO HOLD WATER
- 19 TREES TALLER THAN 6'-0" TO BE TIED
- 20 2" x 4" STAKE - OR - METAL FENCE POST
- 21 1" x 4" x 10" WHITE WOOD FLAG
- 22 EXISTING SOIL/GRADE
- 23 DRIPLINE OF EXISTING TREE/SHRUB
- 24 CHAIN LINK PROTECTIVE FENCE

CASCO
 10877 WATSON ROAD
 ST. LOUIS, MO 63127
 PROJECT MANAGERS

ISSUED FOR PERMIT:	
ISSUED FOR BID:	
REVISIONS:	
NO.#	DATE
REMARKS:	
REV. 1	5/05/04
ENGINEERING PLANS RESUBMITTAL	
REV. 2	5/28/04
ENGINEERING PLANS RESUBMITTAL	
REV. 3	11/11/04
ENGINEERING PLANS RESUBMITTAL	
REV. 4	12/30/04
ENGINEERING PLANS RESUBMITTAL	

O'Reilly AUTO PARTS
 PROJECT:
NEW O'REILLY AUTO PARTS STORE
RIDGE ROAD
ROCKWALL, TEXAS

233 SOUTH PATTERSON
 SPRINGFIELD, MO 65802
 PHONE: (417) 862-3333

REGISTERED PROFESSIONAL ENGINEER
 STATE OF TEXAS
 RALPH R. SHAW #7427 5/31/05
 PROFESSIONAL OF RECORD
 PHONE: 314-821-1100

JOB NO.: 904522
 DRAWN: MAD
 CHECKED: CRM
 DATE: 3/01/04
 SCALE: AS NOTED
 SHEET:

L2

LANDSCAPE DETAILS

© COPYRIGHT 2004 - DESIGNS, DRAWINGS AND SPECIFICATIONS ARE INSTRUMENTS OF SERVICE AND ARE THE PROPERTY OF THE DESIGN PROFESSIONAL. REPRODUCTION PROHIBITED WITHOUT THE EXPRESSED WRITTEN CONSENT OF THE DESIGN PROFESSIONAL.