

PLAN
SCALE: 3/16" = 1'-0"

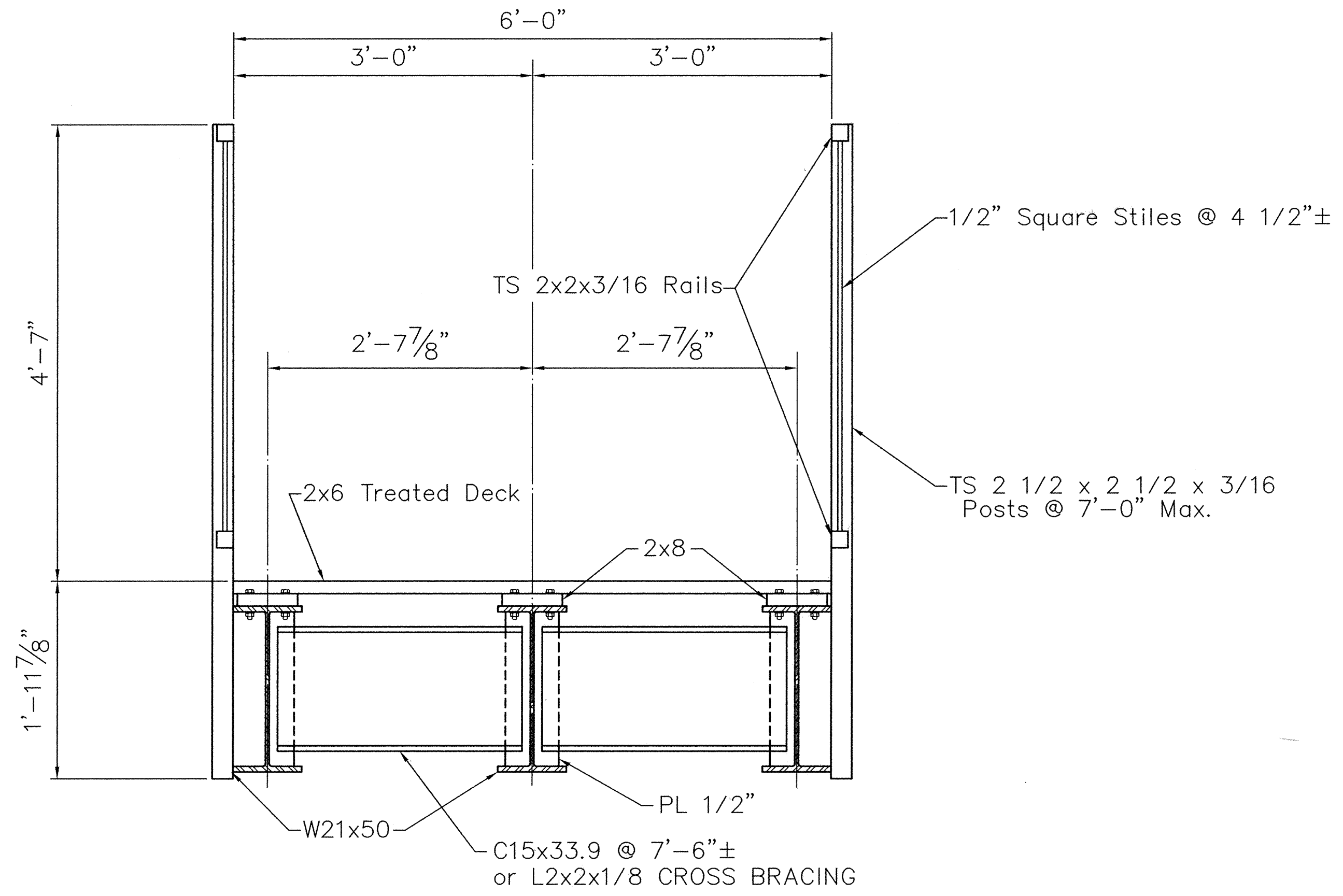

TYPICAL CROSS SECTION
SCALE: 3/16" = 1'-0"

- NOTE:
1. Timber shall be #2 So. Pine or better (Treated).
 2. Structural Steel shall be ASTM A36 (Painted).
 3. Structural Bolts shall be ASTM A307 (Painted).
 4. Welding shall be in accordance with the requirements of AWS 1.1.

RECORD DRAWINGS March 16, 2004
 NOTE: THE INTENT OF THE OWNER AND ENGINEER WAS TO CONSTRUCT THE IMPROVEMENTS ACCORDING TO THESE PLANS AS APPROVED BY THE CITY OF ROCKWALL. THE LINES AND GRADES WERE SET ON THE GROUND FOR CONSTRUCTION ACCORDING TO SAID PLANS. WE ARE NOT AWARE OF ANY CHANGES OR REVISIONS TO THESE PLANS DURING CONSTRUCTION EXCEPT AS NOTED ON THE PLANS.

Stan Reed
 THE SEAL APPEARING ON THIS DOCUMENT WAS AUTHORIZED BY STAN REED, P.E. 33685, ON 8/11/03

PLAN & TYPICAL SECTION PEDESTRIAN BRIDGE	
HILLCREST SHORES PHASE THREE ROCKWALL, TEXAS	
REEDCON	
REEDCON, INC. CONSULTING ENGINEERS Plano, Texas	
DESIGNED BY: Stan Reed	PROJECT: 2003 023
DRAWN BY: Stan Reed	DATE: MAY, 2003
SHEET NO. SB1	OF 2 SHEETS

These plans and related specifications were prepared for construction of this specific project only. Reuse of these documents is not permitted without written authorization of Reedcon, Inc.

2003 023 FEBRUARY, 2003 © Copyright 2003 Reedcon, Inc. Made in Texas