

DISCLAIMER
 The use of this standard is governed by the "Texas Engineering Practice Act". No warranty of any kind is made by TxDOT for any purpose whatsoever. TxDOT assumes no responsibility for the conversion of this standard to other formats or for incorrect results or damages resulting from its use.

LEVELS DISPLAYED
 ACC:
 1 2 3 4 5 6 7 8 9 10 11 12 13 14 15 16
 17 18 19 20 21 22 23 24 25 26 27 28 29 30 31 32
 33 34 35 36 37 38 39 40 41 42 43 44 45 46 47 48
 49 50 51 52 53 54 55 56 57 58 59 60 61 62 63

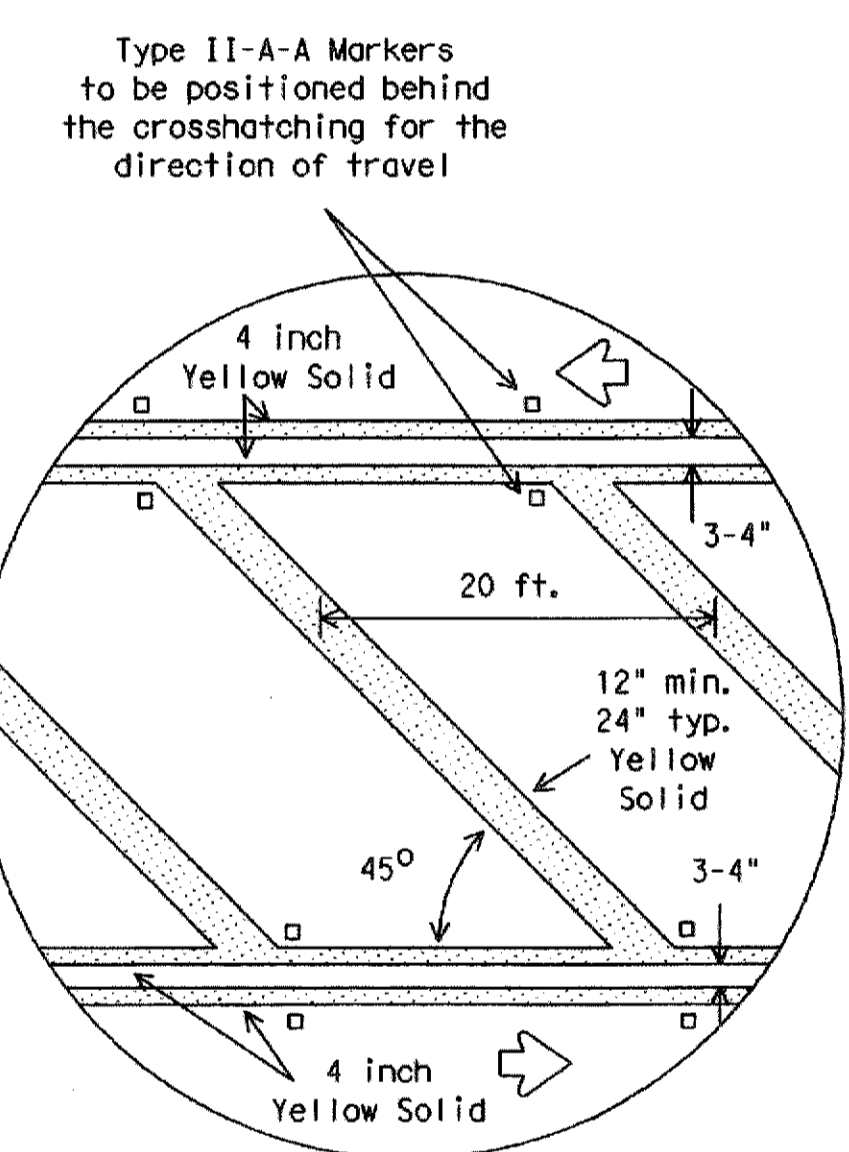

DETAIL A

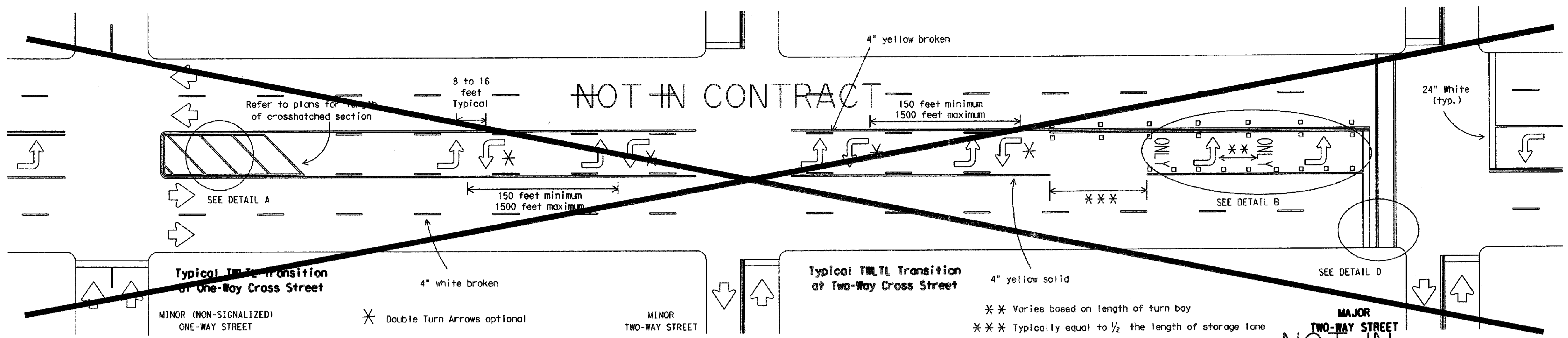
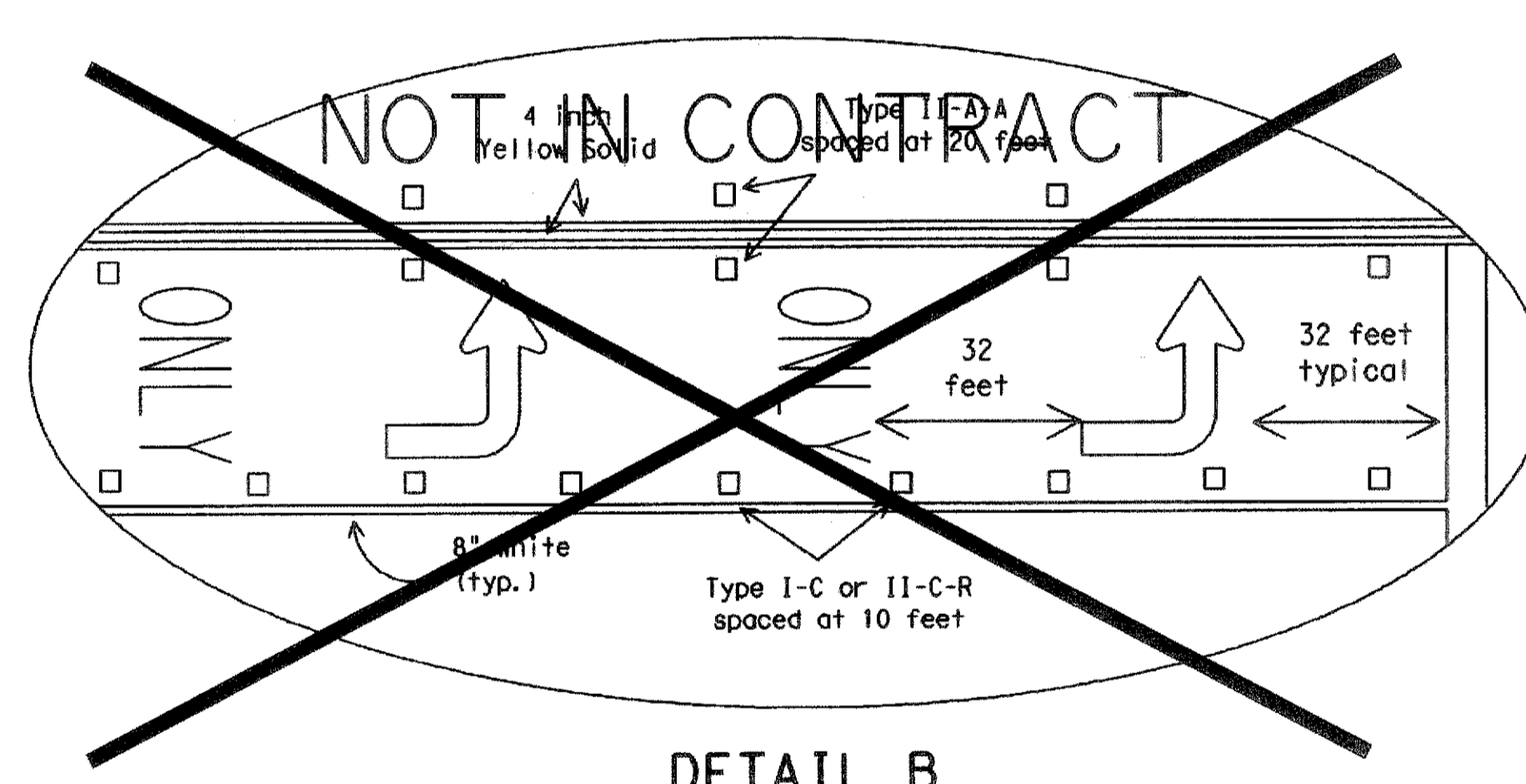

DETAIL B

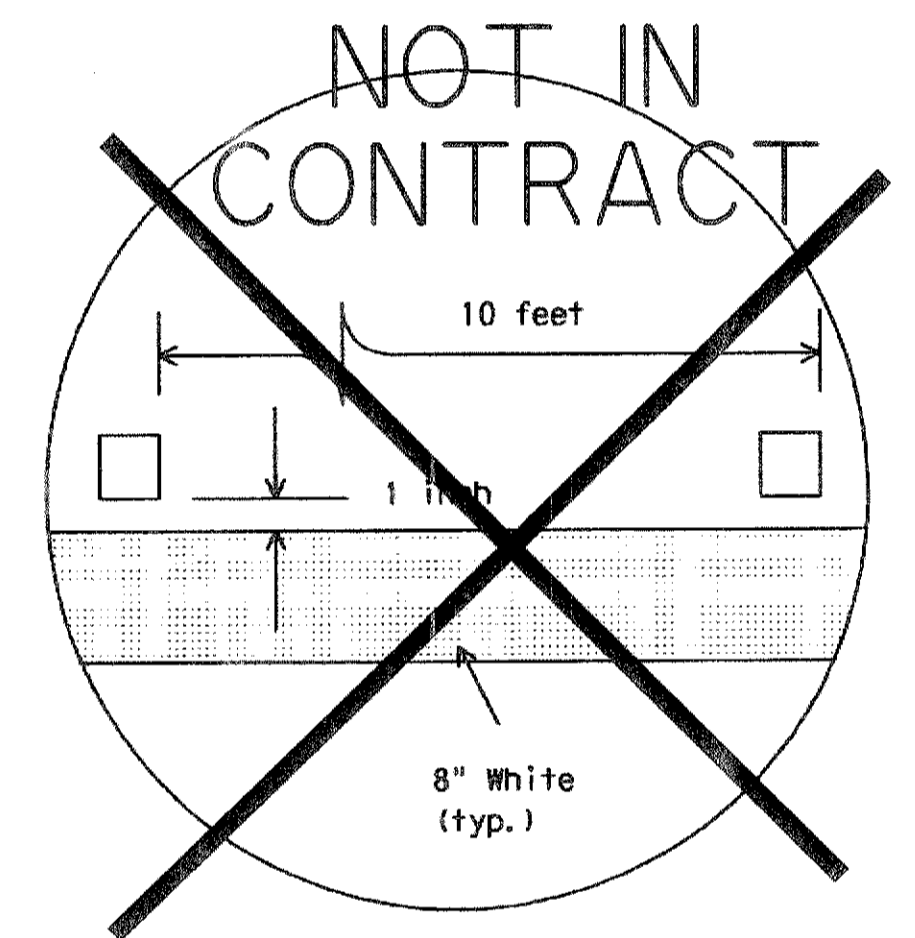

DETAIL C

Raised pavement marker
 Type I-C with undivided highways, flush medians and two way left turn lanes.
 Raised pavement marker
 Type II-C-R with divided highways and raised medians.

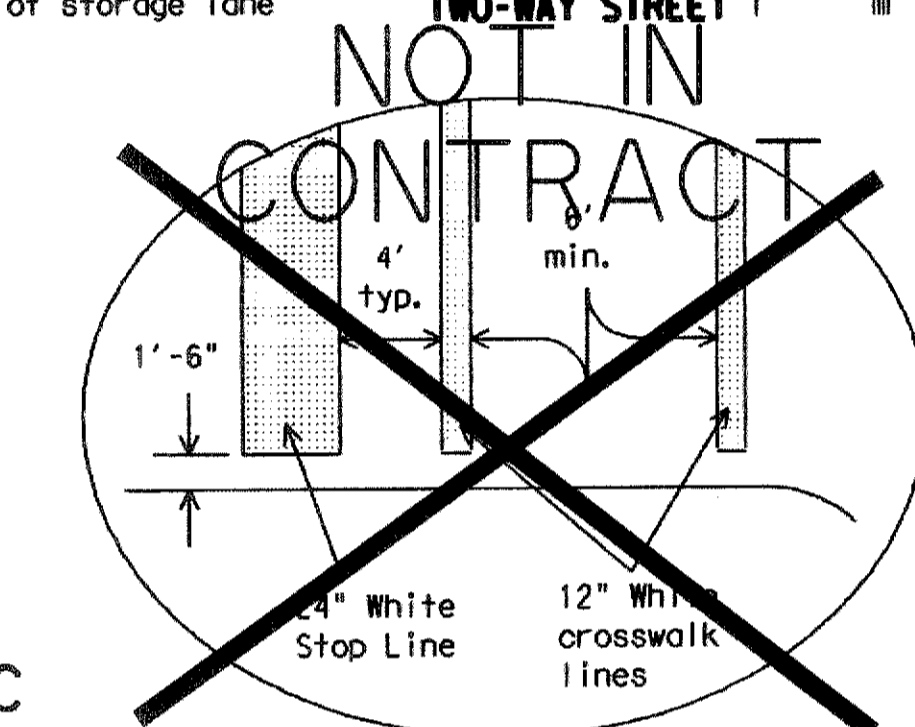

DETAIL D

GENERAL NOTES
 Refer elsewhere in plans for additional RPM placement and details.
 Details for words and arrows as shown on other sheets.
 All pavement marking materials shall meet the required Departmental Material Specifications as specified by the plans.
 For a left turn bay, two sets of words and arrows shall be used if the length of the bay is equal to or greater than 180 feet. The bottom of the first ONLY shall be placed at the beginning of the turn bay lane line as shown above.
 Other crosswalk patterns as shown in the "Texas Manual on Uniform Traffic Control Devices" may be used.

SPECIFICATION REFERENCE TABLE
 MATERIAL SPECIFICATIONS
 PAVEMENT MARKERS (REFLECT.) DMS-4200
 EPOXY DMS-6100
 BITUMINOUS ADHESIVE FOR PAVE. MKS. DMS-6130

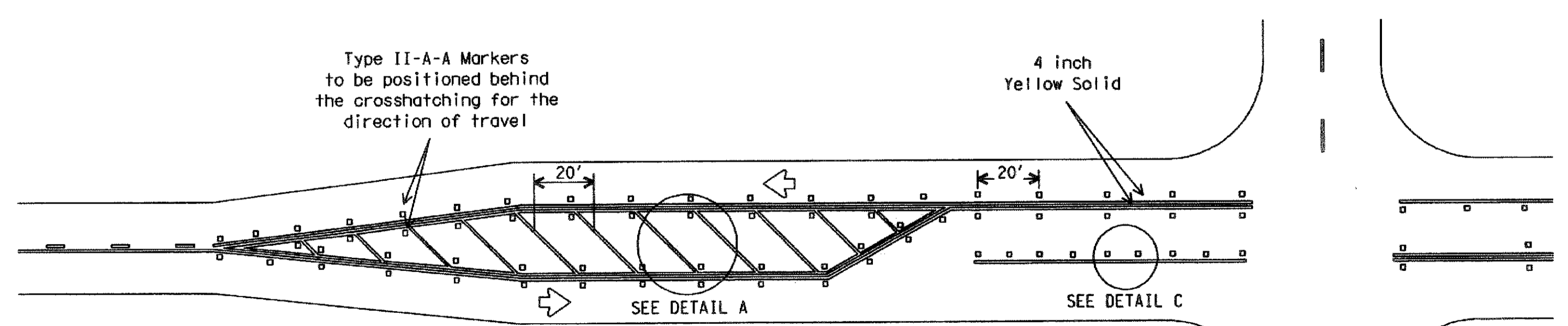

TYPICAL TWO-LANE HIGHWAY INTERSECTION WITH LEFT TURN BAYS

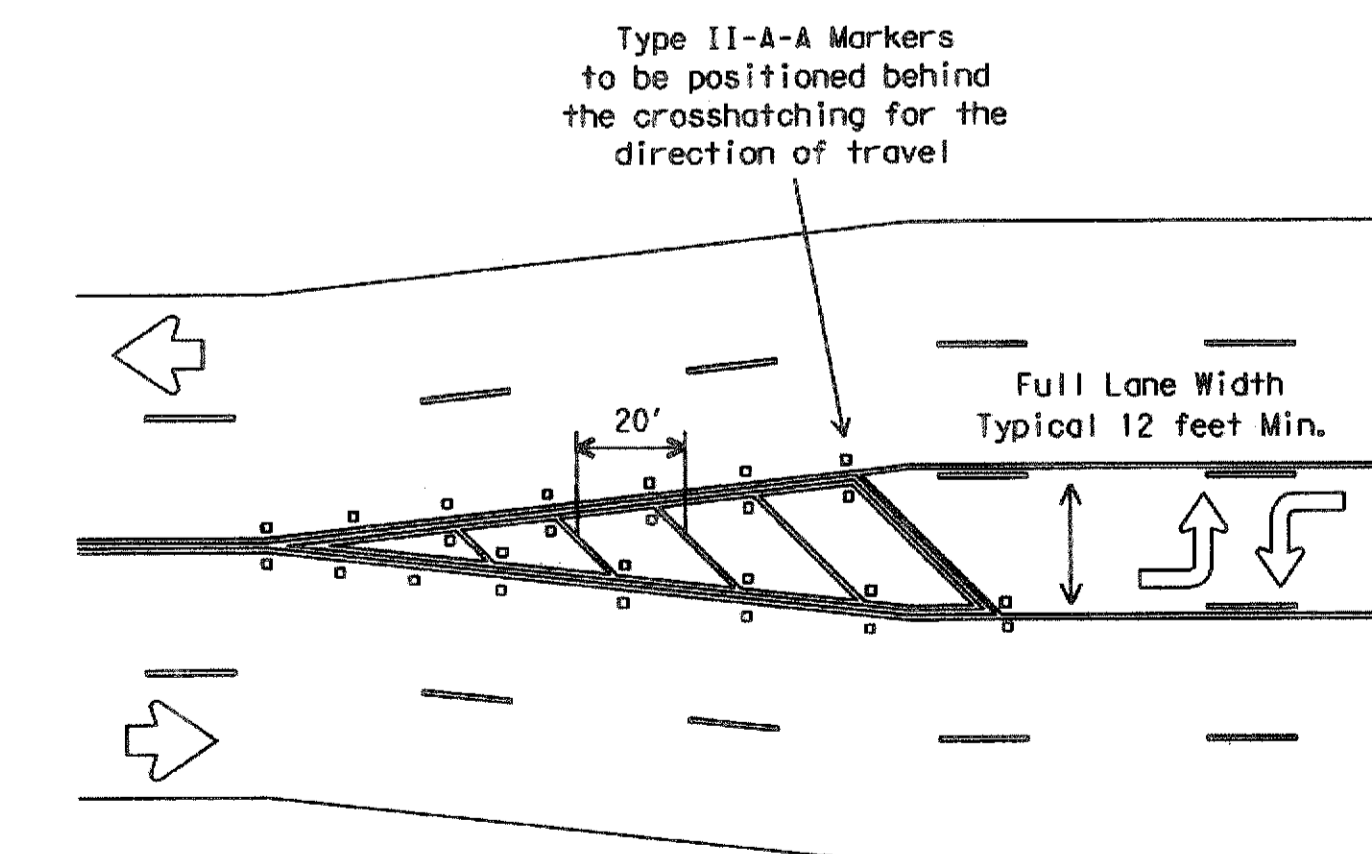

TYPICAL TRANSITION FOR TWLTL AND DIVIDED HIGHWAY

RECORD DRAWING
4/07/2009
 TO THE BEST OF OUR KNOWLEDGE WIER & ASSOCIATES, INC., HERBY STATES THAT THIS PLAN IS AS-BUILT. THIS INFORMATION PROVIDED IS BASED ON SURVEYING AT THE SITE AND INFORMATION PROVIDED BY THE CONTRACTOR.

STANDARD PLANS
Texas Department of Transportation
 Traffic Operations Division

PAVEMENT MARKINGS FOR TWO-WAY LEFT TURN LANES DIVIDED HIGHWAYS AND RURAL LEFT TURN BAYS
 PM(4)-03

REVISING	DATE	BY	CHK	APP	NO.
5-00	APR 11 1998	BAS	GRB	FDN	CAL
8-00					
3-03					

PROJECT: STATE DISTRICT: FEDERAL AID PROJECT: COUNTY: CONTROL: SECTION: JOB: HIGHWAY:

220