

FILE: G103-Channel Grading out of SD Line Q-98041-04.dwg
 TIME: 9:17

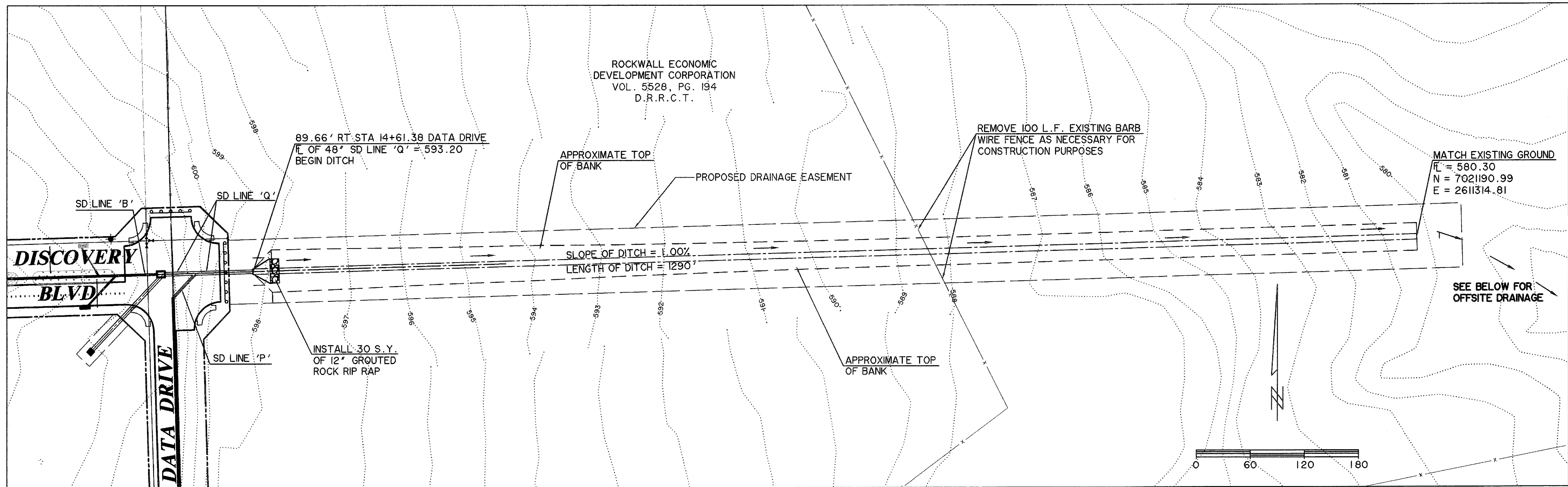

OFFSITE DRAINAGE

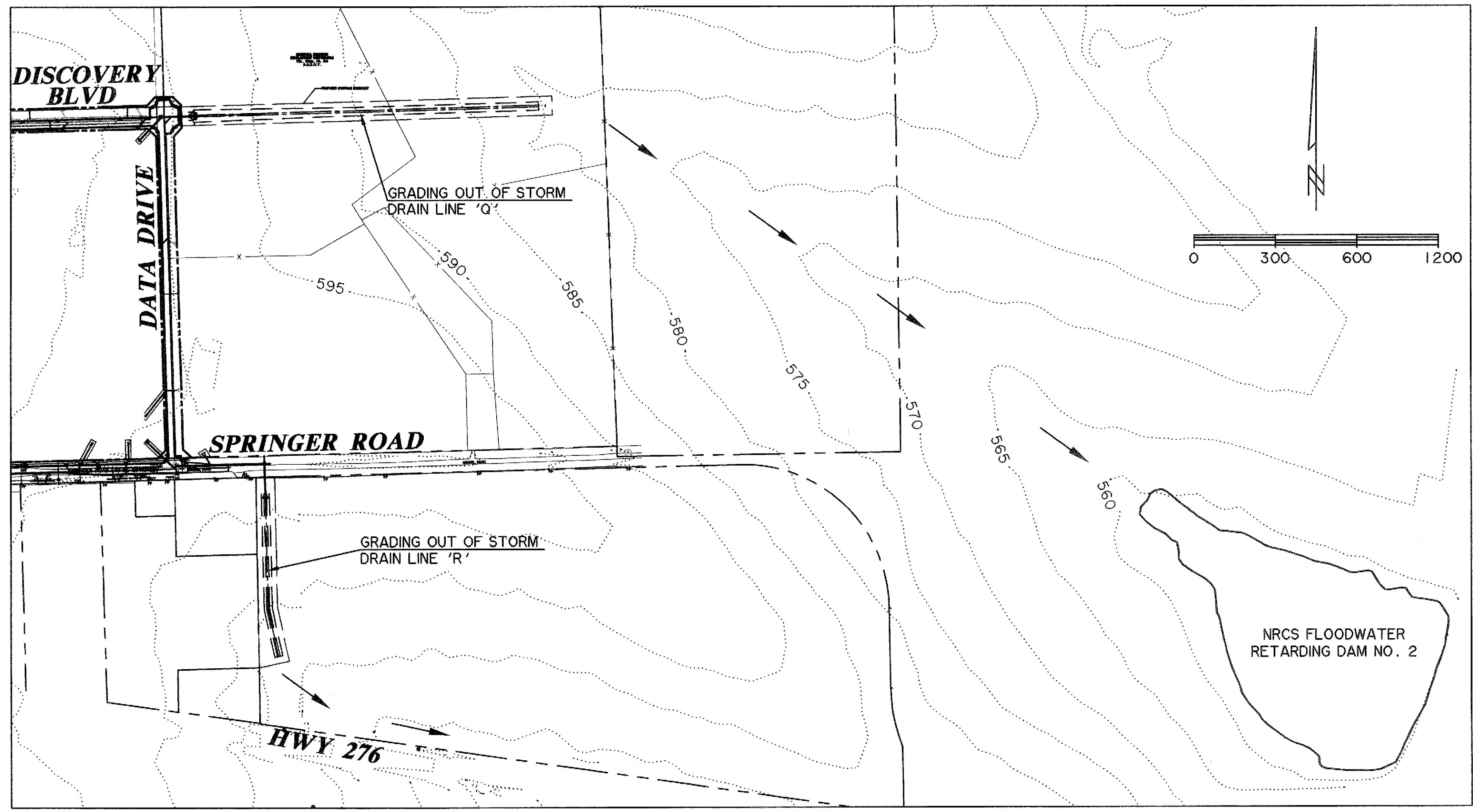

TYPICAL DITCH CROSS SECTION (N.T.S)

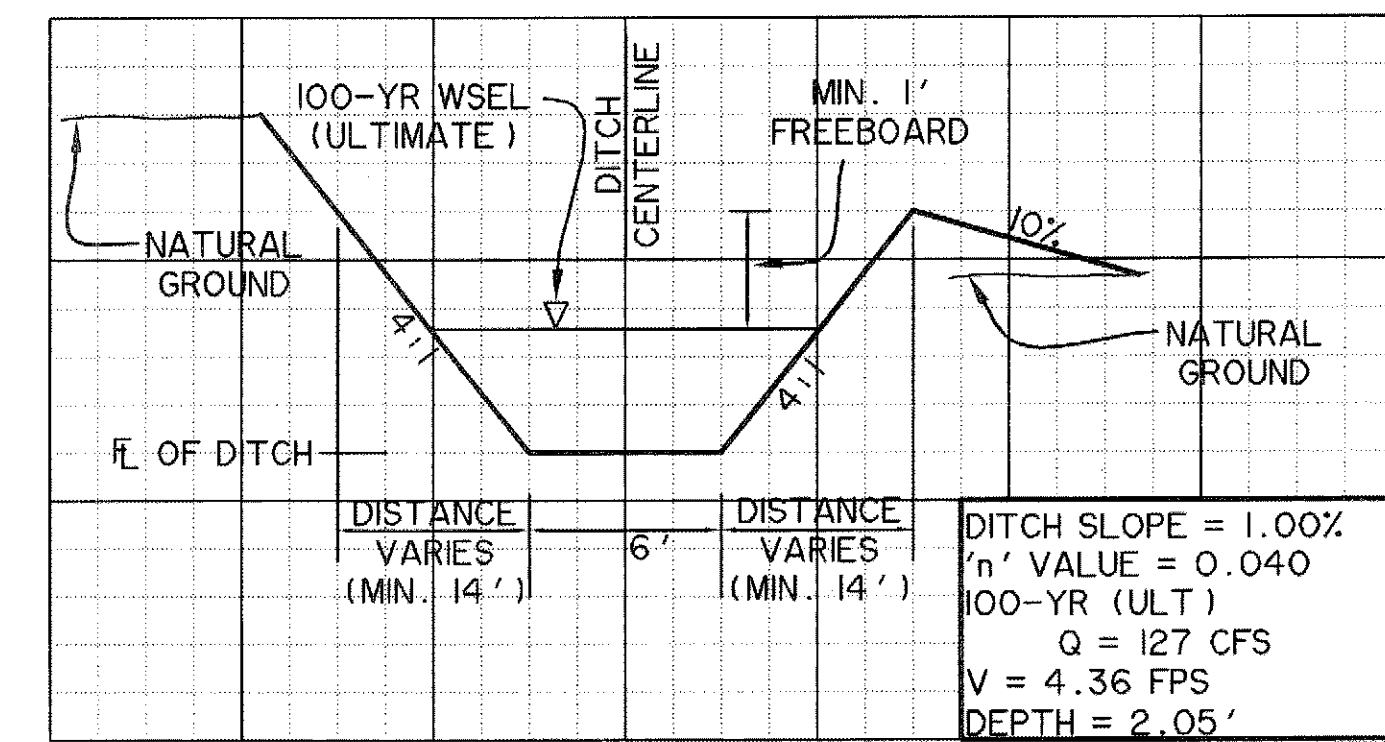

NOTES:

1. CHANNEL SIDES TO HAVE 4:1 SLOPE. AFTER REACHING HEIGHT OF 3.05' ABOVE THE FL OF THE DITCH, CONTRACTOR SHALL CONTINUE THE 4:1 SLOPE UP TO NATURAL GROUND (IF BELOW NATURAL GROUND), OR BEGIN TO COME BACK DOWN AT A 10% SLOPE UNTIL REACHING NATURAL GROUND (IF ABOVE NATURAL GROUND).
2. SEED ALL DISTURBED/GRADED AREAS AFTER CONSTRUCTION. SEE TECHNICAL SPECIFICATIONS IN CONTRACT DOCUMENTS.

RECORD DRAWING
4/07/2009
 TO THE BEST OF OUR KNOWLEDGE WIER & ASSOCIATES, INC., HERBY STATES THAT THIS PLAN IS AS-BUILT. THIS INFORMATION PROVIDED IS BASED ON SURVEYING AT THE SITE AND INFORMATION PROVIDED BY THE CONTRACTOR.

CAUTION !!
 EXISTING UTILITIES ARE INDICATED ON THE PLANS FROM AVAILABLE INFORMATION. IT SHALL BE THE RESPONSIBILITY OF THE CONTRACTOR TO VERIFY THE LOCATION OF ALL UTILITIES, TO NOTIFY ALL UTILITY COMPANIES OF THE CONTRACTORS OPERATIONS, TO PROTECT ALL UTILITIES FROM DAMAGE, TO REPAIR ALL UTILITIES DAMAGED DUE TO THE CONTRACTORS OPERATIONS, AND TO NOTIFY THE ENGINEER PROMPTLY OF ALL CONFLICTS OF THE WORK WITH EXISTING UTILITIES.

* BENCH MARKS *

BM A - AN "X" CUT IN THE BACK OF CURB LOCATED AT THE SOUTH RIGHT-OF-WAY LINE OF SPRINGER ROAD ±2470' EAST OF THE INTERSECTION OF SPRINGER ROAD AND F.M. 549. 598.80 FT.

BM B - AN "X" CUT IN THE BACK OF CURB LOCATED AT THE NORTH RIGHT-OF-WAY LINE OF DISCOVERY BOULEVARD ±580' EAST OF THE INTERSECTION OF DISCOVERY BOULEVARD AND F.M. 549. 599.82 FT.

BM C - AN "X" CUT IN DISCOVERY BOULEVARD IN A MEDIAN NOSE ±60' WEST OF THE INTERSECTION OF DISCOVERY BOULEVARD AND F.M. 549. 598.20 FT.

PREPARED BY:
WIER & ASSOCIATES, INC.
 ENGINEERS SURVEYORS LAND PLANNERS
 701 HIGHLANDER BLVD., SUITE 300 ARLINGTON, TEXAS 76015 METRO (817)467-7700
 6849 ELM STREET FISCO, TEXAS 75034 METRO (214)397-8000
 Texas State Registration No. 2776 www.wierassociates.com

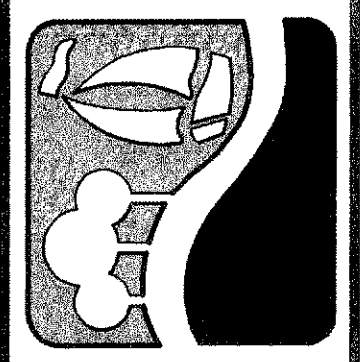

ROCKWALL TECHNOLOGY PARK PHASE III

CHANNEL GRADING OUT OF STORM DRAIN LINE Q

STATE OF TEXAS
 RONALD RAMIREZ
 81821
 REGISTERED PROFESSIONAL ENGINEER
 COPYRIGHT ©
 WIER & ASSOCIATES, INC.
 LAST SHEET EDIT
 DATE 04-06-2009
 WA# 98041.04
SHEET NO. G103