

BLACKLAND WATER SUPPLY
VOL. 235, PG. 233
D.R.R.C.T.

DATA DRIVE
C STA: 1+59.12
SPRINGER ROAD
C STA: 26+88.06

CITY OF ROCKWALL
VOL. 2219, PG. 187
D.R.R.C.T.

ROCKWALL ECONOMIC
DEVELOPMENT CORPORATION
VOL. 2224, PG. 226
D.R.R.C.T.

ROCKWALL ECONOMIC
DEVELOPMENT CORPORATION
VOL. 5528, PG. 194
D.R.R.C.T.

NOTE:
1) STREET DIMENSIONS ARE FROM
BACK OF CURB TO EDGE OF
CONCRETE (BC-EC).

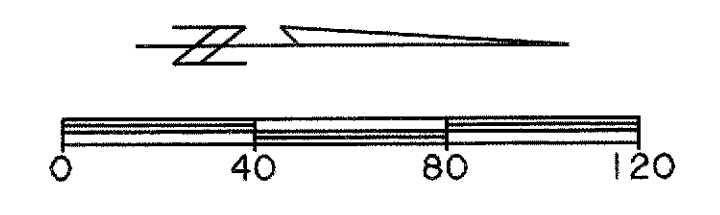

CAUTION !!
EXISTING UTILITIES ARE INDICATED ON THE PLANS FROM
AVAILABLE INFORMATION. IT SHALL BE THE RESPONSIBILITY OF
THE CONTRACTOR TO VERIFY THE LOCATION OF ALL UTILITIES,
TO NOTIFY ALL UTILITY COMPANIES OF THE CONTRACTORS
OPERATIONS, TO PROTECT ALL UTILITIES FROM DAMAGE,
TO REPAIR ALL UTILITIES DAMAGED DUE TO THE CONTRACTORS
OPERATIONS, AND TO NOTIFY THE ENGINEER PROMPTLY OF ALL
CONFLICTS OF THE WORK WITH EXISTING UTILITIES.

PREPARED BY:
WIER & ASSOCIATES, INC.
ENGINEERS SURVEYORS LAND PLANNERS
701 HIGHLANDER BLVD., SUITE 300 ARLINGTON, TEXAS 76015 METRO (817)467-7700
6849 ELM STREET FRISCO, TEXAS 75034 METRO (214)387-8000
Texas State Registration No. 2776 www.wierassociates.com

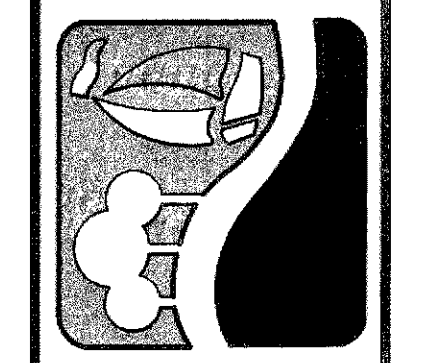

**ROCKWALL
TECHNOLOGY
PARK
PHASE III**

**DATA DRIVE
PAVING PLAN AND PROFILE
STA 1+59.12 TO STA 9+00**

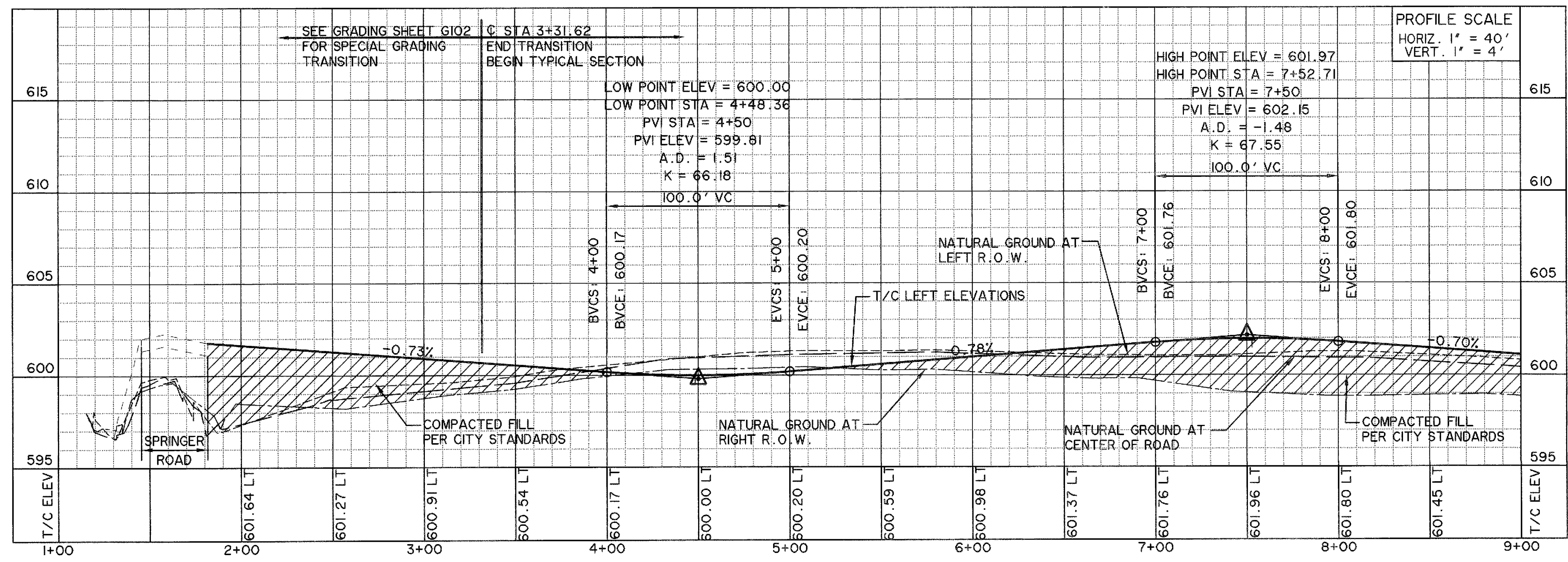

*** BENCH MARKS ***

BM A - AN "X" CUT IN THE BACK OF CURB
LOCATED AT THE SOUTH RIGHT-OF-WAY LINE
OF SPRINGER ROAD ±2470' EAST OF THE
INTERSECTION OF SPRINGER ROAD AND F.M.
549. 598.80 FT.

BM B - AN "X" CUT IN THE BACK OF CURB
LOCATED AT THE NORTH RIGHT-OF-WAY
LINE OF DISCOVERY BOULEVARD ±580' EAST
OF THE INTERSECTION OF DISCOVERY
BOULEVARD AND F.M. 549. 599.82 FT.

BM C - AN "X" CUT IN DISCOVERY
BOULEVARD IN A MEDIAN NOSE ±60' WEST OF
THE INTERSECTION OF DISCOVERY
BOULEVARD AND F.M. 549. 598.20 FT.

**RECORD
DRAWING
4/07/2009**

TO THE BEST OF OUR KNOWLEDGE WIER & ASSOCIATES,
INC., HEREBY STATES THAT THIS PLAN IS AS-BUILT. THIS
INFORMATION PROVIDED IS BASED ON SURVEYING AT THE
SITE AND INFORMATION PROVIDED BY THE CONTRACTOR.

STATE OF TEXAS
REGISTERED PROFESSIONAL ENGINEER
RONALD RAMIREZ
81821
WIER & ASSOCIATES, INC.
LAST SHEET EDIT
DATE 04-07-2009
WA# 98041.04
**SHEET NO.
P106**