

!!! WARNING !!!
 EXISTING OVERHEAD/UNDERGROUND TELEPHONE, ELECTRIC AND UNDERGROUND GAS AND FIBER OPTIC UTILITIES IN THE AREA. CONTACT UTILITY COMPANIES 48 HOURS PRIOR TO CONSTRUCTION AT 1-800-DIG-TESS.

ALL DIMENSIONS ARE TO BACK-OF-CURB UNLESS OTHERWISE NOTED.

NOTE: REFER TO SHEET C1.1 FOR GENERAL NOTES

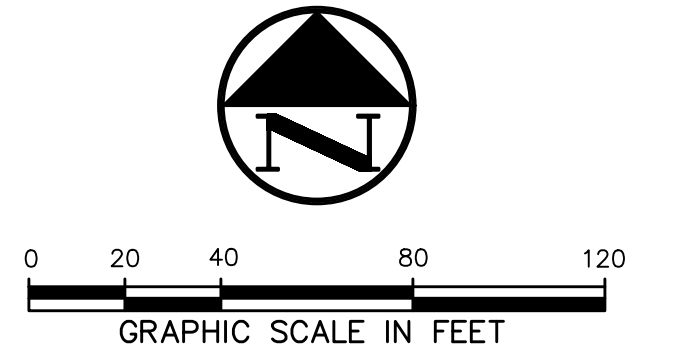

LEGEND

BL	BOLLARD
EM	ELECTRIC METER
PP	POWER POLE
LS	LIGHT STANDARD
WM	WATER METER
WV	WATER VALVE
ICV	IRRIGATION CONTROL VALVE
FHD	FIRE HYDRANT
CO	CLEANOUT
MH	MANHOLE
TSC	TRAFFIC SIGNAL CONTROL
TSP	TRAFFIC SIGNAL POLE
TELE	TELEPHONE BOX
FL	FLOOD LIGHT
FP	FLAG POLE
SIGN	TRAFFIC SIGN
IRS	1/2-INCH IRON ROD
(C.M.)	W/"PACHECO KOCH" CAP SET
---	CONTROLLING MONUMENT
---	PROPERTY LINE
---	FENCE
X	PROPOSED FENCE

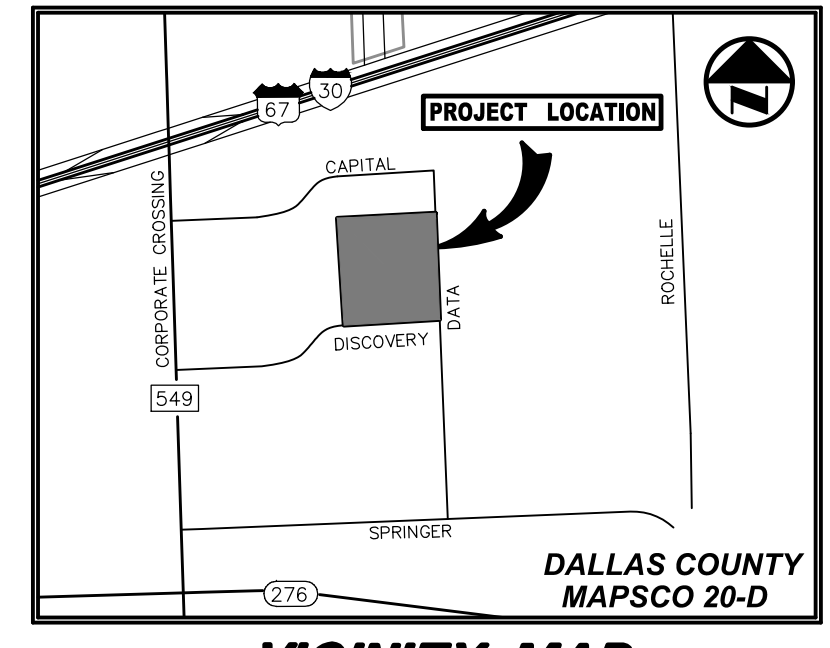

VICINITY MAP
(NOT TO SCALE)

RECORD DRAWING

THE SIGNED AND SEALED CONSTRUCTION DOCUMENT HAS BEEN REVISED TO REFLECT CONSTRUCTION RECORDS MAINTAINED AND PROVIDED BY THE CONTRACTOR FOR THIS PROJECT. THE INFORMATION SHOWN ON THIS RECORD DRAWING, WHICH WAS PROVIDED BY THE CONTRACTOR, OR OTHERS NOT ASSOCIATED WITH THE DESIGN ENGINEER, CANNOT BE VERIFIED FOR ACCURACY OR COMPLETENESS. PACHECO KOCH SHALL ASSUME NO LIABILITY FOR ANY CHANGES MADE DURING CONSTRUCTION THAT WERE NOT SPECIFICALLY APPROVED BY THE ENGINEER PRIOR TO CONSTRUCTION. THE SEALED CONSTRUCTION DRAWINGS ARE ON FILE AT THE OFFICES OF PACHECO KOCH.

ATTESTED BY: *[Signature]*
 ENGINEER OF RECORD: CHET LEUGERS, P.E.
 CONTRACTOR: MILLER-VALENTE CONSTRUCTION
 DATE REVISED: 06/08/2017

NO.	DATE	REVISION
06/09/2017	RECORD DRAWINGS	

Pacheco Koch
 7557 RAMBLER ROAD, SUITE 1400
 DALLAS, TX 75231 972.235.3031
 TX REG. ENGINEERING FIRM F-14439
 TX REG. SURVEYING FIRM LS-10193805

DIMENSIONAL CONTROL PLAN
ROCKWALL MANUFACTURING FACILITY
LOT 1, BLOCK A, ROCKWALL
TECHNOLOGY PARK, PHASE IV
CITY OF ROCKWALL, ROCKWALL COUNTY, TEXAS

DESIGN	DRAWN	DATE	SCALE	NOTES	FILE	NO.
CTL	RHB	JULY 2016	1"=40'			C1.4

NELSON 6/14/2017 2:10 PM M:\VNC-37\3782-16.05A\DWG\CIVIL C-3D 2015\3782-16.05A-DIMS.DWG

Rockwall Manufacturing Facility