

**!!! WARNING !!!**  
 EXISTING OVERHEAD/UNDERGROUND TELEPHONE, ELECTRIC AND UNDERGROUND GAS AND FIBER OPTIC UTILITIES IN THE AREA. CONTACT UTILITY COMPANIES 48 HOURS PRIOR TO CONSTRUCTION AT 1-800-DIG-TESS.

ALL DIMENSIONS ARE TO BACK-OF-CURB UNLESS OTHERWISE NOTED.

NOTE: REFER TO SHEET C1.1 FOR GENERAL NOTES

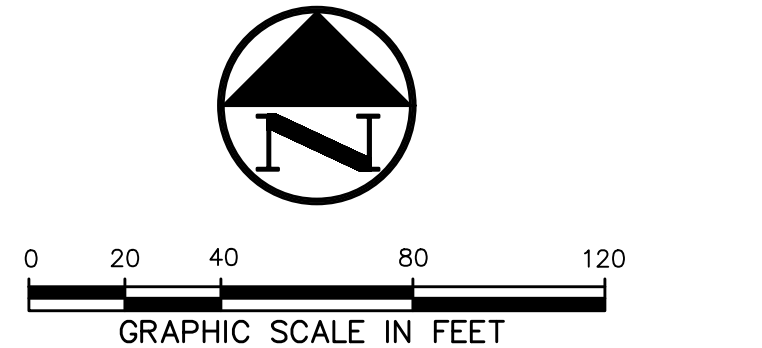

- LEGEND**
- BL BOLLARD
  - EM ⊙ ELECTRIC METER
  - PP ⊙ POWER POLE
  - LS ⊙ LIGHT STANDARD
  - WM ⊙ WATER METER
  - WV ⊙ WATER VALVE
  - ICV ⊙ IRRIGATION CONTROL VALVE
  - FH ⊙ FIRE HYDRANT
  - CO ⊙ CLEANOUT
  - MH ⊙ MANHOLE
  - TSC ⊙ TRAFFIC SIGNAL CONTROL
  - TSP ⊙ TRAFFIC SIGNAL POLE
  - TELE ⊙ TELEPHONE BOX
  - FL ⊙ FLOOD LIGHT
  - FP ⊙ FLAG POLE
  - SGN ⊙ TRAFFIC SIGN
  - IRS 1/2-INCH IRON ROD
  - (C.M.) W/PACHECO KOCH CAP SET
  - CONTROLLING MONUMENT
  - PROPERTY LINE
  - - - FENCE
  - X PROPOSED FENCE

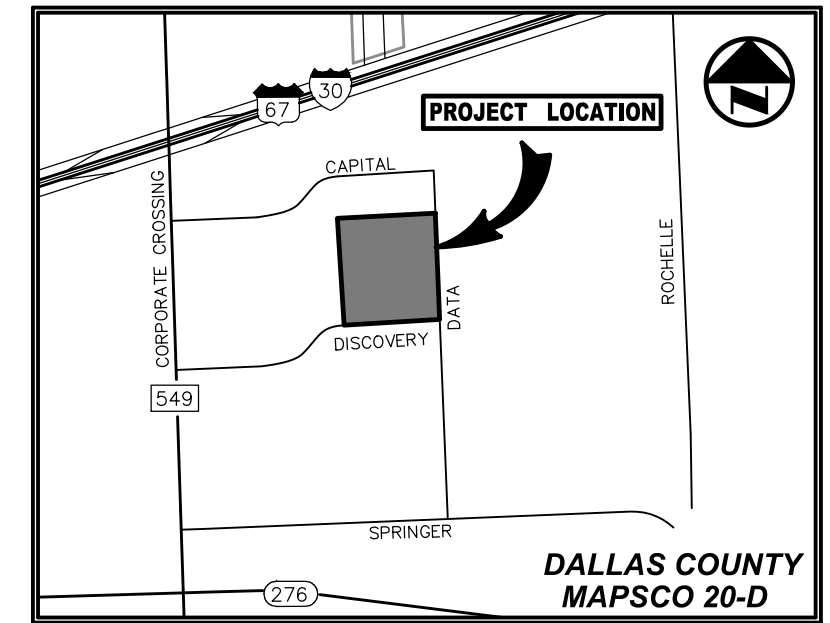

**VICINITY MAP**  
(NOT TO SCALE)

N 00°41'58" W  
1604.601

ROCKWALL ECONOMIC DEVELOPMENT CORPORATION  
(INST. NO. 20130000496918)

ROCKWALL ECONOMIC DEVELOPMENT CORPORATION  
(VOL. 3495, PG. 314)  
48,584 ACRES  
(2,116,334 SF)

A=15°49'29"  
R=1,042.50'  
L=287.93'  
T=144.89'  
CB=S 80°29'05" W  
CD=287.02'

S 88°33'03" W  
24.12'

S 01°38'50" E 1212.90'

S 88°23'49" W 961.50'

**DISCOVERY BOULEVARD**

**MATCH LINE**  
SEE SHEET C1.4

**MATCH LINE - SEE SHEET C1.1**

**RECORD DRAWING**

THE SIGNED AND SEALED CONSTRUCTION DOCUMENT HAS BEEN REVISED TO REFLECT CONSTRUCTION RECORDS MAINTAINED AND PROVIDED BY THE CONTRACTOR FOR THIS PROJECT. THE INFORMATION SHOWN ON THIS RECORD DRAWING, WHICH WAS PROVIDED BY THE CONTRACTOR, OR OTHERS NOT ASSOCIATED WITH THE DESIGN ENGINEER, CANNOT BE VERIFIED FOR ACCURACY OR COMPLETENESS. PACHECO KOCH SHALL ASSUME NO LIABILITY FOR ANY CHANGES MADE DURING CONSTRUCTION THAT WERE NOT SPECIFICALLY APPROVED BY THE ENGINEER PRIOR TO CONSTRUCTION. THE SEALED CONSTRUCTION DRAWINGS ARE ON FILE AT THE OFFICES OF PACHECO KOCH.

ATTENDED BY: *[Signature]*

SIGNATURE: \_\_\_\_\_

ENGINEER OF RECORD: CHET LEUGERS, P.E.

CONTRACTOR: MILLER-VALENTINE CONSTRUCTION

DATE REVISED: 06/08/2017

NO.	DATE	REVISION
△ 06/09/2017	RECORD DRAWINGS	

**Pacheco Koch**  
 7557 RAMBLER ROAD, SUITE 1400  
 DALLAS, TX 75231 972.235.3031  
 TX REG. ENGINEERING FIRM F-14439  
 TX REG. SURVEYING FIRM LS-10193805

**DIMENSIONAL CONTROL PLAN**

**ROCKWALL MANUFACTURING FACILITY**

**LOT 1, BLOCK A, ROCKWALL TECHNOLOGY PARK, PHASE IV**

**CITY OF ROCKWALL, ROCKWALL COUNTY, TEXAS**

DESIGN	DRAWN	DATE	SCALE	NOTES	FILE	NO.
CTL	RHB	JULY 2016	1"=40'			<b>C1.3</b>

LOT 2, BLOCK B  
 ROCKWALL TECHNOLOGY PARK PHASE III  
 (CAB. H, SLIDE 273)

ALLEN FOODS, INC.  
 (VOL. 6740, PG. 138)

NELSON 6/14/2017 2:10 PM M:\DWG-37\3782-16.054\DWG\CIVIL C3D 2015\3782-16.054\DWG.DWG

Rockwall Manufacturing Facility